

Latitude: 39°50'00" (SHL)

SURFACE HOLE 6,790'

BOTTOM HOLE 7,050'

Latitude: 39°47'30" (BHL)



CIVIL & ENVIRONMENTAL CONSULTANTS, INC.
120 GENESIS BOULEVARD
BRIDGEPORT, WV 26330
304-933-3119

GRID NORTH
UTM, NAD83 DATUM, ZONE 17, US FT

PROPOSED SURFACE HOLE
ASDRILLED SURFACE HOLE

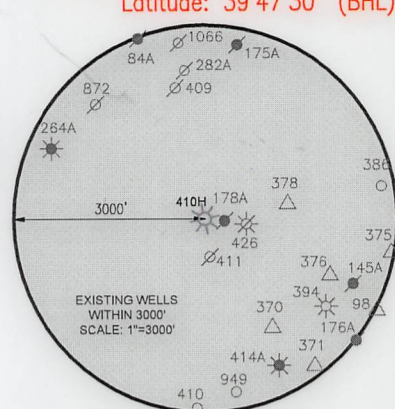
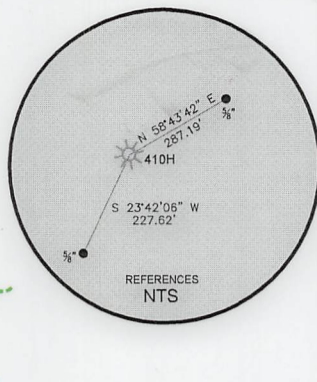

Table with 5 rows: SURFACE HOLE LOCATION (SHL), LANDING POINT LOCATION (LHL), TURNING POINT LOCATION (TPL), BOTTOM HOLE LOCATION (BHL). Each row contains UTM coordinates (Northings and Eastings).

Table with 4 rows: PERMIT SURFACE HOLE LOCATION (SHL), PERMIT LANDING POINT LOCATION (LHL), PERMIT TURNING POINT LOCATION (TPL), PERMIT BOTTOM HOLE LOCATION (BHL). Each row contains UTM coordinates.

AS-DRILLED

WELL RESTRICTIONS

- 1. NO OCCUPIED DWELLINGS > 2500 SQ FT. WITHIN 625 FEET OF CENTER OF PAD.
2. NO AGRICULTURE BUILDINGS > 2500 SQ FT. WITHIN 625 FEET OF CENTER OF PAD.
3. WATER WELLS OR DEVELOPED SPRINGS ARE WITHIN 625 FEET OF PROPOSED WELL.
4. PERENNIAL STREAMS, LAKES, PONDS, OR RESERVOIRS WITHIN 600 FEET OF THE LIMITS OF DISTURBANCE.
5. NO NATURALLY PRODUCING TROUT STREAM WITHIN 300 FEET OF LIMITS OF DISTURBANCE.
6. NO GROUND INTAKE OR PUBLIC WATER SUPPLY WITHIN 1000 FEET OF WELL PAD, LIMITS OF DISTURBANCE, E & S CONTROLS OR PUBLIC WATER SUPPLY.

NOTES ON SURVEY

- 1. SURFACE AND ROYALTY OWNER INFORMATION AND THEIR BOUNDARIES SHOWN HEREON WERE PLOTTED FROM DEEDS AND/OR TAX PARCEL MAPS PROVIDED BY CLIENT AND/OR FIELD LOCATIONS.
2. THIS PLAT DOES NOT REPRESENT A BOUNDARY SURVEY OF THE PARCELS SHOWN HEREON.
4. ALL INSETS ARE GRID NORTH UNLESS OTHERWISE DEPICTED.

I, THE UNDERSIGNED, HEREBY CERTIFY THAT THIS PLAT IS CORRECT TO THE BEST OF MY KNOWLEDGE AND BELIEF AND SHOWS ALL THE INFORMATION REQUIRED BY LAW AND REGULATIONS ISSUED AND PRESCRIBED BY THE DEPARTMENT OF ENVIRONMENTAL PROTECTION.

P.S. 991

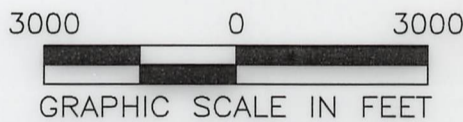
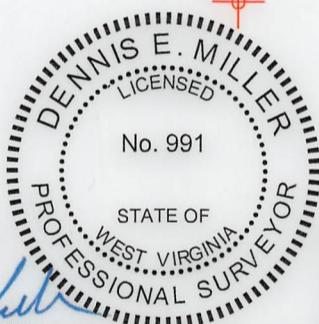

VERTICAL DIMENSIONS: SURFACE HOLE 15,106', BOTTOM HOLE 13,270', Longitude: 80°32'30" (BHL), Longitude: 80°35'00" (SHL)



(+) DENOTES LOCATION OF WELL ON UNITED STATES TOPOGRAPHIC MAPS
WVDEP
OFFICE OF OIL & GAS
601 57TH STREET
CHARLESTON, WV 25034

MINIMUM DEGREE OF ACCURACY: 1/200
PROVEN SOURCE OF ELEVATION: SURVEY GRADE GPS (NAVD 88, US FT)

COMPANY: SWN Production Company, LLC

CHARLES JAMISON MSH
OPERATOR'S WELL #: 410H
API WELL #: 47 051 02425
STATE COUNTY PERMIT

WELL TYPE: OIL [ ] WASTE DISPOSAL [ ] PRODUCTION [X] DEEP [ ] GAS [X] LIQUID INJECTION [ ] STORAGE [ ] SHALLOW [X]
WATERSHED: MAGGOTY RUN
DISTRICT: LIBERTY DISTRICT COUNTY: MARSHALL
SURFACE OWNER: CHARLES AND JEAN JAMISON
OIL & GAS ROYALTY OWNER: CHARLES AND JEAN JAMISON
DRILL [ ] DRILL DEEPER [ ] REDRILL [ ] FRACTURE OR STIMULATE [ ] PLUG OFF OLD FORMATION [ ] PERFORATE NEW FORMATION [ ]
CONVERT [ ] PLUG & ABANDON [ ] CLEAN OUT & REPLUG [ ] OTHER CHANGE [X] (SPECIFY) ASDRILLED
TARGET FORMATION: MARCELLUS ESTIMATED DEPTH: 7,383.77 TVD 27,375.00 TMD

WELL OPERATOR: SWN PRODUCTION COMPANY, LLC
ADDRESS: 1300 FORT PIERPONT DRIVE, STE 201
CITY: MORGANTOWN STATE: WV ZIP CODE: 26508
DESIGNATED AGENT: BRITTANY WOODY
ADDRESS: 1300 FORT PIERPONT DRIVE, STE 201
CITY: MORGANTOWN STATE: WV ZIP CODE: 26508

LEGEND: PROPOSED SURFACE HOLE / BOTTOM HOLE, EXISTING / PRODUCING WELLHEAD, LPL, EXISTING WATER WELL, EXISTING SPRING, SURVEYED BOUNDARY, DRILLING UNIT, LEASE BOUNDARY, ASDRILLED PATH, PROPOSED PATH

REVISIONS: DATE: 8-05-2022
DRAWN BY: K.E.S.
SCALE: 1" = 3000'
DRAWING NO: 170-426
WELL LOCATION PLAT



CIVIL & ENVIRONMENTAL CONSULTANTS, INC.  
 120 GENESIS BOULEVARD  
 BRIDGEPORT, WV 26330  
 304-933-3119

WELL BORE TABLE FOR SURFACE OWNERS		
TRACT	SURFACE OWNER	TAX PARCEL
1	CHARLES AND JEAN JAMISON	07-007-0006
2	KENNETH WAYNE STEELE REVOCABLE LIVING TRUST AGREEMENT	07-007-0011
3	ANTHONY M. SKRYPEK	07-007-0010
4	GAIL L. ZWICK - LIFE	07-006-0008
5	CNX LAND, LLC	07-006-0010
6	CO. RT. 23 ROW (CAMERON RIDGE ROAD)	
7	GAIL L. ZWICK - LIFE	07-006-0012.1
8	CNX LAND, LLC	07-006-0012
9	ROBIN E. AND DONALD QUIGLEY	07-010-0020
10	ROBIN E. AND DONALD QUIGLEY	07-011-0001
11	CNX LAND, LLC	07-011-0002
12	CNX LAND, LLC	07-011-0003
13	FISH RIDGE ROAD ROW	
14	SCOTT C. MARLING AND JESSICA L. PARRY	07-011-0004
15	ELLEN MARIE QUIGLEY	07-011-0005
16	ELLEN MARIE QUIGLEY	07-016-0036
17	CO. RT. 96 ROW	
18	HINKLE FAMILY TRUST	07-015-0001
19	HINKLE FAMILY TRUST	07-015-0019
20	DAVID W. JR. AND MELANIE A. HUMMEL	07-015-0017
21	WILLIAM H. AND GAIL K. PORTER	07-015-0017.2
22	WILLIAM H. AND GAIL K. PORTER	07-015-0017.1
23	MOUNTAIN VIEW REALTY LLC	07-020-0025
24	MOUNTAIN VIEW REALTY LLC	07-015-0014
25	AMMON A. BURLEY, ET UX	07-020-0026

ADJOINING OWNERS TABLE		
TRACT	SURFACE OWNER	TAX PARCEL
A	MARSHALL COUNTY COAL RESOURCES INC.	07-007-0007
B	KENNETH WAYNE STEELE REVOCABLE LIVING TRUST AGREEMENT	07-007-0008.1
C	JEAN JAMISON	07-007-0009.1
D	ANTHONY M. SKRYPEK	07-006-0002
E	ANTHONY M. SKRYPEK	07-006-0005
F	ANTHONY M. SKRYPEK	07-006-0004
G	CNX LAND, LLC	07-006-0006
H	GAIL L. ZWICK - LIFE	07-006-0007
I	CNX LAND, LLC	07-006-0009
J	MARVIN AND SHIRLEY BYARD	07-006-0013
K	MARVIN AND SHIRLEY BYARD	07-006-0014
L	CNX LAND, LLC	07-011-0008
M	DOUGLAS AND DEANA MCCOMBS	07-011-0007
N	AMANDA MARIE LINDSEY, ANDREW DAVID MCCURDY AND TIMOTHY S. MCCURDY	07-011-0006
O	ELLEN MARIE QUIGLEY AND DIANA MATHEWS	07-011-0017
P	ANDREW MCCURDY, ET UX	07-016-0036.2
Q	ANDREW DAVID MCCURDY	07-011-0017.1
R	ELLEN MARIE QUIGLEY	07-016-0036.1
S	DONALD MACK QUIGLEY, ET UX	07-011-0018
T	DOUGLAS R. AND REBECCA J. MCCOMBS	07-011-0019
U	DAVID W. HUMMEL JR. AND MELANIE A. HUMMEL	07-015-0001.1
V	DAVID W. HUMMEL JR. AND MELANIE A. HUMMEL	07-015-0002
W	CODY MILLER	07-015-0012
X	TREVOR L. NEELY	07-015-0012.1
Y	MOUNTAIN VIEW REALTY, LLC.	07-015-0015
Z	MOUNTAIN VIEW REALTY, LLC.	07-015-0016
AA	JANEEN L. CZOLBA	07-015-0014.1
BB	BEAU V. MARTIN AND AMELIA D. YOUNG	07-015-0015.1
CC	VICTOR J. SEIFERT, ET UX - DARRELL H. II AND VICKI A. MCNEELY	07-020-0027
DD	SEAN D. AND DEBBIE L. HALL	07-020-0028
EE	RICARDO S. GREGG, ET UX	07-020-0032
FF	MONTANA SKY LLC	07-020-0032.1
GG	DENNIS DEAN HALL, ET UX	07-020-0035
HH	AMMON A. BURLEY	07-020-0037
II	AMMON A. BURLEY	07-020-0024
JJ	WILLIAM H. AND GAIL K. PORTER	07-015-0017.3
KK	CYNTHIA ANTILL, JOANNE M. HATZELL, CLAUDE R. STEPHENS, JR. AND EDWARD K. STEPHENS	07-020-0023
LL	HAROLD LEROY DOTY JR.	07-015-0018
MM	DANIEL W. DEVER, DAVID S. DEVER, GREGORY T. DEVER, JOHN A. DEVER, LAWRENCE A. DEVER AND DEBORAH KAY KINCAID	07-020-0022
NN	FRANCES IRENE ALLEN, ET AL	07-020-0021
OO	JOHN E. RIGGS, ET UX	07-016-0044
PP	BARBARA R. ARDENO, ET AL	07-016-0037
QQ	JOHN MATTHEW BUTLER	07-016-0039
RR	DAVID L. ELSON, ET UX	07-016-0034
SS	TERRY A. AND DONNA L. BONAR	07-016-0035
TT	STEPHANIE L. WHITE	07-016-0036.3
UU	DAVID L. ELSON, ET UX	07-016-0032
VV	ELLEN MARIE QUIGLEY	07-016-0033
WW	RUSSELL ALLEN JR. AND JODI D. DOTSON	07-016-0031
XX	RYAN HILL	07-016-0031.1
YY	MICHAEL KNOWLTON	07-010-0025
ZZ	JAN CAROL DOBBS, TRUSTEE OF THE G AND JAN DOBBS FAMILY TRUST AND ERIC SCOTT DOBBS	07-010-0021
AAA	MARSHALL COUNTY COAL RESOURCES INC.	07-010-0019
BBB	DONALD W. AND MARTHA J. KENNEDY	07-006-0011.1
CCC	STEPHEN L. AND PAMELA SCOTT	07-006-0011
DDD	GAIL L. ZWICK - LIFE	07-007-0014
EEE	GAIL L. ZWICK - LIFE	07-007-0012
FFF	TIMOTHY R. CAIN	07-007-0006.1
GGG	TIMOTHY R. CAIN	07-007-0006.2
HHH	MARSHALL COUNTY COAL RESOURCES INC.	07-007-0006.3

**AS-DRILLED**

API WELL #: **47** **051** **02425**  
 STATE COUNTY PERMIT

REVISIONS:	COMPANY:		
	OPERATOR'S		DATE: 8-05-2022
	WELL #:		DRAWN BY: K.E.S.
	DISTRICT:	COUNTY:	SCALE: N/A
	LIBERTY DISTRICT	MARSHALL	DRAWING NO: 170-426
		STATE:	WELL LOCATION PLAT 2
		WV	