

Latitude: 40°00'00" SURFACE HOLE 10,228'

**JACKSON SURVEYING INC.**

2413 EAST PIKE ST. # 112  
Clarksburg, WV 26302  
304-623-5851

Latitude: 39°57'30" BOTTOM HOLE 4,980'

<b>SURFACE HOLE LOCATION (SHL):</b>
UTM (NAD83, ZONE 17, METERS): NORTHING: 4,427,011.568 EASTING: 528,896.760
<b>LANDING POINT LOCATION (LPL):</b>
UTM (NAD83, ZONE 17, METERS): NORTHING: 4,426,765.469 EASTING: 528,526.897
<b>AZIMUTH LOCATION 1 (AZL1):</b>
UTM (NAD83, ZONE 17, METERS): NORTHING: 4,426,744.816 EASTING: 528,533.398
<b>AZIMUTH LOCATION 2 (AZL2):</b>
UTM (NAD83, ZONE 17, METERS): NORTHING: 4,426,562.905 EASTING: 528,592.706
<b>BOTTOM HOLE LOCATION (BHL):</b>
UTM (NAD83, ZONE 17, METERS): NORTHING: 4,421,110.193 EASTING: 530,520.402



LINE	BEARING	DISTANCE	DESCRIPTION	MONUMENT
L1	N 18°10'12" W	1,055.09'	SHL TO LANDMARK	FD. FENCE CORNER
L2	N 58°41'45" W	1,272.45'	SHL TO LANDMARK	FD. FENCE CORNER
L4	S 17°36'25" E	92.34'	LP TO AZL1	

LINE	BEARING	DISTANCE	CURVE LENGTH	DESCRIPTION
L3	S 56°21'40" W	1,457.53'	1,960.17'	SHL TO LP
L5	S 18°03'27" E	606.44'	606.44'	AZL1 TO AZL2

BOTTOM HOLE 6,839'  
SURFACE HOLE 2,628'  
Longitude: 80°37'30"

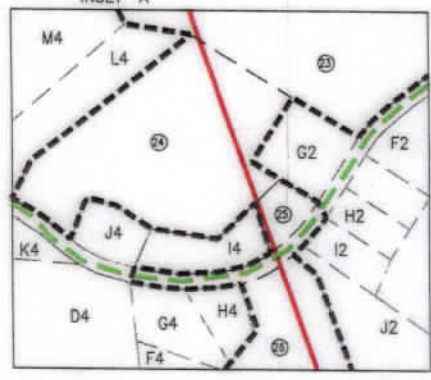
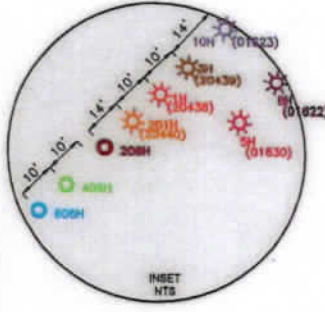
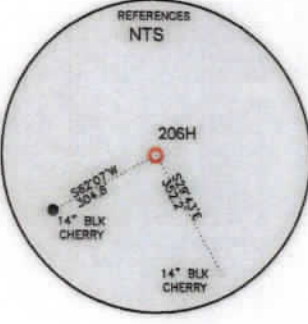
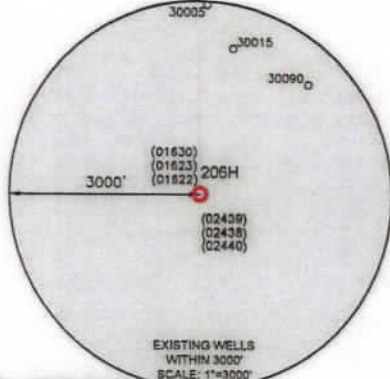

**WELL RESTRICTIONS**

1. NO OCCUPIED DWELLINGS > 2500 SQ FT. WITHIN 625 FEET OF CENTER OF PAD.
2. NO AGRICULTURE BUILDINGS > 2500 SQ FT. WITHIN 625 FEET OF CENTER OF PAD.
3. NO WATER WELLS OR DEVELOPED SPRINGS ARE WITHIN 250 FEET OF PROPOSED WELL.
4. NO PERENNIAL STREAMS, LAKES, PONDS, OR RESERVOIRS WITHIN 100 FEET OF THE LIMITS OF DISTURBANCE.
5. NO NATURALLY PRODUCING TROUT STREAM WITHIN 300 FEET OF LIMITS OF DISTURBANCE.
6. NO GROUND INTAKE OR PUBLIC WATER SUPPLY WITHIN 1000 FEET OF WELL PAD, LIMITS OF DISTURBANCE, E & S CONTROLS OR PUBLIC WATER SUPPLY.

**NOTES ON SURVEY**

1. SURFACE AND ROYALTY OWNER INFORMATION AND THEIR BOUNDARIES SHOWN HEREON WERE PLOTTED FROM DEEDS AND/OR TAX PARCEL MAPS PROVIDED BY CLIENT AND/OR FIELD LOCATIONS.
2. THIS PLAT DOES NOT REPRESENT A BOUNDARY SURVEY OF THE PARCELS SHOWN HEREON.
3. ALL INSETS ARE GRID NORTH UNLESS OTHERWISE DEPICTED.

I, THE UNDERSIGNED, HEREBY CERTIFY THAT THIS PLAT IS CORRECT TO THE BEST OF MY KNOWLEDGE AND BELIEF AND SHOWS ALL THE INFORMATION REQUIRED BY LAW AND REGULATIONS ISSUED AND PRESCRIBED BY THE DEPARTMENT OF ENVIRONMENTAL PROTECTION.

P.S. 708

*David L Jackson*



COMPANY: **SWN** Production Company, LLC

<p>(+) DENOTES LOCATION OF WELL ON UNITED STATES TOPOGRAPHIC MAPS</p> <p>WVDEP OFFICE OF OIL &amp; GAS 601 57TH STREET CHARLESTON, WV 25034</p>	MINIMUM DEGREE OF ACCURACY: 1/200 PROVEN SURVEY SOURCE OF ELEVATION: GRADE GPS (NAVD 88, US FT)	COMPANY: <b>DAVID REINBEAU MSH</b> OPERATOR'S WELL #: 206H API WELL #: 47 STATE 051 COUNTY 02501 PERMIT
---	--	---

WELL TYPE: OIL  WASTE DISPOSAL  PRODUCTION  DEEP  GAS  LIQUID INJECTION  STORAGE  SHALLOW

WATERSHED: HOLLIDAYS RUN OF WHEELING CREEK (HUC-10) ELEVATION: 1,250.8'

DISTRICT: UNION COUNTY: MARSHALL QUADRANGLE: MOUNDSVILLE, WV

SURFACE OWNER: SHELLY A. & DAVID W. REINBEAU ACREAGE: ±50.88

OIL & GAS ROYALTY OWNER: SHELLY A. & DAVID W. REINBEAU ACREAGE: ±50.88

DRILL  DRILL DEEPER  REDRILL  FRACTURE OR STIMULATE  PLUG OFF OLD FORMATION  PERFORATE NEW FORMATION

CONVERT  PLUG & ABANDON  CLEAN OUT & REPLUG  OTHER CHANGE  (SPECIFY)

TARGET FORMATION: MARCELLUS ESTIMATED DEPTH: 6,492 TO 26,615 TMD

WELL OPERATOR: SWN PRODUCTION COMPANY, LLC	DESIGNATED AGENT: BRITTANY WOODY
ADDRESS: 1300 FORT PIERPONT ROAD, SUITE 200	ADDRESS: 1300 FORT PIERPONT ROAD, SUITE 200
CITY: MORGANTOWN STATE: WV ZIP CODE: 26508	CITY: MORGANTOWN STATE: WV ZIP CODE: 26508

<b>LEGEND:</b> ○ PROPOSED SURFACE HOLE / BOTTOM HOLE * EXISTING / PRODUCING WELLHEAD LPL * LANDING POINT LOCATION ⊙ EXISTING WATER WELL ⊕ EXISTING SPRING — SURVEYED BOUNDARY — DRILLING UNIT = = = LEASE BOUNDARY — PROPOSED PATH	<b>REVISIONS:</b> DATE: 03-14-2023 DRAWN BY: J. COCKERHAM SCALE: 1" = 2000' DRAWING NO: WELL LOCATION PLAT
---	---

**JACKSON SURVEYING  
INC.**

2413 EAST PIKE ST. # 112  
Clarksburg, WV 26302  
304-623-5851



I, THE UNDERSIGNED, HEREBY CERTIFY THAT THIS PLAT IS CORRECT TO THE BEST OF MY KNOWLEDGE AND BELIEF AND SHOWS ALL THE INFORMATION REQUIRED BY LAW AND REGULATIONS ISSUED AND PRESCRIBED BY THE DEPARTMENT OF ENVIRONMENTAL PROTECTION.

3000 0 3000



GRAPHIC SCALE IN FEET 06/23/2023

P.S. 708

*David L Jackson* 47-051-02501

REVISIONS:	COMPANY:			
	OPERATOR'S		DAVID REINBEAU MSH	
	WELL #:		206H	
	DISTRICT:	COUNTY:	STATE:	DATE: 03-14-2023
	UNION	MARSHALL	WV	DRAWN BY: J. COCKERHAM
				SCALE: N/A
				DRAWING NO:
				WELL LOCATION PLAT 2

**JACKSON SURVEYING  
INC.**

2413 EAST PIKE ST. # 112  
Clarksburg, WV 26302  
304-623-5851

WELL BORE TRACTS		
TRACT	SURFACE OWNER (S) / ROYALTY OWNER (R)	TAX PARCEL
1	REINBEAU SHELLY A & DAVID W (S/R)	13-8-29
2	REINBEAU SHELLY A & DAVID W (S)	13-8-27
3	REINBEAU RONALD W & FRED A (LIFE) (S)	13-7-22.2
4	MCCOMBS JOHN A SR, THOMAS E & BETH (S)	13-8-26
5	HIERONIMOUS C KEITH ET UX (S)	13-8-15
6	CONNER AMBER D & DAVID HANES JR (S)	13-8-14
7	HIERONIMUS C KEITH ET UX (S)	13-8-13
8	CONNER AMBER D & DAVID HANES JR (S)	13-8-12
9	MELNIK BRUCE A ET UX (S)	13-10-21
10	MELNIK BRUCE A ET UX (S)	13-10-21.1
11	MONTGOMERY TORIE (S)	13-10-21.2
12	RIGGLE STACY L (S)	13-10-21.9
13	GANTZER THOMAS P & JILL N (S)	13-10-21.3
14	GANTZER THOMAS P & JILL N (S)	13-10-21.5
15	JONES NICHOLAS & EVELINE J (S)	13-10-21.8
16	METS PROPERTIES LLC (S)	13-10-22
17	METS PROPERTIES LLC (S)	13-10-23
18	EDISON MARK C ET UX (S)	13-9-9
19	ELIAS GRANT THOMAS ET UX (S)	13-9-32
20	CUNNINGHAM JOHN F (S)	13-9-29.7
21	LILLEY KENNETH R & CARLOTTA J (S)	13-9-31
22	CHAMBERS DOROTHY - LIFE (S)	13-14-07
23	MCWHORTER LELAND & DEBORAH (S)	13-14-10
24	GODDARD RUSSELL E (S)	13-14-9.5
25	GAMES KOLBY (S)	13-14-9.3
26	KNUTH DAVID W JR & NICOLE L(S)	13-14-29.10
27	SNIDER LINDA ELIZABETH(S)	13-14-29.11
28	HENRY GH & JANET FAMILY TRUST (S)	13-14-29
29	FOSTER CHARLES S ET UX (S)	13-14-38.1
30	SMITH EDWARD LEE II (S)	14-5-26
31	FRANCIS USA JANE(S)	14-5-37
32	HILL KAY F ET AL (S)	14-5-28
33	HILL KAY F ET AL (S)	14-5-29
34	HILL KAY F ET UX (S)	14-5-30
35	PETTIT DIANA LYNN (S)	14-5-31.2
36	MOORE DAVID & SHIRLEY 2018 IRREVOCABLE TRUST (S)	14-5-77

ADJOINING OWNERS TABLE		
TRACT	SURFACE OWNER	TAX PARCEL
A	SAMPSON EDITH VIRGINIA EST	13-7-19
B	BONACO BRIAN F	13-3-5.1
C	NARRISH KEVIN	13-8-30
D	SOUTH CHRISTOPHER C	13-8-31
E	KOSTELECKY JOSEPH J JR & CAROLYN - TOD	13-8-31.1
F	FUNK CHARLES D ET UX	13-8-32
G	LOY EUGENE EST ET AL	13-8-1
H	LIBERTY JOHN ET UX	13-8-10
I	MCCOMBS JOHN A SR, THOMAS E & BETH	13-8-11
J	LILLEY CONSTANCE E - TOD	13-8-10.1
K	LILLEY CONSTANCE E - TOD	13-8-7.7
L	KINNEER JAMIE ET UX	13-8-7.9
M	KINNEER VERNON A JR & JAMIE	13-8-6
N	ROCKY PEARL FARM LLC	13-9-6
O	JOHNSON GARY A ET UX	13-10-21.4
P	JONES NICHOLAS & EVELINE J	13-10-21.7
Q	JONES NICHOLAS & EVELINE J	13-9-8
R	EDISON MARK C ET UX	13-9-9.1
S	LOY CHARLES E SR - TOD	13-9-5.1
T	LOY CHARLES E SR - TOD	13-9-4
U	CUNNINGHAM GEORGE A	13-9-3
V	EDISON MARK C ET UX	13-9-10
W	CUNNINGHAM BESSIE JANE	13-9-11
X	SHERMAN FAMILY TRUST	13-9-26
Y	BERTRAM BRIAN B & ADDIE L	13-9-30
Z	HUCK LAURA LEE & MARY L	13-9-29.2
A2	KELCH SCOTT EDWARD ET UX	13-9-29.5
B2	THOMPSON MICHAEL C & CRYSTAL M	13-14-13
C2	ROGERSON CHESTER ET AL - LIFE	13-14-12
D2	BRIGGS ANDREW & MAXCINE	13-14-11
E2	BENSON CHAZ M	13-14-28
F2	ANDERSON ROBERT P & BECKI L	13-14-29.1
G2	MCDIFFITT CLYDE J & KAREN - TOD	13-14-9.1
H2	MCCONNELL DAVID A	13-14-29.2
I2	CROCKARD JAMES E	13-14-29.4
J2	MASON CURTIS G ET UX	13-14-29.7
K2	D'CAGNA LINN L	13-14-29.5
L2	GRAY CAROLYN L	13-14-29.8
M2	GRAY CAROLYN L	13-14-24
N2	GRAY CAROLYN L	13-14-24.2
O2	SMITH RICHARD A	14-5-27
P2	FOSTER CHARLES S ET UX	13-14-38.5
Q2	BLEDSE DAVID R & KIMBERLY K	14-5-26.1
R2	BLEDSE BILLY JAMES SR & NORA - LIFE BLEDSE TIMOTHY & DAVID	14-5-26.2
S2	BLEDSE BILLY JR & CLARA M	14-5-26.4
T2	ECO VRINDIBAN INC	15-2-18
U2	GORAKSHYA-SEVA & ENV EDU TRUST OF AMERICA INC	15-2-18.2
V2	GORAKSHYA-SEVA & ENV EDU TRUST OF AMERICA INC	15-7-2
W2	MILLER R CRAIG & DONITA D	15-7-2.4
X2	WIESNER GEORGE L ET UX - TOD	15-7-1.3
Y2	ISKON - NEW MATHURA VRINDIBAN	15-7-1.2
Z2	WALKER JACOB M	14-5-79

ADJOINING OWNERS TABLE		
TRACT	SURFACE OWNER	TAX PARCEL
A3	ASTON THOMAS C	14-5-78
B3	RICHMOND SALLY ANN & CHARLES R	14-5-75
C3	GUMP DAVID A & BETTY JEAN	14-5A-30
D3	SNODGRASS GARY E ET UX	14-5A-26
E3	MARRINER LEROY A	14-5A-25
F3	MASON KIERSTEN E	14-5A-19
G3	MASON ABBY LEAH	14-5A-18
H3	FERRELL CHARLES DAVID ET UX	14-5A-10
I3	FOSTER KERRY G	14-5-76
J3	LIMESTONE PRESBYTERIAN CHURCH	14-5A-5
K3	PRESBYTERIAN CHURCH	14-5-31.1
L3	HUDKINS BASIL J ET UX	14-5-31.4
M3	HILL KAY F ET UX	14-5-32.4
N3	LILLEY ROGER W & TRIGIA	14-5-32.6
O3	HILL HOWARD B EST	14-5-29.2
P3	HILL KAY F ET UX	14-5-29.1
Q3	LILLEY ROGER W ET UX	14-5-32.5
R3	TATICH DANIEL EDWARD TRUST	14-5-36
S3	FRANCIS USA JANE	14-5-36.2
T3	BISHOP PENNY S ET VIR	14-5-39.1
U3	FRANCIS USA JANE	14-5-37.1
V3	GALLOWAY HARRY L	14-5-11
W3	J & R DEVELOPMENT LLC	14-5-11.3
X3	SMITH MARK ALLEN ET UX	14-5-23
Y3	KOONTZ CARL JR ET AL	14-5-24
Z3	FOSTER CAITLIN E	13-14-50
A4	WILSON ROBERT J & REBECCA S	14-5-24.6
B4	FOSTER CHARLES S & BRENDA	13-14-38.2
C4	GUNTO CARL MET UX	13-14-34
D4	HENRY G H & JANET FAMILY TRUST	13-14-32
E4	NIVEN ROBERT M ET UX	13-14-29.12
F4	EBBERT JOHN D III ET UX	13-14-29.9
G4	STANFORD BETTY R & BRADLEY	13-14-30.1
H4	NORRIS THOMAS E ET UX	13-14-30
I4	MCCONNELL DAVID A	13-14-9.6
J4	SCHWING DAVID ELLETT	13-14-9.2
K4	DRAKE JASON T & DEANNA J	13-14-31.1
L4	COULTER JAMES G & SONDR A K	13-14-9.7
M4	ROVER PIPELINE LLC	13-14-9
N4	ROVER PIPELINE LLC	13-14-8
O4	BECKNER DAVID E & DEBORAH K	13-14-7.3
P4	LEWEY CHARLES L & MARGARET A	13-14-7.1
Q4	DORAN BRIAN W ET UX	13-14-7.4
R4	COTTRELL COLE T	13-14-7.5
S4	GIVENS BRUCE E ET UX	13-14-7.2
T4	GIVENS BRUCE E ET UX	13-14-6
U4	CHAMBERS DOROTHY	13-14-6.2
V4	MURPHY MICHAEL A & BLACK AMY S	13-14-7.6
W4	FREEMAN RAYMOND CHRISTOPHER	13-14-4
X4	SUNDERHAUS TINA M & STEPHEN G	13-14-7.7
Y4	PARSONS JAY D ET UX	13-14-1
Z4	FRYE JACQUELINE L & CHARLES G	13-14-1

06/23/2023

REVISIONS:	COMPANY:		
	OPERATOR'S	DAVID REINBEAU MSH	
	WELL #:	206H 47-051-02501	
	DISTRICT:	COUNTY:	STATE:
	UNION	MARSHALL	WV
			DATE: 03-14-2023
			DRAWN BY: J. COCKERHAM
			SCALE: N/A
			DRAWING NO:
			WELL LOCATION PLAT 3

**JACKSON SURVEYING  
INC.**

2413 EAST PIKE ST. # 112  
Clarksburg, WV 26302  
304-623-5851

ADJOINING OWNERS TABLE		
TRACT	SURFACE OWNER	TAX PARCEL
A5	VEMURI HOME & GARDEN LLC	13-9-34
B5	KIMBERLY JORDAN A	13-9-35
C5	HUCK MARY L ET AL	13-9-36
D5	GETCHEY RONALD D	13-9-37
E5	WEST RICHARD L & TIMBERLY A	13-9-38
F5	WEST RICHARD L & TIMBERLY A	13-9-39
G5	JARRETT JAMES M & EVELYN E	13-9-40
H5	LAUDERMILT RAY A ET UX	13-9-41
I5	FRANCIS SAMUEL E	13-9-42
J5	ROUSE PENNY L - TOD	13-9-43
K5	EAGLE LTD	13-9-30.1
L5	PHILLIPS JANET M	13-9-32.6
M5	PHILLIPS JANET M	13-9-32.8
N5	WRIGHT DAVID JAMES	13-9-32.4
O5	CRAKE ROBERT J SHELLEY S	13-9-32.7
P5	CRAKE ROBERT J SHELLEY S	13-9-32.3
Q5	BIXBY LINDA L	13-9-32.2
R5	EAGLE LTD	13-9-32.1
S5	CHAMBERS ROBIN L & DENICE E	13-9-32.2
T5	CHAMBERS ROBIN L & DENICE E	13-9-33.1
U5	MILLER KENNETH LEE - TOD	13-9-33
V5	SCHABER LESLIE B & LORI D	13-13-10
W5	SIBURT ERIC R &	13-13A-1
X5	STURGILL JULIE L & JOE D	13-10-24
Y5	METS PROPERTIES LLC	13-10-24.1
Z5	SCHABER LESLIE B & LORI D	13-13-10.1
A6	MARSH DAVID A ET UX	13-10-28
B6	THORN RONNIE L & BETH A	13-10-30.1
C6	ELLIOTT GLENN F	13-10-30
D6	MERINAR KENNETH LEE ET UX	13-10-21.6
E6	SHAW SIDNEY S & ROBIN MARIE	13-108-1
F6	SHAW SIDNEY S & ROBIN MARIE	13-108-2
G6	WISE CLARA L	13-10-18
H6	CARTER KELLY J	13-10-19
I6	CARTER KELLY J	13-10-20
J6	CARTER KELLY J	13-10-15.1
K6	WALTON DANIEL JR & THERESA	13-8-17
L6	WALTON DANIEL JR & THERESA	13-8-18
M6	MCCOMBS THOMAS E & BETH E	13-8-19
N6	PRESBYTERIAN CHURCH	13-8-20
O6	ALLEN GROVE PRESBYTERIAN CHURCH	13-8-15.1
P6	KAHLNAUGH DAVID W & DELORES	13-7-24
Q6	HIERONIMUS C KEITH ET UX	13-7A-23
R6	SHEPPARD CEMETERY	13-7A-22
S6	JOHNSON GILBERT	13-7A-3
T6	MCCOMBS THOMAS E & BETH E - TOD	13-8-16
U6	PATTERSON DANIEL & MICHELLE	13-7-22
V6	MCLAUGHLIN SHAWN & ELIZABETH	13-7-23
W6	PERRY JOSEPH P JR	13-7-24
X6	THORN JACLYN A & JASON K	13-8-25
Y6	SBERNA JOSEPH L JR & TAMMY	13-7E-1
Z6	SBERNA JOSEPH L JR & TAMMY	13-7E-2
A7	CRAWFORD GARY J	13-7E-7
B7	JOSEPH WILLIAM F & SUSAN L	13-7E-8
C7	CAIN ROGER L II	13-7E-10
D7	MCCLINTOCK JOSIE & LARRY	13-7-22.4
E7	SHEPHERD JAMES LEE II	13-7-23
F7	REINBEAU DAVID W & SHELLY A	13-7-22.3
G7	REINBEAU DAVID W & SHELLY A	13-7-21.1
H7	BOWMAN MICHAEL ET UX	13-8-28
I7	BOWMAN MICHAEL J & CONSTANCE G	13-7-21
J7	ALEXANDER LORRAINE	13-7-20
K7	ALEXANDER LORRAINE	13-7-18.1
L7	ALEXANDER LORRAINE	13-7-18

47-05106/23/2023

REVISIONS:	COMPANY:	 	
	OPERATOR'S	DAVID REINBEAU MSH	DATE: 03-14-2023
	WELL #:	206H	DRAWN BY: J. COCKERHAM
	DISTRICT:	COUNTY:	STATE:
	UNION	MARSHALL	WV
			SCALE: N/A
			DRAWING NO:
			WELL LOCATION PLAT 4