

39°50'00"

Latitude

80°35'00"

Longitude

2.27s
1.13w

Topo Location

7.5' Loc. _____ 15' Loc. _____
(calc.) _____

Company Manufact Lt+Ht
Farm Wellington Hrs #1098
15' Quad _____
(sec.)
7.5' Quad Cameron
District Liberty

WELL LOCATION PLAT

County OSI Permit 30025

Liberty Dist

Plugging Affidavit
JUNE 1, 1933

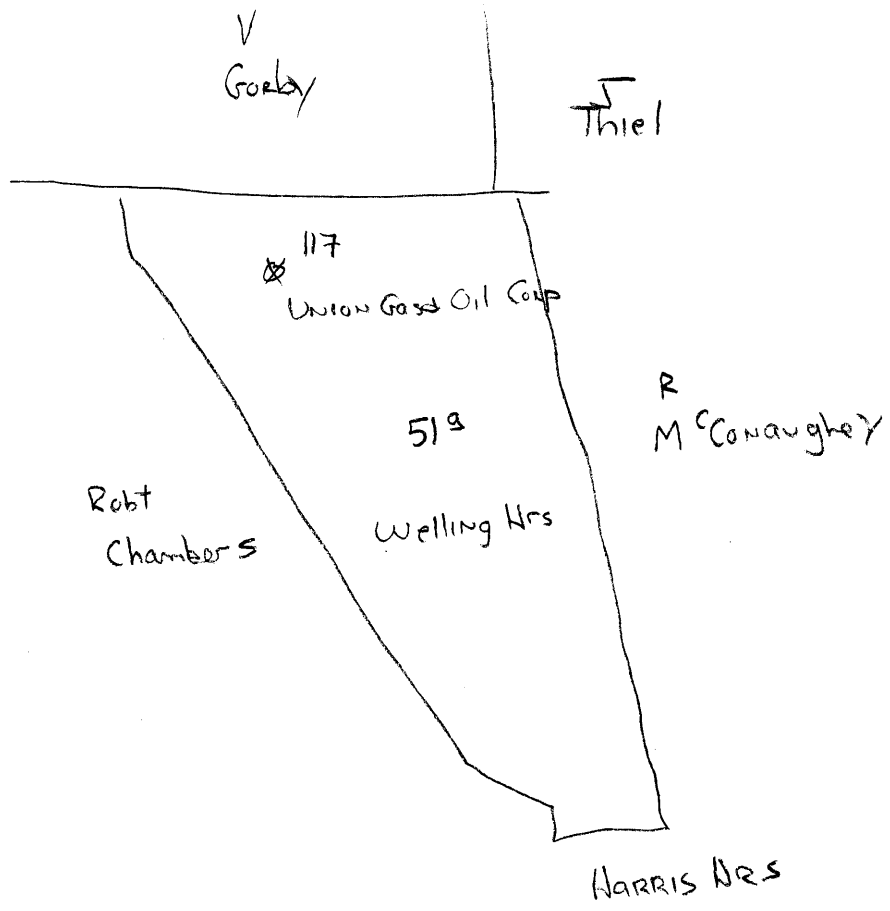

Marsh 25A

WELLING HEIRS NO. 1098 (MLH) 117 (UGO) WELL.

No. 90 O.F.-Marshall

Liberty District, Marshall County, W. Va.
 Manufacturers Light & Heat Co., 800 Union Tr. Bldg., Pittsburgh, Pa.
 On 251 acres, surface owned by Welling Heirs, Spencer Welling,
 RD 1, West Alexander, Pa., and mineral rights by ML&H Co.,
 Pittsburgh, Pa.

Drilled prior to June 1, 1929.

Elevation, 1160'.

18' conductor; 13" casing, 167'; 10", 1400'; 8", 1673'; 6-5/8", 2330'.

Coal was encountered at 883 and 980'.

Abandonment reported to Dept. of Mines Jan. 12, 1933.

Well was shot at 654, 1486, and 3005'.

All 13", 10", and 8" casing pulled out.

March 3, 1902, shot with 73 qts.; shell 2' from top of sand;
 made good flow. (Bluff Sand).

MAAS-25-A

	Top.	Bottom.
Conductor	0	18
13" casing		167
Bluff Sand (gas)	654	
Mapletown Coal	883	
Pittsburgh Coal	980	
Murphy Sand	1108	
13" hole		1400
10" casing		1400 Dec. 17, 1909.
Big Dunkard Sand	1486	
Gas Sand	1663	
8" casing		1673
Salt Sand (dry)	1851	
Maxton Sand	2048	
Big Lime	2097	
Big Injun Sand	2147	
6-5/8" casing		2330
Through Big Injun Sand		2415
Stray Sand (SLM)	2967	
Through Stray Sand		2978
Gordon Sand (little oil) (best pay at 3010')	3004	
Total depth		3023

Handwritten calculations:
 2447
 654

 1793
 920
 654

 264
 1160
 654

 506