

39°47'30"

Latitude

80°32'30"

Longitude

1.12s
1.08w

Topo Location

7.5' Loc. _____ 15' Loc. _____
(calc.) _____

Company Manufact Lt & Lt

Farm JE McBeary #1-2470

15' Quad _____
(sec.)

7.5' Quad Cameron

District Liberty

WELL LOCATION PLAT

County OSI Permit 30342

Liberty

39° 50' 18"

80° 30'

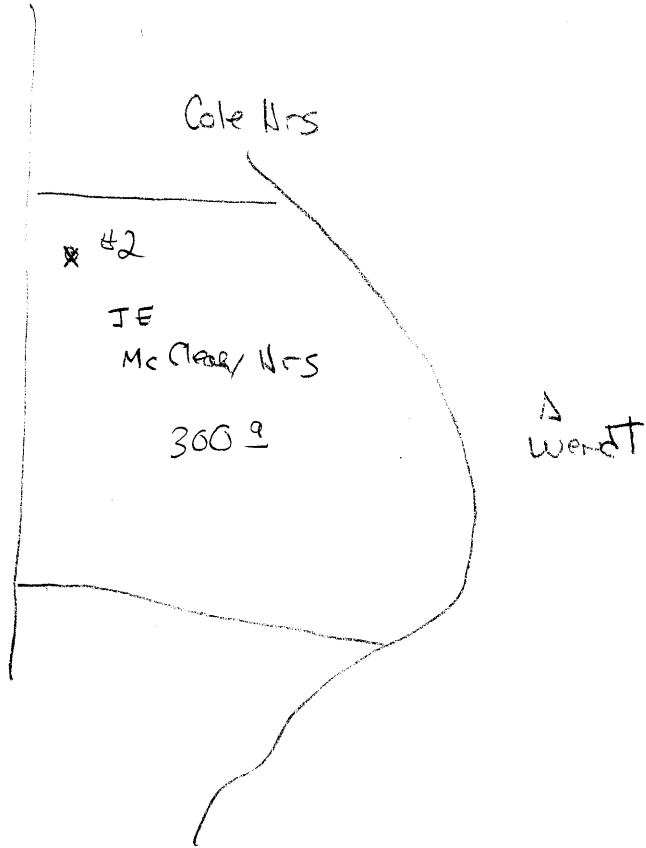

3034 2

J. E. AND GRACE McCLEARY NO. 1 (2470) WELL.

348 R

Liberty District, Marshall County, W. Va.

By The Manufacturers Light & Heat Co., 800 Union Trust Bldg., Pittsburgh, Pa.

Abandoned under permit Mars-.....-A?

On 300 acres.

Elevation,' L.

Surface owned by Gordon Land Co. and Grace McCleary et al., and minerals by

The Manufacturers Light & Heat Co., 800 Union Trust Bldg., Pittsburgh, Pa.

Drilling commenced Oct. 13, 1919; completed Dec. 9, 1919.

10" casing, 285'; 8 $\frac{1}{2}$ " 1290 (910' left in); 6 $\frac{3}{4}$ " 2030'.

Coal was encountered at 864-872'.

Gas well. Record to Dept. of Mines dated Oct. 12, 1951.

Record to NCE from Mrs. Griffith Feb. 11, 1953. O.F.No.406.

	Top.	Bottom.
Pittsburgh Coal	864	- 872
Little Dunkard Sand	1280	- 1320
Big Dunkard Sand	1360	- 1400
Gas Sand	1530	- 1575
1st Salt Sand	1680	- 1740
2nd Salt Sand	1870	- 1945
Marton Sand	1975	- 1985
Big Lime	2040	- 2100
Big Injun Sand (gas, 2115-2130')	2100	- 2350
Gordon Stray Sand	2844	- 2860
Gordon Sand	2910	- 2921
Fourth Sand (show of gas, 2971')	2970	- 2978
Total depth		3150



STATE OF WEST VIRGINIA
DEPARTMENT OF MINES
OIL AND GAS DIVISION

406

WELL RECORD

Permit No. MAAS - 342-A Oil or Gas Well _____ (KIND)

Company The Mfrs. Light & Heat Company
 Address 800 Union Trust Bldg., Pittsburgh, Pa.
 Farm J. E. & Wm. McCleary Acres 300
 Location (waters) _____
 Well No. 1-2470 Elev. _____
 District Liberty County Marshall
 The surface of tract is owned in fee by Gordon Land Co. and Grace McCleary, et al Address _____
 Mineral rights are owned by The Mfrs. Light & Heat Co.
800 Union Trust Bldg. Address Pittsburgh, Pa.
 Drilling commenced October 13, 1919
 Drilling completed December 9, 1919
 Date Shot _____ From _____ To _____
 With _____
 Open Flow _____ /10ths Water in _____ Inch
 _____ /10ths Merc. in _____ Inch
 Volume _____ Cu. Ft.
 Rock Pressure _____ lbs. _____ hrs.
 Oil _____ bbls., 1st 24 hrs.
 Fresh water _____ feet _____ feet
 Salt water _____ feet _____ feet

Casing and Tubing	Used in Drilling	Left in Well	Packers
Size			Kind of Packer
16			
13			
10	285	285	Size of
8 3/4	1290	9.10	
6 5/8	2030	2030	Depth set
5 3/16			
3			Perf. top
2			Perf. bottom
Liners Used			Perf. top
			Perf. bottom

CASING CEMENTED _____ SIZE _____ No. Ft. _____ Date _____

COAL WAS ENCOUNTERED AT 864 FEET 96 INCHES
 _____ FEET _____ INCHES _____ FEET _____ INCHES
 _____ FEET _____ INCHES _____ FEET _____ INCHES

Formation	Color	Hard or Soft	Top	Bottom	Oil, Gas or Water	Depth Found	Remarks
Pittsburgh Coal			864	872			
Little Dunkard			1280	1320			
Big Dunkard			1360	1400			
Gas Sand			1530	1575			
1st. Salt Sand			1680	1740			
2nd. Salt Sand			1870	1945			
Maxim			1975	1985			
Big Lime			2040	2100			
Big Indian			2100	2350	Gas 2115 to 2130.		
Gordon Stray Sand			2844	2860			
Gordon Sand			2910	2921			
Fourth Sand			2970	2978	Show of gas 2971'.		
TOTAL DEPTH			3150				

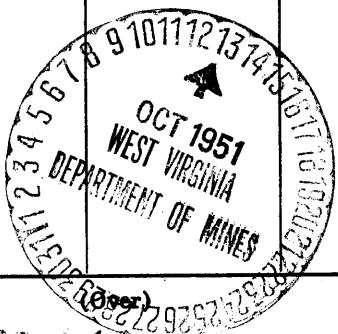

FEB 11 1951

Formation	Color	Hard or Soft	Top	Bottom	Oil, Gas or Water	Depth Found	Remarks

Date OCTOBER 12, 19 51

APPROVED THE MANUFACTURERS LIGHT & HEAT CO., Owner

By *[Signature]* ASST. LAND AGENT.

X3881