

LATITUDE 37° 27' 30"

LONGITUDE 91° 53' 18"

WITHIN CIRCLE

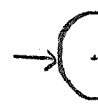

7'5 OGIS topo location

7.5' loc	<u>1.795</u>	15' loc	<u>4.675</u>
	<u>0.10 W</u>	(calc.)	<u>0.10 W</u>

Company _____

Farm _____

Quad WELCH 7 1/2' + 15' NC

County Mc DOWELL

District BROWNS CREEK

WELL LOCATION MAP

File No. 047-0004

Alta Maps Christodoulou

OPERATOR U.S.G.S. Elev Surf At Well = 1285

Depth of Well = 652

PLAT OF GAS WELL LOCATION

CITY OF WELCH, BROWNS CREEK DISTRICT

MCDOWELL CO. WEST VA

Scale 1"=200' October 12, 1934 L.A. Osborn City Engr.

Well Location Shown

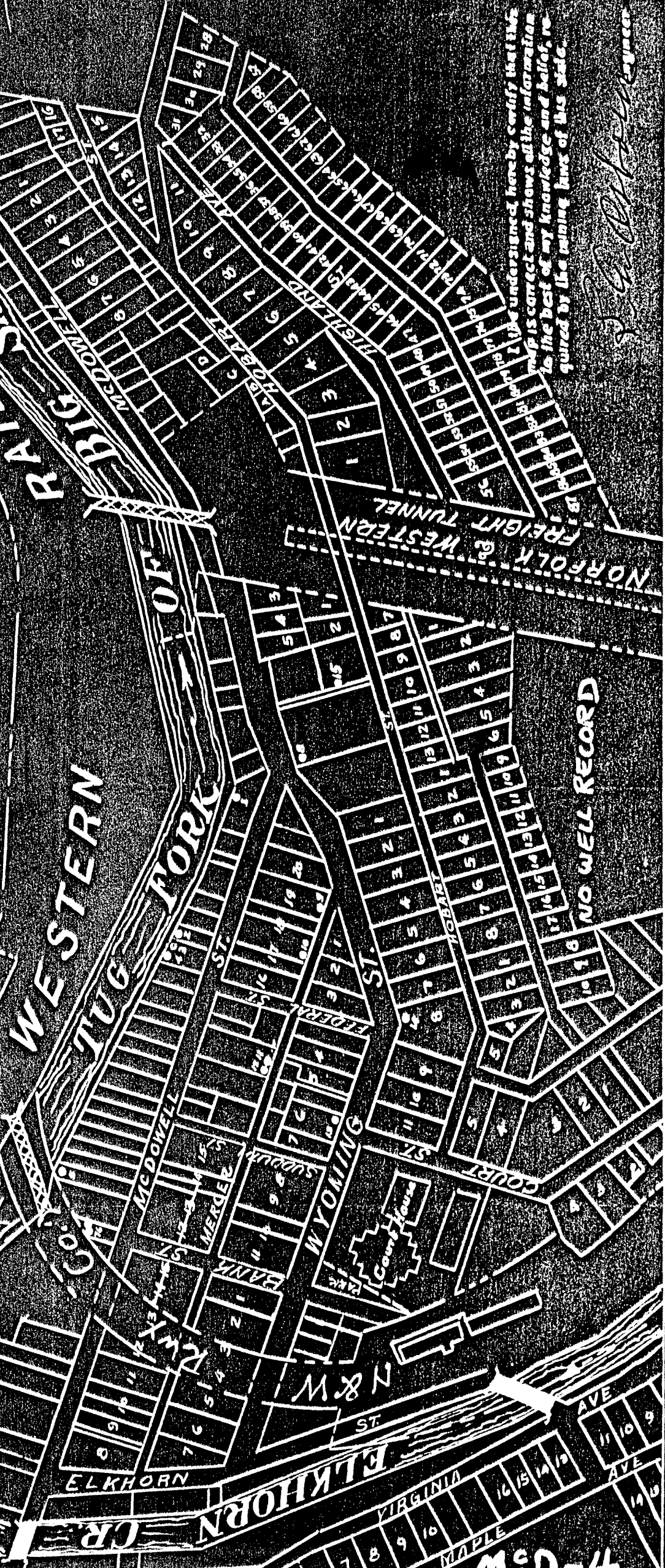

NO WELL RECORD

I, the undersigned, hereby certify that this map is correct and shows all the information to the best of my knowledge and belief, required by the mining laws of this state.

L.A. Osborn
City Engineer

4-CW-4

CITY OF WELCH No. 3 -

McD-4.

By Alcibiades Christodaulow?

Browns Creek Dist.

(NO PERMIT)