

LATITUDE 37° 27' 30"

81° 35' 00"

LONGITUDE

WITHIN CIRCLE



7'5 OGIS topo location

7.5' loc 1.785  
0.10 W

15' loc 4.665  
(calc.) 0.10 W

Company \_\_\_\_\_

Farm \_\_\_\_\_

Quad WELCH 7 1/2' DIS'NC

County Mc DOWELL

District BROWNS CREEK

WELL LOCATION MAP

File No. 047-005

U.S. Geological Survey

1285

OPERATOR USGS. Elev Surf At Well =  
PLAT OF GAS WELL LOCATION Depth of Well =

CITY OF WELCH, BROWNS CREEK DISTRICT  
MCDOWELL CO. WEST VA  
NORFOLK & WESTERN RAILROAD CO.

Scale 1:200  
October 28, 1904  
Well Location Shown

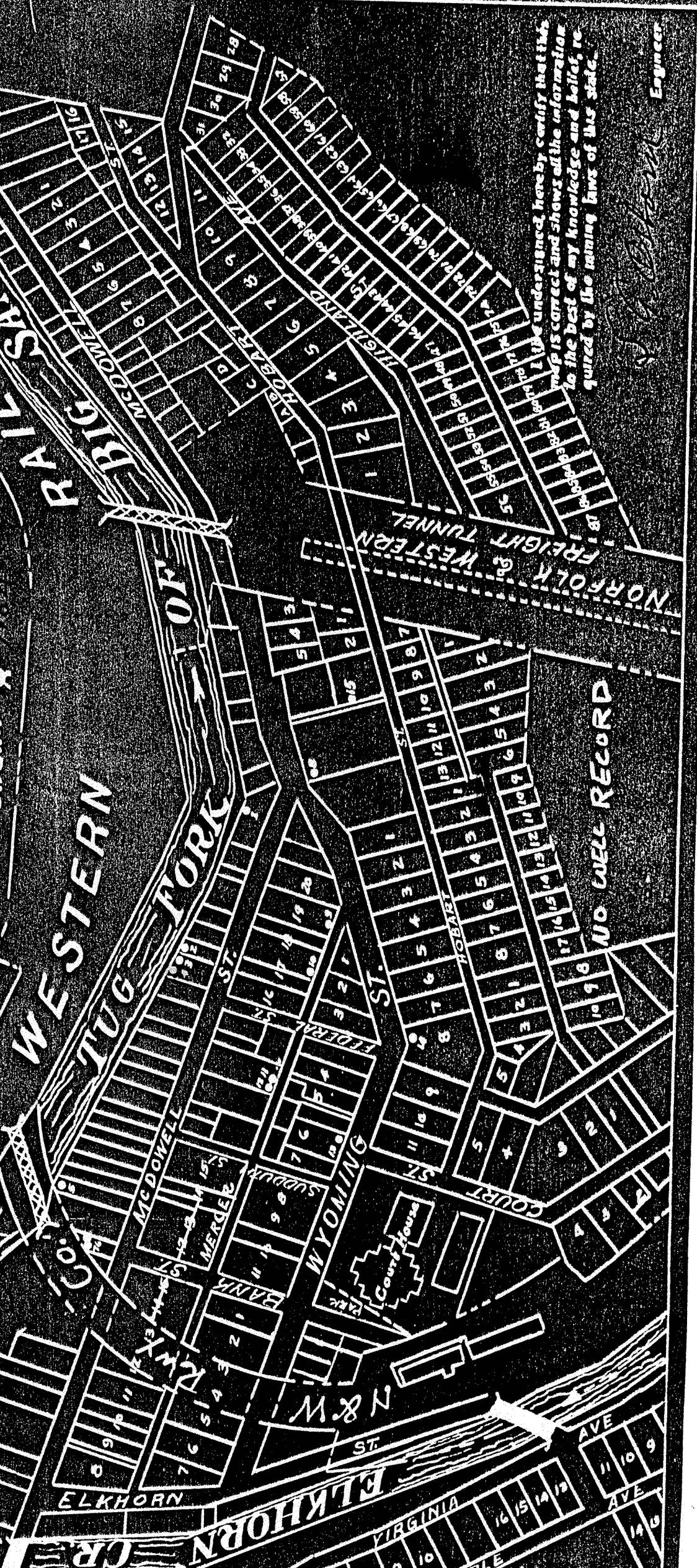

I, the undersigned, hereby certify that this map is correct and shows all the information to the best of my knowledge and belief, required by the mining laws of this State.

Engineer

NO WELL RECORD

M.D. 5

CITY OF WELCH NO. 4.

McD-5.

By Alcibiades Christodoulow?

Browns Creek Dist.

(NO PERMIT)