

LATITUDE 37° 27' 30"

9° 35' 00"

LONGITUDE

WITHIN CIRCLE



7'5 OGIS topo location

7.5' loc 1.79 S
0.09 W

15' loc _____
(calc.) _____

Company _____

Farm _____

Quad WELCH 7 1/2' + Ne

County Mc DOWELL

District BROWNS CREEK

WELL LOCATION MAP

File No. 047-100

Tr. 1/2 Sec. 7, T. 24 N., R. 10 W.,
W. Va.

OPERATOR USGS Elev. Surf. At Well 1296.3
Depth of Well 528.2

PLAT OF GAS WEAIR LOCATION
CITY OF WELCH, BROWNS CREEK DISTRICT
MCDOWELL CO. WEST VA

Scale 1" = 200' October 1917
WELL Location Shown * NO. 9

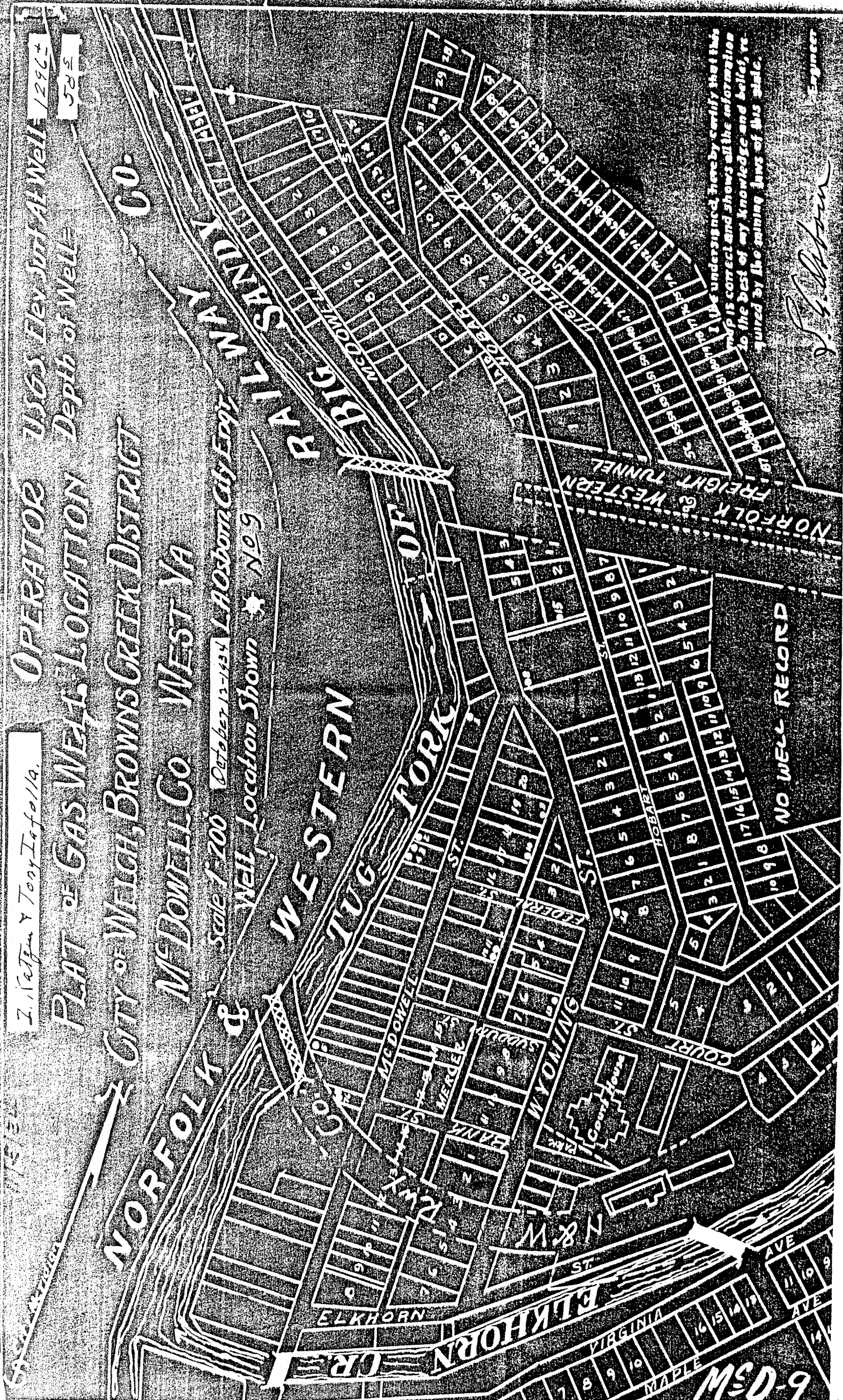

I have read the above and certify that the map is correct and shows all the information to the best of my knowledge and belief, required by the mining laws of this State.

J. S. Johnson
Engineer

NO WELL RECORD

6-05M

CITY OF WELCH NO. 9.

McD-9.

By J. Katzer & Tony Isafalla.

Browns Creek Dist.

(NO PERMIT)