

LATITUDE 37° 27' 30"

LONGITUDE 91° 35' 00"



7'5 OGIS topo location

7.5' loc	<u>1.40 S</u>	15' loc	<u>4.28 S</u>
	<u>0.32 W</u>	(calc.)	<u>0.32 W</u>

Company _____

Farm _____

Quad WELCH 7 1/2' x 15' N

County McDOWELL

District BROWNS CREEK

WELL LOCATION MAP

File No. 047-1015

~~CONSULTING~~ OPERATOR

PLAT OF GAS WELL LOCATION

CITY OF WELCH BROWNS CREEK DISTRICT

MCDOWELL CO. WEST VA.

Scale of 100' November 1st 1934

L.A. Osborn City Engr

Well Location Shown by No. ~~15~~

ET. WELL ~~100'~~

Depth ~~100'~~

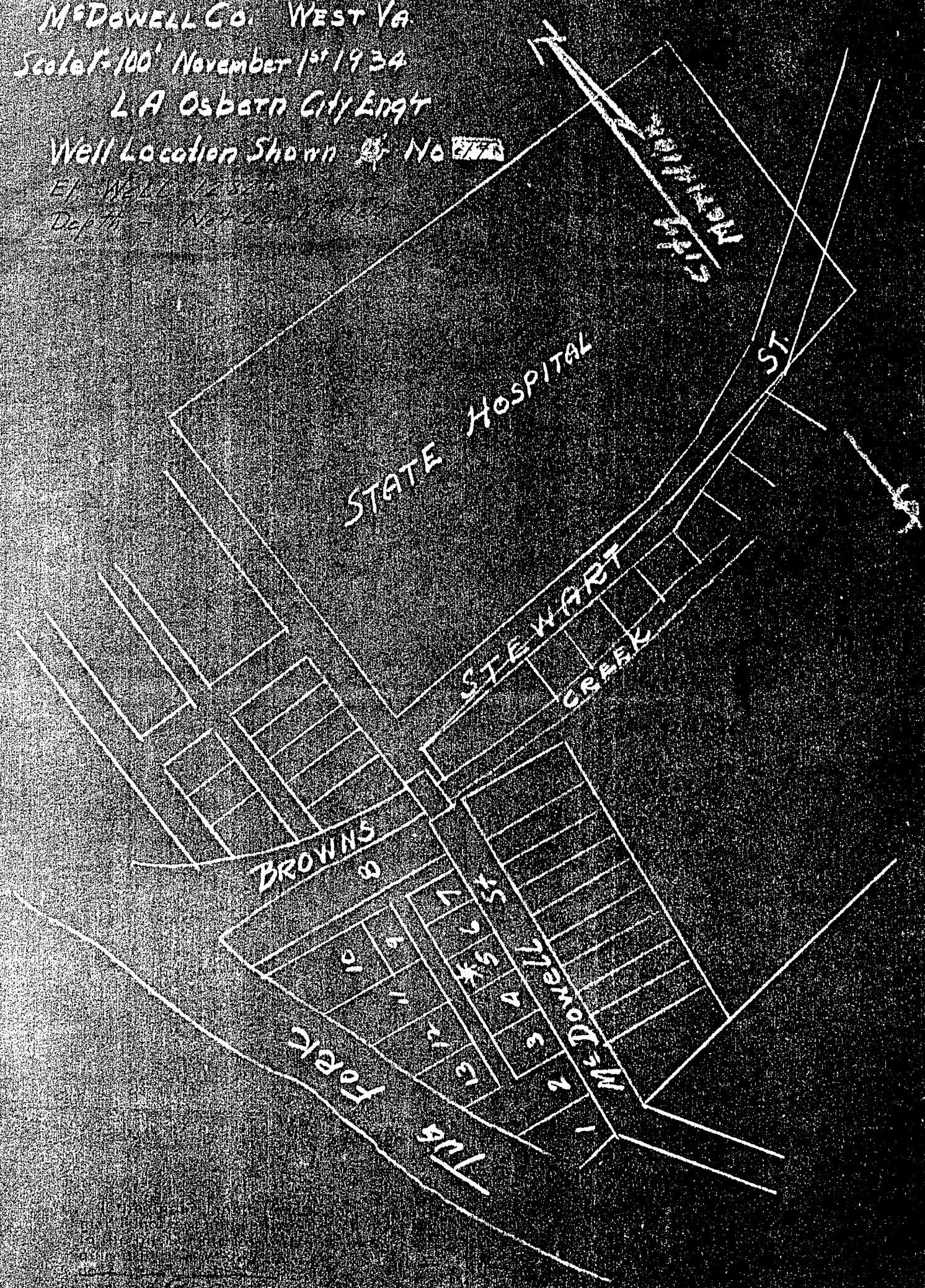

NO WELL RECORD

MCD-15

CITY OF WELCH NO. 17.

McD-15.

By O. S. Conner.

Browns Creek Dist.

(NO PERMIT)