

LATITUDE 37° 27' 30"

81° 35' 00"

LONGITUDE

WITHIN CIRCLE



T'S OGIS topo location

7.5' loc 1.78 S 15' loc _____
 0.12 W (calc.) _____

Company _____

Farm _____

Quad WELCH 7 1/2'

County Mc DOWELL

District BROWNS CREEK

WELL LOCATION MAP

File No. 047-0021

W. G. Shaw

1340
72

OPERATOR USGS ELEV SURF AT WELL
PLAT OF GAS WELL LOCATION Depth of Well

CITY OF WELCH, BROWNS CREEK DISTRICT
McDOWELL CO WEST VA
NORFOLK & WESTERN RAILWAY COMPANY

Scale 1:200
LA Osborn City Engr
Well Location Shown

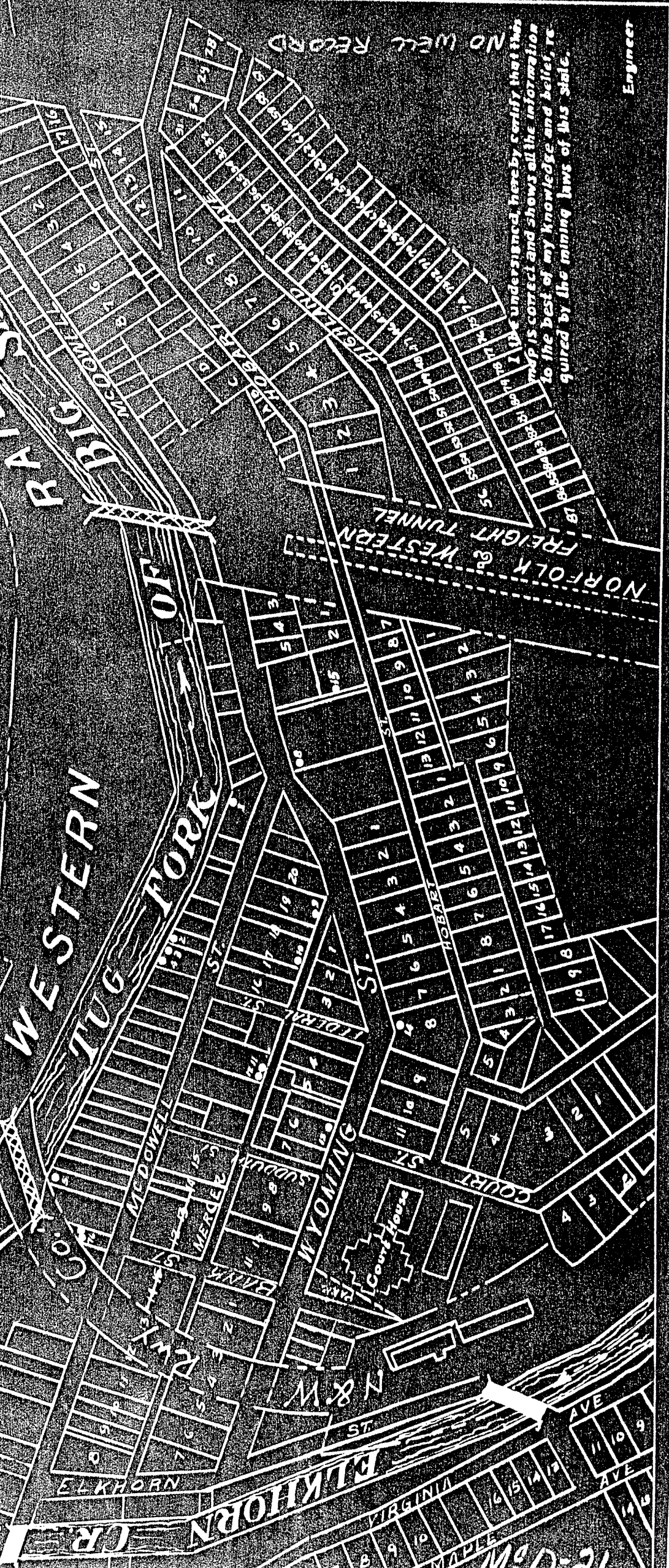

NO WELL RECORD

I the undersigned, hereby certify that this map is correct and shows all the information to the best of my knowledge and belief, required by the mining laws of this State.

Engineer

CITY OF WELCH NO. 17.

McD-21.

By Vivian A. Shaw.

Browns Creek Dist.

(NO PERMIT)