

Latitude

39 17 30

81.25

Longitude

OGIS  
→ 7.5' loc  
Kla 7/20/1999  
2.5'S  
1.5' W

Topo Location

7.5' Loc. \_\_\_\_\_ 15' Loc. 5.39S  
\_\_\_\_\_ (calc.) 1.51W

Company \_\_\_\_\_

Farm \_\_\_\_\_

15' Quad Welch se  
(sec.) \_\_\_\_\_

7.5' Quad Gary  
\_\_\_\_\_

District \_\_\_\_\_

WELL LOCATION PLAT

County 047 Permit 31

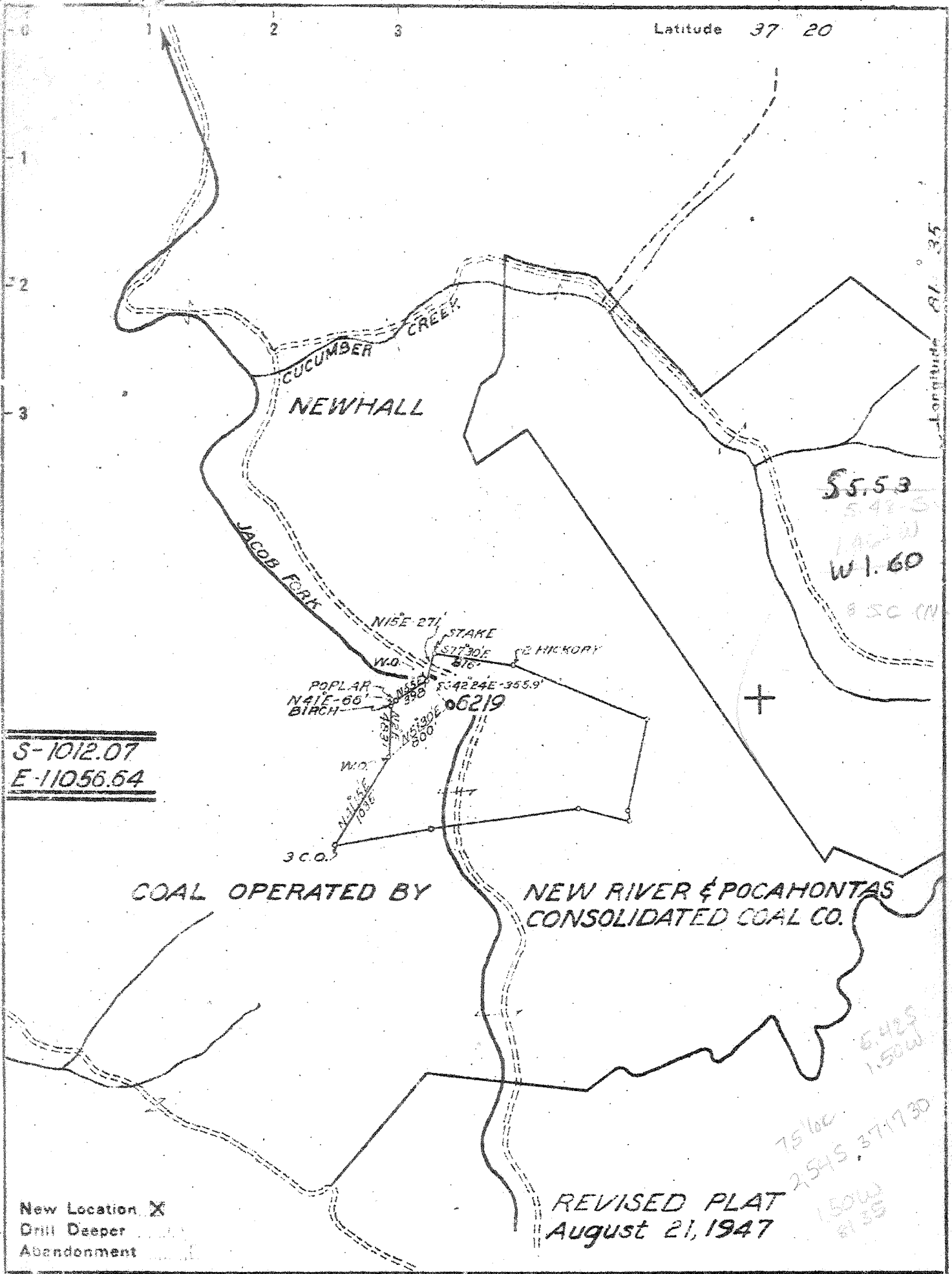

S-1012.07  
E-11056.64

COAL OPERATED BY **NEW RIVER & POCAHONTAS CONSOLIDATED COAL CO.**

REVISED PLAT  
August 21, 1947

New Location  X  
Drill Deeper   
Abandonment

Company	UNITED FUEL GAS CO.
Address	CHARLESTON, W. VA. NEW RIVER & POCAHONTAS CONSOLIDATED COAL CO.
Tract	Acres 230.44 Lease No. 45459
Well (Farm) No.	1 Serial No. 6219
Elevation (Spirit Level)	1627.16'
Quadrangle	WELCH - SC
County	MCDOWELL District BIG CREEK
Engineer	[Signature]
Engineer's Registration No.	662
File No.	62-393 Drawing No.
Date	AUGUST 4 1947 Scale 1"=1320'

STATE OF WEST VIRGINIA  
DEPARTMENT OF MINES  
OIL AND GAS DIVISION  
CHARLESTON

WELL LOCATION MAP  
FILE NO. McD-31

+ Denotes location of well on United States Topographic Maps, scale 1 to 62,500. latitude and longitude lines being represented by border lines as shown.  
- Denotes one inch spaces on border line of original tracing.

5-0-0

WEST VIRGINIA DEPARTMENT OF MINES  
OIL & GAS DIVISION  
W E L L R E C O R D

Page One (1)

Dry Hole  
CASING & TUBING

Permit No. Mcd 31 P

Welch Quad.

Company

Address

Farm

Location

Well No.

District

Surface

Mineral

United Fuel Gas Co.

P.O. Box 1273, Charleston 25, W.Va. 20

New River and Pocahontas Con. Coal Co. 16

Jacobs Fork Acres 23044

6219 Elev. 1627.16 Gr.

Big Creek McDowell

30 30

16 258 258

12 1155 1155

10 2460 2460

7 6426 6426

New River & Pocahontas Con. Coal Co.

1100 Commercial Trust Bldg., Phila., Penna.

10-11-47

1-19-49

Commenced

Completed

Not shot

Volume

Water

Dry Hole

350' 1 BMH

ABANDONMENT

Sand & Gravel	0	19	Blue Slate	2060	2173
Quicksand	19	25	Lime	2173	2179
Blud Mud	25	35	Slate	2179	2207
Gray Lime	35	65	Lime	2207	2220
Slate	65	69	Slate	2220	2225
Gray Lime	69	142	Lime	2225	2303
Red Rock	142	146	Slate	2303	2308
Lime	146	200	Lime	2308	2328
Red Lime	200	251	Slate	2328	2380
Lime	251	312	Lime	2380	2423
Slate	312	350	Red Rock	2423	2438
Lime	350	370	Slate	2438	2569
Slate	370	420	Red Lime	2569	2575
Lime	420	438	Lime	2575	2750
Slate	438	450	White Lime	2750	2770
Lime	450	465	Lime	2770	3235
Shale	465	660	Slate & Shells	3235	3263
Lime	660	746	Red Lime	3263	3295
Shale	746	775	Slate & Shells	3295	3395
Lime	775	828	Sandy Lime	3395	3520
Slate & Shells	828	855	Slate & Shells	3520	3834
Lime	855	875	Lime	3834	3832
Slate	875	878	Slate	3852	3880
Lime	878	905	Shale	3880	3892
Slate	905	935	Black Lime	3892	3902
Lime	935	985	Berea	3902	3928
Red Rock	985	1148	Slate	3928	3938
Slate	1148	1162	Lime	3938	4016
Lime	1162	1158	Blue Slate	4016	4020
Red Rock	1158	1180	Lime	4020	4195
Red Lime	1180	1200	Slate & Shells	4195	4890
Slate	1200	1215	Black Lime	4890	5032
Red Lime	1215	1350	Slate & Shells, Lime Sl. & Shs.	5032	5275
Blue Lime	1350	1543	Br. Shale	5275	5430
Lime	1543	1585	Slate & Shells	5430	5670
Sand	1585	1660	Black Lime	5670	5778
Lime	1660	1695	Slate, Lime Shells	5780	5810
Red Lime	1695	1705	Dark Slate	5810	6268
Lime	1705	1715	Lime Shells	6268	6274
Slate	1715	1765	Dark Slate	6274	6288
Sand	1765	1780	Broken Lime, Dark	6288	6318
Red Lime	1780	1800	Slate, Break	6318	6418
Slate	1800	1840	Corniferous	6418	6458
Lime	1840	1850	Siltstone, Chert Limey	6458	6468
Slate & Shells	1830	1900	Oriskany,	6468	6478
Black Lime	1900	1945	Lime & Chert, Sandy	6478	6490
Slate & Shells	1945	1980	Sand	6490	6517
Lime	1980	2010	Lime	6517	6680
Slate	2010	2020	Bloomsburg Sand (Newburg)	6680	6688
Lime	2020	2033	Limestone & Dolomite	6688	7043
Gray Sand	2033	2041	Siltstone	7043	7059
Blue Slate	2041	2045	Big Six Sand	7059	7089
Lime	2045	2047	Gray Dolomitic, Siltstone	7089	7132
Sand	2047	2060	Red & Gray Siltstone, Shale	7132	7207

6680  
1627  
5053

— open  
6469  
712

Con't on page two(2)

WEST VIRGINIA DEPARTMENT OF MINES  
OIL & GAS DIVISION  
WELL RECORD

Page Two (2)

Permit No. MED 31 P  
Welch Quad.  
Company  
Address  
Farm  
Well No.

Dry Hole

United Fuel Gas Co.  
P.O. Box 1273, Charleston 25, W.Va.  
New River and Pocahontas Con. Coal Co.  
6219 Elev. 1627.16 Gr.

Pink Shell	7207	7215
Slate & Shell	7215	7256
Red Sand	7256	7264
Slate	7264	7268
Sand	7268	7276
Total depth		7276

Oil 7259' Scum  
Gas 453' show

565

Not to White Medina  
Short 150'

5432  
1627  

---

7059

7426  
1627  

---

5799

7276

6418  
1627  

---

4791



STATE OF WEST VIRGINIA  
DEPARTMENT OF MINES  
OIL AND GAS DIVISION

W. Va.

WELL RECORD

Oil or Gas Well Dry Hole  
(KIND)

Permit No. McD-31-P

ABANDONMENT

Company United Fuel Gas Co.  
 Address P. O. Box 1273, Charleston 25, W. Va.  
 Farm New River & Pocahontas Con. Coal Co. Acres 230/44  
 Location (waters) Jacobs Fork  
 Well No. 6219 Elev. 1627.16 Gr.  
 District Big Creek County McDowell  
 The surface of tract is owned in fee by \_\_\_\_\_  
 Mineral rights are owned by New River & Pocahontas Consolidated Coal Co.  
1100 Commercial Trust Address Phila, Penna.  
 Bldg. 10-11-47  
 Drilling commenced 1-19-49  
 Drilling completed \_\_\_\_\_  
 Date Shot Not Shot From \_\_\_\_\_ To \_\_\_\_\_  
 With \_\_\_\_\_

Casing and Tubing	Used in Drilling	Left in Well	Packers
Size			
20	30'	30'	Kind of Packer
18	258	258	
13 1/2	1155	1155	Size of
10	2460	2460	
7	6426	6426	Depth set
6 1/2			
5 3/16			Perf. top
3			
2			Perf. bottom
Liners Used			
			Perf. top
			Perf. bottom

Open Flow /10ths Water in \_\_\_\_\_ Inch  
 \_\_\_\_\_ /10ths Merc. in \_\_\_\_\_ Inch  
 Volume Dry Hole \_\_\_\_\_ Cu. Ft.  
 Rock Pressure \_\_\_\_\_ lbs. \_\_\_\_\_ hrs.  
 Oil \_\_\_\_\_ bbls., 1st 24 hrs.  
 Fresh water 350 feet \_\_\_\_\_ feet  
 Salt water \_\_\_\_\_ feet \_\_\_\_\_ feet

CASING CEMENTED \_\_\_\_\_ SIZE \_\_\_\_\_ No. Ft. \_\_\_\_\_  
 COAL WAS ENCOUNTERED AT \_\_\_\_\_ FEET \_\_\_\_\_ INCH  
 \_\_\_\_\_ FEET \_\_\_\_\_ INCHES \_\_\_\_\_ FEET \_\_\_\_\_ INCH  
 \_\_\_\_\_ FEET \_\_\_\_\_ INCHES \_\_\_\_\_ FEET \_\_\_\_\_ INCH

Formation	Color	Hard or Soft	Top	Bottom	Oil, Gas or Water	Depth Found	Remarks
Sand & Gravel			0	19			
Quicksand			19	25			
Blue Mud			25	35			
Gray Lime			35	65			
Slate			65	69			
Gray Lime			69	142			
Red Rock			142	146			
Lime			146	200			
Red Lime			200	251			
Lime			251	312			
Slate			312	350	Water	350'	1 B.P.H.
Lime			350	370			
Slate			370	420			
Lime			420	438			
Slate			438	450	Gas	453'	Show.
Lime			450	465			
Shale			465	660			
Lime			660	746			
Shale			746	775			
Lime			775	828			
Slate & Shells			828	855			
Lime			855	875			
Slate			875	878			
Lime			878	905			
Slate			905	935			
Lime			935	985			
Red Rock			985	1148			
Slate			1148	1152			
Lime			1152	1158			
Red Rock			1158	1180			
Red Lime			1180	1200			
Slate			1200	1215			
Red Lime			1215	1350			
Blue Lime			1350	1543			
Lime			1543	1585			
Sand			1585	1660			
Lime			1660	1695			
Red Lime			1695	1705			

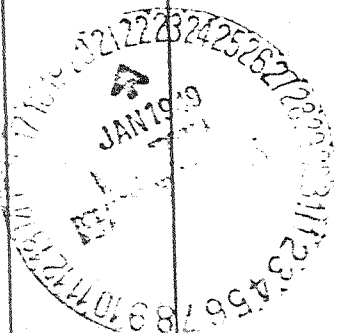

Formation	Color	Hard or Soft	Top	Bottom	Oil, Gas or Water	Depth Found	Remarks
Lime			1705	1715			
Slate			1715	1765			
Sand			1765	1780			
Red Lime			1780	1800			
Slate			1800	1840			
Lime			1840	1850			
Slate & Shells			1850	1900			
Black Lime			1900	1945			
Slate & Shells			1945	1980			
Lime			1980	2010			
Slate			2010	2020			
Lime			2020	2033			
Gray Sand			2033	2041			
Blue Slate			2041	2045			
Lime			2045	2047			
Sand			2047	2060			
Blue Slate			2060	2173			
Lime			2173	2179			
Slate			2179	2207			
Lime			2207	2220			
Slate			2220	2225			
Lime			2225	2303			
Slate			2303	2308			
Lime			2308	2328			
Slate			2328	2380			
Lime			2380	2423			
Red Rock			2423	2438			
Slate			2438	2569			
Red Lime			2569	2575			
Lime			2575	2750			
White Lime			2750	2770			
Lime			2770	3235			
Slate & Shells			3235	3263			
Red Lime			3263	3295			
Slate & Shells			3295	3395			
Sandy Lime			3395	3520			
Slate & Shells			3520	3834			
Lime			3834	3852			
Slate			3852	3880			
Shale			3880	3892			
Black Lime			3892	3902	Gas	3913-3917	Show.
Bersa			3902	3928			
Slate			3928	3938			
Lime			3938	4016			
Blue Slate			4016	4020			
Lime			4020	4195			
Slate & Shells			4195	4890			
Black Lime			4890	5032			
Slate & Shells			5032	5070			
Lime			5070	5115			
Slate & Shells			5115	5275			
Br. Shale			5275	5430			
Slate & Shells			5430	5670			
Black Lime			5670	5778			
Slate			5778	5780			
Lime Shells			5780	5810			
Dark Slate			5810	6268			
Lime Shells			6268	6274			
Dark Slate			6274	6288			
Broken Lime, Dark			6288	6318			
Slate, Break			6318	6418			
Corniferous			6418	6458			
Siltstone, Chert Limey			6458	6468			
Oriskany			6468	6478			
Lime & Chert, Sandy			6478	6490			
Sand			6490	6517			
Lime			6517	6680			
Bloomsburg Sand			6680	6688			
Limestone & Dolomite			6688	7043			

Date January 20, 191

APPROVED United Fuel Gas Co., Ov

By Y. H. Moore  
Chief Engineer (Title) R.



STATE OF WEST VIRGINIA  
DEPARTMENT OF MINES  
OIL AND GAS DIVISION

WELL RECORD

Oil or Gas Well dry hole  
(KIND)

Permit No. MED-31-P

Company \_\_\_\_\_  
 Address \_\_\_\_\_  
 Farm \_\_\_\_\_ Acres \_\_\_\_\_  
 Location (waters) \_\_\_\_\_  
 Well No. 6219 Elev. \_\_\_\_\_  
 District \_\_\_\_\_ County \_\_\_\_\_  
 The surface of tract is owned in fee by \_\_\_\_\_  
 Address \_\_\_\_\_  
 Mineral rights are owned by \_\_\_\_\_  
 Address \_\_\_\_\_  
 Drilling commenced \_\_\_\_\_  
 Drilling completed \_\_\_\_\_  
 Date Shot \_\_\_\_\_ From \_\_\_\_\_ To \_\_\_\_\_  
 With \_\_\_\_\_  
 Open Flow \_\_\_\_\_ /10ths Water in \_\_\_\_\_ Inch  
 \_\_\_\_\_ /10ths Merc. in \_\_\_\_\_ Inch  
 Volume \_\_\_\_\_ Cu. Ft.  
 Rock Pressure \_\_\_\_\_ lbs. \_\_\_\_\_ hrs.  
 Oil \_\_\_\_\_ bbls., 1st 24 hrs.  
 Fresh water \_\_\_\_\_ feet \_\_\_\_\_ feet  
 Salt water \_\_\_\_\_ feet \_\_\_\_\_ feet

Casing and Tubing	Used in Drilling	Left in Well	Packers
Size			Kind of Packer
16			
13			
10			Size of
8 1/4			Depth set
6 3/4			Perf. top
5 3/16			Perf. bottom
3			Perf. top
2			Perf. bottom
Liners Used			

CASING CEMENTED \_\_\_\_\_ SIZE \_\_\_\_\_ No. Ft. \_\_\_\_\_ Da \_\_\_\_\_

COAL WAS ENCOUNTERED AT \_\_\_\_\_ FEET \_\_\_\_\_ INCHES  
 \_\_\_\_\_ FEET \_\_\_\_\_ INCHES  
 \_\_\_\_\_ FEET \_\_\_\_\_ INCHES

Formation	Color	Hard or Soft	Top	Bottom	Oil, Gas or Water	Depth Found	Remarks
Siltstone			7043	7059			
Big Six Sand			7059	7089			
Gray Dolomitic, Siltstone			7089	7132			
Red & Gray Siltstone, Shale			7132	7207			
Pink Shell			7207	7215			
Slate & Shell			7215	7256	Oil	7259'	Scum
Red Sand			7256	7264			
Slate			7264	7268			
Sand			7268	7276			
Total Depth			7276'				

Plugged  
2/28/49

