

FILE #: \\filestation1\Station4D\work\Cabot Oil & Gas  
 DRAWING #: Cabot2014\Pocaland\_86(199)WW-6\_Poca86.pdf  
 SCALE: see barscale above  
 MINIMUM DEGREE OF ACCURACY: 1 part in 2500  
 PROVEN SOURCE OF ELEVATION: sub meter GPS locatio

I, THE UNDERSIGNED, HEREBY CERTIFY THAT THIS PLAT IS CORRECT TO THE BEST OF MY KNOWLEDGE AND BELIEF AND SHOWS ALL THE INFORMATION REQUIRED BY LAW AND THE REGULATIONS ISSUED AND PRESCRIBED BY THE DEPARTMENT OF ENVIRONMENTAL PROTECTION.  
 Signed: *[Signature]*  
 R.P.E.: \_\_\_\_\_ L.L.S.: 1065

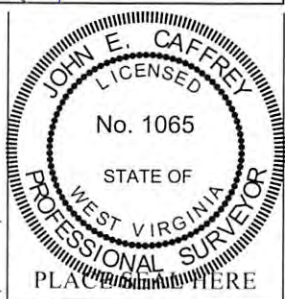

(+) DENOTES LOCATION OF WELL ON UNITED STATES TOPOGRAPHIC MAPS  
**WVDEP**  
**OFFICE OF OIL & GAS**  
 601 57TH STREET  
 CHARLESTON, WV 25304



DATE: November 12, 2014  
 OPERATOR'S WELL #: Pocahontas Land 86  
 API WELL #: 47 047 00199  
 STATE COUNTY PERMIT

Well Type:  Oil  Waste Disposal  Production  Deep  
 Gas  Liquid Injection  Storage  Shallow

WATERSHED: UT of Wolfpen Br. of Clear Fk. of Tug Fk. of the Big Sandy ELEVATION: 1866.85  
 COUNTY/DISTRICT: 047-McDowell / 2-Big Creek QUADRANGLE: 319 - DAVY

SURFACE OWNER: Pocahontas Land Corporation ACREAGE: 26882.97

OIL & GAS ROYALTY OWNER: Penn Virginia Oil and Gas Corporation ACREAGE: 47,520

DRILL  CONVERT  DRILL DEEPER  REDRILL  FRACTURE OR STIMULATE   
 PLUG OFF OLD FORMATION  PERFORATE NEW FORMATION  PLUG & ABANDON   
 CLEAN OUT & REPLUG  OTHER CHANGE  (SPECIFY): \_\_\_\_\_

TARGET FORMATION: Berea Sandstone ESTIMATED DEPTH: 4,433'

WELL OPERATOR Cabot Oil & Gas Corporation  
 Address Five Penn Center West, Suite 401  
 City Pittsburgh State PA Zip Code 15276

DESIGNATED AGENT Whitney Johnson  
 Address P.O. Box 450  
 City Glasgow State WV Zip Code 25086

Office of Oil & Gas  
 DEC 22 2016

01/27/2017

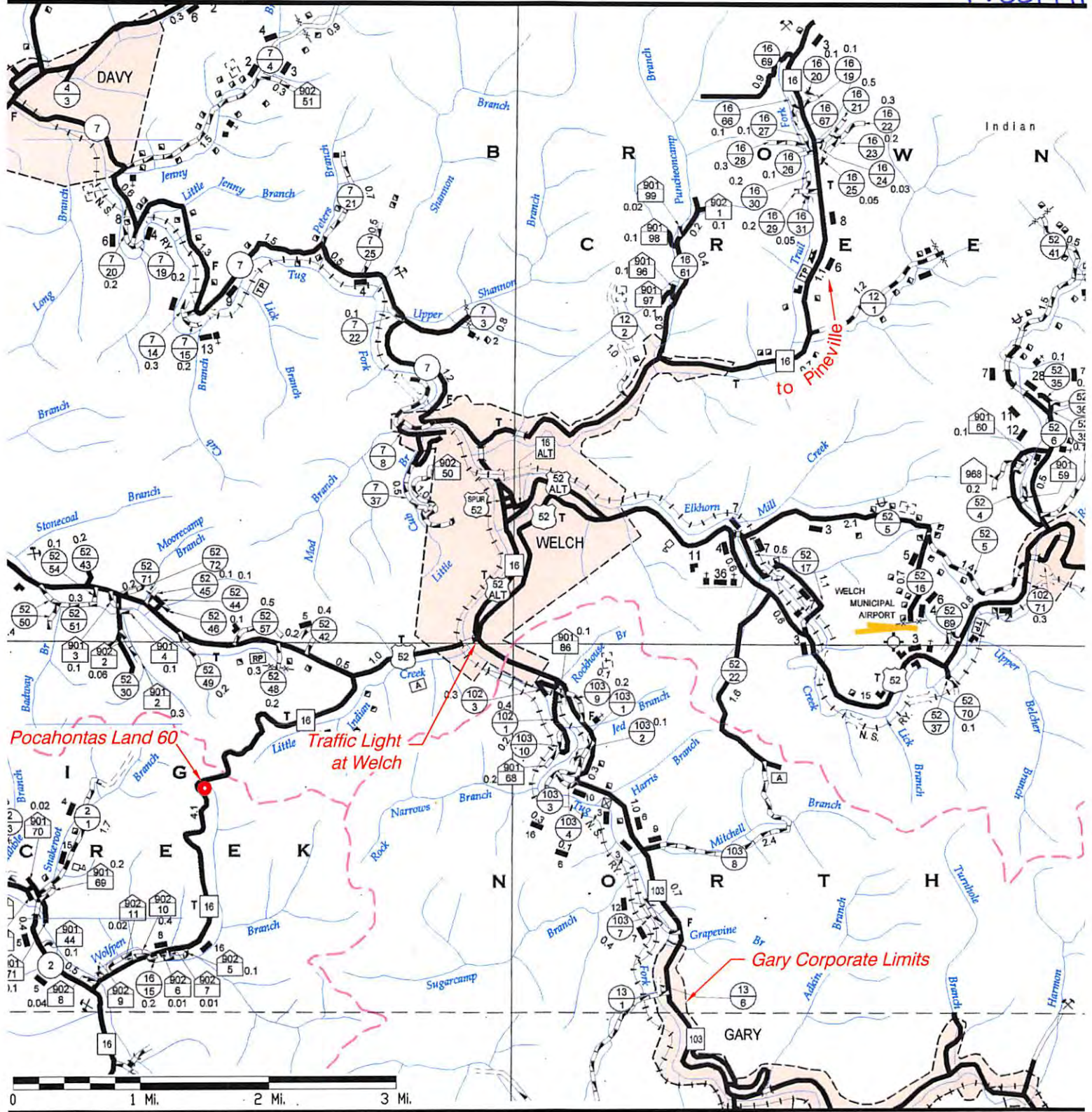

### Driving Directions:

1. From Cabot's Pineville, WV office, take WV Rt. 10 South 0.2 miles to junction with WV Rt. 16 South at the bridge over the Guyandotte River.
2. Turn right at the bridge onto Rt. 16 South (Welch-Pineville Road) for ±19 miles to the junction of US Rt. 52 in Welch, WV at the traffic light.
3. At the intersection with the traffic light, turn right onto US Rt. 52 north / WV State Rt. 16 south for 0.9 miles where Rt. 16 splits off lefthanded.
4. Turn left onto WV State Rt. 16 south for 2¼ miles. At the apex of a tight left turn, the existing lease road is on the left. Turn off Rt. 16 onto the lease road.
5. Follow the existing lease road 486 feet to the existing Pocahontas Land 86 well site.