

WR-35
Rev (8-10)

State of West Virginia
Department of Environmental Protection
Office of Oil and Gas
Well Operator's Report of Well Work

DATE: _____
API #: 47-047-01511

Farm name: Pocahontas Land Corporation Operator Well No.: 506168

LOCATION: Elevation: 1165' Quadrangle: Davy 7.5'

District: Browns Creek County: McDowell
Latitude: 37.48133 Feet South of _____ Deg. _____ Min. _____ Sec.
Longitude -81.66656 Feet West of _____ Deg. _____ Min. _____ Sec.

Company:

Address:	Casing & Tubing	Used in drilling	Left in well	Cement fill up Cu. Ft.
EQT Production 550 Eagan St. Charleston, WV 25301				
Agent: Kenneth Kirk, EVP				
Inspector:				
Date Permit Issued:				
Date Well Work Commenced: 10/8/2001				
Date Well Work Completed: 11/7/2001				
Verbal Plugging: <u>n/a</u>				
Date Permission granted on:				
Rotary <input checked="" type="checkbox"/> Cable <input type="checkbox"/> Rig				
Total Vertical Depth (ft):	3554'		3554'	510.3
Total Measured Depth (ft):	3554'		3554'	
Fresh Water Depth (ft.):	11.75'		360'	208.5(CTS)
Salt Water Depth (ft.):				
Is coal being mined in area (N/Y)? Y				
Coal Depths (ft.):	8.625'		1020'	333.6(CTS)
Void(s) encountered (N/Y) Depth(s) N				

OPEN FLOW DATA (If more than two producing formations please include additional data on separate sheet)

Producing formation Berea (injection) Pay zone depth (ft) 3412-3468
Gas: Initial open flow n/a MCF/d Oil: Initial open flow n/a Bbl/d
Final open flow n/a MCF/d Final open flow n/a Bbl/d
Time of open flow between initial and final tests n/a Hours
Static rock Pressure n/a psig (surface pressure) after n/a Hours

Second producing formation n/a Pay zone depth (ft) _____
Gas: Initial open flow _____ MCF/d Oil: Initial open flow _____ Bbl/d
Final open flow _____ MCF/d Final open flow _____ Bbl/d
Time of open flow between initial and final tests _____ Hours
Static rock Pressure _____ psig (surface pressure) after _____ Hours

RECEIVED
Office of Oil & Gas

JUL 25 2011

WV Department of
Environmental Protection

I certify under penalty of law that I have personally examined and am familiar with the information submitted on this document and all the attachments and that, based on my inquiry of those individuals immediately responsible for obtaining the information I believe that the information is true, accurate, and complete.

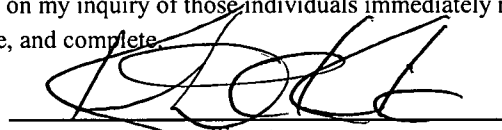
Signature

07/13/11
Date

Were core samples taken? Yes _____ No X

Were cuttings caught during drilling? Yes X No _____

Were Y Electrical, N Mechanical, N or Geophysical logs recorded on this well?
Y/N Y/N Y/N

NOTE: IN THE AREA BELOW PUT THE FOLLOWING: 1). DETAILS OF PERFORATED INTERVALS, FRACTURING OR STIMULATING, PHYSICAL CHANGE, ETC. 2). THE WELL LOG WHICH IS A SYSTEMATIC DETAILED GEOLOGICAL RECORD OF THE TOPS AND BOTTOMS OF ALL FORMATIONS, INCLUDING COAL ENCOUNTERED BY THE WELLBORE FROM SURFACE TO TOTAL DEPTH.

Perforated Intervals, Fracturing, or Stimulating:

3412-3468 with 108 holes, frac with linear gel water frac

Formations Encountered: _____ Top Depth / _____ Bottom Depth
Surface: _____

See attached Driller's Log

RECEIVED
Office of Oil & Gas

JUL 25 2011

WV Department of
Environmental Protection

Gasco Drilling Inc.

Cedar Bluff, Va 24609
(540)964-2696

Rig No. 5

Driller's Log

Operator's Well Name & Number:

506168

API No. 47-4701511

AFE No. _____

RECEIVED
Office of Oil & Gas

County: Wyoming

JUL 25 2011

WV Department of
Environmental Protection

District: Clear Fork

State: West Virginia

Gasco Drilling

(Drilling Contractor)

FORMATION

TOP (DEPTH)	BASE (DEPTH)	FORMATION (STRATA)
0	23	OVER BURTON
23	115	SANDSTONE
115	117	COAL
117	200	SANDY SHALE
200	202	COAL
202	350	STREAKED SANDSTONE
350	351	COAL
351	420	SANDY SHALE
420	481	COAL
480	1000	SALT SAND
1000	1002	COAL
1002	1090	STREAKED SANDSTONE
1090	1270	RAVEN CLIFF
1270	1360	SANDY SHALE
1360	1410	UPPER MARION
1410	1620	STREAKED SANDSTONE
1620	1660	MIDDLE MARION
1660	1800	SANDY SHALE
1800	2000	STREAKED SANDSTONE
2000	2100	LOWER MARION
2100	2200	LITTLE LIME
2200	2235	RED ROCK
2235	2650	BIG LIME
2650	2910	SANDY SHALE
2910	2940	UPPER WEIR
2940	2970	SANDY SHALE
2970	3000	LOWER WEIR
3000	3400	SANDY SHALE
3400	3450	BEREA
3450	3575	SANDY SHALE T.D.

RECORD

DESCRIPTION (HARD, SOFT, COLOR ?)	REMARKS (OIL, FRESH/SALT WATER, GAS)
	85 WATER 1" STREN
	111 " " 2' STREN
	250 6" STREN
	✓
<p>RAN 81 JOINTS OF 5 1/2 15.5" PIPE 3549 SET AT 3554 CEMENT WITH B. J. 270 SKS OF 5-4-3 BLEND PUMP 9.5 BARREL OF HCL ACID 15% PLUG DOWN AT P.M 10-18-01</p>	
<p>RECEIVED Office of Oil & Gas JUL 25 2011 WV Department of Environmental Protection</p>	

PLUGGING RECORD

R E M A R K S

DATE WELL PLUGGED: _____

PLUGGING CONTRACTOR: _____

PIPE LEFT IN HOLE:

Size:

Footage:

CEMENT/GEL PLUGS SET AS FOLLOWS:

From:

To:

Sacks/Type:

set 21' on well #1
set 23.3 on well #2
of 16" conduct

RECEIVED
Office of Oil & Gas

JUL 25 2011

WV Department of
Environmental Protection

TALLY OF PIPE

SIZE		WEIGHT		GRADE		THREAD	
11-3/4						<i>off</i>	

Feet	In	Feet	In	Feet	In	Feet	In
① 43	85	②		43	05		
44	20			44	30		
44	-			44	35		
<u>132</u>	05			37	75		
				44	20		
				44	15		
				44	10		
				44	40		
				43	85		
				44	35		
				43	-		
				44	-		
				<u>521</u>	50		
				352			
				Set			
				in			
				well			

TALLY OF PIPE

SIZE		WEIGHT		GRADE		THREAD	

Feet	In	Feet	In	Feet	In	Feet	In

RECEIVED
 Office of Oil & Gas
 JUL 25 2011
 WV Department of
 Environmental Protection

POCAHONTAS LAND CORP. WELL NO. WV6168

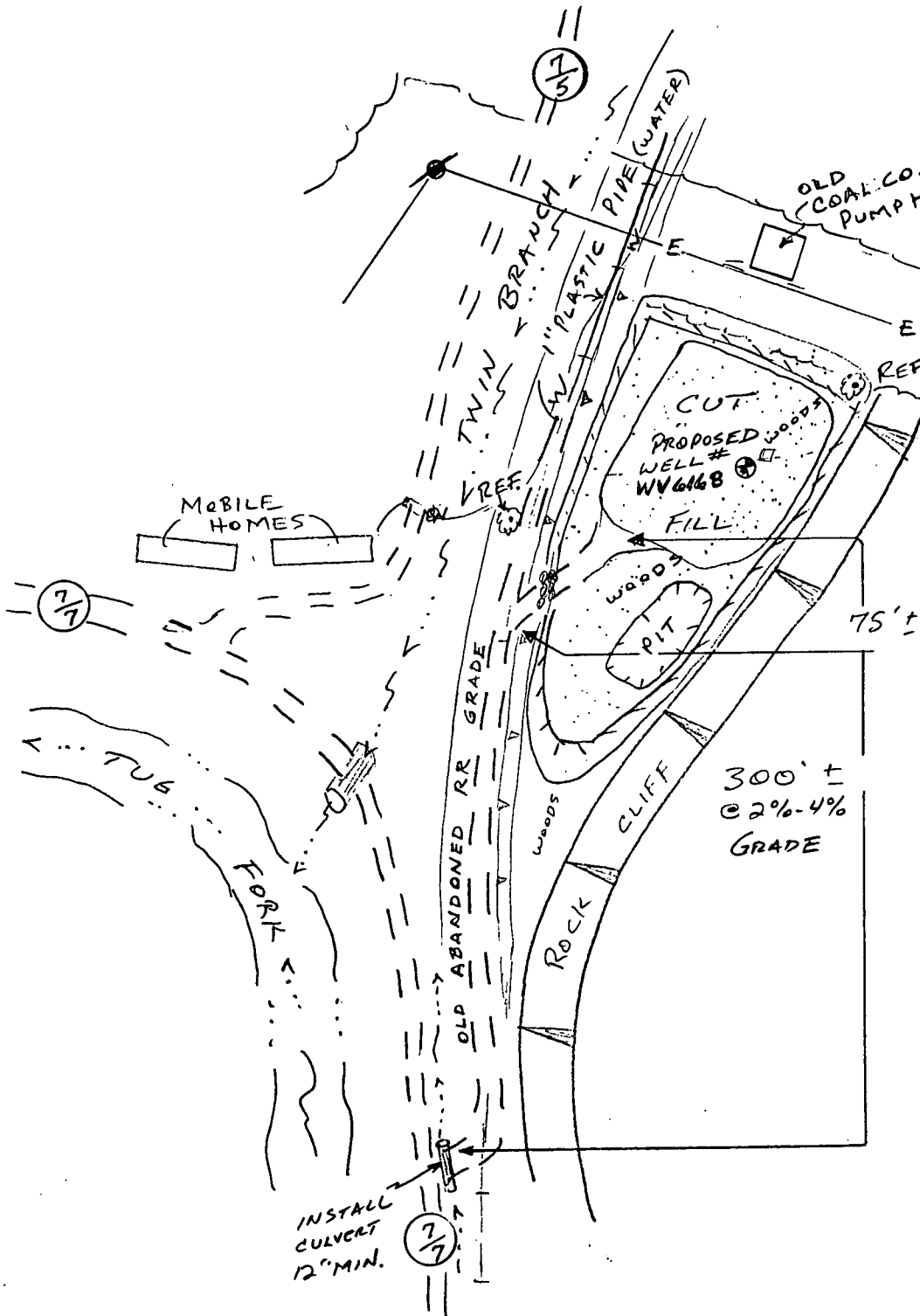

* PROPOSED SITE TO BE BUILT UP & CONSTRUCT DIVERSION AT BASE OF CLIFF & ALONG OLD RR GRADE TO PREVENT DRAINAGE ONTO SITE

* THERE IS OBVIOUS SIGNS OF OLD UNDERGROUND METAL LINES & CONCRETE STRUCTURES ASSOCIATED WITH THE OLD PUMP HOUSE (A3'D). OPERATOR & /OR CONTRACTOR IS RESPONSIBLE FOR TAKING APPROPRIATE MEASURES TO ADHERE TO STATE BMP & DEP REGULATIONS

RECEIVED
Office of Oil & Gas
Permitting

MAR 07 2001

WV Division of
Environmental Protection

POCAHONTAS LAND CORP. WELL NO. WV6168

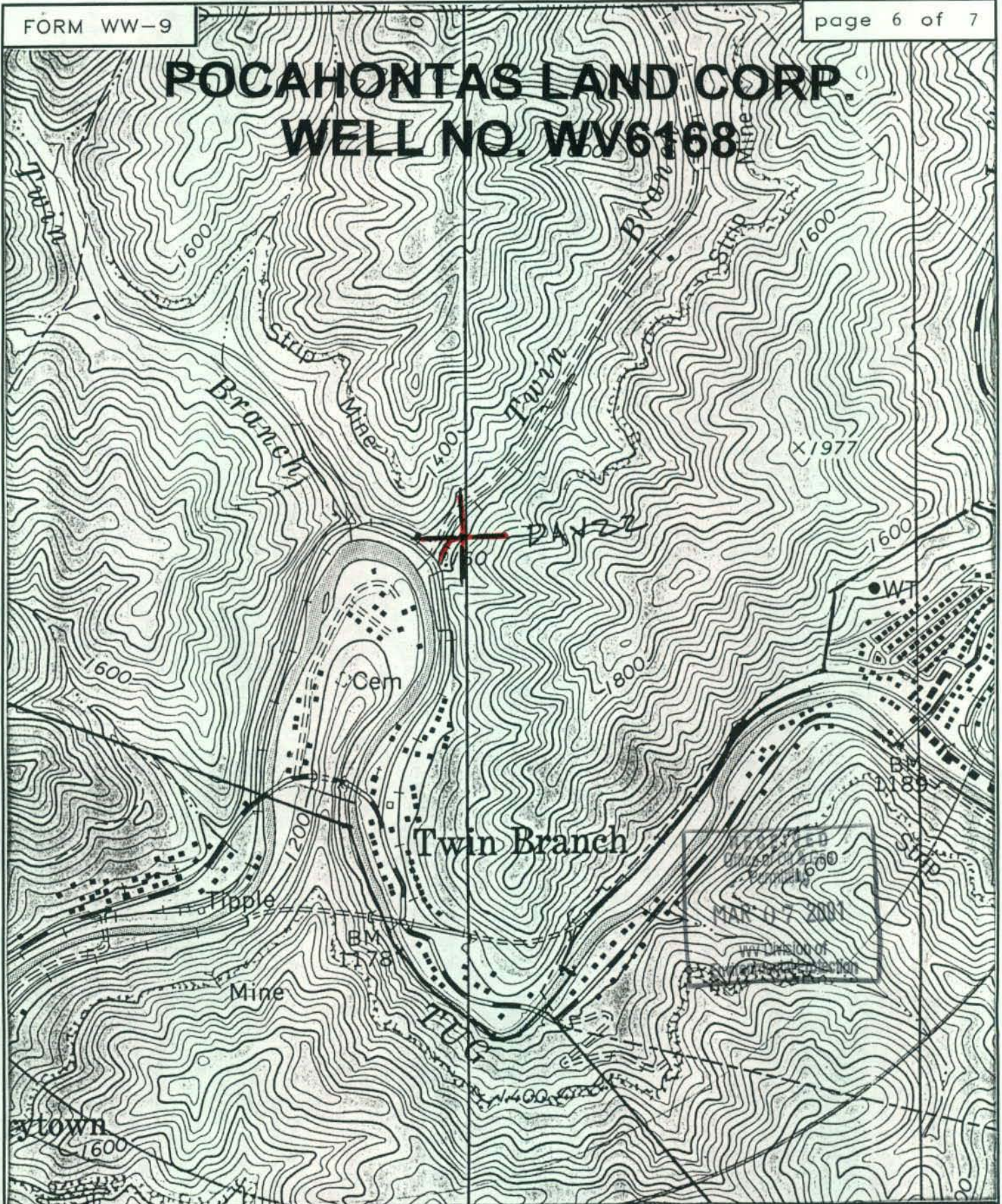

SMITH LAND SURVEYING
P.O. BOX 150 GLENVILLE, WV. 26351

TOPO SECTION OF Davy 7.5'

FILE NO. 4552 DATE 12/06/00 SCALE 1"=1000'