

WEST VIRGINIA STATE PLANE COORDINATES
NAD 27

N 184,650.356
E 1,809,600.167

9090'

LATITUDE 37° 32' 30"

LONGITUDE 81° 37' 30"

Pocahontas Land Corporation
Surface and Coal
Penn Virginia Oil and Gas Corporation
Oil and Gas
Cabot Oil and Gas Corporation
Oil and Gas Lessee

47-047-00763
N 20° 43' 38" W @ 1975.75'

BROWNS CREEK

PENN-1B
Proposed Gas Well
Elev. 2136.09

Penn-1A
Penn-1D

Penn-1C

1000'

1/2 Mile Radius

13,260'

Fork

Left

REFERENCES

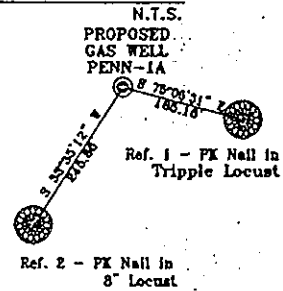

Topo Location

Pocahontas Land Corporation
Surface and Coal
Penn Virginia Oil and Gas Corporation
Oil and Gas
Equitable Production Company
Oil and Gas Lessee

Notes:

No known domestic water supplies within 1000 feet.

(+) Denotes location of well on USGS map.

FILE No. Clients\CDX
DRAWING NAME 1140-02-005
DRAWING NAME Well 1B
SCALE 1" = 1000'
MINIMUM DEGREE OF
ACCURACY 1 : 2500
PROVEN SOURCE OF
ELEVATION GPS - GLOBAL
POSITIONING SYSTEM

I THE UNDERSIGNED, HEREBY CERTIFY THAT
THIS PLAT IS CORRECT TO THE BEST OF MY
KNOWLEDGE AND BELIEF AND SHOWS ALL THE
INFORMATION REQUIRED BY LAW AND THE REGU-
LATIONS ISSUED AND PRESCRIBED BY THE
DEPARTMENT OF MINES.

(SIGNED) W. Claude Banner, Jr.
R.P.E. 2430 R.P.S.

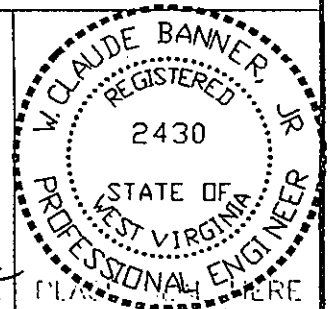

STATE OF WEST VIRGINIA
DIVISION OF ENVIRONMENTAL PROTECTION
OFFICE OF OIL AND GAS
NITRO, WV

DATE April 29, 2002
OPERATOR'S WELL No. PENN-1B
API WELL No.
47 - 047 - 01654C
STATE COUNTY PERMIT

WELL TYPE: OIL GAS CBM LIQUID INJECTION WASTE DISPOSAL
(IF "GAS") PRODUCTION X STORAGE DEEP SHALLOW
LOCATION: ELEVATION 2136.09 WATER SHED TRIBUTARY OF TWIN BRANCH OF TUG FORK
DISTRICT BROWNS CREEK COUNTY McDOWELL
QUADRANGLE BAILEYSVILLE, WV

SURFACE OWNER POCAHONTAS LAND CORPORATION ACREAGE 5,522.72
CBM ROYALTY OWNER PENN VIRGINIA OIL AND GAS CORPORATION LEASE ACREAGE 5,522.72

LEASE No. _____

PROPOSED WORK: DRILL X CONVERT DRILL DEEPER REDRILL FRACTURE OR
STIMULATE PLUG OFF OLD FORMATION PERFORATE NEW
FORMATION OTHER PHYSICAL CHANGE IN WELL (SPECIFY) _____

PLUG AND ABANDON _____ CLEAN OUT AND REPLUG _____
TARGET FORMATION POCA NO. 3 AND PENN. COALS
WELL OPERATOR CDX GAS, LLC
ADDRESS P.O. BOX 609
PINEVILLE, WV 24874

ESTIMATED DEPTH 1460' JUN 07 2002
DESIGNATED AGENT JOSEPH ZUPANICK
ADDRESS P.O. BOX 609
PINEVILLE, WV 24874

6-6 Baileysville (222)

Mc Dow 1654 C

A-17

State of West Virginia
Division of Environmental Protection
Section of Oil & Gas

Well Operator's Report of Well Work

Farm name: Pocahontas Land Corp. Operator Well No: Penn-1B

Location: Elevation: 2136.09 Quadrangle: Baileysville

District: Browns Creek County: McDowell

Latitude: 13260 Feet South of 37 Deg. 32 Min. 30 Sec.
Longitude: 9090 Feet West of 81 Deg. 37 Min. 30 Sec.

Company: CDX Gas, LLC
P.O. Box 609
Pineville, WV 24874

Agent: JOSEPH A. ZUPANICK

Inspector: Ronnie Scott
Permit Issued: 06/05/02
Well Work commenced: 7/03/02
Well Work completed: 10/10/02

Verbal plugging
Permission granted on:
Rotary x Cable _____ Rig

Total depth (ft) 1462.6
Fresh water depths (ft) N/A
Salt water depths (ft) N/A

Is coal being mined in the area (Y/N)? Y
Coal depths (ft): 118', 219', 348', 407', 723', 1370', 1408'

Casing & Tubing Size	Used in Drilling	Left in Well	Cement Fill up
13 3/8"	55'	55'	Surface
9 5/8"	795'	795'	Surface
7"	1030'	1030'	Surface

OPEN FLOW DATA

Producing formation Pocahontas No. 4 Seam

Gas: Initial open flow N/A Mcf/d
Final open flow N/A Mcf/d

Time of open flow between initial and final tests: _____ hours

Static rock pressure _____ psig (surface pressure) after _____ hours

Pay zone depth (ft) 1370'
Oil: Initial open flow _____ Bbl/d
Final open flow _____ Bbl/d

Second Producing formation _____

Gas: Initial open flow N/A Mcf/d
Final open flow N/A Mcf/d

Time of open flow between initial and final tests: _____ hours

Static rock pressure _____ psig (surface pressure) after _____ hours

Pay zone depth (ft) _____
Oil: Initial open flow _____ Bbl/d
Final open flow _____ Bbl/d

Note: ON BACK OF THIS FORM, PUT THE FOLLOWING: 1) DETAILS OF PERFORATED INTERVALS, FRACTURING OR STIMULATING, PHYSICAL CHANGE, ETC. 2) THE WELL LOG WHICH IS A SYSTEMATIC DETAILED GEOLOGICAL RECORD OF ALL FORMATIONS, INCLUDING COAL ENCOUNTERED BY THE WELLBORE.

Steven Pauley
For: CDX Gas, LLC
By: Steven Pauley
Date: 2-21-03

MAR 6 0 2003

MCDOWELL 1654 C

Details of Perforated Intervals, Fracturing or Stimulation, Physical Change, Etc.

N/A

Well Log & Geologic Record - Depths from K.B.

Formation	Top	Bottom
Overburden	0	5
Sandy Shale	5	82
Shale	82	118
Coal	118	119
Sandy Shale	119	160
Shale	160	219
Coal	219	220
Shale	220	222
Sandy shale	222	233
Shale	233	280
Sandy Shale	280	330
Shale	330	348
Coal	348	350
Sandy Shale	350	407
Coal	407	408
Sandy Shale	408	460
Shale	460	480
Sandy Shale	480	525
Shale	525	535
Sandy Shale	535	559
Shale	559	602
Sandy Shale	602	654
Shale	654	670
Sandy Shale	670	680
Shale	680	723
Coal	723	725
Sandy Shale	725	780
Shale	780	785
Sandy Shale	785	928
Shale	928	976
Sandy Shale	976	986
Shale	986	1002
Sandy Shale	1002	1040
Shale	1040	1130

