

LATITUDE 37° 20' 00" 6480
 LONGITUDE 81° 50' 00"

Proposed 506507 (CBM-426)
 Well Coordinates:
 West Virginia State Plane
 N: 122,025.68 E: 1,751,128.61
 Elevation: 1621.84

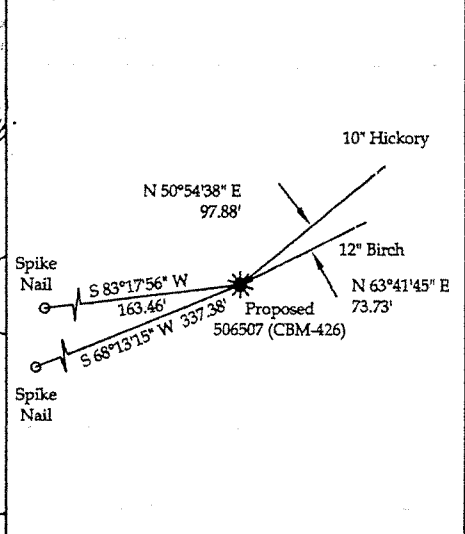
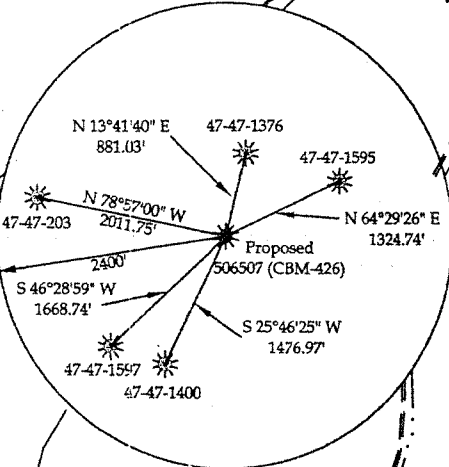

Geographic Coordinates Nad '27"
 LAT: 37.331959 LON: -81.855901

REFERENCES SCALE: 1" = 100'

I THE UNDERSIGNED, HEREBY CERTIFY THAT THIS PLAT IS CORRECT TO THE BEST OF MY KNOWLEDGE AND BELIEF AND SHOWS ALL THE INFORMATION REQUIRED BY LAW AND THE REGULATIONS ISSUED AND PRESCRIBED BY THE DIVISION OF ENVIRONMENTAL PROTECTION.
 (SIGNED) Philip Bailey 8-30-07
 R.P.E. _____ R.P.S. X

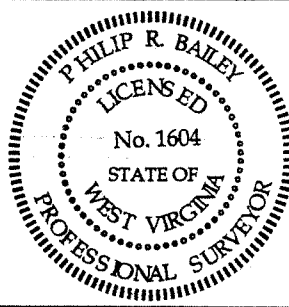

(+) DENOTES LOCATION OF WELL ON UNITED STATES TOPO MAPS
 DATE August 30, 20 07
 OPERATOR'S WELL NO. 506507 (CBM-426)
 API WELL No. 47 - 47 Revised - 2449 C
 STATE COUNTY PERMIT

MINIMUM DEGREE OF ACCURACY 45,795
 FILE NO. G1314-07
 SCALE: 1" = 1000'
 PROVEN SOURCE OF ELEVATION
 TRIG. LEVELING FROM KNOWN GPS ELEVATION DRAWING NO. 426-plat-REV.dwg

STATE OF WEST VIRGINIA
 DIVISION OF ENVIRONMENTAL PROTECTION
 OFFICE OF OIL AND GAS



WELL TYPE: OIL _____ GAS X (CBM) LIQUID INJECTION _____ WASTE DISPOSAL _____
 (IF "GAS") PRODUCTION _____ STORAGE X DEEP _____ SHALLOW _____
 LOCATION: ELEVATION 1621.84 WATER SHED _____ BRADSHAW CREEK
 DISTRICT SANDY RIVER COUNTY McDOWELL
 QUADRANGLE _____ BRADSHAW
 SURFACE OWNER KENNEDY HEIRS ACREAGE 842±
 OIL & GAS ROYALTY OWNER KENNEDY HEIRS LEASE ACREAGE 842±
 LEASE NO. 497885
 PROPOSED WORK: DRILL X CONVERT _____ DRILL DEEPER _____ REDRILL _____ FRACTURE OR
 STIMULATE _____ PLUG OFF OLD FORMATION _____ PERFORATE NEW
 FORMATION _____ OTHER PHYSICAL CHANGE IN WELL (SPECIFY) _____
 PLUG AND ABANDON _____ CLEAN OUT AND REPLUG _____
 TARGET FORMATION 100' Below Squire Gem ESTIMATED DEPTH _____
 WELL OPERATOR EQUITABLE PRODUCTION CO. DESIGNATED AGENT L. Todd Tetrick
 ADDRESS 1710 Pennsylvania Avenue ADDRESS: 1710 Pennsylvania Avenue
Charleston, WV 25302 Charleston, WV 25302

McDOWELL 2449 C

