

LATITUDE 37-20-00

WELL NO. 30388

NAD 27 WV SOUTH SPC  
N= 107,389 E= 1,868,043  
LAT. 37-17-38.51  
LONG. 81-27-12.88

SCALED COORD.  
10,740' W  
14,190' S

LONGITUDE 81-25-00

NORTH

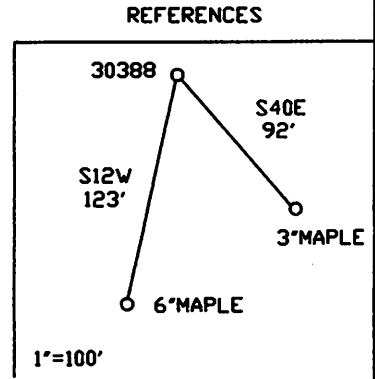
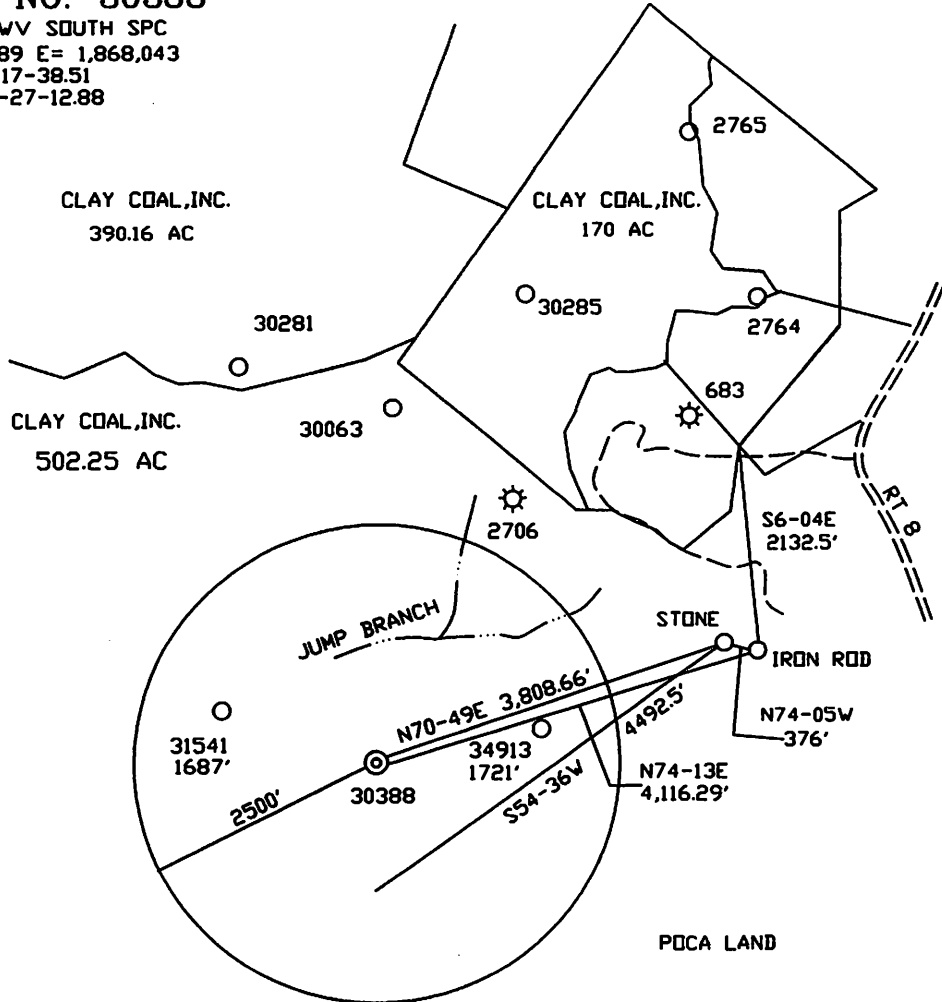

FILE NO. \_\_\_\_\_  
 DRAWING NO. \_\_\_\_\_  
 SCALE 1"=2000'  
 MINIMUM DEGREE OF ACCURACY 1/2500'  
 PROVEN SOURCE OF ELEVATION DGPS SUBMETER

I THE UNDERSIGNED, HEREBY CERTIFY THAT THIS PLAT IS CORRECT TO THE BEST OF MY KNOWLEDGE AND BELIEF AND SHOWS ALL THE INFORMATION REQUIRED BY LAW AND THE REGULATIONS ISSUED AND PRESCRIBED BY THE DEPARTMENT OF MINES.  
 (SIGNED) [Signature]  
 R.P.E. \_\_\_\_\_ L.L.S. 959 \_\_\_\_\_

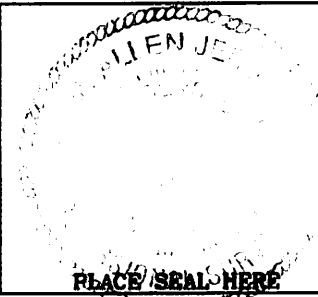

(+) DENOTES LOCATION OF WELL ON UNITED STATES TOPOGRAPHIC MAPS  
 FORM IV - 6 (8-78)



DATE MARCH 30, 2010  
 OPERATOR'S WELL NO. 30388  
47 STATE 047 COUNTY 02806 PERMIT

**CANCELLED**

Division of Environmental Protection  
Office of Oil & Gas

WELL TYPE: OIL \_\_\_\_\_ GAS X LIQUID INJECTION \_\_\_\_\_ WASTE DISPOSAL \_\_\_\_\_  
 IF "GAS" PRODUCTION X STORAGE \_\_\_\_\_ DEEP \_\_\_\_\_ SHALLOW X

LOCATION: ELEVATION 2400' WATER SHED JUMP BRANCH  
 DISTRICT ADKIN COUNTY MCDOWELL  
 QUADRANGLE ANAWALT 7.5'

SURFACE OWNER CLAY COAL, INC. ACREAGE 502.25 TAX MAP \_\_\_\_\_  
 OIL & GAS ROYALTY OWNER OPAL S. ASHWORTH, ET AL. LEASE NO. 89252 LEASE ACREAGE 1485

PROPOSED WORK: DRILL X CONVERT \_\_\_\_\_ DRILL DEEPER \_\_\_\_\_ REDRILL \_\_\_\_\_ FRACTURE OR  
 STIMULATE X PLUG OFF OLD FORMATION \_\_\_\_\_ PERFORATE NEW \_\_\_\_\_  
 FORMATION \_\_\_\_\_ OTHER PHYSICAL CHANGE IN WELL (SPECIFY) \_\_\_\_\_  
 PLUG AND ABANDON \_\_\_\_\_ CLEAN OUT AND REPLUG \_\_\_\_\_

TARGET FORMATION CLOYD ESTIMATED DEPTH 4970'  
 WELL OPERATOR CONSOL GAS COMPANY DESIGNATED AGENT RICHARD K. ELSWICK  
 ADDRESS PO BOX 1248 ADDRESS PO BOX 1248  
JANE LEW, WV 26378 JANE LEW, WV 26378