

DEPI 30216

NAD 27 WV SOUTH SPC

TOP HOLE
N=177,272 E=1,927,339
LAT. 37-29-11.64
LONG. 81-15-01.47

BOTTOM HOLE
N=179,789 E=1,925,289
LAT. 37-29-36.48
LONG. 81-15-26.98

LATITUDE 37-30-00

SCALED COORD.

175' W
4,850' S

LONGITUDE 81-15-00

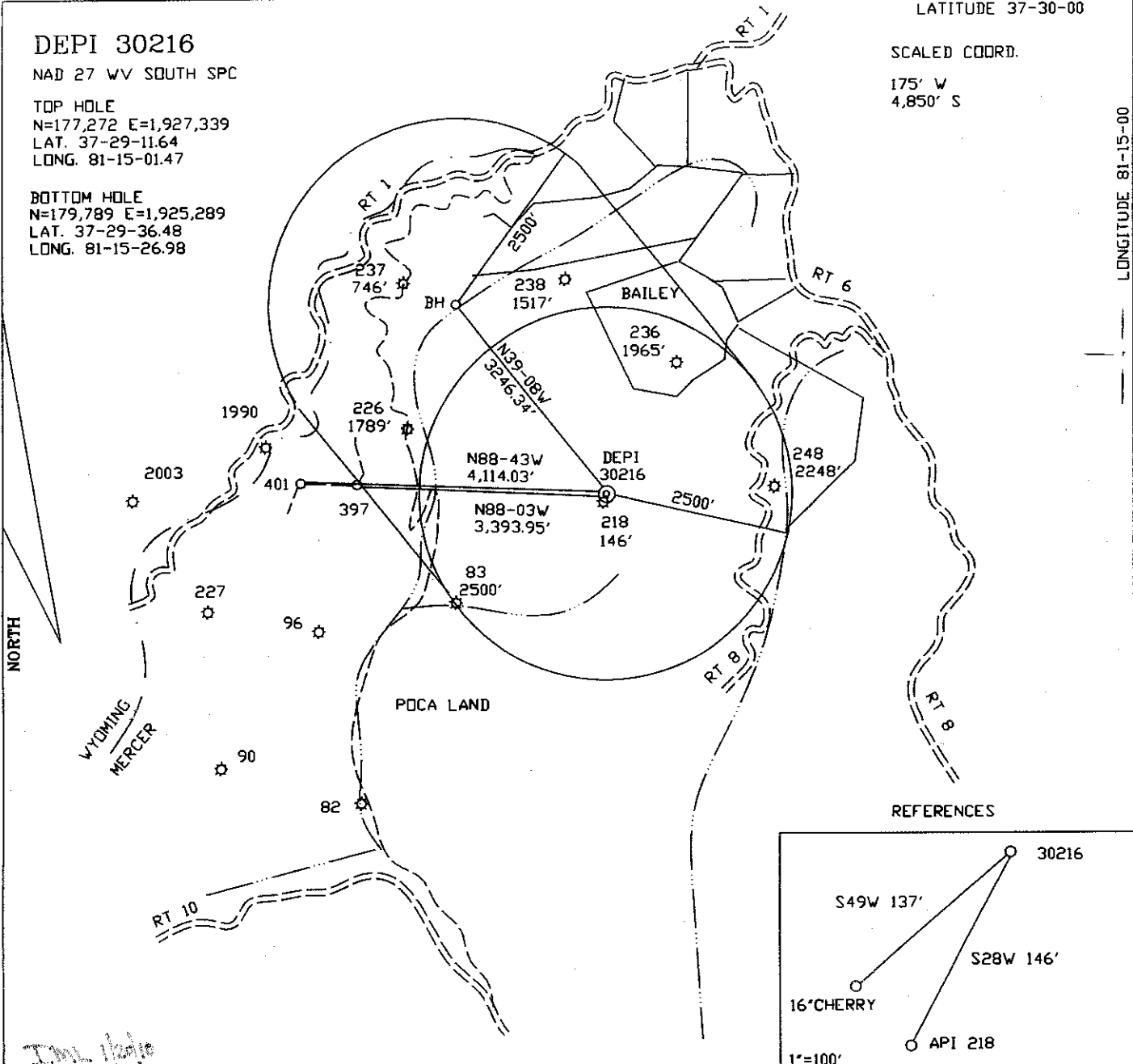

REFERENCES

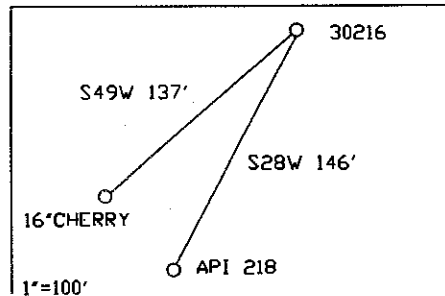

Int'l 1/10/10

FILE NO. _____
 DRAWING NO. _____
 SCALE 1"=2000'
 MINIMUM DEGREE OF ACCURACY 1/2500'
 PROVEN SOURCE OF ELEVATION DGPS SUBMETER

I THE UNDERSIGNED, HEREBY CERTIFY THAT THIS PLAT IS CORRECT TO THE BEST OF MY KNOWLEDGE AND BELIEF AND SHOWS ALL THE INFORMATION REQUIRED BY LAW AND THE REGULATIONS ISSUED AND PRESCRIBED BY THE DEPARTMENT OF MINES.
 (SIGNED) M. Allen Jordan
 R.P.E. _____ L.L.S. 959



(+) DENOTES LOCATION OF WELL ON UNITED STATES TOPOGRAPHIC MAPS

FORM IV - 6 (8-78)



DATE DECEMBER 15, 2009
 OPERATOR'S WELL NO. DEPI 30216
 47 STATE 055 COUNTY 00418H PERMIT

CANCELLED

Division of Environmental Protection
 Office of Oil & Gas

WELL TYPE: OIL _____ GAS X LIQUID INJECTION _____ WASTE DISPOSAL _____
 IF "GAS" PRODUCTION X STORAGE _____ DEEP _____ SHALLOW X
 LOCATION: ELEVATION 3115' WATER SHED RIGHTHAND FORK
 DISTRICT ROCK COUNTY MERCER
 QUADRANGLE CRUMPLER 7.5'
 SURFACE OWNER POCAHONTAS LAND CORP. ACREAGE 2160.35 TAX MAP
 OIL & GAS ROYALTY OWNER PENN VIRGINIA OIL & GAS COMPANY LEASE ACREAGE 103,420
 LEASE NO. 79917
 PROPOSED WORK: DRILL X CONVERT _____ DRILL DEEPER _____ REDRILL _____ FRACTURE OR
 STIMULATE X PLUG OFF OLD FORMATION _____ PERFORATE NEW _____
 PLUG AND ABANDON _____ OTHER PHYSICAL CHANGE IN WELL (SPECIFY) _____
 CLEAN OUT AND REPLUG _____
 TARGET FORMATION UNION ESTIMATED DEPTH TVD 3800' MD 6800'
 WELL OPERATOR DOMINION EXPLORATION AND PRODUCTION, INC. DESIGNATED AGENT RODNEY J. BIGGS
 ADDRESS ONE DOMINION DRIVE PO BOX 1248 JANE LEW, WV 26378
 ADDRESS ONE DOMINION DRIVE PO BOX 1248 JANE LEW, WV 26378

07/27/2012