

RALPH D. & KIMBERLY D. MAYNARD
Deed Book #101
Page #306
(Owner - Oil & Gas)
RALPH D. & KIMBERLY D. MAYNARD
(Owner - Surface)
QUALITY NATURAL GAS PROPERTIES, LTD.
(Owner - Oil & Gas)
RALPH D. & KIMBERLY D. MAYNARD
(Owner - Coal)
COAL NOT LEASED

EQUITABLE PRODUCTION COMPANY
(Owner - Oil & Gas)
OIL & GAS NOT LEASED

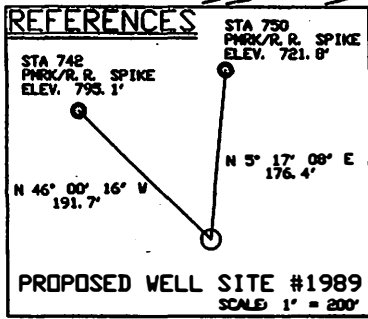

State Plane
WV South Nad 27
N = 266,039
E = 1,654,925

Geographic Nad 27
LAT = 37° 43' 28.29"
LONG = 82° 11' 35.17"

LEGEND

+	INDICATES LOCATION WELL ON UNITED STATES TOPOGRAPHICAL MAPS
○	PROPOSED WELL
⊙	PLUGGED WELL
⊛	EXISTING WELL
⊙	SURVEY STATION
⊙	TREE
—	ROADS
—	RAILROAD
—	STREAM, DRAIN, CREEK

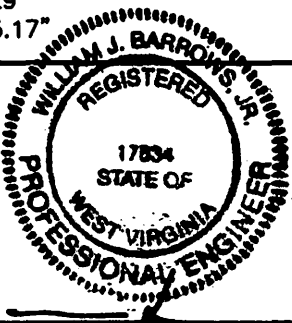

WJB

B & B Engineering, LLC
36 Hatfield Lane
Prestonsburg, KY 41653
Phone: (606) 874-7005

DRAWING No. WVA1989.DWG
SCALE 1" = 500'
MINIMUM DEGREE OF ACCURACY 1 IN 2500
PROVEN SOURCE OF ELEVATION USGS B.M. MONUMENT #672

STATE OF WEST VIRGINIA
DIVISION OF ENVIRONMENTAL PROTECTION
OFFICE OF OIL AND GAS
CHARLESTON, WV. 25304



DATE: 05/19/2009
OPERATOR'S WELL NO. 1989
API WELL NO. 47-59-02107
STATE COUNTY PERMIT

WELL TYPE: OIL GAS LIQUID INJECTION WASTE DISPOSAL
(IF "GAS") PRODUCTION OR STORAGE DEEP OR SHALLOW **CELLED**

LOCATION: ELEVATION 712.1' WATER SHED Pigeon Creek
DISTRICT Lee COUNTY Mingo
QUADRANGLE Delbarton

SURFACE OWNER Ralph D. & Kimberly D. Maynard ACREAGE +/- 30
OIL & GAS ROYALTY OWNER Ralph D. & Kimberly D. Maynard LEASE ACREAGE +/- 30
LEASE No. 1024

PROPOSED WORK: DRILL CONVERT DRILL DEEPER REDRILL FRACTURE OR STIMULATE
PLUG OFF OLD FOR ATION PERFORATE NEW FORMATION
OTHER PHYSICAL CHANGE IN WELL (SPECIFY) _____

PLUG AND ABANDON CLEAN OUT AND REPLUG
TARGET FORMATION DEVONIAN SHALE ESTIMATED DEPTH +/- 3823'
WELL OPERATOR QUALITY NATURAL GAS, LLC DESIGNATED AGENT JAMES HILL
ADDRESS P.O. BOX 480 ADDRESS HC 71 Rt. 4, BOX 87A
Allen, Kentucky 41601 WHARNCLIFFE, WV 25651