

LATITUDE 37° 37' 30"

LONGITUDE 82° 05' 00"

**BOTTOM HOLE  
WELL NO. WV 511826  
STATE PLANE COORDINATES  
(SOUTH ZONE)**

N. 228,980  
E. 1,678,288

LAT=(N) 37.62355  
LONG=(W) 82.11080

# RED JACKET COAL CORPORATION LEASE 1,844.72 of 2,234.72 ACRES± WELL NO. WV 511826

RED JACKET COAL  
CORP. LEASE  
1844.72 ACRES±

BOTTOM HOLE  
WELL NO.  
WV 511826

HEARTWOOD  
FORESTLAND FUND  
3,052.16 ACRES±

PLUM CREEK  
TIMBERLANDS, LP  
LEASE  
2,142.75 ACRES±

47-059-1146

LEASE BOUNDARY CALLS  
RUN WITH/ALONG RIDGE

THACKER LAND CO. LEASE  
1947.04 ACRES±

**WELL NO. WV 511826  
STATE PLANE COORDINATES  
(SOUTH ZONE)**

N. 226,980  
E. 1,681,400

LAT=(N) 37.61816  
LONG=(W) 82.09997

**EXISTING WELL  
A.P.I. #47-059-1572  
STATE PLANE COORDINATES  
(SOUTH ZONE)**

N. 226,943  
E. 1,681,364

LAT=(N) 37.61806  
LONG=(W) 82.10007

47-059-1288

MAUCLINVILLE  
BRANCH

S 78°43' W  
4832.48'

HEARTWOOD  
FORESTLAND FUND  
1,795.90 ACRES±

GRAPEVINE LAND  
COMPANY ET AL  
669.24 ACRES±

### NOTES ON SURVEY

1. TIES TO WELLS AND CORNERS ARE BASED ON GRID NORTH FOR THE WV STATE PLANE COORDINATE SYSTEM SOUTH ZONE NAD '27.
2. TIES TO REFERENCES ARE BASED ON MAGNETIC NORTH 09/04/09.
3. LEASE BOUNDARY SHOWN HEREON TAKEN FROM A PLAT DATED MARCH 20, 2003 AS PREPARED BY SLS FOR A.P.I. NO. 47-059-1572.
4. SURFACE OWNER AND ADJOINER INFORMATION TAKEN FROM THE ASSESSOR AND COUNTY CLERK RECORDS OF MINGO COUNTY IN JULY, 2009.
5. WELL LAT./LONG. (NAD'27) ESTABLISHED BY DGPS(SUBMETER MAPPING GRADE).

### REFERENCES

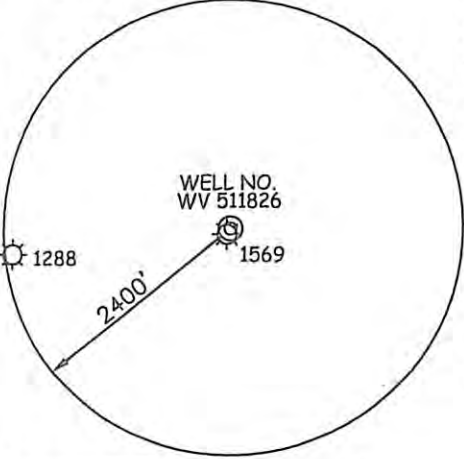
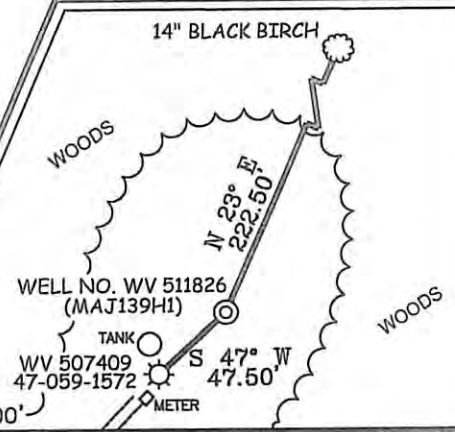

I THE UNDERSIGNED, HEREBY CERTIFY THAT THIS PLAT IS CORRECT TO THE BEST OF MY KNOWLEDGE AND BELIEF AND SHOWS ALL THE INFORMATION REQUIRED BY LAW AND THE REGULATIONS ISSUED AND PRESCRIBED BY THE DIVISION OF ENVIRONMENTAL PROTECTION.

P.S. 677 *Gregory A. Smith*

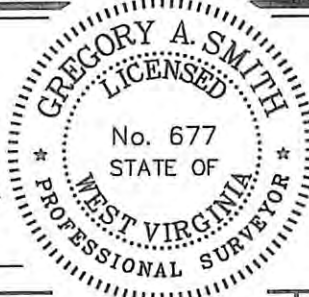

(+) DENOTES LOCATION OF WELL ON UNITED STATES TOPOGRAPHIC MAPS.  
DATE SEPTEMBER 23, 20 09

OPERATORS WELL NO. WV 511826

API WELL NO. 47-059-02163H  
STATE COUNTY PERMIT

**CANCELLED**

MINIMUM DEGREE OF ACCURACY 1/2500 FILE NO. 3915P511826 (283-68)  
PROVEN SOURCE OF ELEVATION DGPS (SUBMETER MAPPING GRADE) SCALE 1" = 1000'

STATE OF WEST VIRGINIA  
DIVISION OF ENVIRONMENTAL PROTECTION  
OFFICE OF OIL AND GAS

WELL TYPE: OIL  GAS  LIQUID INJECTION  WASTE DISPOSAL  IF "GAS" PRODUCTION  STORAGE  DEEP  SHALLOW

LOCATION: ELEVATION 1,912' WATERSHED TRIBUTARY OF MITCHELL BRANCH OF MATE CREEK

DISTRICT MAGNOLIA COUNTY MINGO QUADRANGLE MAJESTIC 7.5'

SURFACE OWNER HEARTWOOD FORESTLAND FUND ACREAGE 3,052.16±

ROYALTY OWNER PLUM CREEK TIMBERLANDS, L.P. LEASE ACREAGE 1,844.72 of 2,234.72±

PROPOSED WORK: LEASE NO. 080567

DRILL  CONVERT  DRILL DEEPER  REDRILL  FRACTURE OR STIMULATE  PLUG OFF OLD

FORMATION  PERFORATE NEW FORMATION  PLUG AND ABANDON  CLEAN OUT AND REPLUG  OTHER

PHYSICAL CHANGE IN WELL (SPECIFY) \_\_\_\_\_ TARGET FORMATION LOWER HURON

ESTIMATED DEPTH 5,320' (TOTAL VERTICAL DEPTH)

WELL OPERATOR EQT PRODUCTION COMPANY DESIGNATED AGENT REX C. RAY  
ADDRESS 1710 PENNSYLVANIA AVENUE ADDRESS 1710 PENNSYLVANIA AVENUE  
CHARLESTON, WV 25302 CHARLESTON, WV 25302

11/16/2012