

Company Road Supply Co.
 Address Salem, W.Va.
 Farm Asa Lemley
 Tract _____ Acres 300 Leas. No. _____
 Well (Farm) No. 3 Serial No. _____
 Elevation (Spirit Level) _____
 Quadrangle Blacksville
 County Monongalia District Clay
 Engineer Emmon Haines
 Engineer's Registration No. _____
 File No. _____ Drawing No. _____
 Date 12-28-43 Scale 1 in. = 400 ft.

STATE OF WEST VIRGINIA
 DEPARTMENT OF MINES
 OIL AND GAS DIVISION
 CHARLESTON

WELL LOCATION MAP
 FILE NO. MON-267-A

+ Denotes location of well on United States Topographic Maps, scale 1 to 62,500, latitude and longitude lines being represented by border lines as shown.

- Denotes one inch spaces on border line of original tracing

ASA LEMLEY No. 3 - ROAD SUPPLY Co. - MON-267-A

Latitude 39 45'

Longitude 80 10'

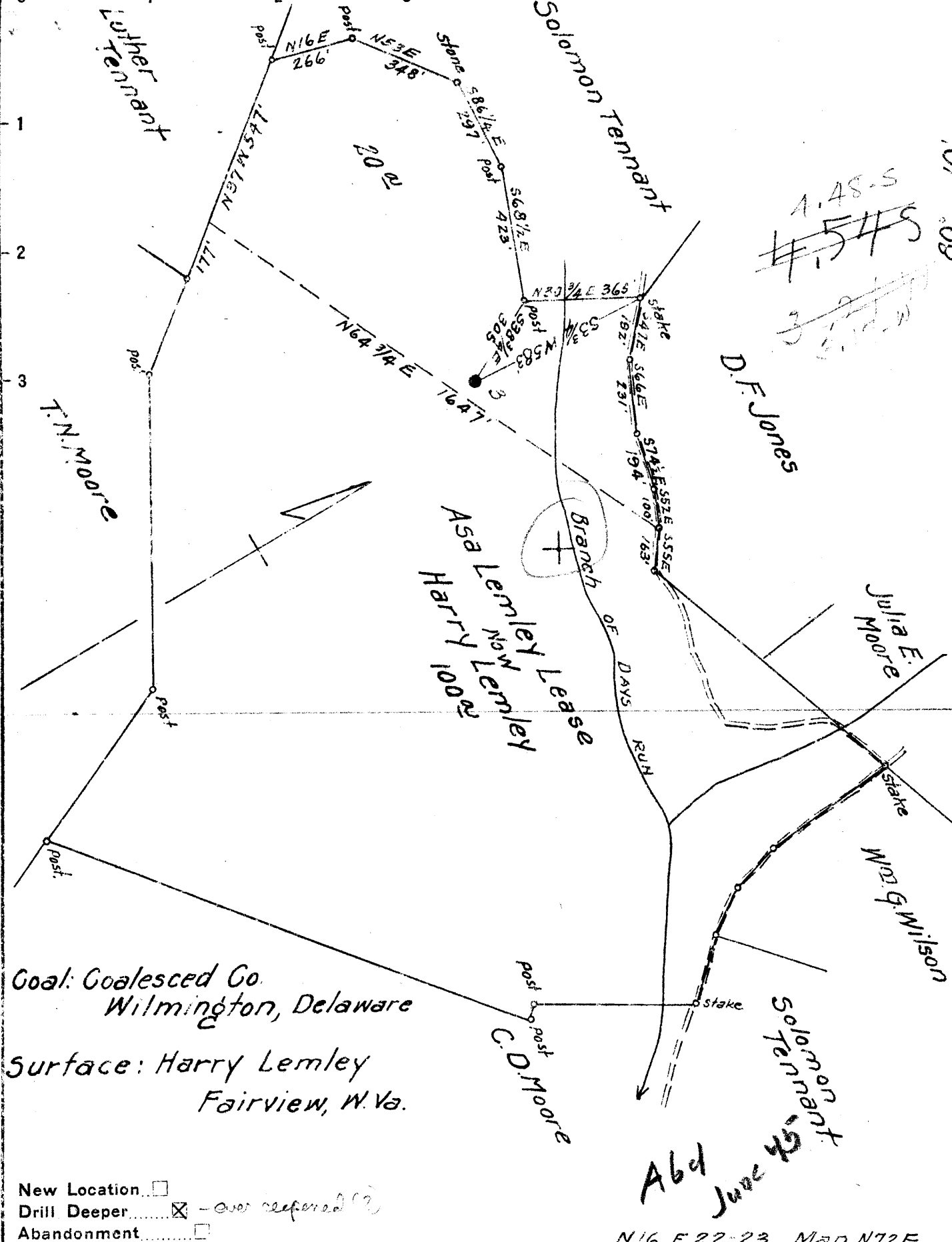

Coal: Coalesced Co.
 Wilmington, Delaware
 Surface: Harry Lemley
 Fairview, W. Va.

- New Location
- Drill Deeper - over referred (?)
- Abandonment

N16 E 22-23 Map N72E

Company South Penn Natural Gas Co.
 Address Parkersburg W. Va
 Farm Asa Lemley
 Tract _____ Acres 300 Lease No. 56349
 Well (Farm) No. 3 Serial No. _____
 Elevation (Spirit Level) 1252.03
 Quadrangle Blacksville NW
 County Monongalia District Clay
 Engineer Emmon Haines
 Engineer's Registration No. _____
 File No. _____ Drawing No. _____
 Date 12-28-43 Scale 1" = 400'

STATE OF WEST VIRGINIA
 DEPARTMENT OF MINES
 OIL AND GAS DIVISION
 CHARLESTON

WELL LOCATION MAP
 FILE NO. MON-167
 1542-103 & Ref
 061-710250.2

+ Denotes location of well on United States Topographic Maps scale 1 to 62 500, latitude and longitude lines being represented by border lines as shown.

- Denotes one inch spaces on border line of original tracing

WEST VIRGINIA DEPARTMENT OF MINES
OIL & GAS DIVISION
W E L L R E C O R D

Permit No. Mon 167
Blacksville Quad.

Oil Well
CASING & TUBING

Company	South Penn Natural Gas Company		
Address	Union Trust Bldg., Parkersburg, W.Va.		
Farm	Asa Lemley Acres 300		
Location		13½	126'4 Pld.
Well No.	3	Elev. 1252, 03	10 1242'6 "
District	Clay	Monongalia County	8½ 1675'1
Surface	Harry Lemley, Fairview, W.Va. 6 5/8 1917' 2		
Mineral	Telluric Co et al, Morgantown, W.Va. 5 3/16 201'		
Commenced	Feb. 27, 1908		
Completed	May 4, 1908	Cond.	14'
Oil	Bailed 10 bbls. 1st 24 hrs.		
Salt Water	1570 H.F.	1765-1890 H.F.	Coal at 625' 60"; 790' 60"; 885' 108"

Bluff Sand	580	620	
✓ Fairview Coal	625	630	
✓ Mapletown Coal	790	795	
✓ Pittsburgh Coal	885	894	
✓ Little Dunkard Sand	1280	1290	
✓ Big Dunkard Sand	1375	1400	
✓ Gas Sand	1560	1590	
✓ Salt Sand	1650	1925	
✓ Little Lime	2085	2095	
✓ Pencil Slate	2103	2112	
✓ Big Lime	2112	2175	
✓ Big Injun 371	2196		
Total Depth		2304	Oil 2294

Lined at 2125'9 9 jts. 5 3/16 casing-201'

$$\begin{array}{r} 2257 \\ 874 \\ \hline 1383 \end{array}$$

$$\begin{array}{r} 2112 \\ 145 \\ \hline 2257 \\ 1252 \\ \hline 1005 \end{array}$$

STATE OF WEST VIRGINIA
DEPARTMENT OF MINES
OIL AND GAS DIVISION

365

WELL RECORD

Permit No. 787-A

Oil or Gas Well
(Kind)

Company	<u>Raad Supply Company</u>	Casing and Tubing	Used in Drilling	Left in Well	Packers
Address	<u>184 East Main Street, Salem, W. Va.</u>	Size			
Farm	<u>Asa Lemley</u>	16			
Acres	<u>300</u>	13	<u>126' 4"</u>	<u>None</u>	Kind of Packer
Location (waters)		10	<u>1242' 6"</u>	<u>None</u>	Size of
Well No.	<u>3</u>	8 1/4	<u>1675' 1"</u>	<u>1675' 1"</u>	Depth set
Elev.	<u>1202.3</u>	6 5/8	<u>1917' 2"</u>	<u>1917' 2"</u>	Perf. top
District	<u>Clay</u>	5 3/16	<u>201'</u>	<u>201'</u>	Perf. bottom
County	<u>Monongalia</u>	3			Perf. top
The surface of tract is owned in fee by	<u>Harry Lemley</u>	2			Perf. bottom
Address	<u>R. D. #2, Marion Co., Fairview, W. Va.</u>	Liners Used			
Mineral rights are owned by	<u>Coalesced Co., Wilmington, Del.</u>				
Address					
Drilling commenced					
Drilling completed	<u>May 4, 1908</u>				
Date shot					
Depth of shot					
Open Flow	<u>/10ths Water in</u>				
Inch					
/10ths Merc. in					
Inch					
Volume					
Cu. Ft.					
Rock Pressure					
lbs.					
hrs.					
Oil					
bbls., 1st 24 hrs.					
Fresh water					
feet					
feet					
Salt water					
feet					
feet					

CASING CEMENTED No SIZE 6 3/8 No. Ft. 630 Date 6-25
 COAL WAS ENCOUNTERED AT 630 FEET 60 INCHES
795 FEET 60 INCHES 894 FEET 108 INCHES
 FEET INCHES FEET INCHES

Formation	Color	Hard or Soft	Top	Bottom	Oil, Gas or Water	Depth Found	Remarks
Conductor				14			
Bluff Sand			580	620			
Fairview Coal			625	630			
Mapletown Coal			790	795			
Pittsburgh Coal			885	894			
Little Dunkard			1280	1290			
Dunkard Sand			1375	1400			
Gas Sand			1560	1590			
Hole full water				1570	Water		
Salt Sand			1650	1925			
Hole full water				1765	Water		
Hole full water				1890	Water		
Little Lime			2085	2095			
Big Lime			2112	2175			
Pencil cave			2103	2112			
Big Injun			2196				
1st Pay			2294				
Total depth				2304			

Lined at 2125' 9" - 9 Jts. 5-3/16" casing - 201'.

STATE OF WEST VIRGINIA
DEPARTMENT OF MINES
OIL AND GAS DIVISION

WELL RECORD

Permit No. **757-A**

Oil or Gas Well
(Kind)

Company **South Penn Natural Gas Company**
Address **Union Trust Bldg. Parkersburg, W. Va.**
Farm **Asa Lemley** Acres **300**
Location (waters) -----
Well No. **3** Elev. **1252.03**
District **Clay** County **Monongalia**
The surface of tract is owned in fee by **Harry Lemley**
R. F. D. #2, Fairview, W. Va.
Mineral rights are owned by **Telluric Company**
Morgantown, W. Va. Address -----

Drilling commenced **February 27, 1908**
Drilling completed **May 4, 1908**
Date shot **No record** Depth of shot -----
Open Flow /10ths Water in ----- Inch
/10ths Merc. in ----- Inch
Volume ----- Cu. Ft.
Rock Pressure ----- lbs. ----- hrs.
Oil **10** bbls., 1st 24 hrs.
Fresh water ----- feet ----- feet
Salt water ----- feet **1570-1765-1890** feet

Casing and Tubing	Used in Drilling	Left in Well	Packers
Size			
16			Kind of Packer
13	126'4"	Pulled	
10	1242'6"	Pulled	Size of
8 1/4	1675'1"		
6 5/8	1917'2"		Depth set
5 3/16	201'		
3			Perf. top
2			Perf. bottom
Liners Used			Perf. top
Cond	14		Perf. bottom

CASING CEMENTED ----- SIZE ----- No. Ft. ----- Date -----
COAL WAS ENCOUNTERED AT ----- FEET ----- INCHES
----- FEET ----- INCHES ----- FEET ----- INCHES
----- FEET ----- INCHES ----- FEET ----- INCHES

Formation	Color	Hard or Soft	Top	Bottom	Oil, Gas or Water	Depth Found	Remarks
Bluff Sand			580	620			
Fairview Coal			625	630			
Mapletown Coal			790	795			
Pittsburgh Coal			885	894			
Little Dunkard			1280	1290			
Big Dunkard			1375	1400			
Gas Sand			1560	1590			
					Water	1570	
					Water	1765	
					Water	1890	
Little Lime			2085	2095			
Pencil Slate			2103	2112			
Big Lime			2112	2175			
Big Injun			2196				
Total Depth				2304	Oil	2294	



(Over)

OCT - 9 1941

