

LATITUDE 39° 42' 30"

D



LONGITUDE

7'5 OGIS topo location

7.5' LOC 0.79 S 15' LOC _____
' 0.07 W (calc.) _____

Company _____

Farm _____

Quad WADESTOWN 7 1/2'

County MONGOLIA

District BATTELLE

Clev 1190 ± tops

WELL LOCATION MAP

File No. 061-0381

28
Co. Rep. Map

HOPE NATURAL GAS COMPANY.

LOCATION FOR WELL No. 2250 ✓

DISTRICT
 State of West Virginia
 County of Mingo
 Township of Quaker
 District of Marion
 Section 17 North Range 17 West
 Lease No. 676 Area 600 Acres
 80 Acres sent to M. Y. C. 5-24-1911
 Location to be 400 feet from corner Shriver Survey line
at a point 400 feet from Shriver corner.

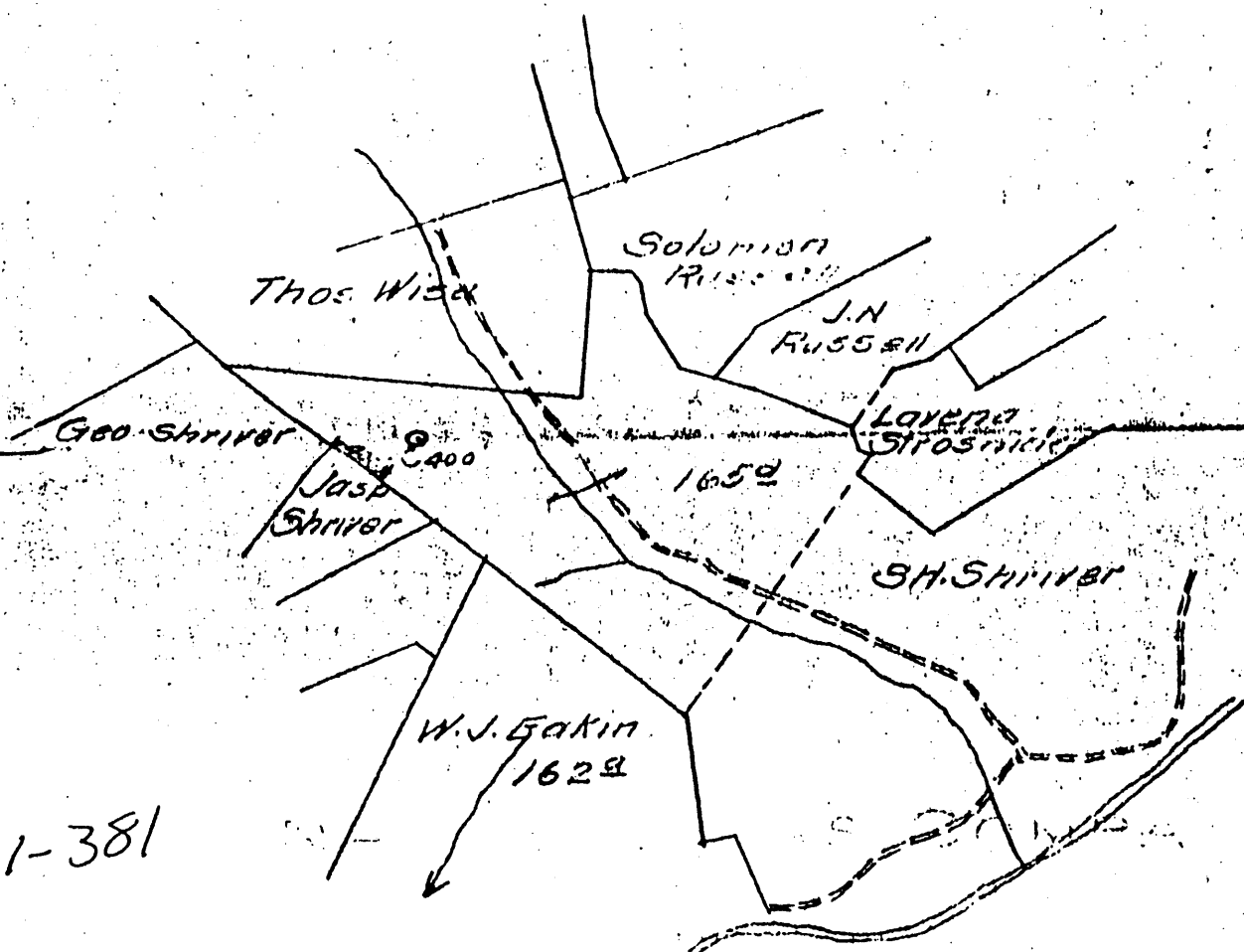

061-381

RESERVE Eight acres on unpatented land
 SPECIAL INSTRUCTIONS Same lease on unpatented land
well No. 211 No. 494
 made on June 5-30-11 by J. S. Lang as per plat, attached. On field
6-3-11 Returned to Pittsburgh 6-3-11

Date _____ Signed by S. H. Bradley
Geo. L.

Record of

Company 1702 501

Well No. 2250

S.H. Shively

Hairview

District

Located on

Farm

District Wadwell

County Williamson

State W.Va

Location Made May 30 1911

First Work Done

Rig Commenced June 14 1911

Rig Completed June 21 1911

Drilling Commenced July 25 1911

Drilling Completed Oct 19 1911

Rig Contractor

Drilling Contractor Beach & Kistler

Drillers

Tool Dressers

FORMATION	TOP	BOTTOM	Steel Line Measurements	Water Faced Depth	Oil Faced Depth	Gas Faced Depth	REMARKS
ive Coal	370	324					Mapletown Coal
aburg Coal	372	1181	S.L.				1890-895
tle Dunkard	1305	1375					
g Dunkard	1455	1510					
Sand	1670	1695					
rat Salt	1780	1810					
cond Salt	1945	2010					
axion							
tle Lime	2185	2200					
ncil Cave	2200	2412					
g Lime	2212	2272	S.L.				
g Injan	2272	2460	S.R.				
shaw	2465	2480					
ren							
ntz	2760	2778	S.L.				
fty Foot	2922	2953	S.L.				2925 Show of Gas
irty Foot	2975	3011	S.L.				2990 Show of Gas + oil
ordon Stray	3076	3054					
ordon	3066	3088	S.L.				
with	3101	3165	S.L.				
with	3195	3234	S.L.				
with	3247	3294	S.L.				
yard	3410	3415	S.L.				3263 & 3268 3411 Shell Gas expansion in 5 hours
total Depth		3452	S.L.				

SIZE	Charged to Well		Put in Well		Packed Out		Left in Well		Transferred Before Completing		Left at Well Not in Use		If more than two strings of casing are left in hole, give reasons for leaving additional strings
	Feet	In.	Feet	In.	Feet	In.	Feet	In.	Feet	In.	Feet	In.	
13" Csg.													
10" "	1463	10	1312	8	1317	8			1422	8	382		
8 1/2" "	2242	6	2011		2011				347	9	1894	9	
6 5/8" "	2367	3	2232								135	3	
3-16" "	3756		3049									207	
Tbx.													

PACKER RECORD

SIZE	KIND	Amount Anchor	Amount Above Anchor	REMARKS
1 7/8 x 8 1/4	BAV			2232
7/16 x 6 5/8	" "			3049

SHOOTING RECORD (If shot before or upon completion of well)

DATE	Gauge	Top of Shell	Bottom of Shell	Diameter	Seal	Test Before Shot			Test After Shot			Test Taken After Shot No. Hours	By Whom Shot
						Reading	Liquid	Opening	Reading	Liquid	Opening		
10-21-11	15	3263	3173	3"	Flight	6 1/10 Water	2"	6 1/10 Water	2"	5/10 Mer	Merietta Co		

CEMENTING RECORD

Date Cemented.....	Size Hole Cemented.....	Size Casing Cemented.....	Amount Cement Used.....	Amount Sand Used.....	Amount Coal Cemented.....	Remarks.....
Top Pittsburg Coal.....	Top Cementing.....	Amount Cement Used.....	Amount Sand Used.....	Amount Coal Cemented.....	Remarks.....	
Bottom Pittsburg Coal.....	Bottom Cementing.....	Amount Cement Used.....	Amount Sand Used.....	Amount Coal Cemented.....	Remarks.....	
MP.....	of.....	Amount Cement Used.....	Amount Sand Used.....	Amount Coal Cemented.....	Remarks.....	

ENTERED OCT 23 1911 G.A.K.

CONTRACTOR'S CERTIFICATE

Signature of Contractor

CONTRACTOR'S TITLE

177171717

Approved by J.A. Shively

061-0381

Voreman