

LATITUDE 39° 40' 00"

LONGITUDE 80° 07' 30"

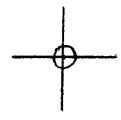

7.5 OGIS topo location

7.5' loc 1.645 15' loc _____
' 2.11W (calc.) _____

Company _____

Farm DJ Eddy 16

Quad BLACKSVILLE 7 1/2'

County MONONGALIA

District CLAY

Obs 1240± (TOPO)

WELL LOCATION MAP

File No. OGI-0487

13940

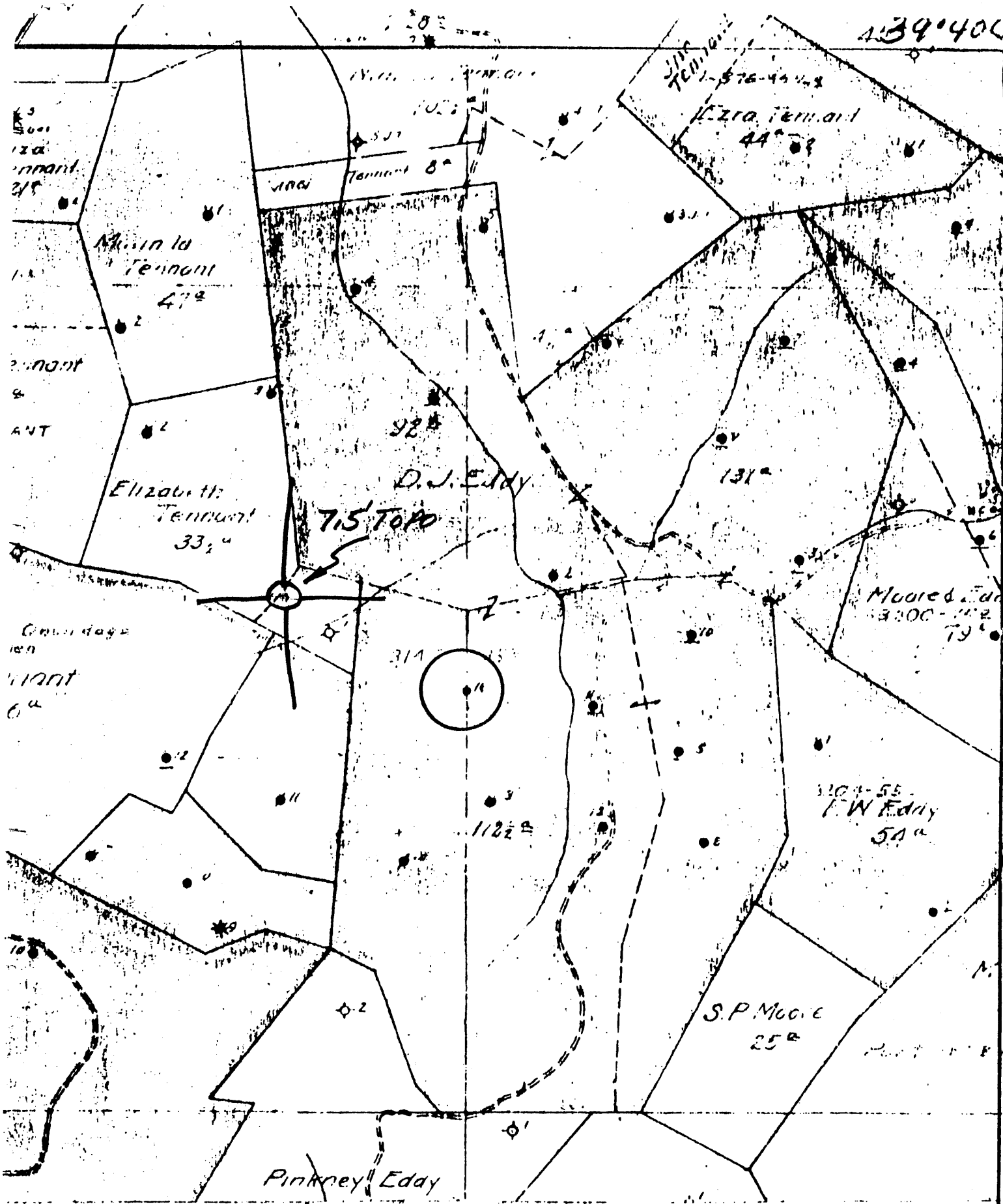

(+) DENOTES LOCATION OF WELL ON UNITED STATES TOPOGRAPHIC MAPS



DATE 1-24- 1979
 OPERATOR'S WELL NO. 16
 API WELL NO. 47-061-0487
 STATE COUNTY PERMIT

FORM IV-6
(8-78)

N72E N12 E25

STATE OF WEST VIRGINIA
DEPARTMENT OF MINES
OIL AND GAS DIVISION

WELL TYPE: OIL GAS _____ LIQUID INJECTION _____ WASTE DISPOSAL _____
 (IF "GAS", PRODUCTION _____ STORAGE _____ DEEP _____ SHALLOW _____)
 LOCATION: ELEVATION _____ WATER SHED JAKES RUN
 DISTRICT CLAY COUNTY MONONGALIA
 QUADRANGLE BLACKVILLE 7151

SURFACE OWNER _____ ACREAGE _____
 OIL & GAS ROYALTY OWNER _____ LEASE ACREAGE _____

LEASE NO. _____
 PROPOSED WORK: DRILL _____ CONVERT _____ DRILL DEEPER _____ REDRILL _____ FRACTURE OR STIMULATE _____ PLUS OFF OLD FORMATION _____ PERFORATE NEW FORMATION _____ OTHER PHYSICAL CHANGE IN WELL (SPECIFY) _____

PLUG AND ABANDON _____ CLEAN OUT AND REPLUS _____
 TARGET FORMATION _____ ESTIMATED DEPTH _____
 WELL OPERATOR Pennzoil Company DESIGNATED AGENT James A. Crews
 ADDRESS P. O. Box 1588 ADDRESS P. O. Box 1588
Parkersburg, WV 26101 Parkersburg, WV 26101

S. E. 25-26 W. Location Made Purchased From
 Clay Rig Completed June 20, 1896 Date Purchased
 Monongalia Dr'g Commenced blank Sold To
 West Va. Dr'g Completed " Date Sold
 Owned By Dr'g Contractor J. A. Smith Date Abandoned

FORMATION					CASING RECORD				
Kind	Top	Bottom	Steel Line Measurement	Tests	Size	Bottom Casing (Steel Line)	Put In Well (Tally Meas.)	Pulled (Tally Meas.)	Cemented
ator	14'				10"		710'	710'	Date
Goal	690'				8 1/2"		1545'	1545'	Size Csg.
ajun	1995'				6, 5/8"		1720'		Top "
ay	2098'				5, 3/16"		275'		Bot. "
depth		2126'			May. 1897 - full string 5 3/16" put in. 1995 ft. now in well.				
PACKERS AND SHOES									
Kind		Size		Depth Set		Date Set			
TORPEDO RECORD									
Date	No. Qts.	Size Shell	Top Shot	Bottom	Results				
6/2/1897	- 10								
6/20/1899	- 20								
11/23/1899	- 24								
3/9/1900	- 30								
1/22/1901	- 40								
2/15/1901	- 50								
9/30/1904	- 40	- 4 1/2" X 6' 9"							
9/30/1909	- 60	- 5-80 qt. shells	4 1/2" X 6' 9"						
Top shot shell 11 2098' - 2nd 2095' - 3rd 2096'									
DRILLING DEEPER									
Commenced	Completed	Original Depth	Final Depth	Contractor					
ABANDONMENT RECORD									
Filled With	From	To	PLUG						
			Size	Kind	Depth				

(Used gas 50 days)

d.	Sand	★ At Completion	★ 30 Days After	★

APPROVED Supt

47-061-0487