

LATITUDE 39° 40' 00"

LONGITUDE 80° 20' 00"

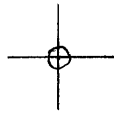

7'5 OGIS topo location

7.5' LOC 265 S 15' LOC \_\_\_\_\_  
                  1.24 W (calc.) \_\_\_\_\_

Company \_\_\_\_\_

Farm \_\_\_\_\_

Quad WADESTOWN 7 1/2'

County MONONGALIA

District BATTELLE

WELL LOCATION MAP

File No. 061-0597

INSTRUCTIONS

1) Attach a photo copy of the location of the well on a 7.5 minute Quadrangle with the corresponding Longitude and Latitude.

2) Designate the location of the well with the symbol (+).

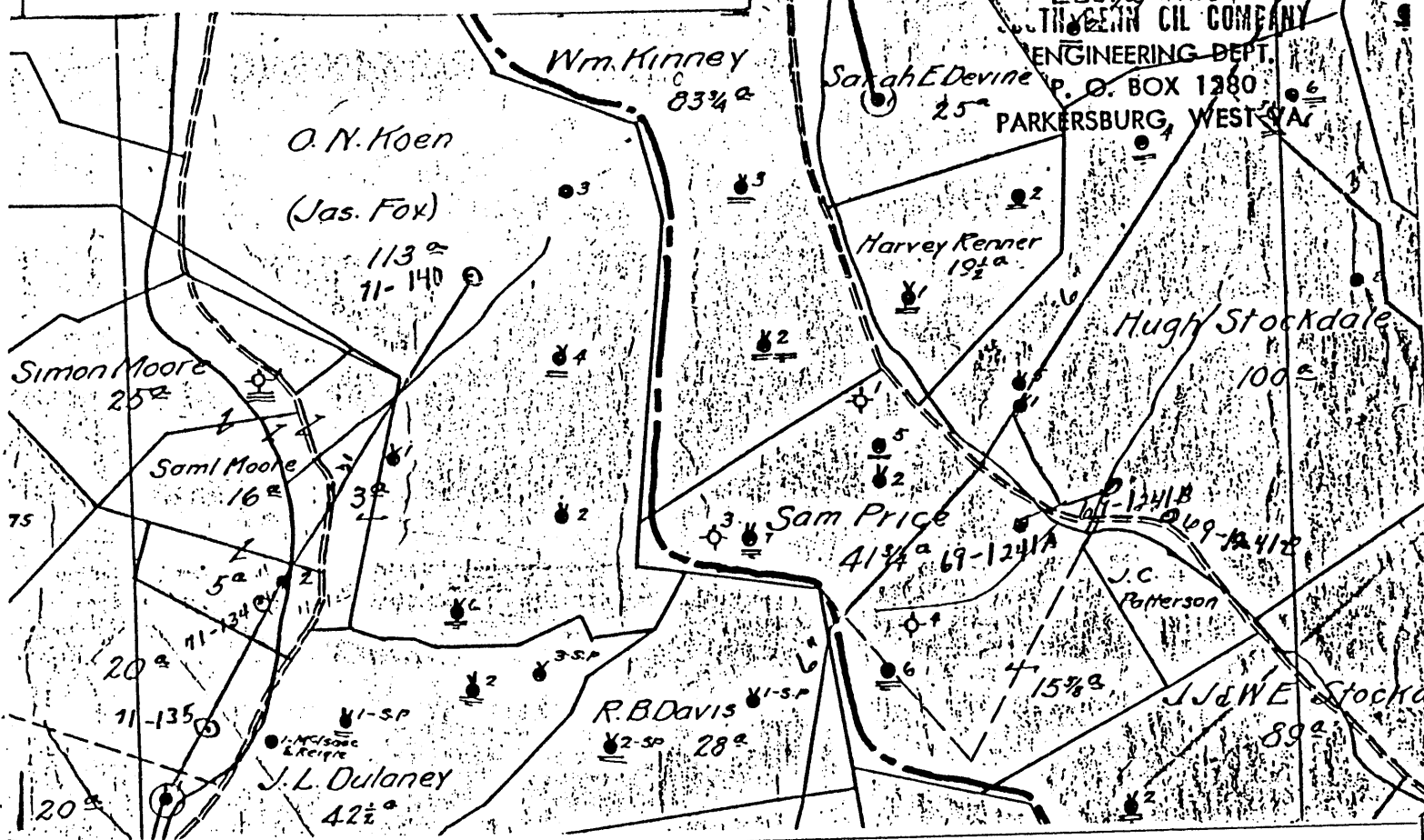

I, the undersigned, hereby certify that this plat is correct to the best of my knowledge and belief.

SIGNED William R. Ice

TITLE Agent

**RECEIVED**  
MAY 17 1988

DATE 5-12 1988

OPERATORS WELL NO Sarah E Devine H. 2

API WELL NO. 47-61-0597

DIVISION OF OIL & GAS  
DEPARTMENT OF ENERGY

STATE OF WEST VIRGINIA  
DEPARTMENT OF ENERGY  
OIL AND GAS DIVISION

of 3335 0

WELL TYPE: OIL  GAS  LIQUID INJECTION \_\_\_\_\_ WASTE DISPOSAL \_\_\_\_\_  
(IE "GAS" PRODUCTION \_\_\_\_\_ STORAGE \_\_\_\_\_ DEEP  SHALLOW \_\_\_\_\_)

LOCATION: ELEVATION N. 12 E. 15 W. WATER SHED STREAM FROM St. Leo into DUNKARD  
DISTRICT BATTELLE COUNTY MONONGALIA  
QUADRANGLE \_\_\_\_\_

SURFACE OWNER Robert Fluharty ACREAGE 120

OIL & GAS ROYALTY OWNER Robert Fluharty LEASE ACREAGE 120  
LEASE NO. 25346

PRODUCING FORMATION Fourth SAND TOTAL DEPTH 3200

WELL OPERATOR ROYALE MOORE & William R. Ice DESIGNATED AGENT William R. Ice

ADDRESS Rt #1 Box 179 ADDRESS Rt #1, Box 179  
FAIRVIEW W. VA. 26570 FAIRVIEW W. VA. 26570

LATITUDE 39° 40'

LONGITUDE 80° 22' 30"

NORTH

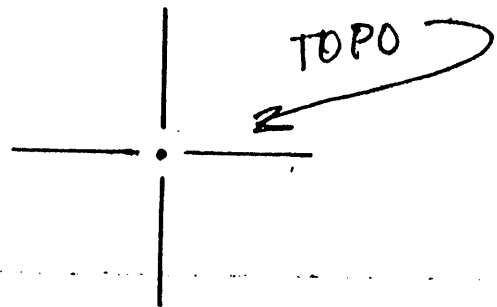
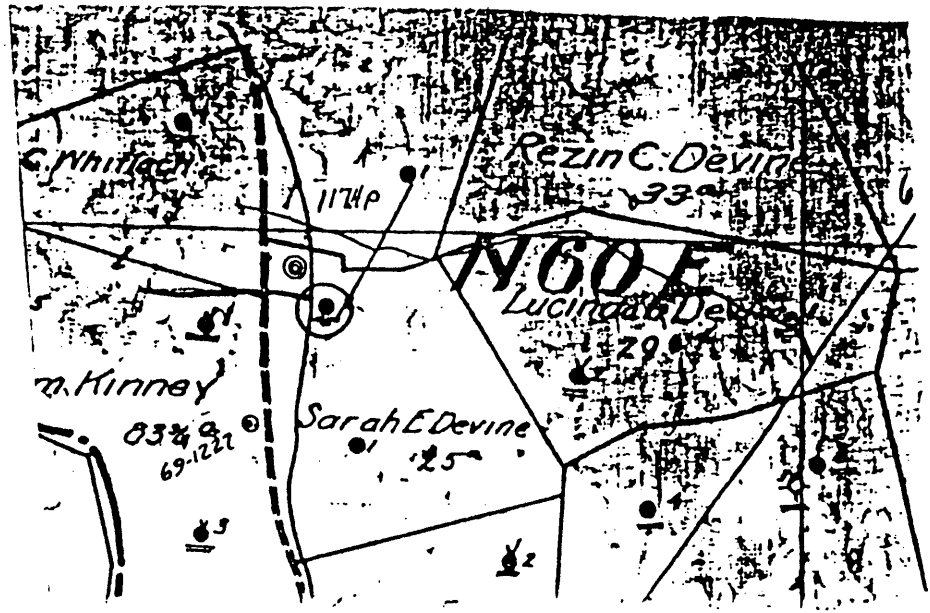

MINIMUM DEGREE OF ACCURACY \_\_\_\_\_  
 PROVEN SOURCE OF ELEVATION \_\_\_\_\_

BY LAW AND THE REGULATIONS ISSUED AND PRESCRIBED BY THE DEPARTMENT OF MINES.  
 (SIGNED) \_\_\_\_\_  
 R.P.E. \_\_\_\_\_ L.L.S. \_\_\_\_\_

PLACE SEAL HERE

(+) DENOTES LOCATION OF WELL ON UNITED STATES TOPOGRAPHIC MAPS  
 FORM IV-6  
 (8-78)



DATE 7-9, 19 79  
 OPERATOR'S WELL NO. 2  
 API WELL NO. 47-061-597  
 STATE COUNTY PERMIT  
SARAH E. DEVINE #2

STATE OF WEST VIRGINIA  
 DEPARTMENT OF MINES  
 OIL AND GAS DIVISION

WELL TYPE: OIL  GAS \_\_\_\_\_ LIQUID INJECTION \_\_\_\_\_ WASTE DISPOSAL \_\_\_\_\_  
 ( IF "GAS", PRODUCTION \_\_\_\_\_ STORAGE \_\_\_\_\_ DEEP \_\_\_\_\_ SHALLOW \_\_\_\_\_  
 LOCATION: ELEVATION 1110.71 WATER SHED DUNKARD CREEK  
 DISTRICT BATTELLE COUNTY MONONGALIA  
 QUADRANGLE WADESTOWN 7.5  
 SURFACE OWNER \_\_\_\_\_ ACREAGE \_\_\_\_\_  
 OIL & GAS ROYALTY OWNER \_\_\_\_\_ LEASE ACREAGE \_\_\_\_\_  
 LEASE NO. \_\_\_\_\_  
 PROPOSED WORK: DRILL \_\_\_\_\_ CONVERT \_\_\_\_\_ DRILL DEEPER \_\_\_\_\_ REDRILL \_\_\_\_\_ FRACTURE OR  
 STIMULATE \_\_\_\_\_ PLUS OFF OLD FORMATION \_\_\_\_\_ PERFORATE NEW  
 FORMATION \_\_\_\_\_ OTHER PHYSICAL CHANGE IN WELL (SPECIFY) \_\_\_\_\_  
 PLUS AND ABANDON \_\_\_\_\_ CLEAN OUT AND REPLUS \_\_\_\_\_  
 TARGET FORMATION \_\_\_\_\_ ESTIMATED DEPTH \_\_\_\_\_  
 WELL OPERATOR WILLIAM R. ICE, AGENT DESIGNATED AGENT WILLIAM R. ICE, AGENT  
 ADDRESS RT 1 BOX 179 ADDRESS RT 1 BOX 179  
FAIRVIEW, WV 26570 FAIRVIEW, WV 26570

Well No. 2

Lessee No. *Bettler* District *Winnemuccia* County

Big built by *J. P. Bennett*

Well drilled by *J. P. Bennett* Contractor

Began drilling *July 22* 1907 Completed *Oct 7* 1907

BOOK POSTMASTER TOP. BOTTOM. REMARKS

EL 1110.71

*1/2* sand *14* *Steel*

*3/4* sand *530* *570* *Steel*

*1/2* sand *730* *1400* *Steel*

*1/2* sand *925* *2000* *Steel*

*1/2* sand *1300* *2545* *Steel*

*1/2* sand *1400* *3054* *Steel*

*1/2* sand *1555* *3059* *Steel*

*1/2* sand *1900* *3174* *Steel*

*1/2* sand *2115* *3151* *Steel*

*1/2* sand *2125* *3154* *Steel*

*1/2* sand *2135* *3154* *Steel*

*1/2* sand *2135* *3154* *Steel*

*1/2* sand *2135* *3154* *Steel*

*1/2* sand *2135* *3154* *Steel*

*1/2* sand *2135* *3154* *Steel*

*1/2* sand *2135* *3154* *Steel*

*1/2* sand *2135* *3154* *Steel*

*1/2* sand *2135* *3154* *Steel*

*1/2* sand *2135* *3154* *Steel*

*1/2* sand *2135* *3154* *Steel*

CASINO RECORD.

*Shot 7/19-20/07*

| CHARGED TO WELL. | POT IN WELL. | PULLED OUT. | LEFT IN WELL. | Transferred before Completion. | Left at Well Not in Use. |
|------------------|--------------|-------------|---------------|--------------------------------|--------------------------|
| Post. In.        | Post. In.    | Post. In.   | Post. In.     | Post. In.                      | Post. In.                |
| 265              | 265          | 265         |               | 265                            |                          |
| 1400             | 1400         | 1400        |               | 1400                           |                          |
| 2000             | 2000         |             | 2000          |                                |                          |
| 2445             | 2445         |             | 2445          |                                |                          |
| 277              | 277          |             | 277           |                                |                          |

061-597