

*Jonnie 6/23/88*

LATITUDE 39° 37' 30"

← 2050 →

↑ 2,430 ↓

LONGITUDE 80° 17' 30"

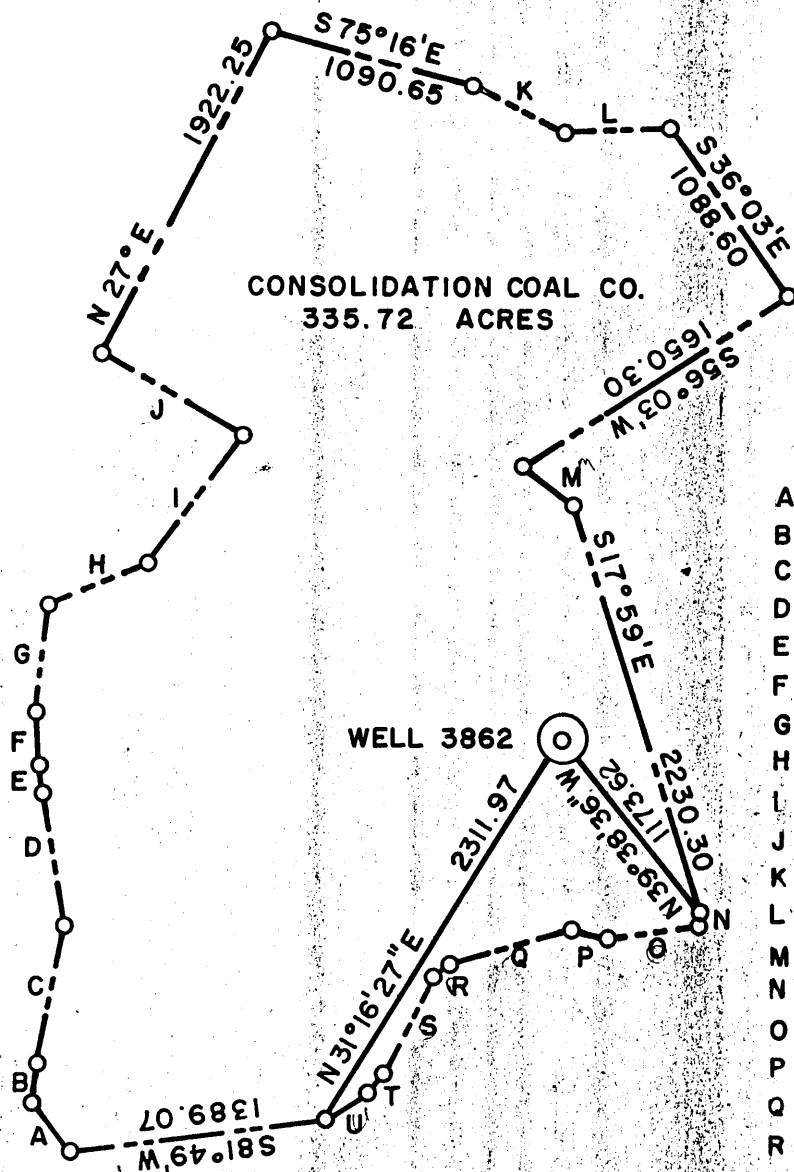

CONSOLIDATION COAL CO.  
335.72 ACRES

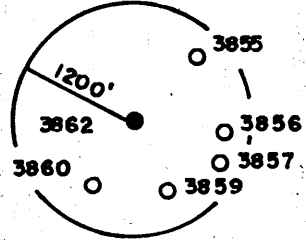

A	= N 38° 30' W	313.50
B	= N 7° 00' E	198.00
C	= N 11° 00' E	726.00
D	= N 10° 00' W	701.25
E	= N 6° 52' W	123.75
F	= N 5° 00' W	280.50
G	= N 6° 24' E	577.50
H	= N 67° 00' E	569.25
I	= N 36° 00' E	841.50
J	= N 60° 24' W	858.00
K	= S 63° 30' E	541.20
L	= N 87° 00' E	564.30
M	= S 54° 11' E	338.60
N	= S 12° 11' W	61.40
O	= S 81° 12' W	487.11
P	= N 77° 48' W	198.15
Q	= S 73° 37' W	655.81
R	= S 55° 31' W	99.07
S	= S 27° 01' W	584.53
T	= S 41° 48' W	113.90
U	= S 57° 32' W	247.51

*Calc 15/100  
3.345  
2.61W*

(+) DENOTES LOCATION OF WELL ON UNITED STATES TOPOGRAPHIC MAPS

FILE NO. \_\_\_\_\_  
DRAWING NO. \_\_\_\_\_  
SCALE 1" = 1000'  
MINIMUM DEGREE OF ACCURACY 1 IN 5000  
PROVEN SOURCE OF ELEVATION COMPANY SURVEY  
TIED INTO U.S.G.S. NETWORK

I THE UNDERSIGNED, HEREBY CERTIFY THAT THIS PLAT IS CORRECT TO THE BEST OF MY KNOWLEDGE AND BELIEF AND SHOWS ALL THE INFORMATION REQUIRED BY LAW AND THE REGULATIONS ISSUED AND PRESCRIBED BY THE DEPARTMENT OF ENERGY  
(SIGNED) *Carl Morris*  
R.P.E. \_\_\_\_\_ L.L.S. 460

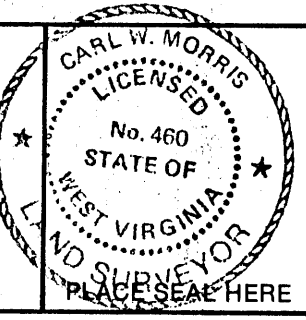

STATE OF WEST VIRGINIA  
DEPARTMENT OF ENERGY  
OIL AND GAS DIVISION



DATE MAY 5 19 88  
OPERATOR'S WELL NO. 3862  
API WELL NO. \_\_\_\_\_

WELL TYPE: OIL \_\_\_ GAS \_\_\_ LIQUID INJECTION \_\_\_ WASTE DISPOSAL \_\_\_  
(IF "GAS,") PRODUCTION \_\_\_ STORAGE \_\_\_ DEEP \_\_\_ SHALLOW  ABANDONED

LOCATION: ELEVATION 1230.13 WATER SHED PAW PAW  
DISTRICT BATTELLE COUNTY MONONGALIA

QUADRANGLE MANNINGTON W.V. + 15' EC  
SURFACE OWNER CONSOLIDATION COAL CO. ACREAGE 335.72

OIL & GAS ROYALTY OWNER \_\_\_\_\_ LEASE ACREAGE \_\_\_\_\_  
LEASE NO. \_\_\_\_\_

PROPOSED WORK: DRILL \_\_\_ CONVERT \_\_\_ DRILL DEEPER \_\_\_ REDRILL  FRACTURE OR STIMULATE \_\_\_ PLUG OFF OLD FORMATION \_\_\_ PERFORATE NEW FORMATION \_\_\_ OTHER PHYSICAL CHANGE IN WELL (SPECIFY) \_\_\_\_\_

PLUG AND ABANDON \_\_\_ CLEAN OUT AND REPLUG   
TARGET FORMATION NONE ESTIMATED DEPTH \_\_\_\_\_  
WELL OPERATOR CONSOLIDATION COAL CO. DESIGNATED AGENT ROGER E. DUCKWORTH  
ADDRESS P.O. BOX 1314 MORGANTOWN W.V. 26505 ADDRESS P.O. BOX 1314 MORGANTOWN W.V. 26505

JUL 1 1988

H.T. HALL 48673 FORM WW-6

COUNTY NAME

PERMIT

**RECEIVED**  
AUG 19 1988

AFFIDAVIT OF PLUGGING AND FILLING WELL

AFFIDAVIT SHOULD BE MADE IN TRIPLICATE, one copy mailed to the DEPARTMENT OF ENERGY to be retained by the Well Operator and the third copy (and extra copies if required) should be mailed to each coal operator at their respective addresses.

Consolidation Coal Company  
Coal Operator or Owner  
P. O. Box 1314, Morgantown, WV 26507-1314  
Address

Consolidation Coal Company  
Coal Operator or Owner  
Address

Consolidation Coal Company  
Lease or Property Owner  
P. O. Box 1314, Morgantown, WV 26507-1314  
Address

Consolidation Coal Company  
Name of Well Operator  
P. O. Box 1314, Morgantown, WV 26507-1314  
Complete Address

August 13, 19 88  
WELL AND LOCATION

Battelle District

Monongalia County

WELL NO. 3862

Consolidation Coal Company Farm

STATE INSPECTOR SUPERVISING PLUGGING Don Ellis, Fairmont, WV 26554

AFFIDAVIT

STATE OF WEST VIRGINIA,

County of Harrison

ss:

Calvin C. Lofton

and

George R. Gore

being first duly sworn according to law depose and say that they are experienced in the work of plugging and filling oil and gas wells and were employed by Consolidation Coal Company, well operator, and participated in the work of plugging and filling the above well, that said work was commenced on the 26th day of July, 19 88, and that the well was plugged and filled in the following manner:

Sand or Zone Record Formation	Filling Material	Plugs Used Size & Kind	Casing	
			CSG PULLED	CSG LEFT IN
Cleaned 9 7/8" hole to 258'. Reduced hole to 7 7/8" at 258'. Cleaned 7 7/8" hole to 727'. Reduced hole to 6 1/2" at 727'. Cleaned 6 1/2" hole to 1,570'. Extreme caving from 1,132' to 1,425'. 6 5/8" casing left in hole from 1,425' to 1,570'. Run coal protection string as follows: 389.06' of 2 3/8" tubing followed by 1,109.01' of 4 1/2" casing. Latch down plug at 1,986.78'. Float valve at 1,109.01'. Swedge at 1,110.01'. Circulated cement to surface as follows: Pumped 640 sacks of poz mix followed by 380 sacks of expanding cement. Displaced cement to 1,086.78' with water. Let set, bailed dry.				
TOTAL DEPTH: 1,498.07 FEET.				
Coal Seams				
(Name) Pittsburgh	920 feet to 928 feet			
(Name)				
(Name)				
(Name)				

*W. J. 8/30/88*

Description of Monument  
5 feet of 4 1/2" casing with  
plaque stating:  
Consol #3862  
#47-061-0869-P

and that the work of plugging and filling said well was completed on the 10th day of August, 19 88.

And further deponents saith not.

*Calvin C. Lofton*  
*George R. Gore*

Sworn to and subscribed before me this 13th day of August, 19 88.

My commission expires:  
APRIL 21, 1993

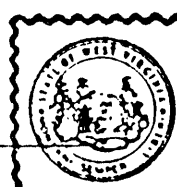

OFFICIAL SEAL  
NOTARY PUBLIC  
STATE OF WEST VIRGINIA  
Timothy L. Cotter  
1000 Goodwin Ave  
Clarksburg, WV 26301  
My Commission Expires April 21, 1993

SEP 06 1988  
Permit No. 47-061-0869-P