

LATITUDE 39 - 42 - 30

11,730'

LONGITUDE 80 - 17 - 30
13,610'

WELL REFERENCES

S15W, 99' to 10" Elm tree
N63E, 99' to 4" White Ash tree

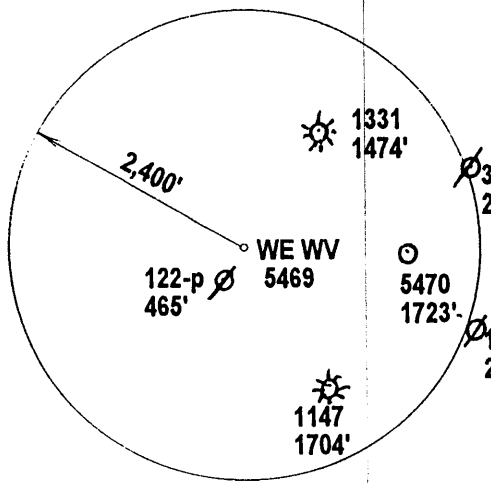

Th. Sanders

"561"
S 86°00'00"E

"280.50"
S 47°00'00"W

Corner Post with
Lrg. Wild Cherry
witness

"511.50"
N 27°00'00"E

566.94'
N 68°59'30"E

36" White Oak, found on knob

Kenneth Parrish

N 63°00'00"E
99.00'

495.00'
N 50°00'00"E

WE WV
5419

396.00'
S 27°00'00"E

S 11°00'00"E
165.00'

Arthur Cowell

N 26°00'00"E
231.00'

N 90°00'00"E
1254.00'

deed closure
N 20°00'00"W
148.50'

330.00'
N 25°00'00"W

N 5°00'00"W
165.00'

N 21°00'00"W
100.173'

N 38°00'00"W
198.00'

S 90°00'00"W
660.00'

Donzel and Donna J. Walls
104.40 Ac.

WE WV 5469
(6 RIGHT - 1)

S 4°00'00"E
594.00'

S 35°00'00"E
528.00'

Betty Baird

S 25°00'00"W
1006.50'

W. C. Mason

ROUTE 11

N 74°00'00"W
668.25'

N 76°00'00"W
726.00'

Note: The near mine boundary
is WNW by 3300 feet +/-.

NAD 27 WV North Coor of 5469 Stake.
N 427,472 E 1,765,543

(+) DENOTES LOCATION OF WELL ON UNITED STATES TOPOGRAPHIC MAPS

FILE & DRAWING NO.	
SCALE	1" = 500'
MINIMUM DEGREE OF ACCURACY	1 in 2500
PROVEN SOURCE OF ELEVATION	GPS Survey

FORM WV-6

I THE UNDERSIGNED, HEREBY CERTIFY THAT THIS PLAT IS CORRECT TO THE BEST OF MY KNOWLEDGE AND BELIEF AND SHOWS ALL THE INFORMATION REQUIRED BY LAW AND THE REGULATIONS ISSUED AND PRESCRIBED BY THE DIVISION OF ENVIRONMENTAL PROTECTION.

(SIGNED) *J. Michael Evans*
PROFESSIONAL SURVEYOR # 900

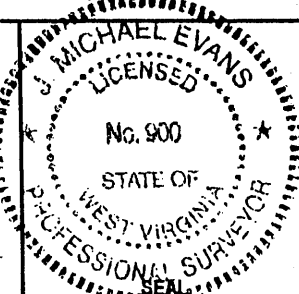

LAND SURVEYING SERVICES
21 CEDAR LANE
BRIDGEPORT, WV 26330
PHONE: 304-842-2018 OR 842-6762

STATE OF WEST VIRGINIA
DIVISION OF ENVIRONMENTAL PROTECTION
OFFICE OF OIL AND GAS
#10 McJUNKIN ROAD, NITRO, WV 25143-2606

DATE September 13, 1999

OPERATORS WELL NO. WE WV 5469

API WELL NO. 6 Right-1

047 STATE 061 COUNTY 01376C PERMIT

WELL TYPE: OIL ___ GAS LIQUID INJECTION ___ WASTE DISPOSAL ___
(IF "GAS",) PRODUCTION STORAGE ___ DEEP ___ SHALLOW
LOCATION: ELEVATION 1,295' WATERSHED West Virginia Fork
DISTRICT Battelle COUNTY Monongalia
QUADRANGLE Wadestown 7.5'

SURFACE OWNER Donzel Walls ACREAGE 104.4 Acres
OIL & GAS ROYALTY OWNER Donzel Walls LEASE ACREAGE 104.4 Acres

PROPOSED WORK: DRILL ___ CONVERT ___ DRILL DEEPER ___ REDRILL ___ FRACTURE OR STIMULATE ___ PLUG OFF OLD FORMATION ___
PERFORATE NEW FORMATION ___ OTHER PHYSICAL CHANGE IN WELL (SPECIFY) Produce methane gas through existing mine vent
PLUG AND ABANDON ___ CLEAN OUT AND REPLUG ___

TARGET FORMATION Pittsburgh Gob ESTIMATED DEPTH 1057'
WELL OPERATOR CNG Producing Company DESIGNATED AGENT Rodney J. Biggs
ADDRESS Route 2, Box 698, Bridgeport, WV 26330 ADDRESS Route 2, Box 698, Bridgeport, WV 26330

NOV 8 1999

COUNTY NAME PERMIT