

LATITUDE 39°37'30"

LONGITUDE 80°17'30"

WELL LOCATION
UTM 17-NAD83
N:4385050.64
E:559848.19
 NAD83, WV NORTH
 N:406439.88
 E:1742339.43
 LAT/LOG DATUM-WGS84
 LAT:39°36'47.22"
 LON:80°18'10.05"

CONSOLIDATION COAL COMPANY

LOCUST

COORDINATES:
 4,328.67' WEST
 3,133.33' SOUTH

CONSOLIDATION COAL COMPANY
 TM/PAR 1-27/20
 DB/PG 967/68
 150 AC ±

CONSOLIDATION COAL COMPANY

SHIRLEY WALKER



W.O.

N 58°33'42" W 4995.9070'

WELL L-86

CONSOLIDATION COAL COMPANY

HERSHEL WISE
NANCY GROOMS

S 80°41'03" W 4224.1208'

HIGHLAND CEMETERY

CONSOLIDATION COAL COMPANY



Blue Mountain Engineering
 11023 MASON DIXON HIGHWAY
 BURTON, WV 26562
 PHONE: (304) 662-6486

NOTE:
 It is not the purpose or intention of this plat to represent surveyed locations of the surface or mineral parcels depicted hereon. The location of the boundary lines, as shown, are based on record deed descriptions, field evidence found and/or tax map position, unless otherwise noted.

OIL & GAS WELLS WITHIN 1200 ft.

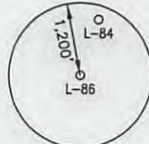

REFERENCE NOT TO SCALE

FILE #: L-86
 DRAWING #: L-86
 SCALE: 1" = 700'
 MINIMUM DEGREE OF ACCURACY: 1/2500
 PROVEN SOURCE OF ELEVATION: U.S.G.S. MONUMENT THOMAS 1498.81'

I, THE UNDERSIGNED, HEREBY CERTIFY THAT THIS PLAT IS CORRECT TO THE BEST OF MY KNOWLEDGE AND BELIEF AND SHOWS ALL THE INFORMATION REQUIRED BY LAW AND THE REGULATIONS ISSUED AND PRESCRIBED BY THE DEPARTMENT OF ENVIRONMENTAL PROTECTION.

Signed: [Signature]

R.P.E.: _____ L.L.S.: P.S. No. 2000

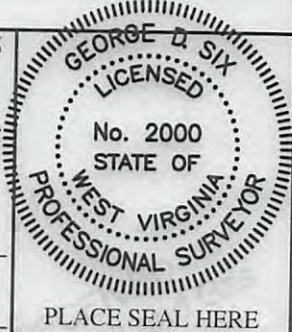

(+) DENOTES LOCATION OF WELL ON UNITED STATES TOPOGRAPHIC MAPS WVDEP
 OFFICE OF OIL & GAS
 601 57TH STREET
 CHARLESTON, WV 25304



DATE: JULY 29, 2013

OPERATOR'S WELL #: L-86

API WELL #: 47 061 01467C P
 STATE COUNTY PERMIT

Well Type: Oil Waste Disposal Production Deep Gas Liquid Injection Storage Shallow

WATERSHED: PAW PAW CREEK

ELEVATION: 1598'

COUNTY/DISTRICT: MONONGALIA / BATTELLE QUADRANGLE: MANNINGTON, WV-PA 7.5'

SURFACE OWNER: CONSOLIDATION COAL COMPANY ACREAGE: 150±

OIL & GAS ROYALTY OWNER: CONSOLIDATION COAL COMPANY, et al ACREAGE: _____

DRILL CONVERT DRILL DEEPER REDRILL FRACTURE OR STIMULATE
 PLUG OFF OLD FORMATION PERFORATE NEW FORMATION PLUG & ABANDON
 CLEAN OUT & REPLUG OTHER CHANGE (SPECIFY): _____

TARGET FORMATION: PITTSBURGH ESTIMATED DEPTH: 1195'

WELL OPERATOR CNX GAS COMPANY LLC DESIGNATED AGENT JEREMY JONES

Address 200 EVERGREENE Dr. Address ONE DOMINION DRIVE

City WAYNESBURG State PA Zip Code 15370 City JANE LEW State WV Zip Code 26578

11/08/2013

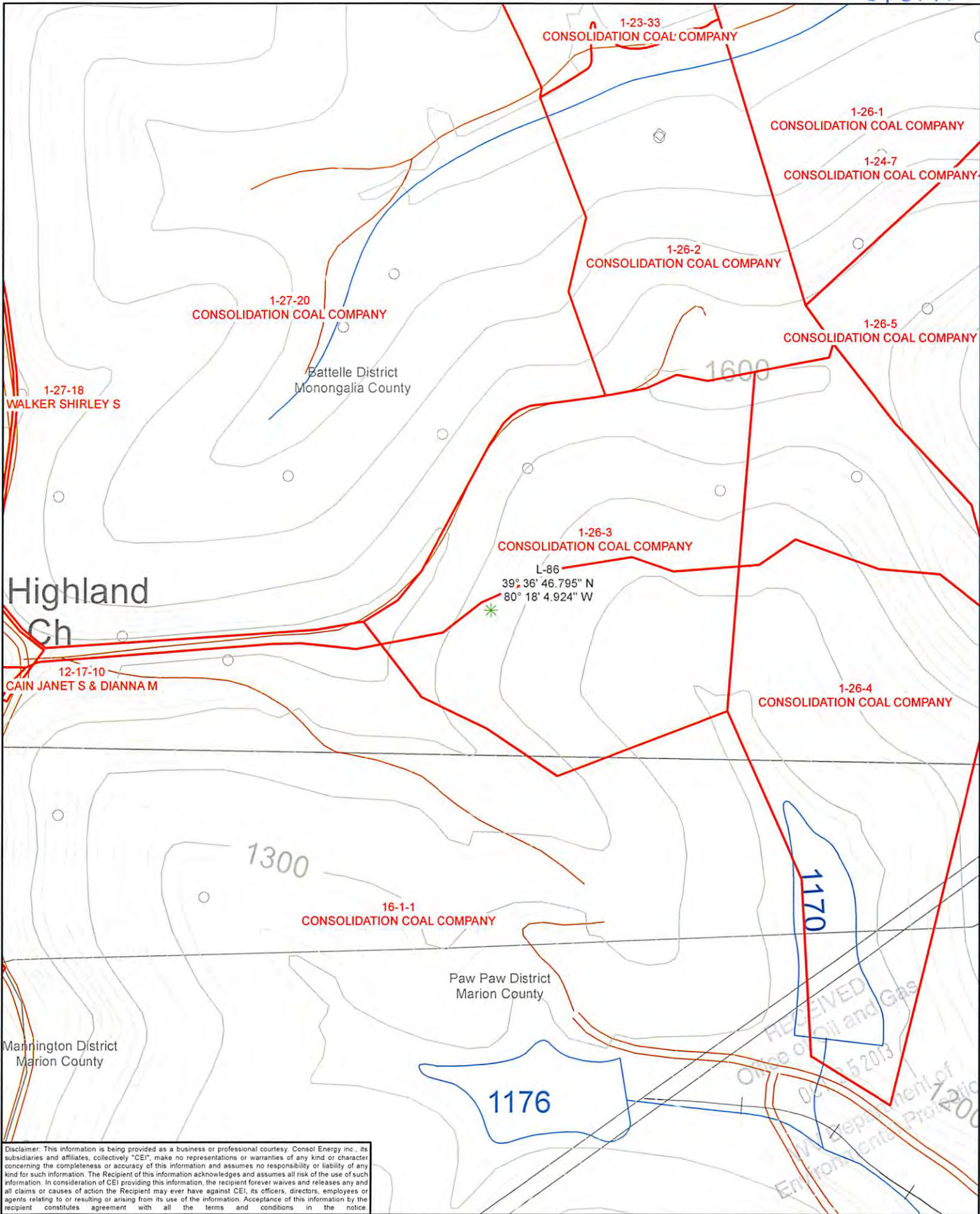

Disclaimer: This information is being provided as a business or professional courtesy. Consol Energy Inc., its subsidiaries and affiliates, collectively "CEI", make no representations or warranties of any kind or character concerning the completeness or accuracy of this information and assumes no responsibility or liability of any kind for such information. The Recipient of this information acknowledges and assumes all risk of the use of such information. In consideration of CEI providing this information, the recipient forever waives and releases any and all claims or causes of action the Recipient may ever have against CEI, its officers, directors, employees or agents relating to or resulting or arising from its use of the information. Acceptance of this information by the recipient constitutes agreement with all the terms and conditions in the notice.

Legend		
GOB Well	Surface Property	
District / County		

<p>1 inch = 500 feet</p>	
Date: 7/10/2013	Prepared By: K. McCartney
Revisions:	Approved By:
<p>This map is property of CONSOL Energy Inc. and contains information that is proprietary and confidential in nature and may not be copied or reproduced without prior written consent.</p>	

CONSOL ENERGY

GOB Well Location Map
Well L-86 for Plugging
Loveridge Project Area

RECEIVED
Office of Oil and Gas
December 5 2013
Department of Environmental Protection