



Diversified Gas & Oil Corporation  
 100 Diversified Way  
 Pikeville KY, 41051

47-061-01530

Well Plugging Map

**Legend**

- Well
- Access Road
- ▨ Pits
- Pad
- Public Roads

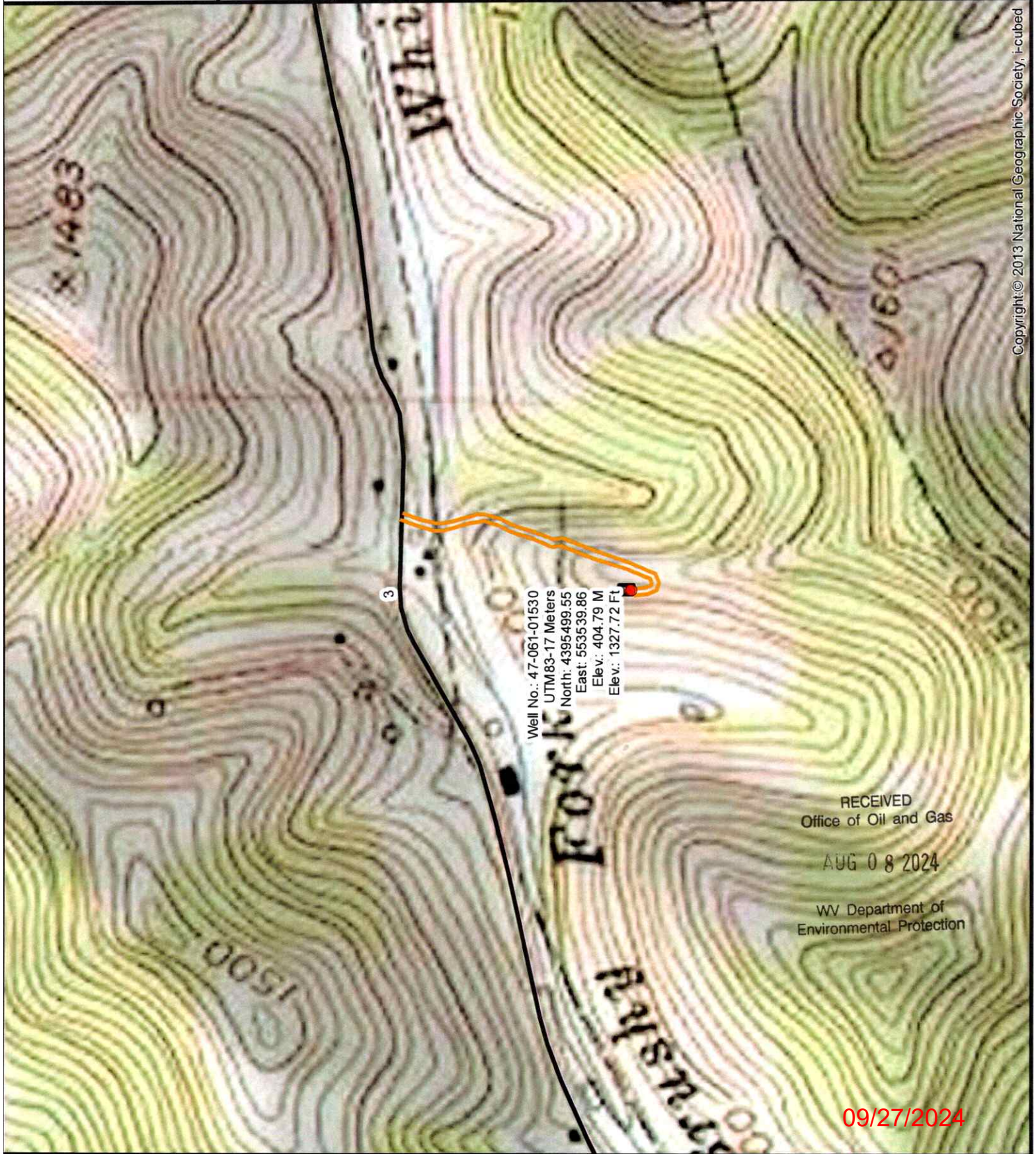







Diversified Gas & Oil Corporation  
 100 Diversified Way  
 Pikeville KY, 41051

47-061-01530

Well Plugging Map

**Legend**

-  Well
-  Access Road
-  Pits
-  Pad
-  Public Roads

RECEIVED  
 Office of Oil and Gas

AUG 08 2024

WV Department of  
 Environmental Protection

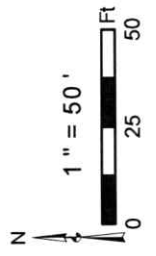

Secondary Pit  
 Primary Pit

Well No.: 47-061-01530  
 UTM83-17, Meters  
 North: 4395499.55  
 East: 553539.86  
 Elev.: 404.79 M  
 Elev.: 1327.72 Ft

Source: Esri, Maxar, Earthstar Geographics, and the GIS User Community

09/27/2024



West Virginia Department of Environmental Protection  
Office of Oil and Gas  
**WELL LOCATION FORM: GPS**

API: 4706101530 WELL NO.: SC14A

FARM NAME: Moore

RESPONSIBLE PARTY NAME: Diversified Production, LLC

COUNTY: Monongalia DISTRICT: Batelle

QUADRANGLE: Hundred 7.5'

SURFACE OWNER: Edgar A Moore, Jr. & Seth Allen Moore

ROYALTY OWNER: Terra Firma Company & Consolidation Coal Company

UTM GPS NORTHING: 4395499.55

UTM GPS EASTING: 553539.86 GPS ELEVATION: 1327.72'

The Responsible Party named above has chosen to submit GPS coordinates in lieu of preparing a new well location plat for a plugging permit or assigned API number on the above well. The Office of Oil and Gas will not accept GPS coordinates that do not meet the following requirements:

- Datum: NAD 1983, Zone: 17 North, Coordinate Units: meters, Altitude: height above mean sea level (MSL) – meters.
- Accuracy to Datum – 3.05 meters
- Data Collection Method:  
Survey grade GPS \_\_\_\_: Post Processed Differential \_\_\_\_  
Real-Time Differential \_\_\_\_  
Mapping Grade GPS X: Post Processed Differential X  
Real-Time Differential \_\_\_\_

RECEIVED  
Office of Oil and Gas

AUG 08 2024

WV Department of  
Environmental Protection

**4. Letter size copy of the topography map showing the well location.**

I the undersigned, hereby certify this data is correct to the best of my knowledge and belief and shows all the information required by law and the regulations issued and prescribed by the Office of Oil and Gas.

  
Signature

Chris Veazey - Director of Administration  
Title

7/31/24  
Date

09/27/2024