

**WELL (SURFACE)  
BEACH 10H  
WV-N (NAD 83)  
N: 439351.6  
E: 1785024.4  
UTM (NAD 83)  
N: 4395295.1  
E: 572685.5**

**WELL (SURFACE)  
BEACH 10H  
WV-N (NAD 83)  
N: 439351.4  
E: 1785024.4  
UTM (NAD 83)  
N: 4395295.8  
E: 572685.5**

**WELL (LANDING  
POINT) BEACH 10H  
WV-N (NAD 83)  
N: 439559.9  
E: 1786533.1  
UTM (NAD 83)  
N: 4395366.3  
E: 573144.2**

- WELL REFERENCE  
(API#, DISTANCE TO LATERAL)**
- 061-00120
  - 061-00125
  - 061-30121
  - 061-00126
  - 061-00134
  - 061-30187
  - 061-71252
  - 061-71251 N 42°52'01" W 1,345'
  - 061-70273 N 84°24'05" W 719'
  - 061-70075
  - 061-71226
  - 061-30151 N 66°16'46" E 896'
  - 061-71250 S 63°55'54" E 1,376'
  - 061-71256
  - 061-00766
  - 061-71260
  - 061-71254 S 69°13'33" W 1,253'
  - 061-71253
  - 061-71255 S 50°27'10" W 1,213'
  - 061-00101
  - 061-30280
  - 061-71259
  - 061-30559
  - 061-30531
  - 061-71257
  - 061-30338
  - 061-00148
  - 061-71258
  - 061-30186 S 25°05'37" W 618'

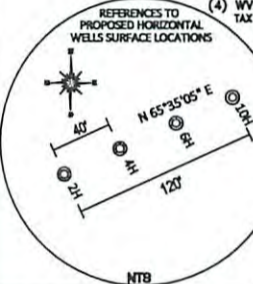

**TOP HOLE (UTM 83)  
N) 4395295.0  
E) 572685.5**

**BOTTOM HOLE (UTM 83)  
N) 4393354.6  
E) 574370.5**

**WELL (BOTTOM)  
BEACH 10H  
WV-N (NAD 83)  
N: 433569.5  
E: 1789990.0  
UTM (NAD 83)  
N: 4393558.7  
E: 574227.9**

**WELL (BOTTOM)  
BEACH 10H  
WV-N (NAD 83)  
N: 432891.8  
E: 1790446.8  
UTM (NAD 83)  
N: 4393354.6  
E: 574370.5**

**REFERENCE NOTES**  
Boundaries as shown taken from deeds, tax maps and field locations. A full boundary survey is not expressed nor implied. All bearings are based on true north. Ownership taken from public records Ohio County, West Virginia OCTOBER 2013  
State Plane Coordinates & NAD 83 Lat/Long by differential submeter mapping grade GPS  
Drafted by: E.A.M.

NO DWELLINGS WERE FOUND WITHIN 625' OF THE CENTER OF WELL PAD  
NO WATER WELLS WERE FOUND WITHIN 250' OF THE CENTER OF WELL PAD

FILE #: NNE009  
DRAWING #: 2296  
SCALE: PLAT = (1"=1400')  
TICK MARK = (1"=2000')  
MINIMUM DEGREE OF ACCURACY: 1/200  
PROVEN SOURCE: SUBMETER MAPPING  
OF ELEVATION: GRADE GPS

I, THE UNDERSIGNED, HEREBY CERTIFY THAT THIS PLAT IS CORRECT TO THE BEST OF MY KNOWLEDGE AND BELIEF AND SHOWS ALL THE INFORMATION REQUIRED BY LAW AND THE REGULATIONS ISSUED AND PRESCRIBED BY THE DEPARTMENT OF ENVIRONMENTAL PROTECTION.

Signed: *[Signature]*  
L.L.S. #2124 : Ernest J. Benchek III



(+) DENOTES LOCATION OF WELL ON UNITED STATES TOPOGRAPHIC MAPS  
WVDEP  
OFFICE OF OIL & GAS  
601 57TH STREET  
CHARLESTON, WV 25304  
Well Type:  Oil  Waste Diposal  Production  Deep  
 Gas  Liquid Injection  Storage  Shallow  
WATERSHED: DUNKARD CREEK  
COUNTY/DISTRICT: MONONGALIA / CLAY  
SURFACE OWNER: NANCY K. BEACH DAVIS & RUSSELL C. BEACH  
OIL & GAS ROYALTY OWNER: (SEE ATTACHMENT)  
LEASE NUMBERS:

DATE: APRIL 3, 2015  
OPERATOR'S WELL #: BEACH 10H AS DRILLED PLAT  
API WELL #: 47 61  
STATE COUNTY PERMIT  
ELEVATION: 1361'  
QUADRANGLE: BLACKSVILLE, WV.  
ACREAGE: 233.72 +/-  
ACREAGE: 860.63 +/-

DRILL  CONVERT  DRILL DEEPER  REDRILL  FRACTURE OR STIMULATE   
PLUG OFF FORMATION  PERFORATE NEW FORMATION  PLUG & ABANDON   
CLEAN OUT & REPLUG  OTHER CHANGE  (SPECIFY):  
TARGET FORMATION: MARCELLUS  
ESTIMATED DEPTH: TVD: 8,119' TMD: 15,961'  
WELL OPERATOR : NORTHEAST NATURAL ENERGY LLC  
DESIGNATED AGENT : JOHN ADAMS  
ADDRESS: 707 VIRGINIA STREET SUITE 1200  
ADDRESS: 707 VIRGINIA STREET SUITE 1200  
CITY: CHARLESTON STATE: WV ZIP CODE: 25301  
CITY: CHARLESTON STATE: WV ZIP CODE: 25301

06/05/2015