

TOP HOLE (UTM NAD 83)
 N) 4391546.9
 E) 577773.3

BOTTOM HOLE (UTM NAD 83)
 N) 4393617.7
 E) 576693.2

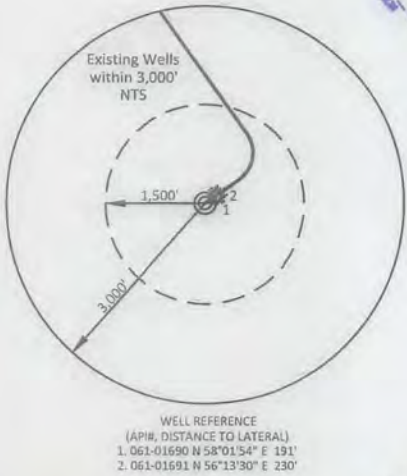
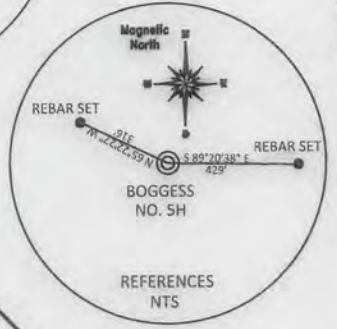
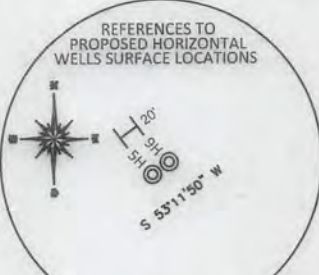

WELL REFERENCE
 (API#, DISTANCE TO LATERAL)
 1. 061-01690 N 58°01'54" E 191'
 2. 061-01691 N 56°13'30" E 230'

REFERENCE NOTES
 Boundaries as shown taken from deeds, tax maps and field locations. A full boundary survey is not expressed nor implied. All bearings are based on true north. Ownership taken from public records MONONGALIA County, West Virginia JUNE 2013
 State Plane Coordinates & NAD 83 Lat/Long by differential submeter mapping grade GPS
 Drafted by: EAK

NOTE:
 NO WATER WELLS WERE FOUND WITHIN 250' OF THE CENTER OF WELL PAD.
 NO DWELLINGS WERE FOUND WITHIN 625' OF THE CENTER OF WELL PAD.

FILE #: NEE14

DRAWING #: 2459

SCALE: PLAT: 1" = 1600'
 TICK MARK: 1" = 2000'

MINIMUM DEGREE OF ACCURACY: 1/200

PROVEN SOURCE OF ELEVATION: SUBMETER MAPPING GRADE GPS

I, THE UNDERSIGNED, HEREBY CERTIFY THAT THIS PLAT IS CORRECT TO THE BEST OF MY KNOWLEDGE AND BELIEF AND SHOWS ALL THE INFORMATION REQUIRED BY LAW AND THE REGULATIONS ISSUED AND PRESCRIBED BY THE DEPARTMENT OF ENVIRONMENTAL PROTECTION.

Signed: *[Signature]*

L.L.S. #2124 : Ernest J. Benchek III

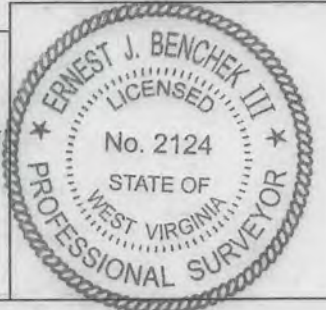

(+) DENOTES LOCATION OF WELL ON UNITED STATES TOPOGRAPHIC MAPS WVDEP

OFFICE OF OIL & GAS
 601 57TH STREET
 CHARLESTON, WV 25304

Well Type: Oil Waste Diposal Production Deep
 Gas Liquid Injection Storage Shallow

WATERSHED: DUNKARD CREEK ELEVATION: 1,268'

COUNTY/DISTRICT: MONONGALIA / CLAY QUADRANGLE: OSAGE, WV

SURFACE OWNER: BLAKE R. & PRESTON H. BOGGESS ACREAGE: 389.96 +/-

OIL & GAS ROYALTY OWNER: BLAKE R. & PRESTON H. BOGGESS ACREAGE: 920.50 +/-

LEASE NUMBERS:

DRILL CONVERT DRILL DEEPER REDRILL FRACTURE OR STIMULATE
 PLUG OFF FORMATION PERFORATE NEW FORMATION PLUG & ABANDON
 CLEAN OUT & REPLUG OTHER CHANGE (SPECIFY):

TARGET FORMATION: MARCELLUS ESTIMATED DEPTH: TVD: 8,902' TMD: 16,004'

WELL OPERATOR: NORTHEAST NATURAL ENERGY LLC DESIGNATED AGENT: JOHN ADAMS
 ADDRESS: 707 VIRGINIA STREET EAST, SUITE 1200 ADDRESS: 707 VIRGINIA STREET EAST, SUITE 1200
 CITY: CHARLESTON STATE: WV ZIP CODE: 25301 CITY: CHARLESTON STATE: WV ZIP CODE: 25301

11/06/2015

SURFACE HOLE DEC. LAT: 39.670122
 SURVEYED LAT: 39° 40' 12.4"

WELL: BOGGESS NO. 5H
OSAGE, WV

