

SURFACE HOLE DEC. LONG: 79.980133
 SURVEYED LONG: 79° 58' 48.8"

6140'

Latitude: 39° 37' 30" (NAD 27)

Longitude: 79° 57' 30" (NAD 27)

SURFACE HOLE DEC. LAT: 39.608784
 SURVEYED LAT: 39° 38' 31.7"

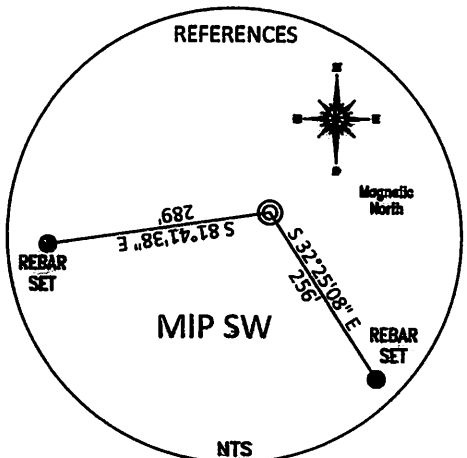

TOP HOLE (UTM NAD 83)
 N) 4384844.7
 E) 587569.3

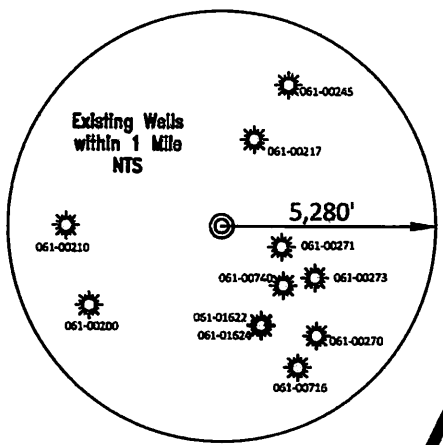

#2
 RIVER ROAD

SURFACE HOLE

ENROUTE PROPERTIES LLC.
 TAX MAP & PARCEL 11-13G-3
 LEASE NUMBER WV-061-000577-000
 WV-061-000322-001
 73.98 ACRES

NO DWELLINGS FOUND WITHIN 650' OF THE CENTER OF THE WELL PAD.
 NO WATER WELLS FOUND WITHIN 250' OF THE CENTER OF WELL PAD.

WATER WELLS	
#1	N 63°35'08" E 889'
#2	N 34°44'27" W 1210'

MIP SW
 AS-BUILT ELEVATION: 1,072.91'

N 63°54'22" E
 676'

S 38°04'32" E
 796'

IRON PIN #1

POST

REFERENCE NOTES
 Coordinates on above plat are from decimeter base station and field locations. A full boundary survey is not expressed nor implied. All bearings are based on true north. Ownership taken from public records Monongalia County, West Virginia NOVEMBER 2014
 State Plane Coordinate & NAD 83 Lat/Long by differential auxiliary mapping grade GPS
 Drawn by: EAB

LEGEND

- = UNIT BOUNDARY
- = TIE LINE TO UNIT BOUNDARY

FILE #: NNE004
 DRAWING #: 2453
 SCALE: 1"=400'
 MINIMUM DEGREE OF ACCURACY: 1/200
 PROVEN SOURCE SUBMETER MAPPING OF ELEVATION: GRADE GPS

I, THE UNDERSIGNED, HEREBY CERTIFY THAT THIS PLAT IS CORRECT TO THE BEST OF MY KNOWLEDGE AND BELIEF AND SHOWS ALL THE INFORMATION REQUIRED BY LAW AND THE REGULATIONS ISSUED AND PRESCRIBED BY THE DEPARTMENT OF ENVIRONMENTAL PROTECTION.
 Signed:
 L.L.S. #2124 : Ernest J. Benchek III

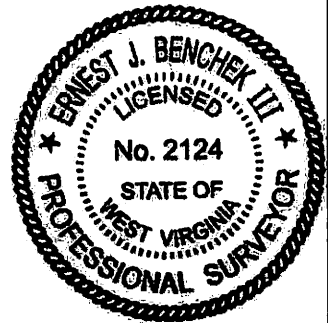

(+) DENOTES LOCATION OF WELL ON UNITED STATES TOPOGRAPHIC MAPS
 WVDEP
 OFFICE OF OIL & GAS
 601 5TH STREET
 CHARLESTON, WV 25304
 Well Type: Oil Waste Diposal Production Deep
 Gas Liquid Injection Storage Shallow
 WATERSHED: UPPER MONONGAHELA RIVER
 COUNTY/DISTRICT: MONONGALIA/GRANT
 SURFACE OWNER: ENROUTE PROPERTIES LLC.
 OIL & GAS ROYALTY OWNER: ENROUTE PROPERTIES LLC.
 LEASE NUMBERS:

DATE: JULY 21, 2015
 OPERATOR'S WELL #: MIP SW
 API WELL #: 47 61 01705400
 STATE COUNTY PERMIT
 AS-BUILT
 ELEVATION : 1,072.91'
 QUADRANGLE: MORGANTOWN SOUTH
 ACREAGE: 73.98 +/-
 ACREAGE: 73.98 +/-

07/24/2015

- DRILL CONVERT DRILL DEEPER REDRILL FRACTURE OR STIMULATE
- PLUG OFF FORMATION PERFORATE NEW FORMATION PLUG & ABANDON
- CLEAN OUT & REPLUG OTHER CHANGE (SPECIFY):

TARGET FORMATION: ONONDAGA
 WELL OPERATOR : NORTHEAST NATURAL ENERGY LLC
 ADDRESS: 707 VIRGINIA STREET - SUITE 1200
 CITY: CHARLESTON STATE: WV ZIP CODE: 25301
 ESTIMATED DEPTH: TVD: 7,672' TMD: 7,672'
 DESIGNATED AGENT : JOHN ADAMS
 ADDRESS: 707 VIRGINIA STREET - SUITE 1200
 CITY: CHARLESTON STATE: WV ZIP CODE: 25301

WELL: MIP SW
QUAD: MORGANTOWN SOUTH

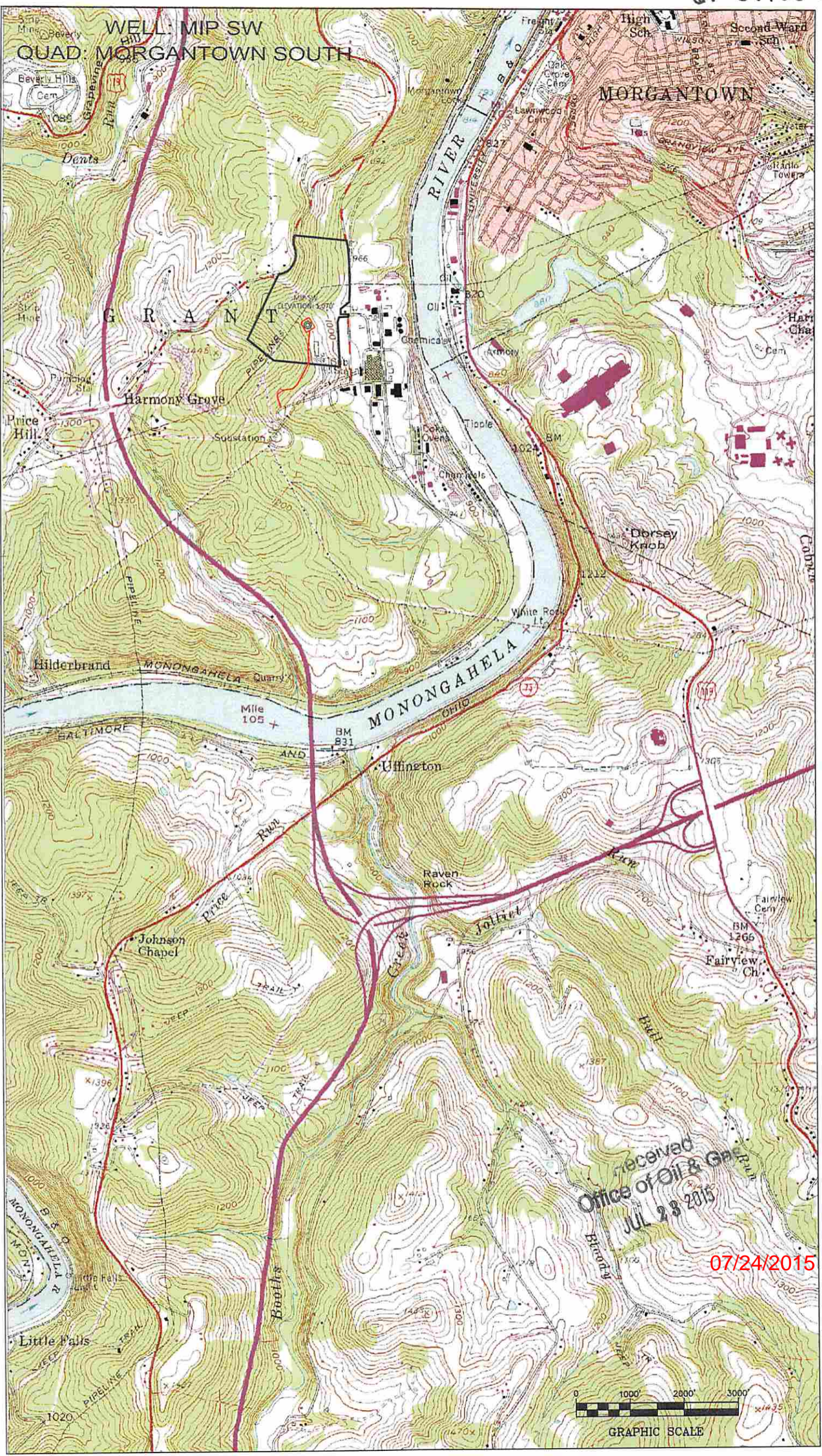

received
Office of Oil & Gas
JUL 23 2015

07/24/2015

