

12/21/2018

NOTE:
NO WATER WELLS WERE FOUND WITHIN 250' OF THE CENTER OF WELL PAD.
NO DWELLINGS WERE FOUND WITHIN 625' OF THE CENTER OF WELL PAD.

TOP HOLE (UTM NAD 83)
N) 4391554.4
E) 577783.0
BOTTOM HOLE (UTM NAD 83)
N) 4394817.1
E) 576688.0

REFERENCE NOTES:
Boundaries as shown taken from deeds, tax maps and field locations. A full boundary survey is not expressed nor implied. All bearings are based on true north. Ownership taken from public records MONONGALIA County, West Virginia 2018
State Plane Coordinates & NAD 83 Lat/Long by differential submeter mapping grade GPS checked by E.J.B.

FILE #: NEE14
DRAWING #: 2866
SCALE: PLAT: 1" = 2000'
TICK MARK: 1" = 2000'
MINIMUM DEGREE OF ACCURACY: 1/200
PROVEN SOURCE OF ELEVATION: SUBMETER MAPPING GRADE GPS

I, THE UNDERSIGNED, HEREBY CERTIFY THAT THIS PLAT IS CORRECT TO THE BEST OF MY KNOWLEDGE AND BELIEF AND SHOWS ALL THE INFORMATION REQUIRED BY LAW AND THE REGULATIONS ISSUED AND PRESCRIBED BY THE DEPARTMENT OF ENVIRONMENTAL PROTECTION.
Signed: *[Signature]*
L.L.S. #2124: Ernest J. Benchek III



(+) DENOTES LOCATION OF WELL ON UNITED STATES TOPOGRAPHIC MAPS WYDEP
OFFICE OF OIL & GAS
601 57TH STREET
CHARLESTON, WV 25304
Well Type: Oil Waste Diposal Production Deep
 Gas Liquid Injection Storage Shallow
WATERSHED: DUNKARD CREEK
COUNTY/DISTRICT: MONONGALIA / CLAY
SURFACE OWNER: BLAKE R. & PRESTON H. BOGCESS
OIL & GAS ROYALTY OWNER: BLAKE R. & PRESTON H. BOGCESS 'et al'
LEASE NUMBERS:

DATE: September 26, 2018
OPERATOR'S WELL #: BOGCESS NO. 13H
API WELL #: 47 61 47-061-01814
STATE COUNTY PERMIT
PROPOSED ELEVATION: 1,265.4'
QUADRANGLE: OSAGE, WV
ACREAGE: 389.96 +/-
ACREAGE: 1219.86 +/-
DRILL CONVERT DRILL DEEPER REDRILL FRACTURE OR STIMULATE
PLUG OFF FORMATION PERFORATE NEW FORMATION PLUG & ABANDON
CLEAN OUT & REPLUG OTHER CHANGE (SPECIFY):
TARGET FORMATION: MARCELLUS
ESTIMATED DEPTH: TVD: 8,074' TMD: 20,242'
WELL OPERATOR: NORTHEAST NATURAL ENERGY LLC
ADDRESS: 707 VIRGINIA STREET EAST, SUITE 1200
CITY: CHARLESTON STATE: WV ZIP CODE: 25301
DESIGNATED AGENT: JOHN ADAMS
ADDRESS: 707 VIRGINIA STREET EAST, SUITE 1200
CITY: CHARLESTON STATE: WV ZIP CODE: 25301

SURFACE HOLE DEC. LAT: 39° 42' 30"
SURVEYED LAT: 39° 40' 12.7"

BOGGESS 13H EXISTING GAS WELLS September 26, 2018

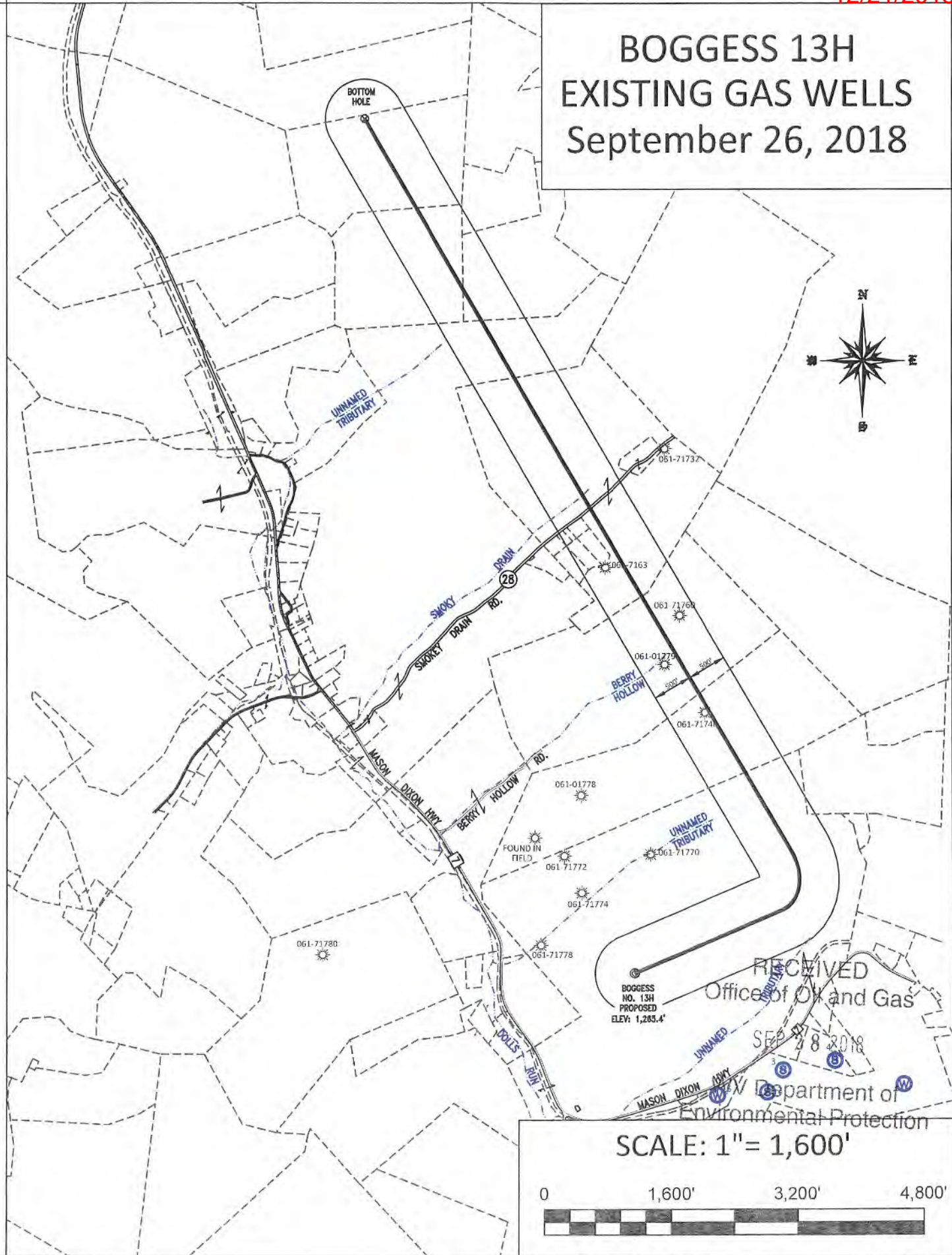

RECEIVED
Office of Oil and Gas
SEP 27 2018
Department of
Environmental Protection

SCALE: 1" = 1,600'

