

WDTN19AHSM
CNX Gas Company LLC

PENNSYLVANIA
GREENE COUNTY
WEST VIRGINIA
MONONGALIA COUNTY

WDTN19AHSM
AS-DRILLED
BOTTOM HOLE

SEE DETAIL A
PAGE 2

AZ 325°02'25"
13,856' ±

N34°26'33"W
2,413'

N87°32'50"W
2,165'

WDTN19AHSM
AS-DRILLED
LANDING POINT

WELL
WDTN19AHSM

LEGEND

- Active Well
- Plugged Well Location
- Abandoned Well
- Future Use
- Surface Tract Identification
- Proposed Gas Well
- Located Corner, as noted
- Permitted Lateral
- As-drilled Lateral
- Surface Tract Lines
- Reference Line
- Lease Boundary
- Creek or Drain
- State Line
- WV County Route
- WV State Route

NOTES ON SURVEY

1. COORDINATES SYSTEM IS UTM, NAD 83 DATUM, ZONE 17. U.S. FOOT AND WELL COORDINATES ESTABLISHED USING SURVEY GRADE GPS.
2. SURFACE AND ROYALTY OWNER INFORMATION AND THEIR BOUNDARIES SHOWN HEREON WERE OBTAINED FROM INFORMATION PROVIDED BY CNX GAS COMPANY LLC AND TAX RECORDS.
3. THIS PLAT DOES NOT REPRESENT A BOUNDARY SURVEY OF THE PARCELS SHOWN HEREON.
4. NO DWELLINGS AND BUILDINGS WITHIN 625 FEET OF PROPOSED CENTER OF PAD.
5. NO WATER WELLS OR DEVELOPED SPRINGS WITHIN 250 FEET OF PROPOSED WELL.
6. NO PERENNIAL STREAMS, LAKES, PONDS, RESERVOIRS OR WETLANDS WITHIN 100 FEET OF THE LIMITS OF DISTURBANCE.
7. NO NATURALLY PRODUCING TROUT STREAM WITHIN 300 FEET LIMITS OF DISTURBANCE.

See Page 3 For Surface Owners and Lessors

() Denotes Location of Well on United States Topographic Maps



I, the undersigned, hereby certify that this plat is correct to the best of my knowledge and belief and shows all the information required by law and the regulations issued and prescribed by the Department of Environmental Protection.

Thomas C. Smit

L. L. S. 687

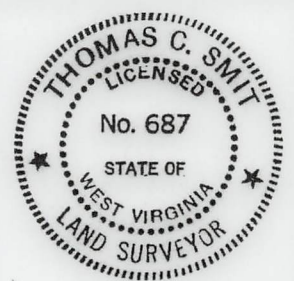

SEAL

FILE NO:
DRAWING NO:
SCALE: 1" = 2000'
MINIMUM DEGREE OF ACCURACY:
1:2500
PROVEN SOURCE OF ELEVATION:
NGS CORS Station



DATE: JUNE 08 20 23
OPERATORS WELL NO:
API WELL NO
47 - 061 - 01899
STATE COUNTY PERMIT

WELL TYPE: OIL GAS LIQUID INJECTION WASTE DISPOSAL
(IF GAS) PRODUCTION: STORAGE DEEP SHALLOW
LOCATION ELEVATION: 1264.30' WATERSHED: Dunkard Creek QUADRANGLE: Wadestown
DISTRICT: Batelle COUNTY: Monongalia
SURFACE OWNER: CNX Gas Company LLC ACREAGE: 96.91 ±
ROYALTY OWNER: Three Rivers Royalty II, LLC, et al LEASE NO: 205228000 ACREAGE: 96.91 ±
PROPOSED WORK: DRILL CONVERT DRILL DEEPER FRACTURE OR STIMULATE PLUG OFF OLD FORMATION
 PERFORATE NEW FORMATION OTHER PHYSICAL CHANGE IN WELL (SPECIFY)
 PLUG AND ABANDON CLEAN OUT AND REPLUG TARGET FORMATION: Marcellus ESTIMATED DEPTH: TVD: 7,913'

WELL OPERATOR: CNX Gas Company LLC DESIGNATED AGENT: Anthony Kendziora
ADDRESS: 1000 Horizon Vue Drive ADDRESS: 1000 Horizon Vue Drive
Canonsburg, PA 15317 Canonsburg, PA 15317

AS-DRILLED

WDTN19AHSM
CNX Gas Company LLC

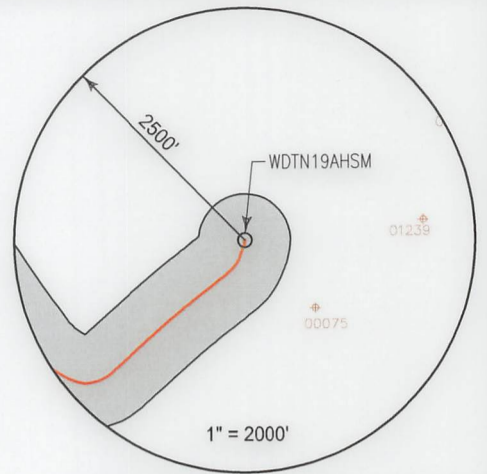
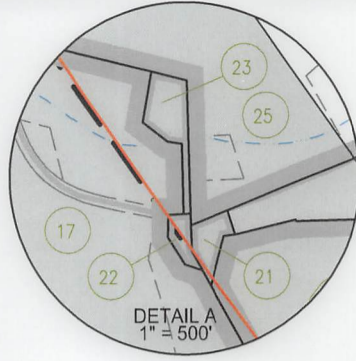

Well References

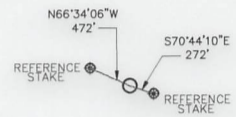

1" = 2000'

WDTN19AHSM

SURFACE HOLE LOCATION (SHL)

UTM 17 NAD 83
N: 4393925.918
E: 556990.604
NAD 83, WV NORTH
N: 435719.4558
E: 1733449.107
LAT/LON DATUM NAD 83
LAT: 39°41'35.795"
LON: 80°20'07.134"
LANDING POINT
UTM 17 NAD 83
N: 4393564.005
E: 556288.708
NAD 83, WV NORTH
N: 434570.369
E: 1731126.089
LAT/LON DATUM NAD 83
LAT: 39°41'24.224"
LON: 80°20'36.713"

WDTN19 WELL PAD

- WDN19EHSM
- WDN19DHSM ○ WDN19BHSM
- WDN19CHSM ○ WDN19FHSM
- WDN19AHSM ○ WDN19RHSM

BOTTOM HOLE LOCATION (BHL)

UTM 17 NAD 83
N: 4396983.257
E: 553812.206
NAD 83, WV NORTH
N: 445926.010
E: 1723187.250
LAT/LON DATUM NAD 83
LAT: 39° 43' 15.702"
LON: 80° 22' 19.679"



I, the undersigned, hereby certify that this plat is correct to the best of my knowledge and belief and shows all the information required by law and the regulations issued and prescribed by the Department of Environmental Protection.

Thomas C. Smit
L. L. S. 687

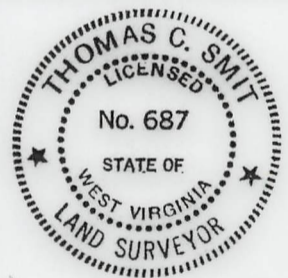

SEAL

FILE NO: _____
DRAWING NO: _____
SCALE: 1" = 1000'
MINIMUM DEGREE OF ACCURACY: 1:2500
PROVEN SOURCE OF ELEVATION: NGS CORS Station



DATE: JUNE 08 20 23
OPERATORS WELL NO: _____
API WELL NO: 47 - 061 - 01899
STATE COUNTY PERMIT

WELL TYPE: OIL GAS LIQUID INJECTION WASTE DISPOSAL
(IF GAS) PRODUCTION: STORAGE DEEP SHALLOW

LOCATION ELEVATION: 1264.30' WATERSHED: Dunkard Creek QUADRANGLE: Wadestown
DISTRICT: Batelle COUNTY: Monongalia

SURFACE OWNER: CNX Gas Company LLC ACREAGE: 99.95/±
ROYALTY OWNER: Three Rivers Royalty II, LLC, et al LEASE NO: 205228000 ACREAGE: 96.91 ±

PROPOSED WORK: DRILL CONVERT DRILL DEEPER FRACTURE OR STIMULATE PLUG OFF OLD FORMATION
 PERFORATE NEW FORMATION OTHER PHYSICAL CHANGE IN WELL (SPECIFY)
 PLUG AND ABANDON CLEAN OUT AND REPLUG TARGET FORMATION: Marcellus ESTIMATED DEPTH: TVD: 7,913'

WELL OPERATOR: CNX Gas Company LLC DESIGNATED AGENT: Anthony Kendziora
ADDRESS: 1000 Horizon Vue Drive ADDRESS: 1000 Horizon Vue Drive
Canonsburg, PA 15317 Canonsburg, PA 15317

AS-DRILLED