

SURFACE HOLE DEC. LONG: 80.223288
 SURVEYED LONG: 80°13'23.8"

4,210'

Latitude: 39° 37' 30" (NAD27)

Longitude: 80° 12' 30" (NAD27)

SURFACE HOLE DEC. LAT: 39.624743
 SURVEYED LAT: 39°37'30"

TOP HOLE (UTM NAD 83)
 N) 4385296.1
 E) 566688.6
 BOTTOM HOLE (UTM NAD 83)
 N) 4385303.9
 E) 568575.6

API # & DISTANCE TO WELL
 061-00452 - N 22°07'10" E 1119'
 061-00453 - N 11°16'29" W 1102'

W1
 N 26°53'27" W 1424'
 W2
 N 19°47'32" W 1406'
 W3
 N 58°02'18" W 1449'

BOTTOM HOLE
 3,702' SOUTH
 OF LATITUDE
 39°37'30"
 4,583' WEST
 OF LONGITUDE
 80°12'30"

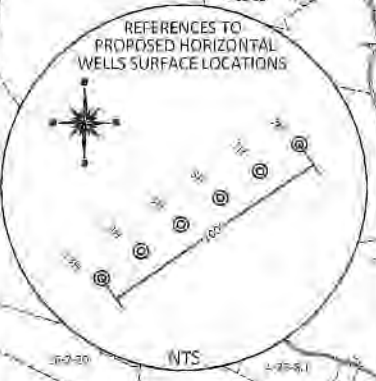

REFERENCE NOTE
 Boundaries as shown taken from deeds, tax maps and field locations. A full boundary survey is not expressed nor implied. All bearings are based on true north. Ownership taken from public records MONONGALIA County, West Virginia NOVEMBER 2019
 State Plane Coordinates & NAD 83 Lat/Long by differential submeter mapping grade GPS Drafted by EAM

MONONGALIA COUNTY
 MARION COUNTY

SULLIVAN 3H
 N 33°37'36" W A2326°22'24"
 TOTAL DISTANCE BORED
 FROM LP TO BH = 329'

FILE #: NNE20
 DRAWING #: 3073
 SCALE: PLAT: 1" = 2000'
 TCM: 1" = 2000'
 MINIMUM DEGREE OF ACCURACY: 1/200
 PROVEN SOURCE OF ELEVATION: SUBMETER MAPPING GRADE GPS

I, THE UNDERSIGNED, HEREBY CERTIFY THAT THIS PLAT IS CORRECT TO THE BEST OF MY KNOWLEDGE AND BELIEF AND SHOWS ALL THE INFORMATION REQUIRED BY LAW AND THE REGULATIONS ISSUED AND PRESCRIBED BY THE DEPARTMENT OF ENVIRONMENTAL PROTECTION.
 Signed: *[Signature]*
 L.L.S. #2124 : Ernest J. Benchek III



(+) DENOTES LOCATION OF WELL ON UNITED STATES TOPOGRAPHIC MAPS WVDEP
 OFFICE OF OIL & GAS
 601 57TH STREET
 CHARLESTON, WY 25304

DATE: JUNE 8, 2022
 OPERATOR'S WELL #: SULLIVAN 3H
 API WELL #: 47 61 01901

WELL NAME: SULLIVAN 3H GRANT TOWN, WV



SULLIVAN 3H
 N 31° 37' 36" W AZ326' 22" 24"
 TOTAL DISTANCE BORED
 FROM LP TO BH = 329'



MONONGALIA CO
 MARION CO

MONONGALIA COUNTY CO
 MARION COUNTY CO