

LATITUDE 39° 45' 00"

80° 01' 30"

LONGITUDE

7.5'



7.5 OGIS topo location

7.5' loc 2.33S
1.50W

15' loc 2.33S
(calc.) 3.72W

Company _____

Farm _____

Quad Blacksville

County Monongahela

District Clay

WELL LOCATION MAP

File No. 061-557A

Entered in Clay District, Mower County.

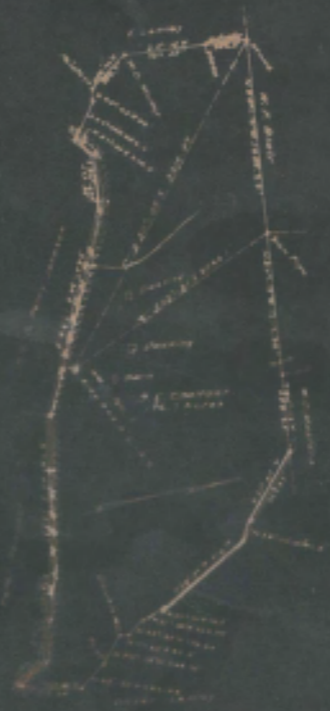

Engineer's Certificate.

I, the undersigned, hereby certify that this map is a true and correct copy of the original as the same is on file in my office, and that I am a duly licensed and qualified Surveyor of the State of Iowa.

H. S. [Signature]
Surveyor

Witness my hand and the seal of my office, this 10th day of [Month] 188[Year].

Clay District, Monongalia County, W. Va.

By J. H. McDermott Oil Co.; succeeded by Consolidation Oil & Gas Co.

On north side of Dunkard Creek, 0.8 mi. N. W. of Worley.

Completed, February 24, 1920.

Elevation, 936' L.

Conductor, 31'; 10" casing, 551'; 8 1/2", 1206'; 6-5/8", 1716';
5-3/16", 2628'.Gas test, 56/10 W. in 2", 355,000 cu. ft.; rock pressure for 2 hrs.,
650 lbs.

MON-55-A

	Top.	Bottom.
Coal, Pittsburgh	522	
Gas Sand (gas, 1235'; 769,500 cu. ft.)	1198	1247
DRILLED DEEPER JULY 31, 1922:		
Sand, First Salt	1252	1320
Sand	1363	1460
Sand, Second Salt	1461	1565
Little Lime	1682	1704
Pencil Cave	1704	1710
Big Lime	1710	1790
Sand, Big Injun (little oil, 1922'; water, 1928', 1 bailer per hour)	1790	2018
Sand, Squaw	2083	2128
Sand, Berea	2323	2345
Sand, Fifty-foot	2420	2550
Sand, Thirty-foot	2550	2580
Sand, Gordon Stray	2592	2650
Sand, Gordon	2675	2690
Sand, Fourth	2732	2738
Sand, Fifth (gas, 2847'; 56/10 water in 2"; 355,000 cu. ft.)	2830	2852
Sand	2868	2882
Sand (little gas, 2906')	2902	2924
Sand, good	2928	2935
Sand, broken	2935	2943
Sand, white and brown	2950	2964
Slate	2964	2967
Hard shell, Bayard Sand (oil show, 2969')	2967	2969
Slate and shale, to bottom	2969	3220

WEST VIRGINIA DEPARTMENT OF MINES
Oil and Gas Section
PRELIMINARY DATA SHEET NO. 1

File No. _____ Well No. 1

Consolidation Oil & Gas Company of 204 Monongahela Building

Hungertown, W. Va. on the S. E. Chalfant Form

containing 200 acres. Location _____

Clay District in Monongalia County, West Virginia.

The surface of the above tract is owned in fee by S. E. Chalfant

of Blacksville, W. Va. address, and the mineral rights are owned by

and S. E. Chalfant and H. G. Phillips of Pittsburgh, Pa.

The oil and gas privileges are held under lease by the above named company, and this well is drilled under

before permits issued _____

permits issued by the West Virginia Department of Mines, Oil and Gas to _____

_____ 10 _____

_____ 940.8 feet _____ Spill

_____ Horizontal _____

The number of feet of the different sized casings used in the well _____

_____ ft. _____ in. _____ Weight _____ conductor _____

75 _____ ft. 10 in. _____ in. _____ sp. _____ 201 _____ ft. 10 in. _____ steel _____ sp. _____

1000 _____ ft. _____ in. _____ sp. _____ 1720 _____ ft. 8 5/8 _____ steel _____ sp. _____

2000 _____ ft. 8 5/8 _____ in. _____ sp. _____ _____ ft. _____ steel _____ sp. _____

2200 _____ gauge _____ of _____ in. _____ at _____ ft. _____

_____ gauge _____ of _____ in. _____ at _____ ft. _____

2200 _____ is casing _____ perforated _____ at _____ ft. _____ to _____ ft. _____

_____ is casing _____ perforated _____ at _____ ft. _____ to _____ ft. _____

Cool was encountered at _____ ft. _____ thickness _____ ft. _____ inches _____ and _____ at _____ ft. _____ thickness _____ ft. _____ inches _____ and _____ at _____ ft. _____ thickness _____ ft. _____ inches _____

_____ These were used as follows: (Give details) _____ 2000 _____

_____ December 20, 1928 _____

_____ Consolidation Oil & Gas Co. _____

_____ Pittsburgh _____

_____ Superintendent _____

_____ 1928 _____



- Consolidation Oil & Gas Company
 222 Kensington Bldg.
 Washington, D. C.
 and No. 1, A. E. Chalfant Farm

COMPLETION DATA SHEET
No. 2
FORMATION RECORD

Zone	Color	Character	Oil, Gas or Water	Top	Bottom	Thickness	Total Depth	Remarks
Wagoning Coal	Black	Soft	none	388	560	5	360	
Wagoning	"	"	"	440	445	5		
Wagoning	"	Soft	Water	521	530	9		
Wagoning	"	"	"	598	1088	30		
Wagoning	white	Hard	none	1128	1247	49		
Wagoning	"	"	gas	1288	1380	68		
Wagoning	"	"	none	1588	1680	97		
Wagoning	gray	"	"	1588	1680	104		
Wagoning	"	"	water	1681	1848	88		
Wagoning	"	"	none	1888	1704	88		
Wagoning	"	Hard	none	1704	1710	6		
Wagoning	dark	soft	"	1710	1790	80		
Wagoning	gray	hard	oil	1790	2018	288		
Wagoning	"	hard	"	2028	2128	48		
Wagoning	"	hard	none	2228	2248	28		
Wagoning	white	Hard	"	2428	2528	120		
Wagoning	"	"	none	2528	2528	50		
Wagoning	gray	"	none	2528	2728	88		
Wagoning	"	"	none	2828	2940	28		
Wagoning	"	"	none	2978	2978	18		
Wagoning	"	"	none	2978	2978	8		
Wagoning	white	"	none	2978	2978	88		
Wagoning	"	soft	gas	2978	2978	84		
Wagoning	"	hard	none	2978	2978	88		
Wagoning	"	"	gas	2978	2978	7		
Wagoning	"	"	none	2978	2978	14		
Wagoning	"	broken	none	2978	2978	8		
Wagoning	"	hard	oil	2978	2978			
Wagoning	"	"	"					
Total depth							3680	

Date of completion of well _____
 Name of well _____
 Name of operator _____
 Name of engineer _____
 Name of geologist _____
 Name of geophysicist _____
 Name of geologist-in-charge _____
 Name of geophysicist-in-charge _____
 Name of geologist-in-charge _____
 Name of geophysicist-in-charge _____

Consolidation Oil & Gas Co.
D. E. Chalfant
Geologist-in-charge

This report was prepared by the geologist and geophysicist named above and is based on the data furnished to them by the operator of the well. It is not intended to be a warranty of the accuracy of the data or the results therefrom.

**AFFIDAVIT IN TRIPPLICATE TO TIME AND MANNER OF
PLUGGING AND FILLING WELL**

(PREPARED BY GEORGE H. JENNINGS & COMPANY 25 OF THE SQUARE)

**WEST VIRGINIA DEPARTMENT OF MINES
OIL AND GAS DIVISION**

<u>Henry A. Phillips</u> <small>NAME OPERATOR OR OWNER</small>	<u>Consolidation Oil & Gas Co.</u> <small>NAME OF WELL OPERATOR</small>
<u>Pittsburgh, Pa.</u> <small>CITY</small>	<u>224 Monongahela Bldg.</u> <u>Morgantown, W. Va.</u> <small>COMPLETE ADDRESS</small>
<u>S. E. Chalfant</u> <small>NAME OPERATOR OR OWNER</small>	<u>November 18</u> 19 <u>22</u> <small>WELL AND LOCATION</small>
<u>Blacksville, W. Va.</u> <small>CITY</small>	<u>Clay</u> <u>State</u>
<u></u> <small>NAME OPERATOR OR OWNER</small>	<u>Monongalia</u> <u>County</u>
<u></u> <small>CITY</small>	<u>Well No. 1, S. E. Chalfant farm</u>
<u></u> <small>CITY</small>	<u>178.7 acres</u> <u>Form</u>

AFFIDAVIT TO BE MADE BY OPERATOR, AND MAY BE SO MADE BY OPERATOR ONLY, OR BY OPERATOR AND ONE ASSISTANT OF THE OPERATOR, AND MAY BE SO MADE BY OPERATOR AND ONE ASSISTANT OF THE OPERATOR AND ONE ASSISTANT OF THE OPERATOR AND ONE ASSISTANT OF THE OPERATOR.

AFFIDAVIT

STATE OF WEST VIRGINIA,
County of Monongalia } ss:

Arno R. Fox and Charles E. Fox

being first duly sworn according to law do depose and say that they are experienced in the work of plugging

and filling of oil and gas wells and were employed by Consolidation Oil & Gas Co. of said county, and participated in the work of plugging and filling the above well, that said work was commenced on the

21st day of May, 1922, and that the well was plugged and filled in the following manner:

Manner in which said well was plugged: Total depth of well 3220 feet;
Fifth sand 2820 to 2838; filled with mud from 2820 to 2810;
bridged at 2800;
Fourth sand 2728 to 2738; filled with clay from 2760 to 2680;
Gordon sand 2578 to 2690; lead plug driven at 2680; filled with
clay from 2580 to 1940; wood plug driven at 1940; (four ft. plug);
filled with clay 1888 to 1728; wood plug driven at 1728 to 1728;
Big Injun sand 1720 to 2018; filled with clay from 1728 to 890;
6 1/8 in. casing 1716 feet to top of well, left in, impossible to

pull;
Pittsburgh sand 221 to 220; cement plug from 200 to 200; 2 inch
vent pipe from 200 to 200; filled with clay from 200 to 478;
Maplewood sand 428 to 448; cement plug from 478 to 420; filled
with clay from 428 to 390;
Waynesburg sand 328 to 320; cement plug 300 to 320; filled with
clay from 328 to surface.
24 in by 24 cement block at surface, with 2 inch vent pipe extending
above surface.

AND WHEREAS THE OPERATOR HAS BEEN ADVISED BY THE OPERATOR OF SAID WELL IN ACCORDANCE WITH THE PROVISIONS OF SECTION 10, ARTICLE 4, CHAPTER 25 OF THE CODES

and that the work of plugging and filling said well was completed on the 21st day of May,

1922.

And further depose and say that

Arno R. Fox
Charles E. Fox

Sworn to and subscribed before me this 18th day of November, 1922.

Geo. H. Jenkins