

Latitude 39° 40'

Longitude 80° 15'

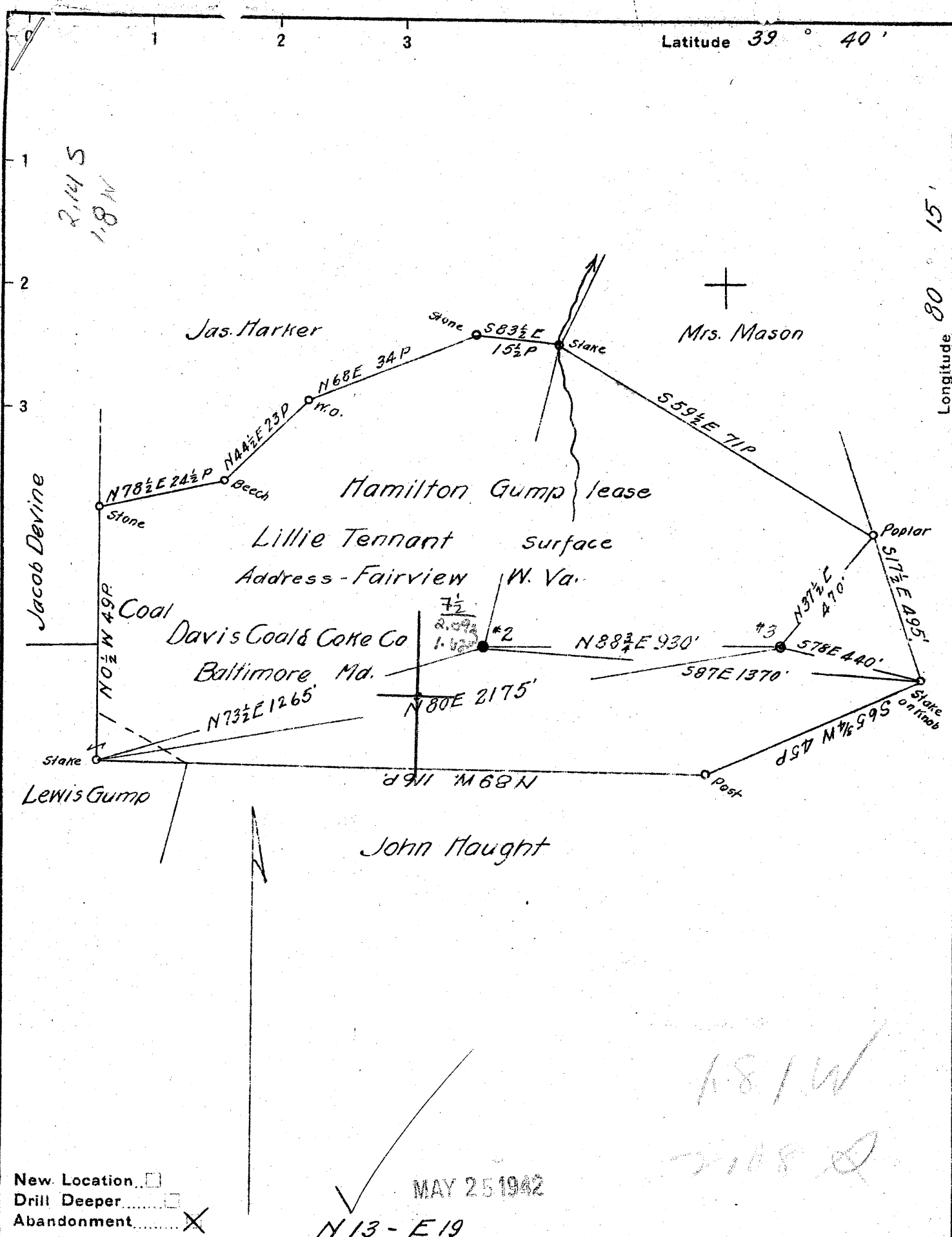

New Location   
 Drill Deeper   
 Abandonment

✓ MAY 25 1942  
 N 13 - E 19

1.8 / W  
 2108

Company South Penn Natural Gas Co.  
 Address Parkersburg W. Va.  
 Farm Hamilton Gump  
 Tract \_\_\_\_\_ Acres 65 Lease No. 12912  
 Well (Farm) No. 2 Serial No. \_\_\_\_\_  
 Elevation (Spirit Level) 1377.02 Ground  
 Quadrangle Mannington  
 County Monongalia District Battelle  
 Engineer Emmon Haines  
 Engineer's Registration No. \_\_\_\_\_  
 File No. \_\_\_\_\_ Drawing No. \_\_\_\_\_  
 Date 3-12-42 Scale 1"=400'

STATE OF WEST VIRGINIA  
 DEPARTMENT OF MINES  
 OIL AND GAS DIVISION  
 CHARLESTON

**WELL LOCATION MAP**  
 FILE NO. MON-272-A

+ Denotes location of well on United States Topographic Maps, scale 1 to 62,500, latitude and longitude lines being represented by border lines as shown.

- Denotes one inch spaces on border line of original tracing.

Battelle District,  
Monongalia County, W. Va.

Flat Run pool.

South Penn Oil Co.

	Top.	Bottom.
Big Injun Sand (oil and gas, 2435')	2340	- 2545
30-Ft. Sand	2900	- 2925
50-Ft. Sand	2985	- 3040
Stray Sand	3270	- 3285
Gordon Sand (1st pay, 3298'; 2nd, 3306')	3289	
Depth		3315

.....District, Monongalia County, W. Va.  
By South Penn Oil Co.  
On Flat Run.

	Top.	Bottom.
Big Injun Sand (oil and gas, 2835')	2380	- 2545
30-Ft. Sand	2900	- 2925
50-Ft. Sand	2985	- 3040
Stray Sand.	3270	- 3285
Gordon Sand (1st pay, 3208'; 2nd pay, 3306')	3289	
Total depth		3315

STATE OF WEST VIRGINIA  
DEPARTMENT OF MINES  
OIL AND GAS DIVISION

376

WELL RECORD

Permit No. 272-A

Oil or Gas Well OIL  
(KIND)

Company South Penn Natural Gas Company,  
Address Union Trust Bldg. Parkersburg, W. Va.  
Farm Hamilton Camp Acres 65  
Location (waters) Miracle Run  
Well No. 2 Elev. 1377.02  
District Battelle County Monongalia  
The surface of tract is owned in fee by Lillie Tennant  
Address Fairview, W. Va.  
Mineral rights are owned by C.S. McElroy et al  
Address Fairview, W. Va.  
Drilling commenced Jan. 19, 1898  
Drilling completed May 17, 1898  
Date Shot See below xxx xxx  
With -----  
Open Flow /10ths Water in ----- Inch  
/10ths Merc. in ----- Inch  
Volume ----- Cu. Ft.  
Rock Pressure ----- lbs ----- hrs.  
Oil 45 bbls., 1st 24 hrs.  
Fresh water ----- feet ----- feet  
Salt water ----- feet ----- feet

Casing and Tubing	Used in Drilling	Left in Well	Packers
Size			
16			Kind of Packer -
13			-
10	355'		Size of -
8 3/4	1495'		-
6 5/8	2080'		Depth set -
5 3/16	2485'		-
3			Perf. top -
2			Perf. bottom -
Liners Used	305		Perf. top -
			Perf. bottom -

CASING CEMENTED - SIZE - No. Ft. - Date  
EST. 1060 FEET 84 INCHES  
COAL WAS ENCOUNTERED AT 1060 FEET 84 INCHES  
- FEET - INCHES - FEET - INCHES  
- FEET - INCHES - FEET - INCHES

Formation	Color	Hard or Soft	Top	Bottom	Oil, Gas or Water	Depth Found	Remarks
Pittsburgh Coal		(Est.)	1060	1067			
Big Injun			2340	2545			
30 Ft. Sand			2900	2925	Oil & Gas	2435	
50 Ft. Sand			2985	3040			
Stray Sand			3270	3285			
Gordon Sand			3289				
					1st Pay	3298	
					2nd Pay	3306	
Total Depth				3315 1/2			
DRILLED DEEPER: Commenced March 20, 1905 - Completed April 8, 1905.							
Completed in Gordon				3306			
1st Oil 4th Sand,			3332				
Total Depth				3350			

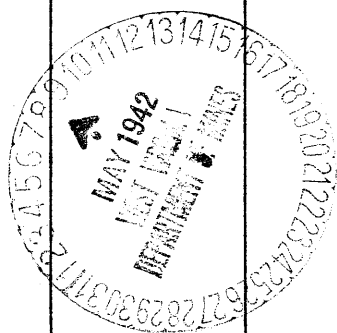

Formation	Color	Hard or Soft	Top	Bottom	Oil, Gas or Water	Depth Found	Remarks

Date May 7, 1942

APPROVED SOUTH PENN NATURAL GAS COMPANY, Owner

By *Elton Elsbury* Land Agent  
(Title)