

Latitude

Longitude

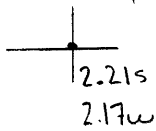

Topo Location

7.5' Loc. _____ 15' Loc. _____
 _____ (calc.) _____

Company Carnegie Nat Gas

Farm Phillip Shuman #3

15' Quad _____
(sec.)

7.5' Quad Blacksville

District Battello

WELL LOCATION PLAT

County 061 Permit 30343

0 1 2 3 Latitude 39 45
 -1
 -2
 -3
 Longitude 30 10

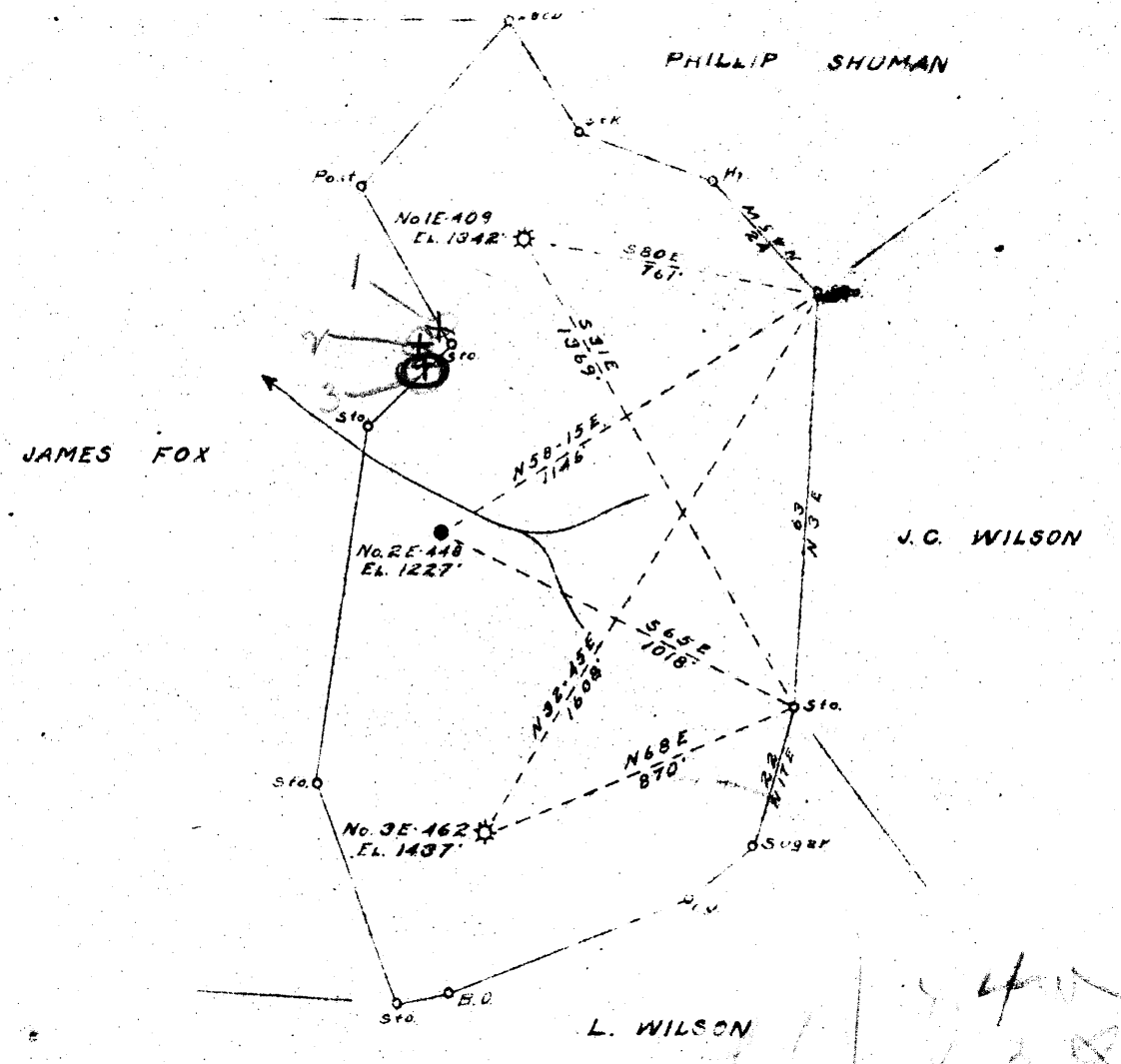

4.43S
 4.41W (13)

NOV 10 1947

New Location
 Drill Deeper
 Abandonment

Company CARNEGIE NATURAL GAS
 Address PITTSBURGH, PA.
 Farm PHILLIP SHUMAN
 Tract _____ Acres 52 Lease No. E. 5891-54
 Well (Farm) No. 3 Serial No. E. 462
 Elevation (Spirit Level) 1437'
 Quadrangle BLACKSVILLE N.W.
 County MONONGALIA District BATTELLE
 Engineer R.L. SWEENEY
 Engineer's Registration No. _____
 File No. _____ Drawing No. _____
 Date 10-29-47 Scale 1" = 30 Feet = 495'

STATE OF WEST VIRGINIA
 DEPARTMENT OF MINES
 OIL AND GAS DIVISION
 CHARLESTON

WELL LOCATION MAP
 FILE NO. MON-343-A

+ Denotes location of well on United States Topographic Maps, scale 1 to 62,500, latitude and longitude lines being represented by border lines as shown.
 - Denotes one inch spaces on border line of original tracing.

PHILLIP SHUMAN No. 2 (E-462) - CARNEGIE NAT. GAS CO. - MON-343-A



400

STATE OF WEST VIRGINIA
DEPARTMENT OF MINES
OIL AND GAS DIVISION

WELL RECORD

Permit No. AD 343 A

Oil or Gas Well GAS
(KIND)

Company CARNEGIE NATURAL GAS COMPANY
Address 1015 Frick Bldg., PITTSBURGH, PA.
Farm PHILLIP SHUMAN Acres 52
Location (waters) _____
Well No. 3-462 Elev. 1437
District BATTLE County MONONGALIA
The surface of tract is owned in fee by PHILLIP SHUMAN ESTATE,
ALBERT SHUMAN, Atty.-in-Fact. Address MORGANTOWN, W. VA.
Mineral rights are owned by PHILLIP SHUMAN ESTATE,
ALBERT SHUMAN, Atty.-in-Fact. Address MORGANTOWN, W. VA.
Drilling commenced 5-6-14 D.D. 5-25-26
Drilling completed 8-4-14 D.D. 9-30-26
Date Shot 8-19-19 From 2466 To 2476
With 15 qts. 2471 2481

Casing and Tubing	Used in Drilling	Left in Well	Packers
Size			
16			Kind of Packer
18			Anchor
10		1015'	Size of 5-3/16"x2"
8 1/4	1868	None	
6 1/2	2135	2135'	Depth set 3330
5 3/16	2335	2335'	
3			Perf. top
2			Perf. bottom
Liners Used			Perf. top
			Perf. bottom

Open Flow /10ths Water in _____ Inch
/10ths Merc. in _____ Inch
Volume 184,000 Cu. Ft.
Rock Pressure _____ lbs. _____ hrs.
Oil _____ bbls., 1st 24 hrs.
Fresh water 2010 feet 2075-2080 feet
Salt water _____ feet _____ feet

CASING CEMENTED _____ SIZE _____ No. Ft. _____ Dat _____
COAL WAS ENCOUNTERED AT 994 FEET _____ INCHES
1094 FEET _____ INCHES FEET _____ INCHES
_____ FEET _____ INCHES FEET _____ INCHES

Formation	Color	Hard or Soft	Top	Bottom	Oil, Gas or Water	Depth Found	Remarks
Mapleton Coal			994	999			
Pittsburgh Coal			1094	1100			
Little Dunkard			1440	1480			
Big Dunkard			1600	1655			
Gas Sand			1859	1886			
1st Salt Sand			1891	1933			
2nd Salt Sand			1980	2115	Water	2010	
Maxton Sand			2240	2250	Water	2075-2080	
Little Line			2304	2312			
Pencil Cave			2312	2320			
Big Line			2320	2365	Gas	2398	
Big Injun			2365		Oil	2466	
TOTAL DEPTH 8-4-14				2498			
Big Injun				2571			
50-Foot Sand			2966	2980	Oil	2480	
30-Foot Sand			3000	3070			
Gordon Stray			3273	3300			
Gordon Sand			3308	3338	Gas	3361	
4th Sand			3357	3377			
Sand			3412	3423	Gas	3417	
5th Sand			3512	3520	Gas	3513	
Bayard Sand			3535	3543			
TOTAL DEPTH 9-30-26				3594			

Formation	Color	Hard or Soft	Top	Bottom	Oil, Gas or Water	Depth Found	Remarks

Date **NOVEMBER 3**, 194**7**

APPROVED: **CARNEGIE NATURAL GAS COMPANY**, Owner

By *[Signature]*
 General Superintendent.