

**Latitude**

**Longitude**

2.30s  
1.24w

**Topo Location**

7.5' Loc. \_\_\_\_\_ 15' Loc. \_\_\_\_\_  
 \_\_\_\_\_ (calc.) \_\_\_\_\_

**Company** South Penn

**Farm** Pratt Tennant #5

**15' Quad** \_\_\_\_\_  
(sec.)

**7.5' Quad** Blacksville

**District** Clay

**WELL LOCATION PLAT**

**County** 061 **Permit** 30566

Latitude 39° 40'

Longitude 80° 10'

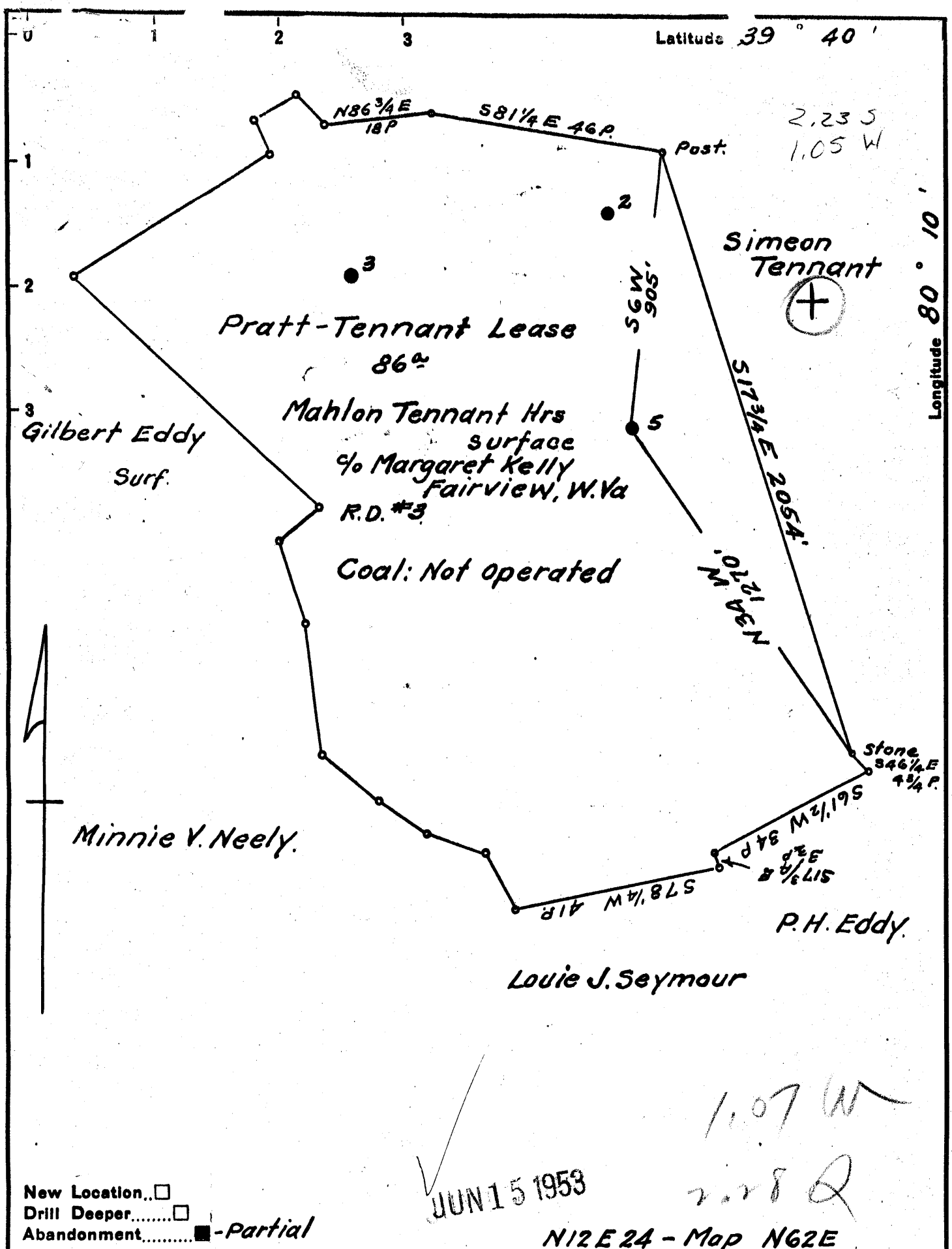

2,235  
1.05 W

Simeon Tennant

Pratt-Tennant Lease  
86<sup>ac</sup>

Mahlon Tennant Hrs  
surface  
c/o Margaret Kelly  
Fairview, W. Va  
R.D. #3

Coal: Not operated

Gilbert Eddy  
Surf.

Minnie V. Neely.

Stone  
S46 1/4 E  
4 3/4 P.

P.H. Eddy

Louie J. Seymour

JUN 15 1953

1.07 W  
2.235 Q

N12 E 24 - Map N62 E

New Location...   
Drill Deeper...   
Abandonment...  - Partial

Company South Penn Natural Gas Co.  
 Address Parkersburg, W. Va.  
 Farm Pratt - Tennant  
 Tract \_\_\_\_\_ Acres 86 Lease No. 12899  
 Well (Farm) No. 5 Serial No. \_\_\_\_\_  
 Elevation (Spirit Level) 1121.66  
 Quadrangle Blacksville  
 County Monongalia District Clay  
 Engineer Wm S. Hayes  
 Engineer's Registration No. 1429  
 File No. \_\_\_\_\_ Drawing No. \_\_\_\_\_  
 Date 5-20-53 Scale 1" = 400'

STATE OF WEST VIRGINIA  
DEPARTMENT OF MINES  
OIL AND GAS DIVISION  
CHARLESTON

WELL LOCATION MAP  
FILE NO. MON-566-A

+ Denotes location of well on United States Topographic Maps, scale 1 to 62,500, latitude and longitude lines being represented by border lines as shown.

- Denotes one inch spaces on border line of original tracing.

STATE OF WEST VIRGINIA  
DEPARTMENT OF MINES  
OIL AND GAS DIVISION

618

## WELL RECORD

Permit No. J 66-A

Oil or Gas Well Gas  
(KIND)

Company South Penn Natural Gas Company  
 Address Union Trust Building, Parkersburg, W. Va.  
 Farm Pratt-Tennant Acres 86  
 Location (waters) \_\_\_\_\_  
 Well No. 5 Elev. 1121.66  
 District Clay County Monongalia  
 The surface of tract is owned in fee by Mahlon Tennant Heirs  
c/o Margaret Kelly Address RD#3, Fairview, W. Va.  
 Mineral rights are owned by Kinsey Tennant  
Mt. Morris Star Route Address Waynesburg, Penna.  
 Drilling commenced October 1, 1926  
 Drilling completed November 9, 1926  
 Date shot See end of report Depth of shot \_\_\_\_\_  
 Open Flow /10ths Water in \_\_\_\_\_ Inch  
 /10ths Merc. in \_\_\_\_\_ Inch  
 Volume \_\_\_\_\_ Cu. Ft.  
 Rock Pressure \_\_\_\_\_ lbs. \_\_\_\_\_ hrs.  
 Oil \_\_\_\_\_ bbls., 1st 24 hrs.  
 Fresh water \_\_\_\_\_ feet \_\_\_\_\_ feet  
 Salt water \_\_\_\_\_ feet \_\_\_\_\_ feet

Casing and Tubing	Used in Drilling	Left in Well	Packers
Size			
16			Kind of Packer
13			<b>Anchor</b>
10			Size of
8 1/4		829'	6-5/8" X 8 1/2" x 10"
6 3/8		1595' 6"	Depth set
5 3/16		2454' 9"	1595'
4 1/2" x 4"		320' 6"	Perf. top
2			Perf. bottom
Liners Used			Perf. top
			Perf. bottom

CASING CEMENTED \_\_\_\_\_ SIZE \_\_\_\_\_ No. Ft. \_\_\_\_\_ Date \_\_\_\_\_

COAL WAS ENCOUNTERED AT 559 FEET \_\_\_\_\_ INCHES  
 \_\_\_\_\_ FEET \_\_\_\_\_ INCHES  
 \_\_\_\_\_ FEET \_\_\_\_\_ INCHES

Formation	Color	Hard or Soft	Top	Bottom	Oil, Gas or Water	Depth Found	Remarks
<b>Conductor</b>			16				
<b>Pittsburgh Coal</b>			559				
<b>Big Injun Sand</b>			1849				
					Oil Pay	1949	
					Oil Pay	1957	
<b>Total Depth</b>			1977				
<b>Started to Drill Deeper</b>							
				1977			
<b>Big Injun Sand</b>			1849	2025			
<b>Gantz Sand</b>			2343	2348			
<b>50 Foot Sand</b>			2428	2460			
<b>30 Foot Sand</b>			2478	2542			
<b>Gordon Sand</b>			2759	2775			
<b>Fourth Sand</b>			2811	2838			
<b>Fifth Sand</b>			2948	2968			
						~ 15' net	
					Gas 2/10 W-1"	2949	
					Gas 6/10 W-2"	2956-2957	
						~ 103' net	
<b>Bayard Sand</b>			2992	2994			
<b>Total Depth</b>				3050			
<b>Date</b>	<b>No. Qts.</b>	<b>Torpedo Record</b>		<b>Bottom</b>			
11-17-26	30 qts.	<b>Size Shell</b>	<b>Top Shot</b>	1967			
11-13-22	10 "	4" x 11"	1956	1967			
11-25-22	20 "	3" x 8"	2949	2957			
		3" x 8"	2950	2958			

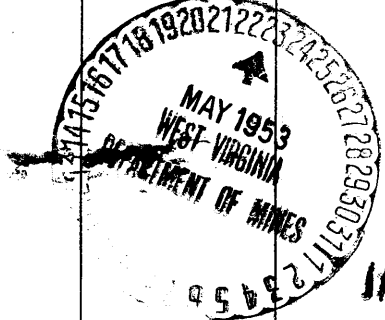

Formation	Color	Hard or Soft	Top	Bottom	Oil, Gas or Water	Depth Found	Remarks

Date..... **May 22nd.** ....., 19**53**.

APPROVED..... **South Penn Natural Gas Company** ....., Owner

By..... *George W. Nilman* .....,  
**George W. Nilman** (Title) **Land Agent**