



STATE OF WEST VIRGINIA

DEPARTMENT OF MINES

Oil and Gas Division

RECEIVED

MAY 8 1975

OIL & GAS DIVISION
DEPT. OF MINES

OIL AND GAS WELL PERMIT APPLICATION

TO THE DEPARTMENT OF MINES,
Charleston, W. Va.

Surface Owner T.W. Broughman
 Address Belva, West Virginia
 Mineral Owner Same as above.
 Address _____
 Coal Owner Same as above.
 Address _____
 Coal Operator Not operated.
 Address _____

DATE May 6, 1975
 Company Appalachian Exploration & Development, Inc.
 Address Box 628, Charleston, W.Va. 25322
 Farm T.W. Broughman Acres 1.34
 Location (waters) Twenty Mile
 Well No. 1 Elevation 813'
 District Jefferson County Nicholas
 Quadrangle Clay

THIS PERMIT MUST BE POSTED AT THE WELL SITE

All provisions being in accordance with Chapter 22, of the W. Va. Code, the location is hereby approved for Drilling. This permit shall expire if operations have not commenced by 9-8-75.

Robert H. [Signature]
Deputy Director - Oil & Gas Division

INSPECTOR TO BE NOTIFIED Paul Thomas
 PH: 472-6418 ADDRESS Buckhannon, W.Va.

GENTLEMEN:

The undersigned well operator is entitled to drill upon the above named farm or tract of land for oil and gas, having fee title thereto, (or as the case may be) under grant or lease dated April 11 19 74 by Thelma W. Broughman made to Appalachian Exploration & Development, Inc. and recorded on the 8th day of May 19 74, in Nicholas County, Book 42 Page 341.

NEW WELL DRILL DEEPER REDRILL FRACTURE OR STIMULATE
 OIL AND GAS WELL ORIGINALLY DRILLED BEFORE JUNE 5, 1969.

The enclosed plat was prepared by a registered engineer or licensed land surveyor and all coal owners and/or operators have been notified as of the above date.

The above named coal owners and/or operator are hereby notified that any objection they wish to make, or are required to make by Section 3 of the Code, must be received by, or filed with the Department of Mines within ten (10) days. *

Copies of this notice and the enclosed plat were mailed by registered mail, or delivered to the above named coal operators or coal owners at their above shown respective address _____ day _____ before, or on the same day with the mailing or delivery of this copy to the Department of Mines at Charleston, West Virginia.

PLEASE SUBMIT COPIES OF ALL
GEOPHYSICAL LOGS DIRECTLY TO:

West Virginia Geological and Economic Survey
 P. O. Box 879
 Morgantown, W. Va. 26505
 AC 304-296-4461

Address of Well Operator

Very truly yours,
Appalachian Exploration & Development, Inc.
 (Sign Name) [Signature] Well Operator

Box 628 Street
Charleston City or Town
West Virginia 25322 State

11/17/2023

*SECTION 3 If no objections are filed or found by the Department of mines, within said period of ten days from the receipt of notice and plat by the department of mines, to said proposed location, the department shall forthwith issue to the well operator a permit reciting the filing of such plat, that no objections have been made by the coal operators or found thereto by the department and that the same is approved and the well operator authorized to proceed.

BLANKET BOND

Nic-349 PERMIT NUMBER
47-067

**THIS IS AN ESTIMATE ONLY
ACTUAL INFORMATION WILL BE SUBMITTED ON OG-10 UPON COMPLETION**

PROPOSED WORK ORDER TO X DRILL _____ DEEPEN _____ FRACTURE-STIMULATE _____
 DRILLING CONTRACTOR: (If Known) _____ RESPONSIBLE AGENT: _____
 NAME F W A Drilling Company, Inc. NAME J.B. McPeters
 ADDRESS 320 O & G Bldg., Wichita Falls, Tx. 76301 ADDRESS Box 628, Charleston, W.Va. 25322
 TELEPHONE -- TELEPHONE 344-8355
 ESTIMATED DEPTH OF COMPLETED WELL: 1910' ROTARY X CABLE TOOLS _____
 PROPOSED GEOLOGICAL FORMATION: Injun
 TYPE OF WELL: OIL _____ GAS X COMB. _____ STORAGE _____ DISPOSAL _____
 RECYCLING _____ WATER FLOOD _____ OTHER _____

TENTATIVE CASING PROGRAM:

CASING AND TUBING SIZE	USED FOR DRILLING	LEFT IN WELL	CEMENT FILL UP OR SACKS - CUBIC FT.
20 - 16			
13 - 10			
9 - 5/8			
8 - 5/8	150'	150'	100 sks.
7			
5 1/2			
4 1/2	1910'	1910'	40 sks.
3			Perf. Top
2			Perf. Bottom
Liners			Perf. Top
			Perf. Bottom

APPROXIMATE FRESH WATER DEPTHS 40 FEET SALT WATER 910 FEET
 APPROXIMATE COAL DEPTHS Unknown.
 IS COAL BEING MINED IN THE AREA? No. BY WHOM? _____

TO DRILL:
 SUBMIT FIVE (5) COPIES OF OG - 1, \$100.00 PERMIT FEE, PERFORMANCE BOND AND PERMANENT COPY OF PLAT.

TO DRILL DEEPER OR REDRILL:
 SUBMIT FIVE (5) COPIES OF OG - 1, SHOWING ORIGINAL PERMIT NUMBER AND PERFORMANCE BOND. ON WELLS DRILLED PRIOR TO 1929, A PERMANENT COPY OF THE PLAT AND THE ORIGINAL WELL RECORD MUST ALSO BE SUBMITTED.

TO FRACTURE - STIMULATE:
 OIL AND/OR GAS WELL ORIGINALLY DRILLED BEFORE JUNE 5, 1929, FIVE (5) COPIES OG - 1, PERFORMANCE BOND, PERMANENT PLAT AND ORIGINAL WELL RECORD.
 OIL AND/OR GAS WELL ORIGINALLY DRILLED ON AND/OR AFTER JUNE 5, 1929, FIVE COPIES OG - 1, SHOWING ORIGINAL PERMIT NUMBER, AND PERFORMANCE BOND.
 Required forms must be filed within ninety (90) days of completion for bond release. Inspector to be notified twenty-four (24) hours in advance.

The following waiver must be completed by the coal operator if the permit is to be issued within ten days of receipt thereof.

WAIVER: I the undersigned, Agent for _____ Coal Company, Owner or Operator of the coal under this lease have examined and place on our mine maps this proposed well location.

We the _____ Coal Company have no objections to said well being drilled at this location, providing operator has complied with all rules and regulations in Articles 4, 5, and 7, Chapter 22 of the West Virginia Code.

11/17/2023

 For Coal Company

 Official Title

PLANNED ROAD



STATE OF WEST VIRGINIA
DEPARTMENT OF MINES
Oil and Gas Division

RECEIVED
JUL 8 1975

OIL & GAS DIVISION
DEPT. OF MINES

WELL RECORD

Rotary Oil _____
Cable _____ Gas
Recycling _____ Comb. _____
Water Flood _____ Storage _____
Disposal _____ (Kind)

Quadrangle Clay

Permit No. Nic-349

Company	Casing and Tubing	Used in Drilling	Left in Well	Cement fill up Cu. ft. (Sks.)
<u>Appalachian Exploration & Dev., Inc.</u>				
<u>P.O. Box 628, Charleston, W.Va. 25322</u>				
<u>Farm T. W. Broughman Acres 1.34</u>				
<u>Location (waters) Twenty Mile</u>				
<u>Well No. 1 Elev. 813'</u>	Size			
<u>District Jefferson County Nicholas</u>	20-16			
<u>The surface of tract is owned in fee by</u>	Cond.			
<u>T. W. Broughman</u>	13-10"			
<u>Address Belva, West Virginia</u>	9 5/8			
<u>Mineral rights are owned by same as above</u>	8 5/8	137'	137'	
<u>Address</u>	7			
<u>Drilling Commenced 5/26/75</u>	5 1/2			
<u>Drilling Completed 5/31/75</u>	4 1/2	1887'	1887'	
<u>Initial open flow _____ cu. ft. _____ bbls.</u>	3			
<u>Final production 710M cu. ft. per day _____ bbls.</u>	2 -3/8"	1729'		
<u>Well open 5 hrs. before test 580# RP.</u>	Liners Used			

Well treatment details:

Attach copy of cementing record.

Perforated Keener-Injun 1756-60' (4 holes); 1784-92 (8 holes). Spotted 500 gals. MCA. Fract Injun with 58,000# 20/40 and 790 bbls. gelled water. ISIP 300#. Perforated Big Lime 1712-18' (12 holes) Acidized with 2000 gals. 15% HCL. ISIP 1600#.

Coal was encountered at none logged Feet _____ Inches _____
Fresh water 10 Feet _____ Salt Water 392 Feet _____
Producing Sand Keener-Injun Depth 1756-60'; 1784-92'

Formation	Color	Hard or Soft	Top Feet	Bottom Feet	Oil, Gas or Water	* Remarks
Rock and sand			0	18		
Rock and sand			18	127		
Shale			127	139		
Rock and sand			139	235		
Shale and sand			235	392		
Salt sand			392	475		
Salt sand			475	562		
Salt sand with st. shale			562	731		
Salt sand			731	1024		
Salt sand and shale			1024	1094		
Shale			1094	1225		
Shale with st. salt sand			1225	1437		
Sand and shale			1437	1595		
Lime			1595	1600		
Lime			1600	1720		
Big Lime			1720	1780		
Sand Injun			1780	1796		
Shale			1796	1888		

11/17/2023

(over)

* Indicates Electric Log tops in the remarks section.

Formation	Color	Hard or Soft	Top Feet <i>60</i>	Bottom Feet	Oil, Gas or Water	* Remarks

50

50

50

--	--	--

11/17/2023

Date July 2, 19 75

APPROVED *James B McR...*, Owner

By District Production Superintendent
(Title)

STATE OF WEST VIRGINIA
DEPARTMENT OF MINES
OIL AND GAS WELLS DIVISION

RECEIVED

MAY 30 1975

OIL & GAS DIVISION
DEPT. OF MINES

INSPECTOR'S WELL REPORT

Permit No. WC-347

Oil or Gas Well _____
(KIND)

Company	CASING AND TUBING	USED IN DRILLING	LEFT IN WELL	PACKERS
<u>A. E. D.</u>	Size			
Address <u>Chas. W. VA.</u>	16			Kind of Packer
Farm <u>T. W. Broughman</u>	13			
Well No. <u>1</u>	10			Size of
District <u>Jefferson County Nicholas</u>	8 3/4	<u>137'</u>		
Drilling commenced <u>5-25-75</u>	6 5/8			Depth set
Drilling completed _____ Total depth _____	5 3/16			
Date shot _____ Depth of shot _____	3			Perf. top
Initial open flow _____ /10ths Water in _____ Inch	2			Perf. bottom
Open flow after tubing _____ /10ths Merc. in _____ Inch	Liners Used			Perf. top
Volume _____ Cu. Ft.				Perf. bottom
Rock pressure _____ lbs. _____ hrs.	CASING CEMENTED <u>8 3/4" SIZE 137'</u> No. FT. _____ Date _____ <u>Cement to Surface</u>			
Oil _____ bbls., 1st 24 hrs.	NAME OF SERVICE COMPANY <u>Steel Drilling</u>			
Fresh water _____ feet _____ feet	COAL WAS ENCOUNTERED AT _____ FEET _____ INCHES			
Salt water _____ feet _____ feet	_____ FEET _____ INCHES _____ FEET _____ INCHES			

Drillers' Names Ellis - Jarvis - Triggus
F. W. A. - Potoy

Remarks: Wgt. on fluid at 931 ft. Saltland 392-
Net Ex.
Pop: They didn't have any Coal Logged. True Seisograph
was broke - gave H. E. D. orders to pull a log to top
5-28-75 of hole on this well Paul Phum

DATE _____ DISTRICT _____

Have daily orders to make accurate log or they would be voided on next hole

FOR BOND
RELEASE

STATE OF WEST VIRGINIA
DEPARTMENT OF MINES
OIL AND GAS WELLS DIVISION

RECEIVED

NOV 30 1978

OIL & GAS DIVISION
DEPT. OF MINES
INSPECTOR'S WELL REPORT

Permit No. NIC 349

Oil or Gas Well GAS
(KIND)

Company	CASING AND TUBING	USED IN DRILLING	LEFT IN WELL	PACKERS
<u>A E D</u>	Size			
<u>CHARLESTON</u>	16			Kind of Packer
<u>T W BROUGHMAN</u>	13			
<u># 1</u>	10			Size of
<u>JEFFERSON</u> County <u>NIC</u>	8 1/4			
Drilling commenced	6 5/8			Depth set
Drilling completed _____ Total depth _____	5 3/16			
Date shot _____ Depth of shot _____	3			Perf. top
Initial open flow _____ /10ths Water in _____ Inch	2			Perf. bottom
Open flow after tubing _____ /10ths Merc. in _____ Inch	Liners Used			Perf. top
Volume _____ Cu. Ft.				Perf. bottom
Rock pressure _____ lbs. _____ hrs.	CASING CEMENTED _____ SIZE _____ No. FT. _____ Date _____			
Oil _____ bbls., 1st 24 hrs.	NAME OF SERVICE COMPANY _____			
Fresh water _____ feet _____ feet	COAL WAS ENCOUNTERED AT _____ FEET _____ INCHES			
Salt water _____ feet _____ feet	_____ FEET _____ INCHES _____ FEET _____ INCHES			
	_____ FEET _____ INCHES _____ FEET _____ INCHES			

Drillers' Names _____

Remarks:

CHECKED NIC 349 FOR BOND RELEASE EVERY
THING IS O.K. WELL IS FINDING
I HAVENT ANY RECORDS ON THIS WELL

11-28-78
DATE

Legg Hopkins 506
DISTRICT WELL INSPECTOR



State of West Virginia

Department of Mines
Oil and Gas Division

Charleston 25305

December 1, 1978

ROBERT L. DODD - P. E.
DEPUTY DIRECTOR

WALTER N. MILLER
DIRECTOR

A. E. D. Inc.
P.O. Box 628
Charleston, W.Va. 25322
Attn: Mr. Parsons

In Re: PERMIT NO NIC-349
FARM T. W. Broughman
WELL NO One
DISTRICT Jefferson
COUNTY Nicholas

Gentlemen:

The Final Inspection Report for the above described well has been received in this office. Only the column checked below applies.

The well designated by the above permit number has been released under your Blanket Bond.

Please return the enclosed cancelled Single Bond which covered the well designated by the above permit number to the Surety Company who executed said bond in your behalf, in order that they may give you credit on their records.

xxxxxx Your well record was received and reclamation requirements approved. In accordance with Chapter 22, Article 4, Section 2, the above captioned well will remain under bond coverage for life of the well.

Very truly yours,

Robert L. Dodd

RLD/chm

11/17/2023

11/17/2023

11/17/2023

U.S. DEPARTMENT OF ENERGY
Federal Energy Regulatory Commission
Washington, D.C. 20426

**APPLICATION FOR DETERMINATION OF THE MAXIMUM LAWFUL
PRICE UNDER THE NATURAL GAS POLICY ACT (NGPA)**
(Sections 102, 103, 107 and 108)

PLEASE READ BEFORE COMPLETING THIS FORM:

General Instructions:

Complete this form if you are applying for price classification under sections 102, 103, 107 or 108 of the NGPA. A separate application is required for each well. If any reservoir qualifies for a category which differs from the category applicable to the producing well, separate applications must be made for the producing well and the reservoir. Complete each appropriate item on the reverse side of this page. The code numbers used in items 4.0 and 6.0 can be obtained from the Buyer/Seller Code Book. If there is more than one purchaser or contract, identify the additional information in the space below. Enter any additional remarks in the space below.

Submit the completed application to the appropriate Jurisdictional Agency as listed in title 18 of the CFR, part 270.103. If there are any questions, call (202) 275-4539.

Specific Instructions for Item 2.0, Type of Determination:

<u>Section of NGPA</u>	<u>Category Code</u>	<u>Description</u>
102	1	New OCS Lease
102	2	New onshore well (2.5 mile test)
102 ✓	3	New onshore well (1,000 feet deeper test)
102	4	New onshore reservoir
102	5	New reservoir on old OCS Lease
103	-	New onshore production well
107 ✓	-	High cost natural gas
108 ✓	-	Stripper well

Other Purchasers/Contracts:

<u>Contract Date</u> (Mo. Day Yr.)	<u>Purchaser</u>	<u>Buyer Code</u>
	N/A	
_____	_____	_____
_____	_____	_____
_____	_____	_____

Remarks:

JUL 2 1985

PARTICIPANTS:

DATE: DEC 27 1982

BUYER-SELLER CODE

WELL OPERATOR: Cabot Oil & Gas Corp.

00728

FIRST PURCHASER: Cabot Corp.

002733

OTHER: _____

W. Va. Department of Mines, Oil & Gas Division
WELL DETERMINATION FILE NUMBER

QUALIFIED

820709-108-067-0349

Use Above File Number on all Communications
Relating to Determination of this Well

CHECK EACH ITEM AS COMPLETE OR NOTE WHAT IS MISSING

ITEM NO.

- 1. FERC -121 Items not completed - Line No. All 7.0 + 8.0
- 2. IV-1 Agent H. Baird Whitehead
- 3. IV-2 Well Permit
- 4. IV-6 Well Plat
- 5. IV-35 Well Record Drilling Deepening
- 6. IV-36 Gas-Oil Test: Gas Only Was Oil Produced? Ratio
- 7. IV-39 Annual Production 1 years
- 8. IV-40 90 day Production 89 Days off line:
- 9. IV-48 Application for certification. Complete?
- 10-17. IV Form 51 - 52 - 53 - 54 - 55 - (56) - 57 - 58 Complete? Affidavit Signed
- 18-28. Other: Survey _____ Logs _____ Geological Charts _____
Structure Map _____ 1: 4000 Map _____ Well Tabulations _____
Gas Analyses _____
- (5) Date commenced: 5-26-75 Date completed 5-31-75 Deepened
- (5) Production Depth: 1756-60, 1784-92
- (5) Production Formation: Keener - Injun
- (5) Final Open Flow: 710 MCF
- (5) After Frac. R. P. 580#
- (6) Other Gas Test: _____
- (7) Avg. Daily Gas from Annual Production: 9162
365 = 25.1 MCF
- (8) Avg. Daily Gas from 90-day ending w/1-120 days 2417
89 = 27.2 MCF
- (8) Line Pressure: 64# PSIG from Daily Report
- (5) Oil Production: From Completion Report
- 17. Does lease inventory indicate enhanced recovery being done NO
- 17. Is affidavit signed? Notarized? 11/17/2023
- Does official well record with the Department confirm the submitted information? yes
- Additional information _____ Does computer program confirm? _____
- Is Determination Objected to _____ By Whom? _____

DEPARTMENT OF MINES, OIL AND GAS DIVISION

Operator's Well No T. W. Broughman #1

API Well No. 47 - 067 - 0349
State County Permit

STATE APPLICATION FOR WELL CLASSIFICATION

Previous File No. N/A
(If Applicable)

WELL OPERATOR Cabot Oil & Gas Corporation

DESIGNATED AGENT H. Baird Whitehead

ADDRESS P. O. Box 628
Charleston, WV 25322

ADDRESS P. O. Box 628
Charleston, WV 25322

Gas Purchase Contract No. 4-147 and Date 9/1/75
(Month, day and year)

Meter Chart Code P4588

Name of First Purchaser Cabot Corporation
P. O. Box 1473
Charleston WV 25325
(City) (State) (Zip Code)

FERC Seller Code 000728

FERC Buyer Code 002733

TYPE OF DETERMINATION BEING SOUGHT:

- (1) Initial determination (See FERC Form 121.) Section of NGPA 108 Category Code N/A
- (2) Determination that increased production is the result of enhanced recovery technology.
- (3) Determination of a seasonally affected well.

H. Baird Whitehead District Production Superintendent
Name (Print) Title

H Baird Whitehead
Signature

P. O. Box 628
Street or P. O. Box
Charleston WV 25322
City State (Zip Code)

304 344-8355
Area Phone Number
Code

(Certificate of Proof of Service to Purchaser)

Copy sent to Purchaser by Certified Mail (823550) on July 9, 1982.

(All of the above to be completed by the Operator/Applicant)

(To be completed by Jurisdictional Agency. Executed copy to be returned to Operator/Applicant and purchaser, if known).

The Department of Mines has received a request, for certification of the above described well as meeting the requirements of Section 108 under the Natural Gas Policy Act of 1978, (NGPA); or for determination that increased production is the result of enhanced recovery technology under Section 108 of (NGPA); or for determination of a seasonally affected well under Section 108 of (NGPA)

All interested parties are hereby notified that on the day of , 19 , at the office of the Oil and Gas Division in Charleston, West Virginia, or as soon thereafter as it may be heard, there will be a public hearing, if requested, or if objection is filed.

This Application is assigned File No. .

Initial review of information submitted indicates the well is, is not entitled to certification as claimed under the Natural Gas Policy Act (NGPA). A review of this evidence and any additional evidence will be made at the time appointed for a public hearing or as soon thereafter as the matter may be heard.

Unless objections are timely filed or a request for a hearing is made within fifteen (15) days, a hearing will not be held except on ex parte motion of the department and the matter will go to determination.

WEST VIRGINIA DEPARTMENT OF MINES

JUL 9 1982

Date received by Jurisdictional Agency

By H Baird Whitehead Director
Title

11/17/2023

STATE OF WEST VIRGINIA
DEPARTMENT OF MINES, OIL AND GAS DIVISION

Date June 30, 19 82

Operator's Well No. T. W. Broughman #1

API Well No. 47 - 067- - 0349
State County Permit

WELL CLASSIFICATION FORM

STRIPPER GAS WELL

NGPA Section 108

DESIGNATED AGENT H. Baird Whitehead

ADDRESS P. O. Box 628

Charleston, WV 25322

WELL OPERATOR Cabot Oil & Gas Corporation

ADDRESS P. O. Box 628

Charleston, WV 25322

LOCATION: Elevation 813'

Watershed Twenty Mile

Dist. Jefferson County Nicholas Quad. Clay

GAS PURCHASER Cabot Corporation

ADDRESS P. O. Box 1473

Charleston, WV 25325

Gas Purchase Contract No. 4-147

Meter Chart Code P4588

Date of Contract 9/1/75

* * * * *

Provide a complete inventory of the lease and production equipment used for the well for the previous 24 months or, if less than 24 months, the period the well has been in production. Include a complete list of equipment or processes used in connection with recognized enhanced recovery techniques during completion or production. (Attach separate sheets, if necessary.)

"SEPARATE SHEET ATTACHED"

List all records reasonably available to you which contain information relevant to a determination of eligibility (including production records, B&C Tax Records and royalty payment records) and indicate the location of such records:

- Production Records and Royalty Payment Records - Houston, Texas
- Business and Occupation Tax and Ad Valorem Tax Records - Boston, Massachusetts
- Well Test Data and Drilling Records - Charleston, West Virginia

11/17/2023

Describe the search made of any records listed above:

A well by well review of production records, test data and drilling records was made by company personnel. When required for further substantiation, other records were examined.

Are you aware of any other information which would tend to be inconsistent with the information specified above? Yes No . If yes, indicate the type and source of the information.

AFFIDAVIT

I, H. Baird Whitehead, having been first sworn according to law, state that I have caused to be made a diligent search of those records hereinbefore indicated in the manner herein described, that the information contained in this document is true and accurate and that on the basis of the records and examinations hereinbefore described, and to the best of my information, knowledge and belief, the well for which this certification is sought qualifies as a stripper well.

H. Baird Whitehead

STATE OF WEST VIRGINIA,

COUNTY OF Kanawha, TO WIT:

I, Lorene Miller, a Notary Public in and for the state and county aforesaid, do certify that H. Baird Whitehead whose name is signed to the writing above, bearing date the 30th day of June, 1982, has acknowledged the same before me, in my county aforesaid.

Given under my hand and official seal this 30th day of June, 1982.

My term of office expires on the 5th day of March, 1989.

Lorene Miller
Notary Public

11/17/2023

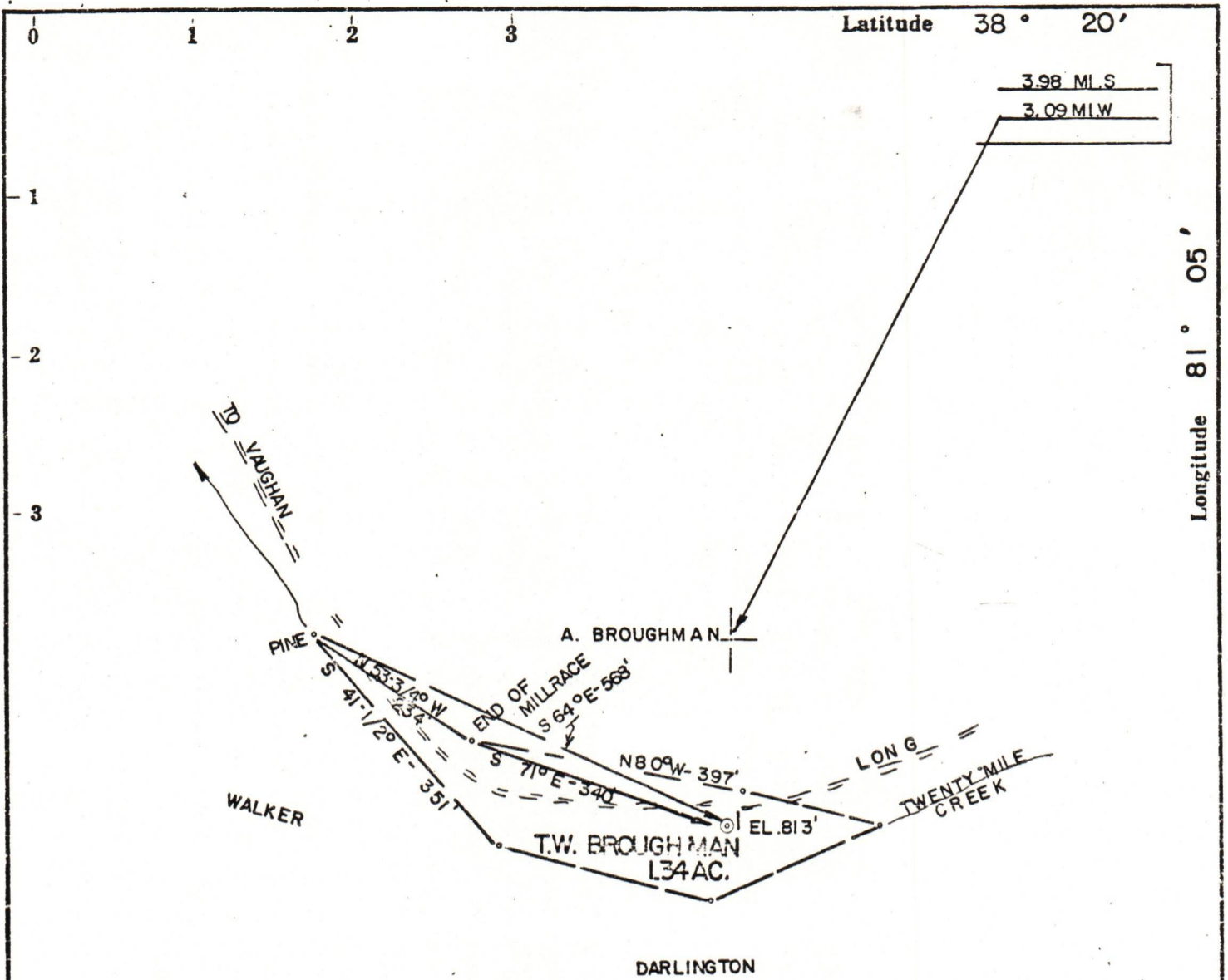

ACCURACY: 1" / 200'

Source of Elevation VAUGHAN (811')

I, the undersigned, hereby certify that this map is correct to the best of my knowledge and belief and shows all the information required by paragraph 6 of the rules and regulations of the oil and gas section of the mining laws of West Virginia.

- New Location
- Drill Deeper
- Abandonment
- Fracture
- Redrill

Chet Waterman

Company APPALACHIAN EXPL & DEV. CORP
 Address CHARLESTON, WV
 Farm T. W. BROUGHMAN
 Tract Acres 1.34 Lease No. _____
 Well (Farm) No. 1 Serial No. _____
 Elevation (Spirit Level) 813'
 Quadrangle CLAY
 County NICHOLAS District JEFFERSON
 Engineer CHET WATERMAN
 Engineer's Registration No. 3788
 File No. 75003-171 Drawing No. _____
 Date 4/30/75 Scale 1" = 200'

STATE OF WEST VIRGINIA
 DEPARTMENT OF MINES
 OIL AND GAS DIVISION
 CHARLESTON

WELL LOCATION MAP
 FILE NO. 47-067-349

11/17/2023

± Denotes location of well on United States Topographic Maps, scale 1 to 62,500, latitude and longitude lines being represented by border lines as shown.

— Denotes one inch spaces on border line of original tracing.

5,875 K

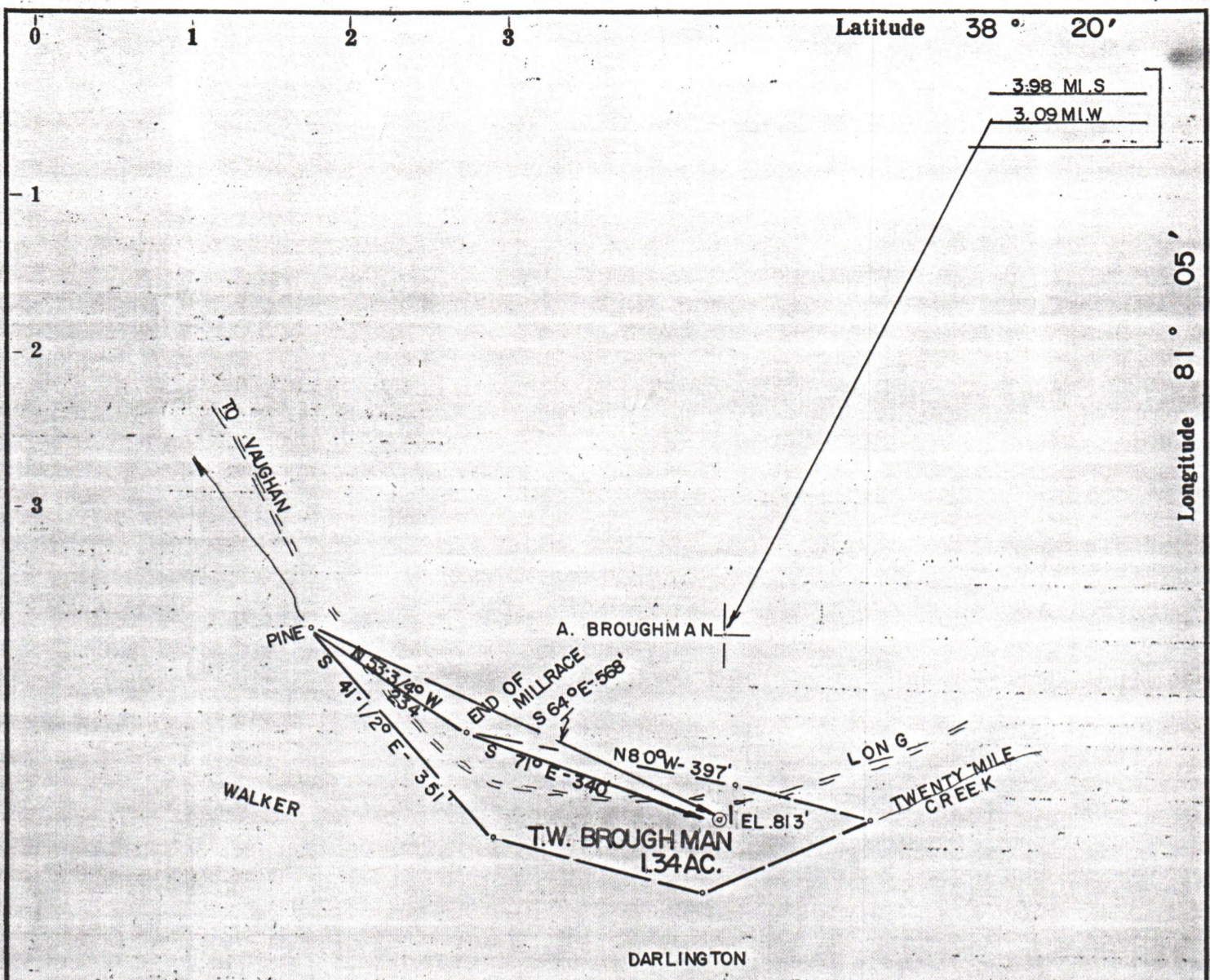

ACCURACY: 1" / 200'

Source of Elevation VAUGHAN (811')

I, the undersigned, hereby certify that this map is correct to the best of my knowledge and belief and shows all the information required by paragraph 6 of the rules and regulations of the oil and gas section of the mining laws of West Virginia.

- New Location
- Drill Deeper
- Abandonment
- Fracture
- Redrill

Chet Waterman

Company APPALACHIAN EXPL & DEV. CORP. INC.
 Address CHARLESTON, WV
 Farm T. W. BROUGHMAN
 Tract Acres 1.34 Lease No. _____
 Well (Farm) No. 1 Serial No. _____
 Elevation (Spirit Level) 813'
 Quadrangle CLAY
 County NICHOLAS District JEFFERSON
 Engineer CHET WATERMAN
 Engineer's Registration No. 3788
 File No. 75003-171 Drawing No. _____
 Date 4/30/75 Scale 1" = 200'

STATE OF WEST VIRGINIA
 DEPARTMENT OF MINES
 OIL AND GAS DIVISION
 CHARLESTON

WELL LOCATION MAP
 FILE NO. Nic-349
 11/17/2023

+ Denotes location of well on United States Topographic Maps, scale 1 to 62,500, latitude and longitude lines being represented by border lines as shown.
 — Denotes one inch spaces on border line of original tracing.

47-067

1910' Injection

According to the density log 8 probable coals are present between 214 feet and 320 feet. There do not appear to be any coals at lower depths, and there is no density log for the upper 138 feet. These 8 coal peaks are at 214, 220, 240, 248, 263, 280, and a split coal from 312-320. All are very thin as you can see.