

WR 1-1H (47-067-00948) REVISED

LINE LEGEND

- LEASE BOUNDARY: - - - - -
- CREEK/STREAM: - - - - -
- PROPOSED LATERAL: - - - - -
- ROADS: - - - - -
- SURFACE BOUNDARY: - - - - -

WR INFANTRY 1-1H LANDING POINT

STATE PLANE COORDINATES SOUTH ZONE -NAD 27
(N) 434184
(E) 2062023

L & L DECIMAL NAD 27
38.19220
80.78419

UTM (NAD 83) ZONE 17 METERS
4227175.10
518914.17

WR INFANTRY 1-1H BOTTOM HOLE

STATE PLANE COORDINATES SOUTH ZONE -NAD 27
(N) 438665
(E) 2057314

L & L DECIMAL NAD 27
38.20453
80.80054

UTM (NAD 83) ZONE 17 METERS
4228540.24
517479.24

WR INFANTRY 1-1H SURFACE HOLE

STATE PLANE COORDINATES SOUTH ZONE -NAD 27
(N) 433705
(E) 2062505

L & L DECIMAL NAD 27
38.19088
80.78252

UTM (NAD 83) ZONE 17 METERS
4227029.03
519060.82

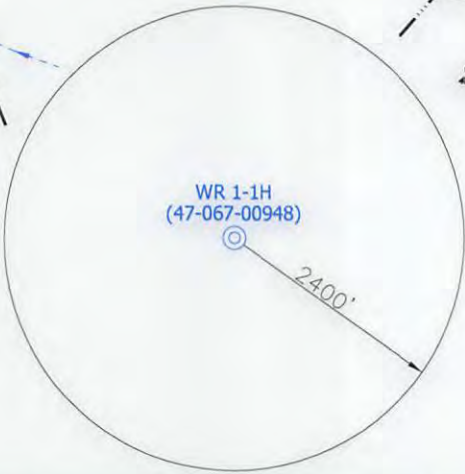
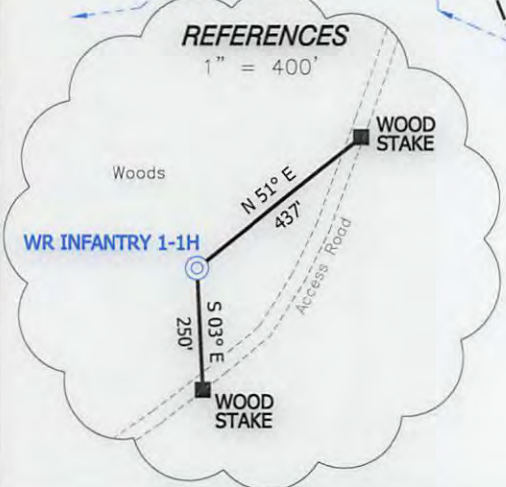

- NOTES ON SURVEY**
1. THERE ARE NO EXISTING OCCUPIED DWELLINGS, BUILDINGS OR RAILROADS WITHIN 625' OF PROPOSED WELL.
 2. THERE ARE NO WATER WELLS OR DEVELOPED SPRINGS WITHIN 250' OF PROPOSED WELL.
 3. TIES TO WELLS AND CORNERS ARE BASED ON STATE PLANE GRID NORTH WY SOUTH ZONE NAD '27, WELL LAT./LONG. ESTABLISHED BY SG-GPS(OPUS).
 4. SURFACE OWNER AND ADJOINER INFORMATION TAKEN FROM THE ASSESSOR AND COUNTY CLERK RECORDS OF NICHOLAS COUNTY IN APRIL, 2017 AND INFORMATION PROVIDED BY BRC OPERATING CO., LLC.
 5. WELLS SHOWN ARE TAKEN FROM RECORDS OF WVDEP.

I, THE UNDERSIGNED, HEREBY CERTIFY THAT THIS PLAT IS CORRECT TO THE BEST OF MY KNOWLEDGE AND BELIEF AND SHOWS ALL THE INFORMATION REQUIRED BY LAW AND THE RULES ISSUED AND PRESCRIBED BY THE DEPARTMENT OF ENVIRONMENTAL PROTECTION.

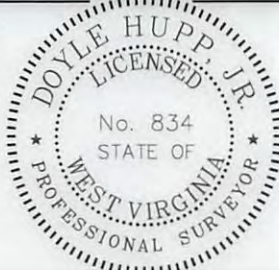

(+) DENOTES LOCATION OF WELL ON UNITED STATES TOPOGRAPHIC MAPS.
DATE AUGUST 22, 20 17
OPERATORS WELL NO. WR 1-1H
API REVISED H6A
WELL NO. 47-067-00948
STATE COUNTY PERMIT
MOD

P.S. 834
Doyle Hupp, Jr.
HUPP Surveying & Mapping
P.O. Box 647 Grantsville, WV 26147
(304) 354-7035 EMAIL: hupp@frontiernet.net

MINIMUM DEGREE OF ACCURACY 1/2500 FILE NO. W2550 (BK83-78)
PROVEN SOURCE OF ELEVATION SG-GPS (OPUS) SCALE 1" = 1000'

STATE OF WEST VIRGINIA
DIVISION OF ENVIRONMENTAL PROTECTION
OFFICE OF OIL AND GAS

WELL TYPE : OIL GAS LIQUID WASTE IF "GAS" PRODUCTION STORAGE DEEP SHALLOW

LOCATION : ELEVATION 2,420' WATERSHED MOUSE FORK OF HOMINY CREEK
DISTRICT WILDERNESS COUNTY NICHOLAS QUADRANGLE MT. NEBO

SURFACE OWNER PLUM CREEK TIMBERLANDS LP ACREAGE 33.39±
ROYALTY OWNER MEADWESTVACO CORP., et al LEASE ACREAGE 552.79± **09/08/2017**

PROPOSED WORK : LEASE NO. _____
DRILL CONVERT _____ DRILL DEEPER _____ REDRILL _____ FRACTURE OR STIMULATE PLUG OFF OLD FORMATION _____ PERFORATE NEW FORMATION _____ PLUG AND ABANDON _____ CLEAN OUT AND REPLUG _____ OTHER _____
PHYSICAL CHANGE IN WELL (SPECIFY) _____ TARGET FORMATION MARCELLUS
ESTIMATED DEPTH TVD- 7,297'-7,362' MD- 14,184'

WELL OPERATOR BRC OPERATING CO., LLC DESIGNATED AGENT CHUCK BRIGHTMAN
ADDRESS 200 CRESCENT COURT, SUITE 1900 DALLAS, TX 75201 ADDRESS 44 SUNDAY RD. HICO, WV 25884

COUNTY NAME
PERMIT