



STATE OF WEST VIRGINIA
DEPARTMENT OF MINES

RECEIVED
APR 18 1972
Ladd
OIL & GAS DIVISION
DEPT. OF MINES

Oil and Gas Division
OIL AND GAS WELL PERMIT APPLICATION

TO THE DEPARTMENT OF MINES,
Charleston, W. Va.

DATE April 17, 1972
Company RAMCO Oil & Gas Corp.
Address P. O. Box 99, Belpre, Ohio 45714
Farm M. McConnell Acres 103
Location (waters) Middle Wheeling Creek
Well No. 1 Elevation 1100'
District Tridelphia County Ohio
Quadrangle Valley Grove 7.5' Wheeling 15'

Surface Owner Merle McConnell
Address Dallas Pike, W. Va.
Mineral Owner Merle McConnell et al
Address Dallas Pike, W. Va.
Coal Owner Valley Camp Coal
Address Valley Grove, W. Va.
Coal Operator Valley Camp Coal
Address Valley Grove, W. Va.

THIS PERMIT MUST BE POSTED AT THE WELL SITE

All provisions being in accordance with Chapter 22, of the W. Va. Code, the location is hereby approved for drilling. This permit shall expire if operations have not commenced by Aug. 18, 1972.

INSPECTOR TO BE NOTIFIED Arthur Full
Shubert, Wva. PH: 775-5611

Deputy Director - Oil & Gas Division

GENTLEMEN:

The undersigned well operator is entitled to drill upon the above named farm or tract of land for oil and gas, having fee title thereto, (or as the case may be) under grant or lease dated January 24, 1972 by Columbia Gas Transmission Corp. made to RAMCO Oil & Gas Corp. and recorded on the _____ day of _____ 19____, in _____ County, Book _____ Page _____
 NEW WELL _____ DRILL DEEPER _____ REDRILL _____ FRACTURE OR STIMULATE
_____ OIL AND GAS WELL ORIGINALLY DRILLED BEFORE JUNE 5, 1969.

The enclosed plat was prepared by a registered engineer or licensed land surveyor and all coal owners and/or operators have been notified as of the above date.

The above named coal owners and/or operator are hereby notified that any objection they wish to make, or are required to make by Section 3 of the Code, must be received by, or filed with the Department of Mines within ten (10) days. *

Copies of this notice and the enclosed plat were mailed by registered mail, or delivered to the above named coal operators or coal owners at their above shown respective address _____ day _____ before, or on the same day with the mailing or delivery of this copy to the Department of Mines at Charleston, West Virginia.

Very truly yours, RAMCO Oil & Gas Corp.
(Sign Name) Neal Rudder, President
Well Operator

Address of Well Operator
P. O. Box 99 Street
Belpre City or Town
Ohio 45714 State

*SECTION 3 If no objections are filed or found by the Department of mines, within said period of ten days from the receipt of notice and plat by the department of mines, to said proposed location, the department shall forthwith issue to the well operator a permit reciting the filing of such plat, that no objections have been made by the coal operators or found thereto by the department and that the same is approved and the well operator authorized to proceed.

BOND DRILL

Ohio-22 PERMIT NUMBER

THIS IS AN ESTIMATE ONLY
ACTUAL INFORMATION WILL BE SUBMITTED ON OG-10 UPON COMPLETION

PROPOSED WORK ORDER TO DRILL _____ DEEPEN _____ FRACTURE-STIMULATE _____
 DRILLING CONTRACTOR: (If Known) _____ RESPONSIBLE AGENT: _____
 NAME John Mossor _____ NAME Brad Crouse _____
 ADDRESS Harrisville, W. Va. _____ ADDRESS Grantsville, W. Va. _____
 TELEPHONE (304) 643-2155 _____ TELEPHONE (304) 354-7657 _____
 ESTIMATED DEPTH OF COMPLETED WELL: 3000' _____ ROTARY _____ CABLE TOOLS _____
 PROPOSED GEOLOGICAL FORMATION: Fourth Sand _____
 TYPE OF WELL: OIL _____ GAS _____ COMB. _____ STORAGE _____ DISPOSAL _____
 RECYCLING _____ WATER FLOOD _____ OTHER _____

TENTATIVE CASING PROGRAM:

CASING AND TUBING SIZE	USED FOR DRILLING	LEFT IN WELL	CEMENT FILL UP OR SACKS - CUBIC FT.
20 - 16	20	20	
13 - 10	600	600	125 sacks
9 - 5/8			
8 - 5/8	1400	1400	100 sacks
7			
5 1/2			
4 1/2			
3			Perf. Top
2			Perf. Bottom
Liners			Perf. Top
			Perf. Bottom

APPROXIMATE FRESH WATER DEPTHS _____ FEET _____ SALT WATER _____ FEET _____
 APPROXIMATE COAL DEPTHS 535' _____
 IS COAL BEING MINED IN THE AREA? Yes _____ BY WHOM? Valley Camp Coal Co. _____

TO DRILL:

SUBMIT FIVE (5) COPIES OF OG - 1, \$100.00 PERMIT FEE, PERFORMANCE BOND AND PERMANENT COPY OF PLAT.

TO DRILL DEEPER OR REDRILL:

SUBMIT FIVE (5) COPIES OF OG - 1, SHOWING ORIGINAL PERMIT NUMBER AND PERFORMANCE BOND. ON WELLS DRILLED PRIOR TO 1929, A PERMANENT COPY OF THE PLAT AND THE ORIGINAL WELL RECORD MUST ALSO BE SUBMITTED.

TO FRACTURE - STIMULATE:

OIL AND/OR GAS WELL ORIGINALLY DRILLED BEFORE JUNE 5, 1929, FIVE (5) COPIES OG - 1, PERFORMANCE BOND, PERMANENT PLAT AND ORIGINAL WELL RECORD.

OIL AND/OR GAS WELL ORIGINALLY DRILLED ON AND/OR AFTER JUNE 5, 1929, FIVE COPIES OG - 1, SHOWING ORIGINAL PERMIT NUMBER, AND PERFORMANCE BOND.

Required forms must be filed within ninety (90) days of completion for bond release. Inspector to be notified twenty-four (24) hours in advance.

The following waiver must be completed by the coal operator if the permit is to be issued within ten days of receipt thereof.

WAIVER: I the undersigned, Agent for Valley Camp Coal Company, Owner or Operator of the coal under this lease have examined and place on our mine maps this proposed well location.

We the Valley Camp Coal Company have no objections to said well being drilled at this location, providing operator has complied with all rules and regulations in Articles 4, 5, and 7, Chapter 22 of the West Virginia Code.

by telephone 4-17-72 10 dd
Wendell Bolden
 For Coal Company
Chief Engineer
 Official Title

LAWSON OIL & GAS WELL CEMENTING CO., Inc.

P. O. BOX 1726 • PARKERSBURG, W. VA.

No. **6221**

DATE 6-16-72	CUSTOMER'S ORDER NO.	TRUCK CALLED OUT DATE TIME 6-16 9:30 AM	ON LOCATION DATE TIME 6-16 1:30 PM	JOB BEGAN DATE TIME 6-16 2:30 PM	JOB COMPLETED DATE TIME 6-16 4:00 PM
WELL NUMBER #1	FARM NO. M. McCLOWN	PLACE	COUNTY OHIO	STATE W. VA.	
WELL OWNER LAWSON OIL & GAS CO. INC.			CONTRACTOR MOSSOR		
CHARGE TO LAWSON OIL & GAS CO. INC.			MAILING ADDRESS P.O. 99 BLENHEIM, OHIO		

Owner, operator or agent states the well is in condition for the service job to be performed and submits the following data:

TYPE OF JOB (✓) ONE	CASING	HOLE DATA	TUB. or DRILL PIPE	CEMENT'G PACKER	FLOATING EQUIPMENT
SURFACE	SIZE 103	BORE SIZE 13"	SIZE	SIZE	FLOAT SHOE
INTERMEDIATE	WEIGHT 32	NEW OLD ✓	TYPE	TYPE	GUIDE SHOE
PRODUCTION	DEPTH 581	DEPTH 575	WEIGHT	WEIGHT	FLOAT COLLAR
SQUEEZE	NEW	CABLE TOOLS ✓	TOTAL DEPTH	DEPTH SET	OTHER EQUIPMENT
PUMPING	USED ✓	ROTARY			
PLUG BACK	TYPE H40				
GROUTING					
OTHER (write in)					

REMARKS By Servicemen: *Hole did not circulate with cement*
THANK YOU

It is expressly understood and agreed that Lawson Cementing Co. is an independent Contractor for the said work and services and that Lawson Cementing Co. shall not be responsible or liable for damage to property of said well owner, operator or drilling contractor, including but not limited to subsurface damage. Well owner, operator or drilling contractor shall be responsible and same harmless, Lawson Cementing Co. against any liability for reservoir loss or damage, or property damage arising from a well blow out. If equipment or property of Lawson Cementing Co. are lost or destroyed at the well, the well owner, operator or drilling contractor shall either recover the same or pay for such equipment.

It is agreed that Lawson Cementing Co. shall not be bound by any agreement not herein contained, and no agent or employee of Lawson Cementing Co. has authority to vary, alter or extend the terms hereof. A mechanic's lien is hereby acknowledged on above well and equipment to secure the amount for materials and services performed thereto. I have read and understood the terms hereof and I hereby represent that I am authorized to sign the same as agent of customer.

SIGNED WELL OWNER, OR OPERATOR	AGENT <i>[Signature]</i>	CEMENT DATA SACKS 235	BULK <input checked="" type="checkbox"/>	SACKED	MIXED WT. PER GAL.
THIS WORK ORDER MUST BE SIGNED BEFORE WORK IS STARTED. DATE 6-16-72		TYPE REG	BRAND COLUMBIA	% GEL, OTHER ADMIX	
PRESSURE CIRCULATING 150	PLUGS & HEADS BOTTOM TYPE	INVOICE SECTION		DEPTH OF JOB 575 FT.	
MINIMUM 150	TOP TYPE Wood	PRICE REF. 2	SERVICE & MATERIAL CHARGES		AMOUNT
MAXIMUM 150	TYPE HEAD Swadge	BASE		265.00	
FINAL 150	CEMENT LEFT IN CASING 10 FT.	2353KS CEMENT 200		470.00	
BY REQUEST <input type="checkbox"/>	NECESSITY <input type="checkbox"/>	11.05ton 25# FOLZOMI		193.20	
TRUCK TYPE TWIN GASO #31		1-1034" FW PLUG		13.20	
SERVICEMEN D.W. LAWSON		RECEIVED JUN 19 1972			
R. CHURCH					
E. PICKARD		OIL & GAS DIVISION DEPT. OF MINES			
REMARKS: 22 M. # OHIO-22		6% INTEREST CHARGED AFTER 30 DAYS FROM DATE OF INVOICE.		SUB TOTAL 941.40	
				STATE TAX	
				TOTAL	

WELL REPORT



RECEIVED

SEP 5 1972

STATE OF WEST VIRGINIA
DEPARTMENT OF MINES

OIL & GAS DIVISION
DEPT. OF MINES

Oil and Gas Division

WELL RECORD

Rotary _____ Oil _____
Cable Gas _____
Recycling _____ Comb. _____
Water Flood _____ Storage _____
Disposal _____ Dry ^{C. NOLL}
(Kind)

AO 15'
a-34

Quadrangle Wheeling - 15'
Valley Grove - 7 1/2'

Permit No. Ohio-22

Company RAMCO Oil & Gas Corp.
Address P. O. Box 99, Belpre, Ohio 45714
Farm M. McConn Acres 103
Location (waters) Middle Wheeling Creek
Well No. 1 Elev. 1100'
District Tridelphia County Ohio
The surface of tract is owned in fee by _____
Merle McConn
Address Dallas Pike, W. Va.
Mineral rights are owned by Merle McConn et al
Address Dallas Pike, W. Va.
Drilling Commenced 5/31/72
Drilling Completed 8/18/72
Initial open flow _____ cu. ft. _____ bbls.
Final production _____ cu. ft. per day _____ bbls.
Well open _____ hrs. before test _____ RP.
Well treatment details:

Casing and Tubing	Used in Drilling	Left in Well	Cement fill up Cu. ft. (Sks.)
Size xxxx 18"			
Cond. 10 "	22'		
9 5/8	573'	573'	235 sks.
8 5/8	1211'		
7	1705'		
5 1/2			
4 1/2			
3			
2			
Liners Used			

Lawson Oil & Gas Well Cementing Co., Inc.
Attach copy of cementing record.

Coal was encountered at 533 - 539 Feet _____ Inches
Fresh water _____ Feet _____ Salt Water 1300', 1470', 1827', 1837' Feet
Producing Sand _____ Depth _____

Formation	Color	Hard or Soft	Top Feet	Bottom Feet	Oil, Gas or Water	* Remarks
Soil			0	2		
Clay			2	10		
Lime			10	20		
Slate			20	35		
Lime			35	50		
Slate			50	55		
Lime			55	125		
Slate			125	145		
Lime			145	155		
Slate			155	165		
Lime			165	195		
Slate			195	220		
Lime			220	250		
Slate			250	327		
Lime			327	357		
Slate			357	367		
Lime			367	445		
Slate			445	475		
Lime			475	510		
Slate			510	514		

(over)

* Indicates Electric Log tops in the remarks section.

Formation	Color	Hard or Soft	Top Feet	Bottom Feet	Oil, Gas or Water	* Remarks
Lime			514	522		
Slate			522	533		
Coal			533	539		
Slate			539	610		
Red Rock			610	620		
Lime			620	660		
Red Rock			660	664		
Lime			664	710		
Sand			710	750		
Slate			750	825		
Red Rock			825	832		
Slate			832	840		
Red Rock			840	850		
Slate			850	895		
Red Rock			895	900		
Slate			900	905		
Lime			905	922		
Slate			922	995		
Sand			995	1015		
Slate			1015	1030		
Lime			1030	1060		
Sand			1060	1085		
Slate			1085	1095		
Lime			1095	1155		
Slate			1155	1163		
Sand			1163	1215		
Lime			1215	1255		
Sand			1255	1290		
Slate			1290	1296		water 1300' - 10 gallon per hour
Sand			1296	1350		
Slate			1350	1375		
Sand			1375	1415		
Slate			1415	1450		
Sand			1450	1540		water 1470' - hole full
Slate			1540	1570		
Lime			1570	1590		
Slate			1590	1630		
Sand			1630	1938		water 1827'-1837' 5 gallon per hour
Slate			1938	2042		
Sand			2042	2048		
Slate			2048	2210		
Sand			2210	2220		
Slate			2220	2275		
Sand			2275	2295		gas & oil 2280' (smell only)
Slate			2295	2365		
Red Rock & Slate			2365	2460		
Slate & Sand			2460	2470		
Slate & Red Rock			2470	2591		
Slate & Sand			2591	2622		
Slate			2622	2643		
Slate & Sand			2643	2661		
Slate & Red Rock			2661	2683		
Slate & Sand			2683	2697		
Slate			2697	2738		
Slate & Sand			2738	3478		
TD			3478			

Date August 29, 19 72

APPROVED RAMCO Oil & Gas Corp., Owner

By *Neal R. ...*, President
(Title)

STATE OF WEST VIRGINIA
DEPARTMENT OF MINES
OIL AND GAS WELLS DIVISION

RECEIVED
JUN 19 1972
OIL & GAS DIVISION
DEPT. OF MINES

INSPECTOR'S WELL REPORT

Spudder

Permit No. 0410-22

Oil or Gas Well _____
(KIND)

Company <u>RANCO O. AND C.</u>	CASING AND TUBING	USED IN DRILLING	LEFT IN WELL	PACKERS
	Address <u>BELPRE, OHIO</u>	Size		
Farm <u>M. MCCONN</u>	16	<u>12</u>		
Well No. <u>1</u>	13			
District <u>TRIADLPHIA</u> County <u>OHIO</u>	10	<u>573</u>	<u>CEMENT.</u>	Size of _____
Drilling commenced <u>5-31-72</u>	8 1/4			
Drilling completed _____ Total depth _____	6 5/8			Depth set _____
Date shot _____ Depth of shot _____	5 3/16			
Initial open flow _____ /10ths Water in _____ Inch	3			Perf. top _____
Open flow after tubing _____ /10ths Merc. in _____ Inch	2			Perf. bottom _____
Volume _____ Cu. Ft.	Liners Used			Perf. top _____
Rock pressure _____ lbs. _____ hrs.				Perf. bottom _____
Oil _____ bbls., 1st 24 hrs.	CASING CEMENTED <u>10"</u> SIZE <u>573</u> No. FT. <u>4-12</u> Date			
Fresh water <u>50</u> feet _____ feet	NAME OF SERVICE COMPANY <u>LAWSON</u>			
Salt water <u>---</u> feet _____ feet	COAL WAS ENCOUNTERED AT <u>533</u> FEET <u>72</u> INCHES			
	_____ FEET _____ INCHES	_____ FEET _____ INCHES	_____ FEET _____ INCHES	_____ FEET _____ INCHES
	_____ FEET _____ INCHES	_____ FEET _____ INCHES	_____ FEET _____ INCHES	_____ FEET _____ INCHES

Drillers' Names _____

COOT, JOHN MOSSOR

Remarks: CEMENTED 10" CASING WHILE I WAS ON JOB. CEMENT TICKET ENCLOSED.
DEPTH- 575' WELD 10" UP TO CEMENT.

6-16-72

DATE

Arthur Bull

DISTRICT WELL INSPECTOR

STATE OF WEST VIRGINIA
 DEPARTMENT OF MINES
 OIL AND GAS WELLS DIVISION
INSPECTOR'S PLUGGING REPORT

Permit No. _____ Well No. _____

COMPANY _____ ADDRESS _____

FARM _____ DISTRICT _____ COUNTY _____

Filling Material Used _____

Liner			Location	Amount	Packer	Location		
PLUGS USED AND DEPTH PLACED			BRIDGES			CASING AND TUBING		
CEMENT-THICKNESS	WOOD-SIZE	LEAD	CONSTRUCTION-LOCATION			RECOVERED	SIZE	LOST

Drillers' Names _____

Remarks:

_____ I hereby certify I visited the above well on this date.
DATE

 DISTRICT WELL INSPECTOR

STATE OF WEST VIRGINIA
DEPARTMENT OF MINES
OIL AND GAS WELLS DIVISION

RECEIVED
JUL 7 1972
OIL & GAS DIVISION
DEPT. OF MINES

INSPECTOR'S WELL REPORT

SPURDER

Permit No. 0410-22

Oil or Gas Well _____
(KIND)

Company <u>ARMCO O. AND G.</u>	CASING AND TUBING	USED IN DRILLING	LEFT IN WELL	PACKERS
	Address <u>Belpre, 0410</u>	Size		
Farm <u>M. McCOWN</u>	16			
Well No. <u>1</u>	13			
District <u>TRIADOPHIA</u> County <u>0410</u>	10	<u>573</u>	<u>CEMENT</u>	Size of _____
Drilling commenced <u>5-31-72</u>	8 1/4	<u>1211</u>		
Drilling completed _____ Total depth _____	6 5/8			Depth set _____
Date shot _____ Depth of shot _____	5 3/16			
Initial open flow _____ /10ths Water in _____ Inch	3			Perf. top _____
Open flow after tubing _____ /10ths Merc. in _____ Inch	2			Perf. bottom _____
Volume _____ Cu. Ft.	Liners Used			Perf. top _____
Rock pressure _____ lbs. _____ hrs.				Perf. bottom _____
Oil _____ bbls., 1st 24 hrs.	CASING CEMENTED <u>10</u> SIZE <u>573</u> No. FT. <u>6-12</u> Date _____			
Fresh water <u>50</u> feet _____ feet	NAME OF SERVICE COMPANY <u>LAWSON</u>			
Salt water <u>1300</u> feet <u>1470</u> feet	COAL WAS ENCOUNTERED AT <u>533</u> FEET <u>72</u> INCHES			
	_____ FEET _____ INCHES _____ FEET _____ INCHES			
	_____ FEET _____ INCHES _____ FEET _____ INCHES			

Drillers' Names _____

CAPT. JOHN MOSSOR

Remarks: DRG-1480'

7-5-72
DATE

Arthur M. Mull
DISTRICT WELL INSPECTOR

STATE OF WEST VIRGINIA
 DEPARTMENT OF MINES
 OIL AND GAS WELLS DIVISION
INSPECTOR'S PLUGGING REPORT

Permit No. _____

Well No. _____

COMPANY _____ ADDRESS _____

FARM _____ DISTRICT _____ COUNTY _____

Filling Material Used _____

Liner	Location	Amount	Packer	Location		
PLUGS USED AND DEPTH PLACED			BRIDGES	CASING AND TUBING		
CEMENT-THICKNESS	WOOD-SIZE	LEAD	CONSTRUCTION-LOCATION	RECOVERED	SIZE	LOST

Drillers' Names _____

Remarks: _____

_____ I hereby certify I visited the above well on this date.

DATE

 DISTRICT WELL INSPECTOR

STATE OF WEST VIRGINIA
DEPARTMENT OF MINES
OIL AND GAS WELLS DIVISION

RECEIVED

AUG 1 1972

OIL & GAS DIVISION
DEPT. OF MINES

INSPECTOR'S WELL REPORT

SPUDDER

Permit No. 6410-22

Oil or Gas Well _____
(KIND)

Company <u>RAMCO O. AND G. CORP</u>	CASING AND TUBING	USED IN DRILLING	LEFT IN WELL	PACKERS
	Address <u>BELPAL, OHIO</u>	Size		
Farm <u>M. MCCONN</u>	16			
Well No. <u>1</u>	13			
District <u>TRIADLPHIA</u> County <u>OHIO</u>	10	<u>573</u>		Size of _____
Drilling commenced <u>5-31-72</u>	8 1/4	<u>1211</u>		<u>BOTTOM HOLE</u> Depth set <u>1705'</u>
Drilling completed _____ Total depth _____	6 5/8	<u>1705</u>		
Date shot _____ Depth of shot _____	5 3/16			
Initial open flow _____ /10ths Water in _____ Inch	3			Perf. top _____
Open flow after tubing _____ /10ths Merc. in _____ Inch	2			Perf. bottom _____
Volume _____ Cu. Ft.	Liners Used			Perf. top _____
Rock pressure _____ lbs. _____ hrs.				Perf. bottom _____
Oil _____ bbls., 1st 24 hrs.	CASING CEMENTED <u>10</u> SIZE _____ No. FT. _____ Date _____			
Fresh water _____ feet _____ feet	NAME OF SERVICE COMPANY _____			
Salt water <u>1470</u> feet _____ feet	COAL WAS ENCOUNTERED AT <u>533</u> FEET <u>72</u> INCHES			
	FEET _____ INCHES _____ FEET _____ INCHES			
	FEET _____ INCHES _____ FEET _____ INCHES			

Drillers' Names _____

CONT, JOHN MOSSOR

Remarks: _____

JOHN RAN 7" CASING 4 TIMES GETTING WATER SHUT OFF. DRG. 1805' - 7-24-72

BY LETTER

7-28-72

DATE

Arthur Mull

DISTRICT WELL INSPECTOR

STATE OF WEST VIRGINIA
 DEPARTMENT OF MINES
 OIL AND GAS WELLS DIVISION
INSPECTOR'S PLUGGING REPORT

Permit No. _____

Well No. _____

COMPANY _____ ADDRESS _____

FARM _____ DISTRICT _____ COUNTY _____

Filling Material Used _____

Liner	Location	Amount	Packer	Location		
PLUGS USED AND DEPTH PLACED			BRIDGES	CASING AND TUBING		
CEMENT-THICKNESS	WOOD-SIZE	LEAD	CONSTRUCTION-LOCATION	RECOVERED	SIZE	LOST

Drillers' Names _____

Remarks: _____

_____ I hereby certify I visited the above well on this date.
DATE

_____ DISTRICT WELL INSPECTOR

STATE OF WEST VIRGINIA
DEPARTMENT OF MINES
OIL AND GAS WELLS DIVISION

RECEIVED
AUG 7 1972

OIL & GAS DIVISION
DEPT. OF MINES

INSPECTOR'S WELL REPORT

Permit No. OHIO-22

Oil or Gas Well _____
(KIND)

Company <u>RANCO OIL AND G.</u>	CASING AND TUBING	USED IN DRILLING	LEFT IN WELL	PACKERS
	Address <u>BELPRE, OHIO</u>	Size		
Farm <u>M. MCCONN</u>	16			
Well No. <u>1</u>	13			
District <u>TRIADUPHIA</u> County <u>OHIO</u>	10	<u>573</u>	<u>CEMENT</u>	Size of _____
Drilling commenced <u>5-31-72</u>	8 1/4	<u>1211</u>		Depth set _____
Drilling completed _____ Total depth _____	6 5/8	<u>1705</u>		
Date shot _____ Depth of shot _____	5 3/16			Perf. top _____
Initial open flow _____ /10ths Water in _____ Inch	3			Perf. bottom _____
Open flow after tubing _____ /10ths Merc. in _____ Inch	2			Perf. top _____
Volume _____ Cu. Ft.	Liners Used			Perf. bottom _____
Rock pressure _____ lbs. _____ hrs.				
Oil _____ bbls., 1st 24 hrs.	CASING CEMENTED _____ SIZE _____ No. FT. _____ Date _____			
Fresh water <u>50</u> feet _____ feet	NAME OF SERVICE COMPANY _____			
Salt water <u>1470</u> feet <u>1827</u> feet	COAL WAS ENCOUNTERED AT <u>533</u> FEET <u>72</u> INCHES			
	_____ FEET _____ INCHES FEET _____ INCHES			
	_____ FEET _____ INCHES FEET _____ INCHES			

Drillers' Names _____

Remarks: CONT, JOHN MOSSOR

BY MAIL DRG' 2048-8-1-72

SECOND NOTE FROM JOHN SAYS SHOT DOWN FOR WIRE LINE AT 2365'

8-4-72

DATE

Arthur Pull
DISTRICT WELL INSPECTOR

STATE OF WEST VIRGINIA
DEPARTMENT OF MINES
OIL AND GAS WELLS DIVISION
INSPECTOR'S PLUGGING REPORT

Permit No. _____

Well No. _____

COMPANY _____ ADDRESS _____

FARM _____ DISTRICT _____ COUNTY _____

Filling Material Used _____

PLUGS USED AND DEPTH PLACED			BRIDGES	CASING AND TUBING		
Liner	Location	Amount	Packer	Location		
CEMENT-THICKNESS	WOOD-SIZE	LEAD	CONSTRUCTION-LOCATION	RECOVERED	SIZE	LOST

Drillers' Names _____

Remarks:

_____ I hereby certify I visited the above well on this date.

DATE

DISTRICT WELL INSPECTOR

STATE OF WEST VIRGINIA
DEPARTMENT OF MINES
OIL AND GAS WELLS DIVISION

RECEIVED

AUG 17 1972

OIL & GAS DIVISION
DEPT. OF MINES *SPUDDER*

INSPECTOR'S WELL REPORT

Permit No. D410-22

Oil or Gas Well _____
(KIND)

Company <u>RAMCO OIL AND GAS</u>	CASING AND TUBING	USED IN DRILLING	LEFT IN WELL	PACKERS
	Address <u>BEHPRE, D410</u>	Size		
Farm <u>M. MCCANN</u>	16			
Well No. <u>1</u>	13			
District <u>TRIADDELPHIA</u> County <u>D410</u>	10	<u>573</u>	<u>CEMENTED</u>	Size of _____
Drilling commenced <u>5-31-72</u>	8 1/4	<u>1211</u>		Depth set _____
Drilling completed _____ Total depth _____	6 5/8	<u>1705</u>		
Date shot _____ Depth of shot _____	5 3/16			Perf. top _____
Initial open flow _____ /10ths Water in _____ Inch	3			Perf. bottom _____
Open flow after tubing _____ /10ths Merc. in _____ Inch	2			Perf. top _____
Volume _____ Cu. Ft.	Liners Used			Perf. bottom _____
Rock pressure _____ lbs. _____ hrs.				
Oil _____ bbls., 1st 24 hrs.	CASING CEMENTED <u>10</u> SIZE _____ No. FT. _____ Date _____			
Fresh water <u>50</u> feet _____ feet	NAME OF SERVICE COMPANY _____			
Salt water <u>1645</u> feet <u>1827</u> feet	COAL WAS ENCOUNTERED AT _____ FEET _____ INCHES			
	_____ FEET _____ INCHES _____ FEET _____ INCHES			
	_____ FEET _____ INCHES _____ FEET _____ INCHES			

Drillers' Names _____

Remarks: CONT. JOHN MOSSER
BY MAIL - 8-11-72 - DRG. 2822

8-14-72
DATE

Arthur Null
DISTRICT WELL INSPECTOR

STATE OF WEST VIRGINIA
 DEPARTMENT OF MINES
 OIL AND GAS WELLS DIVISION
INSPECTOR'S PLUGGING REPORT

Permit No. _____ Well No. _____

COMPANY _____ ADDRESS _____

FARM _____ DISTRICT _____ COUNTY _____

Filling Material Used _____

Liner	Location	Amount	Packer	Location		
PLUGS USED AND DEPTH PLACED			BRIDGES	CASING AND TUBING		
CEMENT-THICKNESS	WOOD-SIZE	LEAD	CONSTRUCTION-LOCATION	RECOVERED	SIZE	LOST

Drillers' Names _____

Remarks: _____

_____ I hereby certify I visited the above well on this date.

DATE

 DISTRICT WELL INSPECTOR

STATE OF WEST VIRGINIA
DEPARTMENT OF MINES
OIL AND GAS WELLS DIVISION

RECEIVED

AUG 28 1972

OIL & GAS DIVISION
DEPT. OF MINES

INSPECTOR'S WELL REPORT

SPUDDER

Permit No. OHIO-22

Oil or Gas Well _____
(KIND)

Company	CASING AND TUBING	USED IN DRILLING	LEFT IN WELL	PACKERS
<u>RAMCO OIL AND GAS</u>	Size			Kind of Packer
<u>BELPRE, OHIO</u>	16			
<u>M. MCCOHN</u>	13			
<u>1</u>	10	<u>573</u>	<u>CEMENT</u>	Size of
<u>TRIADPHIA County OHIO</u>	8 1/4	<u>1211</u>		
<u>5-31-72</u>	6 5/8	<u>1705</u>		Depth set
	5 3/16			
	3			Perf. top
	2			Perf. bottom
	Liners Used			Perf. top
				Perf. bottom

CASING CEMENTED 10 SIZE _____ No. FT. _____ Date _____

NAME OF SERVICE COMPANY _____

COAL WAS ENCOUNTERED AT _____ FEET _____ INCHES

_____ FEET _____ INCHES _____ FEET _____ INCHES

_____ FEET _____ INCHES _____ FEET _____ INCHES

Drillers' Names _____

Remarks: CONT. JOHN MOSSER
SHOT DOWN AT 3220'
REPORT BY MAIL ENCLOSED.

8-24-72
DATE

Arthur Neill
DISTRICT WELL INSPECTOR

STATE OF WEST VIRGINIA
 DEPARTMENT OF MINES
 OIL AND GAS WELLS DIVISION
INSPECTOR'S PLUGGING REPORT

Permit No. _____

Well No. _____

COMPANY _____ ADDRESS _____

FARM _____ DISTRICT _____ COUNTY _____

Filling Material Used _____

Liner	Location	Amount	Packer	Location			
PLUGS USED AND DEPTH PLACED			BRIDGES		CASING AND TUBING		
CEMENT-THICKNESS	WOOD-SIZE	LEAD	CONSTRUCTION-LOCATION		RECOVERED	SIZE	LOST

Drillers' Names _____

Remarks: _____

_____ DATE I hereby certify I visited the above well on this date.

 DISTRICT WELL INSPECTOR



RECEIVED

SEP 5 1972

OIL & GAS DIVISION
DEPT. OF MINES

STATE OF WEST VIRGINIA
DEPARTMENT OF MINES
OIL AND GAS WELLS DIVISION

NOTICE OF INTENTION TO PLUG AND ABANDON WELL

(REQUIRED BY SECTION 9, ARTICLE 4, CHAPTER 22 OF THE CODE)

TO THE DEPARTMENT OF MINES,
Charleston, W. Va.

<u>Valley Camp Coal</u> Coal Operator	<u>RAMCO Oil & Gas Corp.</u> Name of Well Operator
<u>Valley Grove, West Virginia</u> Address	<u>P. O. Box 99, Belpre, Ohio 45714</u> Complete Address
<u>Valley Camp Coal</u> Coal Owner	<u>September 1, 1972</u> Date
<u>Valley Grove, West Virginia</u> Address	<u>WELL TO BE ABANDONED</u> <u>Tridelpia</u> District
<u>Merle McConn</u> Lease or Property Owner	<u>Ohio</u> County
<u>Dallas Pike, West Virginia</u> Address	Well No. <u>1</u> <u>M. McConn</u> Farm

Inspector Arthur Null, Box 296, Hundred, West Virginia 26575 Telephone 775-5611

TO BE NOTIFIED 24 HOURS IN ADVANCE OF PLUGGING OPERATIONS

Gentlemen:—

The undersigned well operator is about to abandon the above described well and will commence

the work of plugging and abandoning said well on the date inspector is notified (which date shall not be less than five days after the day on which this notice so mailed is received, or in due course should be received by the Department of Mines).

This notice is given you in order that your respective representatives may be present at the plugging and filling of said well. You are further notified that whether you are represented or not represented the undersigned will proceed on that date, or shortly thereafter, to plug and fill said well in the manner required by Section 10, Article 4, Chapter 22 of the Code and given in detail on the reverse side of this notice, in "Work Order."

This notice is being mailed by registered mail to each of you at the above addresses on the above date.

Very truly yours, RAMCO Oil & Gas Corp.

by: Karl Rudder
Well Operator

NOTE: Upon the abandonment of any well drilled prior to June 1, 1929, a plat prepared by a registered engineer, shall be filed with THREE COPIES OF APPLICATION, (OG-9) AND "WORK ORDER" AND TWO COPIES OF THE WELL RECORD, (OG-10). The map must show the district and county in which the tract of land is located, the name and acreage of same, the name or names of the owners and names of adjacent tracts and the location of the well to be abandoned, determined by survey with the courses and distances of such well from two permanent points or landmarks on said tract, in compliance with Rule 5 of the Rules and Regulations.

NOTE: In case plugging is not commenced within four months from the date of permit, same shall expire and be of no further force or effect.

NOTE: PERMIT IS NON TRANSFERABLE.

~~WELL BOND~~ BLANKET BOND

Ohio-22-P

Permit Number

AFFIDAVIT, FORM OG-8. MANNER WELL PLUGGED MUST BE SUBMITTED TO OBTAIN RELEASE OF WELL UNDER BOND.

ofc

PROPOSED MANNER OF PLUGGING AND FILLING WELL

(REQUIRED BY RULES AND REGULATIONS)

WEST VIRGINIA DEPARTMENT OF MINES
OIL AND GAS DIVISION
WORK ORDER

Well to be plugged and filled as follows:

Bridge 2325

Mud to 2255

Cement Plug 2255' - 2220'

Mud to ~~1807~~ 1750'

Cement Plug 1750' - 1700' Pull - 1705' of 7" Casing

Mud to 1450

Cement Plug 1450' - 1425'

Mud to ~~1280~~ 1220'

Cement Plug 1220' - 1180' Pull 1211' of 8 5/8" Casing

~~Cement Plug 1588~~

Mud to ~~Surface~~ 580'

Cement - 580' - 560' - - Mud 560' - 20'

Set Monument In Prescribed Manner Cement - 20' - surface

1705' of 7" casing & 1211' of 8 5/8" casing will be pulled from well during plugging

573' of 10" casing will be left in well as it is cemented to surface

To the Department of Mines
Coal Owner or Operator,
Lease or Property Owner.

IF PARTIAL PLUGGING
PLEASE SUBMIT REVISED WELL RECORD
WHEN WORK IS COMPLETED.

Gentlemen:

This "work order" is submitted for your approval and concurrence and unless notified of your disapproval or non-concurrence, the undersigned will proceed with the plugging and filling of said well in the above described manner on the date inspector is notified after permit is issued.

Very truly yours, RAMCO Oil & Gas Corp.

by: (Front of Copy)
Well Operator

No objections have been filed by the coal owner or coal operator, or any available adjacent lease or property owners or interposed by the Department of Mines to the manner herein described for the plugging and filling of the well above mentioned. Therefore, the same is hereby approved this

5th day of Sept., 1972.

DEPARTMENT OF MINES
Oil and Gas Division

By: Robert L. Todd

NOTE: This "work order" shall be filed in triplicate, one copy for the files of the Department of Mines; one to be approved or corrected and returned to the well operator as his authority for plugging said well; and one for the well inspector.

RECEIVED

SEP 28 1972

FORM OG-8

STATE OF WEST VIRGINIA
DEPARTMENT OF MINES
OIL AND GAS DIVISION

OIL & GAS DIVISION
DEPT. OF MINES

AFFIDAVIT OF PLUGGING AND FILLING WELL

AFFIDAVIT SHOULD BE MADE IN TRIPLICATE, ONE COPY MAILED TO THE DEPARTMENT, ONE COPY TO BE RETAINED BY THE WELL OPERATOR AND THE THIRD COPY (AND EXTRA COPIES IF REQUIRED) SHOULD BE MAILED TO EACH COAL OPERATOR AT THEIR RESPECTIVE ADDRESSES.

Valley Camp Coal
COAL OPERATOR OR OWNER
Valley Grove, West Virginia
ADDRESS
Valley Camp Coal
COAL OPERATOR OR OWNER
Valley Grove, West Virginia
ADDRESS
Merle McConn
LEASE OR PROPERTY OWNER
Dallas Pike, West Virginia
ADDRESS

RAMCO OIL & GAS CORP.
NAME OF WELL OPERATOR
P.O. BOX 99, Belpre, Ohio
COMPLETE ADDRESS
Sept. 23 19 72
WELL AND LOCATION
Tridelphia District
Ohio County
Well No. # 1
M. Mc conn Farm

STATE INSPECTOR SUPERVISING PLUGGING Arthur Null, Box 296, Hundred, W. Va. 26575

AFFIDAVIT

STATE OF WEST VIRGINIA,
County of WOOD } SS:

Lawson Oil and Gas Well Cementing Co., Inc.

being first duly sworn according to law depose and say that they are experienced in the work of plugging and filling oil and gas wells and were employed by Ramco Oil & Gas Corp., well operator, and participated in the work of plugging and filling the above well, that said work was commenced on the 20th day of Sept., 1972, and that the well was plugged and filled in the following manner:

SAND OR ZONE RECORD	FILLING MATERIAL		PLUGS USED	CASING	
				CSG PULLED	CSG LEFT IN
FORMATION	0'	To 20' Cement	20'	SIZE & KIND	
	20'	To 560' Gel			
	560'	To 580' Cement	20'		
	580'	To 1180' Gel			
	1180'	To 1220' Cement	60'		
	1220'	To 1425' Gel			
	1425'	To 1450' Cement	25'		
	1450'	To 1700' Gel			
	1700'	To 1750' Cement	50'		
	1750'	To 2220' Gel			
	2220'	To 2255' Cement	35'		
COAL SEAMS	DESCRIPTION OF MONUMENT				
(NAME)	10" casing filled with cement				
(NAME)					
(NAME)					
(NAME)					

and that the work of plugging and filling said well was completed on the 21st. day of Sept., 1972.

And further deponents saith not.

Karl Church
Ronnie Church
Gred G Ingram Jr
Notary Public.

Sworn to and subscribed before me this 25th day of September, 1972.

My commission expires:
MARCH 26 Th 1979

Permit No. Ohio 22-P C. NO. 11



State of West Virginia

Department of Mines

Oil and Gas Division

Charleston 25305

Ramco Oil & Gas Corporation
P. O. Box 99
Belpre, Ohio 45714

In Re: Permit No. OHIO-22-P
Farm M. McConn
Well No. 1
District Triadelphia
County Ohio

Gentlemen:

The final inspection report for the well which is described above has been received in this office. Only the column checked below applies.

 The bond covering the well designated by the above permit number has been released under your Blanket Bond.

~~XXXX~~ Please return the enclosed cancelled bond which covered the well designated by the above permit number to the Surety Company who executed said bond in your behalf, in order that they may give you credit on their records.

Very truly yours,

Deputy Director
Oil and Gas Division

RLD/cc

Enclosure: 1 Bond



RECEIVED
MAR 14 1985
OIL & GAS DIVISION
DEPT. OF MINES

State of West Virginia
Department of Mines
Oil and Gas Division
Charleston 25305
FINAL INSPECTION REPORT
INSPECTORS COMPLIANCE REPORT
July 27, 1984

COMPANY Ramco Oil & Gas Corp.
P. O. Box 2347
Hollywood, Florida 33022

PERMIT NO 069-0022-P
FARM & WELL NO M. McConn #1
DIST. & COUNTY Tridelphia/Ohio

RULE	DESCRIPTION	IN COMPLIANCE	
		Yes	No
23.06	Notification Prior to Starting Work	<input checked="" type="checkbox"/>	<input type="checkbox"/>
16.01	Required Permits at Wellsite	<input checked="" type="checkbox"/>	<input type="checkbox"/>
17.02	Method of Plugging	<input checked="" type="checkbox"/>	<input type="checkbox"/>
18.01	Materials used in Plugging	<input checked="" type="checkbox"/>	<input type="checkbox"/>
23.02	Maintained Access Roads	<input checked="" type="checkbox"/>	<input type="checkbox"/>
25.01	Necessary Equipment to Prevent Waste	<input checked="" type="checkbox"/>	<input type="checkbox"/>
23.04	Reclaimed Drilling Pits	<input checked="" type="checkbox"/>	<input type="checkbox"/>
23.05	No Surface or Underground Pollution	<input checked="" type="checkbox"/>	<input type="checkbox"/>
17.06	Statutory Affidavit	<input checked="" type="checkbox"/>	<input type="checkbox"/>
7.06	Parties Responsible	<input checked="" type="checkbox"/>	<input type="checkbox"/>
7.05	Identification Markings	<input checked="" type="checkbox"/>	<input type="checkbox"/>

I HAVE INSPECTED THE ABOVE CAPTIONED WELL AND RECOMMEND THAT IT BE RELEASED:

SIGNED R.A. Lowther

DATE Mar 12, 1985

Your Affidavit of Plugging was received and reclamation requirements approved. The well designated by the above permit number has been released under your bond.

T.H. B.B.
Administrator-Oil & Gas Division

March 14, 1985

DATE

McCONN

OHIO-22

MAY 31, 1972

18' Conductor	22' long
10' —	573'
8" —	1211'
7' —	1705'

1

36-L- MOSSOR

(11)

3220

AUG 18, 1972

3220. Shut down to determine if hole is any good.

Slote	2780	3185
Sand	3185	3218
Sand & Slote	3218	

RECEIVED

AUG 28 1972

OIL & GAS DIVISION
DEPT. OF MINES

STATE OF WEST VIRGINIA
DEPARTMENT OF MINES
OIL AND GAS WELLS DIVISION
INSPECTOR'S PLUGGING REPORT

RECEIVED
SEP 29 1972
OIL & GAS DIVISION
DEPT. OF MINES

Permit No. OH10-22-P Well No. 1

COMPANY RAMCO O. AND G. ADDRESS _____

FARM M. MCCOY DISTRICT T. BIRDBEATH COUNTY OHIO

Filling Material Used CEMENT, RAUAGEL

NONE Liner Location Amount Packer Location NONE

PLUGS USED AND DEPTH PLACED			BRIDGES	CASING AND TUBING		
CEMENT-THICKNESS	WOOD-SIZE	LEAD	CONSTRUCTION-LOCATION	RECOVERED	SIZE	LOST

Drillers' Names JOHN MOSEBR, CARL CHURCH (LAWSON CEMENTING)

Remarks: Well plugged from T.D. 3501 to 10'. plugging done except erection of monument.

9-26-72 I hereby certify I visited the above well on this date.
DATE

Arthur Null
DISTRICT WELL INSPECTOR

STATE OF WEST VIRGINIA
DEPARTMENT OF MINES
OIL AND GAS WELLS DIVISION

INSPECTOR'S WELL REPORT

Permit No. _____

Oil or Gas Well _____
(KIND)

	CASING AND TUBING	USED IN DRILLING	LEFT IN WELL	PACKERS
Company _____	Size			Kind of Packer _____
Address _____	16 _____			
Farm _____	13 _____			Size of _____
Well No. _____	10 _____			
District _____ County _____	8 1/4 _____			Depth set _____
Drilling commenced _____	6 5/8 _____			
Drilling completed _____ Total depth _____	5 3/16 _____			Perf. top _____
Date shot _____ Depth of shot _____	3 _____			
Initial open flow _____ /10ths Water in _____ Inch	2 _____			Perf. bottom _____
Open flow after tubing _____ /10ths Merc. in _____ Inch	Liners Used _____			Perf. top _____
Volume _____ Cu. Ft.				Perf. bottom _____
Rock pressure _____ lbs. _____ hrs.	CASING CEMENTED _____ SIZE _____ No. FT. _____ Date _____			
Oil _____ bbls., 1st 24 hrs.	NAME OF SERVICE COMPANY _____			
Fresh water _____ feet _____ feet	COAL WAS ENCOUNTERED AT _____ FEET _____ INCHES			
Salt water _____ feet _____ feet	_____ FEET _____ INCHES _____ FEET _____ INCHES			
	_____ FEET _____ INCHES _____ FEET _____ INCHES			

Drillers' Names _____

Remarks:

DATE

DISTRICT WELL INSPECTOR

4-18-72 Load

LATITUDE 40 ° 05 '

LONGITUDE 80 ° 30 '

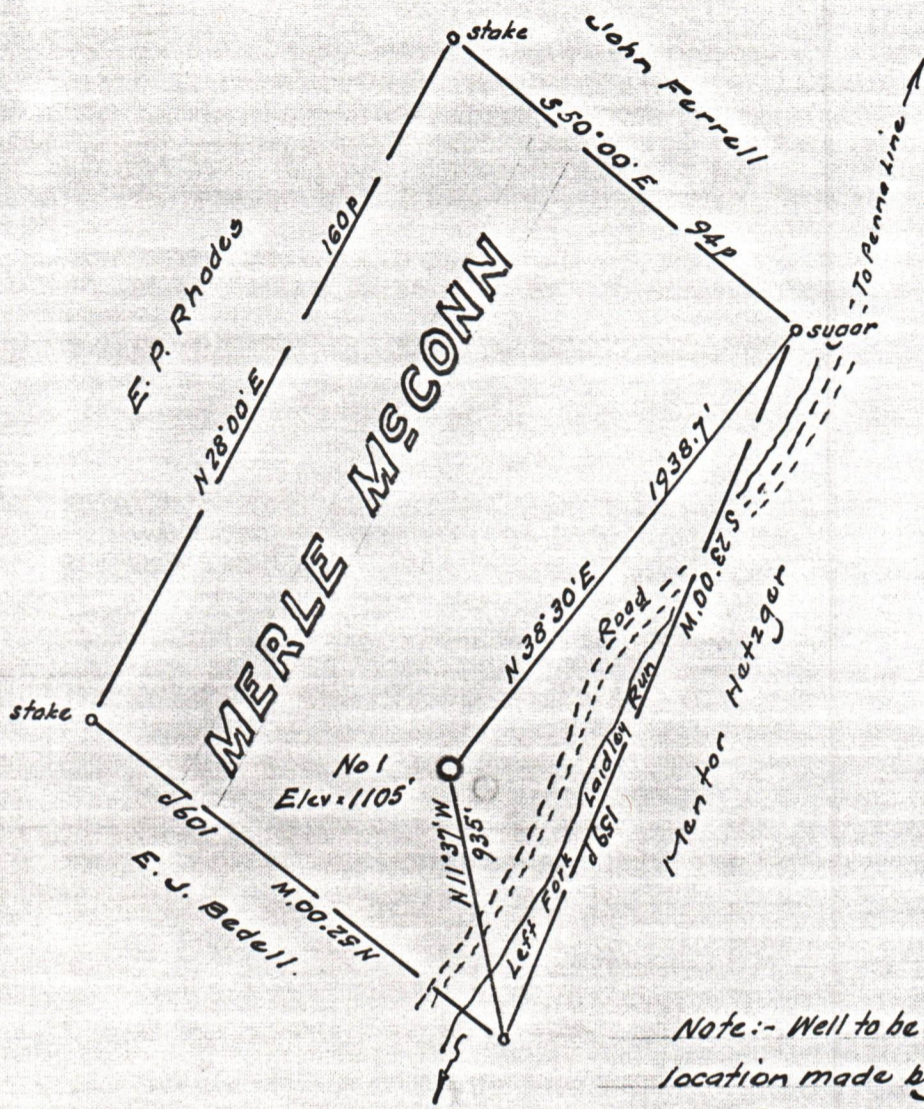

Note:- Well to be drilled on location made by Valley Camp Coal Company.

Minimum Error of Closure 1 in 2500'

Source of Elevation B.M. at Middle Creek School = 958'

- Fracture.....
- New Location.....
- Drill Deeper.....
- Abandonment.....

I, the undersigned, hereby certify that this map is correct to the best of my knowledge and belief and shows all the information required by paragraph 6 of the rules and regulations of the oil and gas section of the mining laws of West Virginia.

Signed: Walter J. [Signature]
Squares: N S E W

Map No. issued 9/5/72

Company RAMCO OIL & GAS CORP.
 Address P.O. Box 99, Belpre, Ohio
 Farm Merle McConn
 Tract _____ Acres 100± Lease No. _____
 Well (Farm) No. One Serial No. _____
 Elevation (Spirit Level) 1105
 Quadrangle Wheeling
 County Ohio District Tridelpia
 Engineer Walter J. [Signature]
 Engineer's Registration No. 1237
 File No. _____ Drawing No. _____
 Date April 17, 1972 Scale _____

STATE OF WEST VIRGINIA
DEPARTMENT OF MINES
OIL AND GAS DIVISION
CHARLESTON

WELL LOCATION MAP

FILE NO. OHIO - 22 - P

+ Denotes location of well on United States Topographic Maps, scale 1 to 62,500, latitude and longitude lines being represented by border lines as shown.

- Denotes one inch spaces on border line of original tracing.

STATE OF WEST VIRGINIA
DEPARTMENT OF MINES
OIL AND GAS WELLS DIVISION

RECEIVED

JAN 17 1974

INSPECTOR'S PLUGGING REPORT OIL & GAS DIVISION
DEPT. OF MINES

Permit No. Ohio-22-P

Well No. 1

COMPANY Ramco Oil & Gas Corp. ADDRESS P.O. Box 99 Belpre, Ohio
FARM Merle McCann DISTRICT Tridelfhia COUNTY Ohio

Filling Material Used _____

PLUGS USED AND DEPTH PLACED			BRIDGES	CASING AND TUBING		
CEMENT-THICKNESS	WOOD-SIZE	LEAD	CONSTRUCTION-LOCATION	RECOVERED	SIZE	LOST

Drillers' Names _____

Remarks: Final Inspection
Drilling material still on location
PITS NOT FILLED
NO IDENTIFICATION ON MARKER
Hold

1/14/1974 I hereby certify I visited the above well on this date.
DATE
Paul W. Garrett
DISTRICT WELL INSPECTOR

STATE OF WEST VIRGINIA
DEPARTMENT OF MINES
OIL AND GAS WELLS DIVISION

INSPECTOR'S WELL REPORT

Permit No. _____

Oil or Gas Well _____
(KIND)

Company _____ Address _____ Farm _____ Well No. _____ District _____ County _____ Drilling commenced _____ Drilling completed _____ Total depth _____ Date shot _____ Depth of shot _____ Initial open flow _____ /10ths Water in _____ Inch Open flow after tubing _____ /10ths Merc. in _____ Inch Volume _____ Cu. Ft. Rock pressure _____ lbs. _____ hrs. Oil _____ bbls., 1st 24 hrs. Fresh water _____ feet _____ feet Salt water _____ feet _____ feet	CASING AND TUBING	USED IN DRILLING	LEFT IN WELL	PACKERS
	Size _____ 16 _____ 13 _____ 10 _____ 8 1/4 _____ 6 5/8 _____ 5 3/16 _____ 3 _____ 2 _____ Liners Used _____			

CASING CEMENTED _____ SIZE _____ No. FT. _____ Date _____

NAME OF SERVICE COMPANY _____

COAL WAS ENCOUNTERED AT _____ FEET _____ INCHES

_____ FEET _____ INCHES _____ FEET _____ INCHES

_____ FEET _____ INCHES _____ FEET _____ INCHES

Drillers' Names _____

Remarks: _____

DATE

DISTRICT WELL INSPECTOR