

SURFACE HOLE DEC. LONG: 80.547778
SURVEYED LONG: 80° 32' 52.0" 1.710

Latitude: 40° 02' 30" (NAD 27)

Longitude: 80° 32' 30" (NAD 27)
SURFACE HOLE DEC. LAT: 40° 02' 26.5"
SURVEYED LAT: 40° 02' 26.5"

TH (NAD 83)	BOTTOM HOLE (NAD 83)
N) 562519.1 E) 1675196.0 LAT.) 40°02'22.9" LONG.) 80°32'51.3" DEC. LAT.) 40.039684 DEC. LONG.) 80.547570	N) 554654.3 E) 1678695.8 LAT.) 40°01'05.5" LONG.) 80°32'05.1" DEC. LAT.) 40.018206 DEC. LONG.) 80.534748
TH (NAD 27)	BOTTOM HOLE (NAD 27)
N) 562482.1 E) 1706630.3 LAT.) 40°02'22.6" LONG.) 80°32'52.0" DEC. LAT.) 40.039610 DEC. LONG.) 80.547778	N) 554817.3 E) 1710130.0 LAT.) 40°01'05.3" LONG.) 80°32'05.8" DEC. LAT.) 40.018132 DEC. LONG.) 80.534954

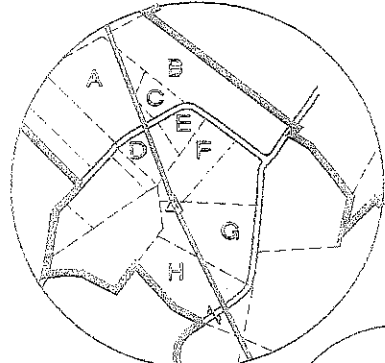
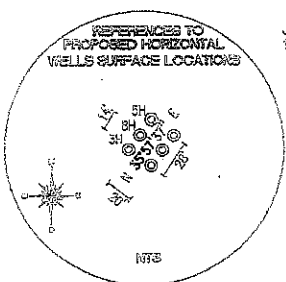

TOP HOLE (UTM 83)	BOTTOM HOLE (UTM 83)
N) 4432259.8 E) 538597.0	N) 4429881.6 E) 539703.3

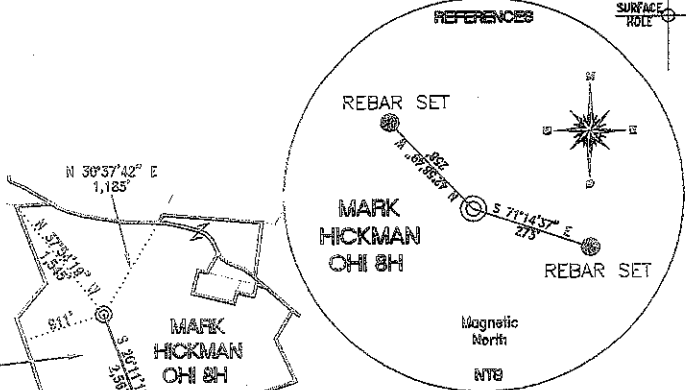
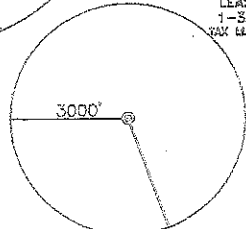

JOHN MARK HICKMAN
143.77 TOTAL ACRES
LEASE NUMBERS
1-345205-001
TAX MAP AND PARCEL
T14-38

PATRICK E. AND
LISA M. LEINWEBER
6.466 TOTAL ACRES
LEASE NUMBER
1-313811-000
TAX MAP AND PARCEL
T14-50

REFLECTION POINT (NAD 83)
N) 560113.4
E) 1676080.6
LAT.) 40°01'59.2"
LONG.) 80°32'39.5"
DEC. LAT.) 40.033108
DEC. LONG.) 80.544311

REFLECTION POINT (NAD 27)
N) 560076.4
E) 1707514.9
LAT.) 40°01'58.9"
LONG.) 80°32'40.3"
DEC. LAT.) 40.033034
DEC. LONG.) 80.544517

MARK & KATHLEEN A.
LICHWA
3.75 TOTAL ACRES
LEASE NUMBER
1-265438-000
TAX MAP AND PARCEL
T19-23

RONALD L. MCCORMICK
17.087 TOTAL ACRES
LEASE NUMBER
1-265438-000
TAX MAP AND PARCEL
T14-85

MARK AND
KATHLEEN A. LICHWA
4.242 TOTAL ACRES
LEASE NUMBER
1-265438-000
TAX MAP AND PARCEL
T19-8.2

MARK AND
KATHY LICHWA
19.642 TOTAL ACRES
LEASE NUMBER
1-265438-000
TAX MAP AND PARCEL
T19-8.1

HERBERT AND
ALICE M. SHARP
2.155 TOTAL ACRES
LEASE NUMBER
1-324177-000
TAX MAP AND PARCEL
T19-9.1

HERBERT & A M SHARP
101.555 TOTAL ACRES
LEASE NUMBER
1-324177-000
TAX MAP AND PARCEL
T19-9

MARJORIE S. GRIFFIN
34.45 TOTAL ACRES
LEASE NUMBER
1-272774-000
TAX MAP AND PARCEL
T20-3.2

VAUGHN AND
KATHY STRICKLIN
18.288 TOTAL ACRES
DEED BOOK / PAGE
489/424
TAX MAP AND PARCEL
T20-6.4

△ = INFLECTION POINT

REFERENCE NOTES
Boundaries as shown taken from deeds, tax maps and field locations. A full boundary survey is not expressed nor implied. All bearings are based on true north. Ownership taken from public records OHIO County, West Virginia OCTOBER 2011
State Plane Coordinates & NAD 83 Lat/Long by differential submeter mapping grade GPS
Drafted by: E.A.M.

	PROPERTY OWNER	ACRES	LEASE NUMBER	PARCEL ID
A	MICHAEL J. FYNMORE	4.72	47-000368-000	T14-53
B	LONNIE & THEDA CHURCH	4.776	1-314057-000	T14-41.1
C	DALE J. PERSONS	1.00	47-000456-000	T14-53.1
D	ROBERT E. TRAVIS JR.	1.55	47-000684-000	T14-57
E	RONALD J. & ROBERTA P. DILORENZO	1.00	1-329171-000	T14-57.1
F	DANIEL R. & REBECCA L. OLIVER	2.368	47-000361-000	T14-41.5
G	PATRICK L. RIDDLE	5.00	1-314065-000	T19-20
H	MICHAEL A. & CYNTHIA K. ROBBINS	5.00	1-314032-000	T19-18

FILE #: CHE 053
DRAWING #: 1844
SCALE: 1"=2000'
MINIMUM DEGREE OF ACCURACY: 1/200
PROVEN SOURCE SUBMETER MAPPING OF ELEVATION: GRADE GPS

I, THE UNDERSIGNED, HEREBY CERTIFY THAT THIS PLAT IS CORRECT TO THE BEST OF MY KNOWLEDGE AND BELIEF AND SHOWS ALL THE INFORMATION REQUIRED BY LAW AND THE REGULATIONS ISSUED AND PRESCRIBED BY THE DEPARTMENT OF ENVIRONMENTAL PROTECTION.
Signed: _____
L.L.S. #2124; Ernest J. Benchek III

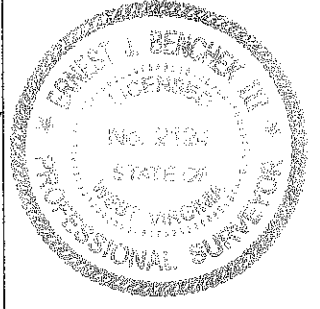

(+) DENOTES LOCATION OF WELL ON UNITED STATES TOPOGRAPHIC MAPS WVDEP
OFFICE OF OIL & GAS
601 57TH STREET
CHARLESTON, WV 25304

Well Type: Oil Waste Diposal Production Deep
 Gas Liquid Injection Storage Shallow

WATERSHED: UPPER OHIO SOUTH ELEVATION: 1,285'

COUNTY/DISTRICT: OHIO/TRIADDELPHIA QUADRANGLE: VALLEY GROVE WV.

SURFACE OWNER: L.G. HICKMAN AND JOHN MARK HICKMAN ACREAGE: 143.77 +/-

OIL & GAS ROYALTY OWNER: L.G. HICKMAN AND JOHN MARK HICKMAN ACREAGE: 350.947 +/-

LEASE NUMBERS: _____

DRILL CONVERT DRILL DEEPER REDRILL FRACTURE OR STIMULATE
PLUG OFF FORMATION PERFORATE NEW FORMATION PLUG & ABANDON
CLEAN OUT & REPLUG OTHER CHANGE (SPECIFY): _____

TARGET FORMATION: MARCELLUS ESTIMATED DEPTH: TVD: 6,685' TMD: 15,097'

WELL OPERATOR: CHESAPEAKE APPALACHIA, LLC. DESIGNATED AGENT: ERIC B. GILLESPIE
ADDRESS: PO BOX 18496 ADDRESS: Po Box 6070

CITY: OKLAHOMA CITY STATE: OK ZIP CODE: 73154-0496 CITY: CHARLESTON STATE: WV ZIP CODE: 25301

03/09/2012

609-001094

