

TOP HOLE (UTM 83)
 N) 4442626.7
 E) 532978.4
BOTTOM HOLE (UTM 83)
 N) 4441453.0
 E) 533782.2

REFERENCE LINES
 S 88°31'43" E 1240'

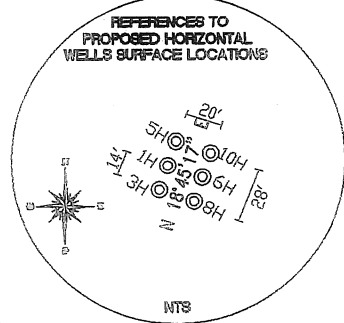

TOP HOLE (NAD 83)
 N) 596847.5
 E) 1657328.1
 LAT.) 40°08'00.0"
 LONG.) 80°36'46.4"
 DEC. LAT.) 40.133323
 DEC. LONG.) 80.612900

TOP HOLE (NAD 27)
 N) 596810.6
 E) 1688762.9
 LAT.) 40°07'59.7"
 LONG.) 80°36'47.2"
 DEC. LAT.) 40.133251
 DEC. LONG.) 80.613102

KOP (NAD 83)
 N) 597288.3
 E) 1658404.1
 LAT.) 40°08'04.4"
 LONG.) 80°36'32.7"
 DEC. LAT.) 40.134569
 DEC. LONG.) 80.609071

KOP (NAD 27)
 N) 597251.3
 E) 1689838.9
 LAT.) 40°08'04.2"
 LONG.) 80°36'33.4"
 DEC. LAT.) 40.134497
 DEC. LONG.) 80.609274

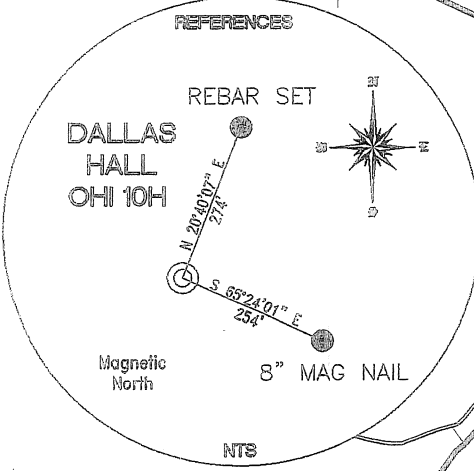

TP (NAD 83)
 N) 596815.6
 E) 1658567.3
 LAT.) 40°07'59.8"
 LONG.) 80°36'50.5"
 DEC. LAT.) 40.133278
 DEC. LONG.) 80.608467

BOTTOM HOLE (NAD 83)
 N) 592951.7
 E) 1659901.2
 LAT.) 40°07'21.8"
 LONG.) 80°36'12.7"
 DEC. LAT.) 40.122716
 DEC. LONG.) 80.603527

TP (NAD 27)
 N) 596778.7
 E) 1690002.1
 LAT.) 40°07'59.5"
 LONG.) 80°36'31.2"
 DEC. LAT.) 40.133205
 DEC. LONG.) 80.608670

BOTTOM HOLE (NAD 27)
 N) 592914.8
 E) 1691336.0
 LAT.) 40°07'21.5"
 LONG.) 80°36'13.4"
 DEC. LAT.) 40.122644
 DEC. LONG.) 80.603730

REFERENCE NOTES
 Boundaries as shown taken from deeds, tax maps and field locations. A full boundary survey is not expressed nor implied. All bearings are based on true north. Ownership taken from public records Ohio County, West Virginia DECEMBER 2010
 State Plane Coordinates & NAD 83 Lat/Long by differential submeter mapping grade GPS
 Drafted by: E.A.M.

FILE #: CHE 043
 DRAWING #: 1547
 SCALE: 1"=1200'
 MINIMUM DEGREE OF ACCURACY: 1/200
 PROVEN SOURCE SUBMETER MAPPING OF ELEVATION: GRADE GPS

I, THE UNDERSIGNED, HEREBY CERTIFY THAT THIS PLAT IS CORRECT TO THE BEST OF MY KNOWLEDGE AND BELIEF AND SHOWS ALL THE INFORMATION REQUIRED BY LAW AND THE REGULATIONS ISSUED AND PRESCRIBED BY THE DEPARTMENT OF ENVIRONMENTAL PROTECTION.

Signed:

L.L.S. #2124 : Ernest J. Benchek III

DATE: DECEMBER 01, 2011
 OPERATOR'S WELL #: DALLAS HALL OHI 10H
 API WELL #: 47 69 00116H10A
 STATE COUNTY PERMIT

(+) DENOTES LOCATION OF WELL ON UNITED STATES TOPOGRAPHIC MAPS
 WVDEP
 OFFICE OF OIL & GAS
 601 57TH STREET
 CHARLESTON, WV 25304

Well Type: Oil Waste Diposal Production Deep
 Gas Liquid Injection Storage Shallow

WATERSHED: UPPER OHIO SOUTH ELEVATION: 1,270'
 COUNTY/DISTRICT: OHIO/LIBERTY QUADRANGLE: BETHANY WV.
 SURFACE OWNER: DALLAS J. AND AGNES L. HALL ACREAGE: 162.58 +/-
 OIL & GAS ROYALTY OWNER: DALLAS J. AND AGNES L. HALL ACREAGE: 398.36 +/-
 LEASE NUMBERS: _____

DRILL CONVERT DRILL DEEPER REDRILL FRACTURE OR STIMULATE
 PLUG OFF FORMATION PERFORATE NEW FORMATION PLUG & ABANDON
 CLEAN OUT & REPLUG OTHER CHANGE (SPECIFY): _____

TARGET FORMATION: MARCELLUS ESTIMATED DEPTH: TVD: 6,150' TMD: 10,688'
 WELL OPERATOR: CHESAPEAKE APPALACHIA, LLC. DESIGNATED AGENT: ERIC B. GILLESPIE
 ADDRESS: PO BOX 18496 ADDRESS: PO Box 6070
 CITY: OKLAHOMA CITY STATE: OK ZIP CODE: 73154-0496 CITY: CHARLESTON STATE: WV ZIP CODE: 25301

69-00114

WELL: DALLAS HALL OHI 10H
QUAD: BETHANY WV.

