

SURFACE HOLE DEC. LONG: 80.625233
 SURVEYED LONG: 80° 37' 30.8" 80'
 Latitude: 40° 05' 00"

TOP HOLE (UTM 83)
 N) 4435804.1
 E) 531956.5
 BOTTOM HOLE (UTM 83)
 N) 4434787.4
 E) 532622.7

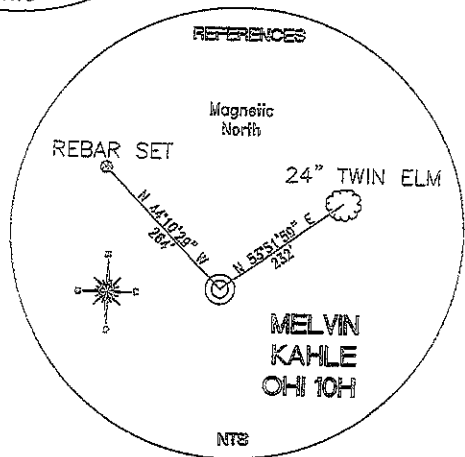
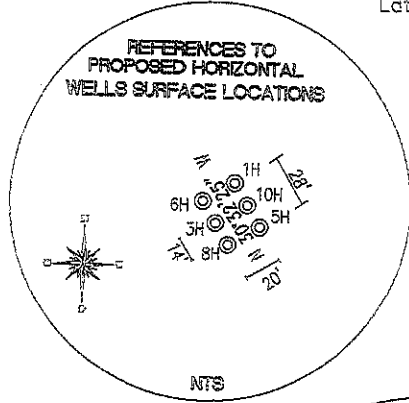

MELVIN W AND
 CAROL M KAHLE
 84.99 TOTAL ACRES
 LEASE NUMBER
 1-524664-000
 TAX MAP AND PARCEL
 T7-170

MARY A DICKEY
 99.95 TOTAL ACRES
 LEASE NUMBER
 1-268375-000
 TAX MAP AND PARCEL
 T7-171

REFERENCE LINES
 RL #1
 S 80°05'20" E 923'

REFERENCE NOTES
 Boundaries as shown taken from deeds, tax maps and field locations. A full boundary survey is not expressed nor implied. All bearings are based on true north. Ownership taken from public records Ohio County, West Virginia NOVEMBER 2011 State Plane Coordinates & NAD 83 Lat/Long by differential submeter mapping grade GPS Drafted by: E.A.M.

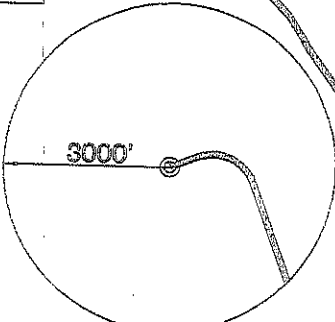

TOP HOLE (NAD 83) N) 574514.7 E) 1653599.7 LAT.) 40°04'18.8" LONG.) 80°37'30.8" DEC. LAT.) 40.071894 DEC. LONG.) 80.625233	KOP (NAD 83) N) 574823.2 E) 1654331.6 LAT.) 40°04'22.0" LONG.) 80°37'21.5" DEC. LAT.) 40.072766 DEC. LONG.) 80.622631
TOP HOLE (NAD 27) N) 574477.9 E) 1685034.7 LAT.) 40°04'18.6" LONG.) 80°37'31.6" DEC. LAT.) 40.071821 DEC. LONG.) 80.625434	KOP (NAD 27) N) 574786.4 E) 1685766.6 LAT.) 40°04'21.7" LONG.) 80°37'22.2" DEC. LAT.) 40.072693 DEC. LONG.) 80.622633
TP (NAD 83) N) 574355.8 E) 1654509.2 LAT.) 40°04'17.4" LONG.) 80°37'19.1" DEC. LAT.) 40.071489 DEC. LONG.) 80.621976	BOTTOM HOLE (NAD 83) N) 571141.7 E) 1655730.1 LAT.) 40°03'45.7" LONG.) 80°37'02.9" DEC. LAT.) 40.062708 DEC. LONG.) 80.617471
TP (NAD 27) N) 574319.0 E) 1685944.1 LAT.) 40°04'17.1" LONG.) 80°37'19.8" DEC. LAT.) 40.071416 DEC. LONG.) 80.622178	BOTTOM HOLE (NAD 27) N) 571104.8 E) 1687165.0 LAT.) 40°03'45.5" LONG.) 80°37'03.6" DEC. LAT.) 40.062635 DEC. LONG.) 80.617673

I, THE UNDERSIGNED, HEREBY CERTIFY THAT THIS PLAT IS CORRECT TO THE BEST OF MY KNOWLEDGE AND BELIEF AND SHOWS ALL THE INFORMATION REQUIRED BY LAW AND THE REGULATIONS ISSUED AND PRESCRIBED BY THE DEPARTMENT OF ENVIRONMENTAL PROTECTION.

Signed:
 L.L.S. #2124 : Ernest J. Benchek III

FILE #: CHE 035
 DRAWING #: 1926
 SCALE: 1"=1000'
 MINIMUM DEGREE OF ACCURACY: 1/200
 PROVEN SOURCE OF ELEVATION: SUBMETER MAPPING GRADE GPS

(+) DENOTES LOCATION OF WELL ON UNITED STATES TOPOGRAPHIC MAPS WVDEP
 OFFICE OF OIL & GAS
 601 57TH STREET
 CHARLESTON, WV 25304

Well Type: Oil Waste Diposal Production Deep Gas Liquid injection Storage Shallow

WATERSHED: UPPER OHIO SOUTH ELEVATION : 1,280'

COUNTY/DISTRICT: OHIO/TRIADELPHIA QUADRANGLE: WHEELING WV.

SURFACE OWNER: MELVIN W AND CAROL M KAHLE ACREAGE: 84.99 +/-

OIL & GAS ROYALTY OWNER: MELVIN W AND CAROL M KAHLE ACREAGE: 184.94 +/-

LEASE NUMBERS:

DRILL: CONVERT DRILL DEEPER REDRILL FRACTURE OR STIMULATE PLUG OFF FORMATION PERFORATE NEW FORMATION PLUG & ABANDON CLEAN OUT & REPLUG OTHER CHANGE (SPECIFY):

TARGET FORMATION: MARCELLUS ESTIMATED DEPTH: TVD: 6,265' TMD: 10,056'

WELL OPERATOR : CHESAPEAKE APPALACHIA, LLC. DESIGNATED AGENT : ERIC B. GILLESPIE

ADDRESS: PO BOX 18496 ADDRESS: Po Box 6070

CITY: OKLAHOMA CITY STATE: OK ZIP CODE: 73154-0496 CITY: CHARLESTON STATE: WV ZIP CODE: 25301

DATE: DECEMBER 09, 2011
 OPERATOR'S WELL #: MELVIN KAHLE OHI 10H
 API WELL #: 47 69 00122H6A
 STATE COUNTY PERMIT

