

- ① KEVIN T. WOODFORD  
TM RS PAR 47  
15.59 ACRES  
829/80
- ② PAUL K. YOUNG  
TM RS PAR 48  
6.8 ACRES  
830/506
- ③ PAUL A. RUTTER  
TM RS PAR 45.14  
1.446 ACRES
- ④ TUNNEL RIDGE LLC  
TM RS PAR 45.8  
5.014 ACRES
- ⑤ EDWARD A. SMITH  
TM RS PAR 45.7  
1.548 ACRES  
830/514
- ⑥ EDWARD A. SMITH  
TM RS PAR 45.16  
0.214 ACRES  
830/514
- ⑦ CARL TIMPSON  
TM RS PAR 45.18  
0.244 ACRES
- ⑧ ROBERT KISH  
TM RS PAR 45.15  
1.082 ACRES  
832/552
- ⑨ MARION S. PAVLIC  
TM RS PAR 45  
0.975 ACRES
- ⑩ DEBRA L. GARRISON  
TM RS PAR 45.5  
0.836 ACRES  
832/363
- ⑪ JOHN W. METZ  
TM RS PAR 45.3  
0.969 ACRES  
814/390
- ⑫ JOHN W. METZ  
TM RS PAR 45.2  
1.588 ACRES  
814/390
- ⑬ ROBERTA M. CORNER  
TM RS PAR 45.12  
2.226 ACRES  
1-328109-000  
813/542
- ⑭ ADRIANNA HLEBICZKI  
TM RS PAR 45.4  
2.836 ACRES  
1-329263-000  
813/554
- ⑮ ADRIANNA HLEBICZKI  
TM RS PAR 45.13  
3.662 ACRES  
1-329261-000  
813/548
- ⑯ HELEN TAYLOR  
TM RS PAR 12  
2.62 ACRES
- ⑰ HUMPHREY D. FLICK JR.  
TM RS PAR 15  
1.64 ACRES
- ⑱ DALE A. MILLANI  
TM RS PAR 16  
1.63 ACRES
- ⑲ ROBERT N. CONNER  
TM RS PAR 17  
7.162 ACRES
- ⑳ JAMES A. MATHEWS  
TM RS PAR 18  
1.87 ACRES
- ㉑ JAMES A. MATHEWS  
TM RS PAR 18.1  
0.829 ACRES
- ㉒ ERVAN D. TRUBIANO  
TM RS PAR 19  
1.01 ACRES  
813/534
- ㉓ BRIAN W. SOWZRAL  
TM RS PAR 20.1  
5.683 ACRES  
810/135
- ㉔ VELMA L. TACCART  
TM RS PAR 20  
2.341 ACRES  
813/538
- ㉕ RYAN E. SPARKS  
TM RS PAR 20.2  
0.459 ACRES
- ㉖ HAROLD COAST  
TM RS PAR 2.9  
10.94 ACRES  
829/783

REFERENCES LINES	
RL #1	S74°51'16"W 2036.86'
RL #2	S61°03'45"W 2097.33'

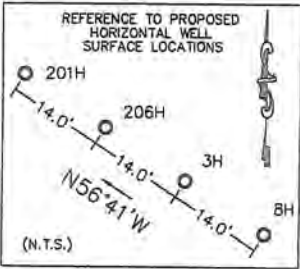

REFERENCES



- NOTES:
1. TIES TO WELLS AND CORNERS ARE BASED ON GRID NORTH FOR THE WEST VIRGINIA STATE PLANE COORDINATE SYSTEM, NORTH ZONE NAD 27.
  2. WELL LOCATION REFERENCES ARE BASED ON MAGNETIC MERIDIAN.
  3. BOUNDARIES SHOWN HEREON DERIVED FROM DEEDS, TAX MAPS AND FIELD LOCATION AND ARE NOT INTENDED TO INFER A FULL BOUNDARY SURVEY.
  4. SURFACE OWNERSHIP INFORMATION TAKEN FROM THE ASSESSOR AND COUNTY CLERK RECORDS OF OHIO & BROOKE COUNTIES IN JUNE 2011 THROUGH JANUARY 2012.
  5. WELL COORDINATES ESTABLISHED BY SUBFOOT GPS UNIT.

(+) DENOTES LOCATION OF WELL ON UNITED STATES TOPOGRAPHIC MAPS

FILE NO. 11-0167-762  
 DRAWING NO. 206H  
 SCALE 1" = 2000'  
 MINIMUM DEGREE OF ACCURACY 1 IN 2500  
 PROVEN SOURCE OF ELEVATION GPS  
SUBFOOT UNIT

I THE UNDERSIGNED, HEREBY CERTIFY THAT THIS PLAT IS CORRECT TO THE BEST OF MY KNOWLEDGE AND BELIEF AND SHOWS ALL THE INFORMATION REQUIRED BY LAW AND THE REGULATIONS ISSUED AND PRESCRIBED BY THE DEPARTMENT OF ENVIRONMENTAL PROTECTION.  
 (SIGNED) \_\_\_\_\_  
 R.P.E. \_\_\_\_\_ P.S. \_\_\_\_\_



STATE OF WEST VIRGINIA  
 DEPARTMENT OF ENVIRONMENTAL PROTECTION  
 OIL AND GAS DIVISION

DATE FEBRUARY 10, 2012  
 OPERATOR'S WELL NO. SEW TRUST OHI 206H  
 API WELL NO. 47-069-00140 H6A

WELL TYPE: OIL GAS X LIQUID INJECTION WASTE DISPOSAL  
 (IF "GAS,") PRODUCTION STORAGE DEEP SHALLOW X

LOCATION: ELEVATION 1137.5' WATERSHED SHORT CREEK  
 DISTRICT RICHLAND COUNTY OHIO  
 QUADRANGLE TILTONVILLE

SURFACE OWNER S.E.W. TRUST ACREAGE 220.947 +/-  
 OIL & GAS ROYALTY OWNER S.E.W. TRUST, ET AL LEASE ACREAGE 294 +/-  
 LEASE NO. \_\_\_\_\_

PROPOSED WORK: DRILL X CONVERT DRILL DEEPER REDRILL FRACTURE OR STIMULATE X PLUG OFF OLD FORMATION PERFORATE NEW FORMATION OTHER PHYSICAL CHANGE IN WELL (SPECIFY) \_\_\_\_\_

PLUG AND ABANDON CLEAN OUT AND REPLUG

TARGET FORMATION MARCELLUS ESTIMATED DEPTH TVD: 5,800' TMD: 10,999'  
 WELLOPERATOR CHESAPEAKE APPALACHIA, LLC DESIGNATED AGENT ERIC GILLESPIE  
 ADDRESS PO BOX 18496, OKLAHOMA CITY, OK 73154-0496 ADDRESS PO BOX 6070, CHARLESTON, WV 25301

COUNTY NAME PERMIT

