

TOP HOLE (UTM 88)
N) 4438947.6
E) 537467.7
BOTTOM HOLE (UTM 88)
N) 4440020.7
E) 537081.0

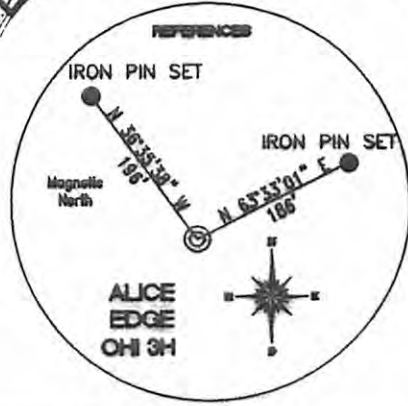

REFERENCE NOTES
 Boundaries as shown taken from deeds, tax maps and field locations. A full boundary survey is not expressed nor implied. All bearings are based on true north. Ownership taken from public records Ohio County, West Virginia DECEMBER 2011 State Plane Coordinates & NAD 83 Lat/Long by differential submeter mapping grade GPS Drafted by: E.A.M.

TOP HOLE (NAD 88) N) 584527.4 E) 1671857.6 LAT.) 40°06'00.0" LONG.) 80°33'37.5" DEC. LAT.) 40.099988 DEC. LONG.) 80.560420	BOTTOM HOLE (NAD 88) N) 588070.1 E) 1670647.8 LAT.) 40°06'34.8" LONG.) 80°33'53.6" DEC. LAT.) 40.109673 DEC. LONG.) 80.564895
TOP HOLE (NAD 27) N) 584490.4 E) 1703292.0 LAT.) 40°05'59.7" LONG.) 80°33'38.3" DEC. LAT.) 40.099915 DEC. LONG.) 80.560625	BOTTOM HOLE (NAD 27) N) 588033.0 E) 1702082.2 LAT.) 40°06'34.6" LONG.) 80°33'54.4" DEC. LAT.) 40.109600 DEC. LONG.) 80.565100

FILE #: CHE 036
 DRAWING #: 1652
 SCALE: 1"=1200'
 MINIMUM DEGREE OF ACCURACY: 1/200
 PROVEN SOURCE SUBMETER MAPPING OF ELEVATION: GRADE GPS

I, THE UNDERSIGNED, HEREBY CERTIFY THAT THIS PLAT IS CORRECT TO THE BEST OF MY KNOWLEDGE AND BELIEF AND SHOWS ALL THE INFORMATION REQUIRED BY LAW AND THE REGULATIONS ISSUED AND PRESCRIBED BY THE DEPARTMENT OF ENVIRONMENTAL PROTECTION.
 Signed:
 L.L.S. #2124 : Ernest J. Benchek III

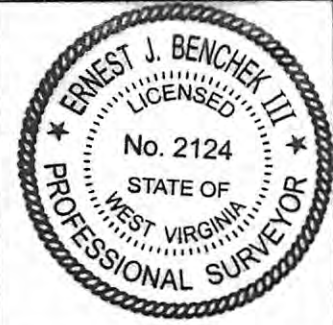

(+) DENOTES LOCATION OF WELL ON UNITED STATES TOPOGRAPHIC MAPS
WVDEP OFFICE OF OIL & GAS
 601 57TH STREET
 CHARLESTON, WV 25304

Well Type: Oil Waste Diposal Production Deep
 Gas Liquid Injection Storage Shallow

WATERSHED: UPPER OHIO SOUTH ELEVATION : 1,220'
 COUNTY/DISTRICT: OHIO/LIBERTY QUADRANGLE: VALLEY GROVE WV.
 SURFACE OWNER: ALICE MAE EDGE ACREAGE: 103 +/-
 OIL & GAS ROYALTY OWNER: ALICE MAE EDGE ACREAGE: 286.84 +/-
 LEASE NUMBERS: _____

DRILL CONVERT DRILL DEEPER REDRILL FRACTURE OR STIMULATE
 PLUG OFF FORMATION PERFORATE NEW FORMATION PLUG & ABANDON
 CLEAN OUT & REPLUG OTHER CHANGE (SPECIFY): _____

TARGET FORMATION: MARCELLUS ESTIMATED DEPTH: TVD: 6,410' TMD: 9,949'
 WELL OPERATOR : CHESAPEAKE APPALACHIA, LLC. DESIGNATED AGENT : ERIC B. GILLESPIE
 ADDRESS: PO BOX 18496 ADDRESS: PO BOX 6070
 CITY: OKLAHOMA CITY STATE: OK ZIP CODE: 73154-0496 CITY: CHARLESTON STATE: WV ZIP CODE: 25304

DATE: APRIL 10, 2012
 OPERATOR'S WELL #: ALICE EDGE OHI 3H
 API WELL #: 47 69 00144.H6A
 STATE COUNTY PERMIT
CANCELLED

09/05/2014