

Longitude: 80° 37' 30" (NAD 27)

SURFACE HOLE DEC. LAT: 40.100817
SURVEYED LAT: 40° 06' 02.9"

REFERENCE LINES

RL #1
S 56°19'44" W 1,170'

TH (NAD 83) N) 585094.2 E) 1652320.2 LAT.) 40°06'03.2" LONG.) 80°37'49.0" DEC. LAT.) 40.100890 DEC. LONG.) 80.630280	TP (NAD 83) N) 584445.4 E) 1651346.2 LAT.) 40°05'56.7" LONG.) 80°38'01.4" DEC. LAT.) 40.099075 DEC. LONG.) 80.633732
TH (NAD 27) N) 585057.4 E) 1683755.1 LAT.) 40°06'02.9" LONG.) 80°37'49.7" DEC. LAT.) 40.100817 DEC. LONG.) 80.630481	TP (NAD 27) N) 584408.5 E) 1682781.2 LAT.) 40°05'56.4" LONG.) 80°38'02.2" DEC. LAT.) 40.099002 DEC. LONG.) 80.633933
KOP (NAD 83) N) 584901.3 E) 1651141.0 LAT.) 40°06'01.2" LONG.) 80°38'04.1" DEC. LAT.) 40.100320 DEC. LONG.) 80.634486	BOTTOM HOLE (NAD 83) N) 579533.3 E) 1653557.1 LAT.) 40°05'08.4" LONG.) 80°37'32.2" DEC. LAT.) 40.085668 DEC. LONG.) 80.625609
KOP (NAD 27) N) 584864.5 E) 1682576.0 LAT.) 40°06'00.9" LONG.) 80°38'04.9" DEC. LAT.) 40.100247 DEC. LONG.) 80.634687	BOTTOM HOLE (NAD 27) N) 579496.4 E) 1684992.0 LAT.) 40°05'08.1" LONG.) 80°37'32.9" DEC. LAT.) 40.085595 DEC. LONG.) 80.625811

TOP HOLE (UTM 83) N) 4439020.6 E) 531512.7	BOTTOM HOLE (UTM 83) N) 4437332.8 E) 531917.9
---	--

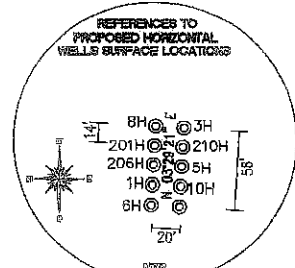

CHRISTOPHER J. NORMAN
1.21 TOTAL ACRES
LEASE NUMBER
1-325825-000
TAX MAP AND PARCEL
R15-16.25

EDWARD AND JUDITH NICHOLS
240.06 ACRES
LEASE NUMBER
1-324679-000
PARCEL ID
R15-16

EDWARD NICHOLS
CR-1 6H

BRIAN R. MENQUE
1.262 TOTAL ACRES
LEASE NUMBER
1-313894-000
TAX MAP AND PARCEL
R15-16.25

TOMMY JACOB TYLER
17.05 TOTAL ACRES
LEASE NUMBER
1-308354-000
TAX MAP AND PARCEL
R18-12

WILSON B. AND H J MILLER
125.44 ACRES
LEASE NUMBER
1-289148-000
PARCEL ID
R18-11

ROBERT HOFFMAN
41.7 TOTAL ACRES
LEASE NUMBER
1-324172-000
TAX MAP AND PARCEL
R18-27

ERIC P. WEISENBORN
10.0 TOTAL ACRES
LEASE NUMBER
1-325533-000
TAX MAP AND PARCEL
R18-27.5

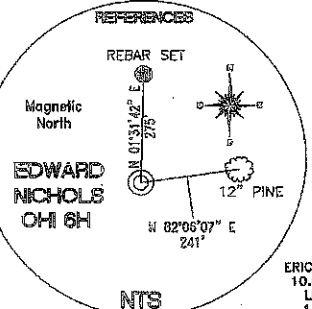
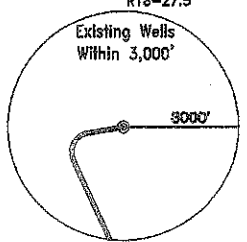

REFERENCE NOTES
Boundaries as shown taken from deeds, tax maps and field locations. A full boundary survey is not expressed nor implied. All bearings are based on true north. Ownership taken from public records OHIO County, West Virginia DECEMBER 2011
State Plane Coordinates & NAD 83 Lat/Long by differential submeter mapping grade GPS
Drafted by: E.A.M.

PROPERTY OWNER	ACRES	LEASE NUMBER	PARCEL ID
A - LARRY AND PATRICIA TRANK	.55	1-325873-000	R15-11.1
B - LARRY AND PATRICIA TRANK	.35	1-325872-000	R15-11
C - DAVID AND KIMBERLY HARMON	.94		R15-12
D - CARRIE ANDERSON EDWARDS	.55	1-325850-000	R15-09
E - CHARLES AND MOLLIE ANDERSON	1.761	1-325827-000	R15-07
F - GINA LYNN JONES MILLER	.178	47-001126-000	R15-08
G - DOUGLAS AND WILLA KNOLLINGER	2.58	1-325772-000	R15-05
H - ELLSWORTH AND B.J. RICHMOND	2.98	1-329092-000	R15-02
I - HARRY E. AND VIRGINIA CASTLE	.58	1-329108-000	R15-03
K - ROBERT AND MELINDA KREISBERG	2.32	47-000300-000	R15-01
L - ELLSWORTH AND B.J. CASTLE	.517	1-329089-000	R18-06
M - ELLSWORTH AND B.J. CASTLE	.67	1-329088-000	R18-06.1
N - EDWARD AND G.E. LONG	.712	1-325775-000	R18-05
O - FREDRICK AND JANET JAQUAY	3.85	1-302096-000	R18-07
P - LISA M. NOLTE	1.28	1-325812-000	R18-16
Q - MELVIN HAND AND C.J. SHOOK	.70	1-309831-001	R18-15
R - REBECCA J. MCKENNA	1.52	1-308554-000	R18-17
S - MARK AND RENEE EDDY	1.17	1-309836-000	R18-13
T - KEVIN AND STACEE HESS	1.00	1-309834-000	R18-22.2
U - RANDEE AND HEATHER COX	1.03	1-309837-000	R18-22.1
V - JOE AND R.E. HORVAT	5.193	1-309833-000	R18-22
W - JOHN GEORGE HOFFMAN	3.71	1-329319-000 & 1-308546-000	R18-23.1

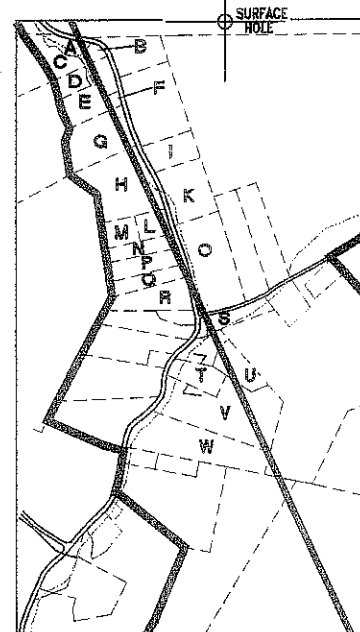

FILE #: CHE 062
DRAWING #: 1942
SCALE: 1" = 1800'
MINIMUM DEGREE OF ACCURACY: 1/200
PROVEN SOURCE SUBMETER MAPPING OF ELEVATION: GRADE GPS

I, THE UNDERSIGNED, HEREBY CERTIFY THAT THIS PLAT IS CORRECT TO THE BEST OF MY KNOWLEDGE AND BELIEF AND SHOWS ALL THE INFORMATION REQUIRED BY LAW AND THE REGULATIONS ISSUED AND PRESCRIBED BY THE DEPARTMENT OF ENVIRONMENTAL PROTECTION.
Signed: _____
L.L.S. #2124 : Ernest J. Benchek III

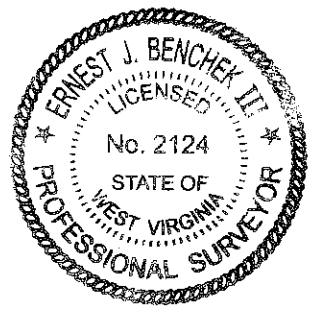

(+) DENOTES LOCATION OF WELL ON UNITED STATES TOPOGRAPHIC MAPS
WVDEP
OFFICE OF OIL & GAS
601 57TH STREET
CHARLESTON, WV 25304

DATE: MARCH 27, 2012
OPERATOR'S WELL #: EDWARD NICHOLS OHI 6H
API WELL #: 47 69 00145 H6A
STATE COUNTY PERMIT

Well Type: Oil Waste Diposal Production Deep
 Gas Liquid Injection Storage Shallow

WATERSHED: UPPER OHIO SOUTH ELEVATION: 1,310.15'
COUNTY/DISTRICT: OHIO/RICHLAND QUADRANGLE: WHEELING WV
SURFACE OWNER: EDWARD AND JUDITH NICHOLS ACREAGE: 240.06 +/-
OIL & GAS ROYALTY OWNER: EDWARD AND JUDITH NICHOLS ACREAGE: 424.33 +/-
LEASE NUMBERS: _____

DRILL CONVERT DRILL DEEPER REDRILL FRACTURE OR STIMULATE
PLUG OFF FORMATION PERFORATE NEW FORMATION PLUG & ABANDON
CLEAN OUT & REPLUG OTHER CHANGE (SPECIFY): _____

TARGET FORMATION: MARCELLUS ESTIMATED DEPTH: TVD: 6,205' TMD: 12,051'
WELL OPERATOR: CHESAPEAKE APPALACHIA, LLC. DESIGNATED AGENT: ERIC GILLESPIE
ADDRESS: PO BOX 18496 ADDRESS: PO BOX 6070
CITY: OKLAHOMA CITY STATE: OK ZIP CODE: 73154-0496 CITY: CHARLESTON STATE: WV ZIP CODE: 25301

WELL EDWARD NICHOLS HIGH
QUAD WHEELING WV

