



320 O'Bryan Lane • Van Buren, AR 72956  
Office: 479.474.7916 • Fax: 479.474.2450  
Surveying • handa-inc.com

LINE	BEARING	DISTANCE	DESCRIPTION	MONUMENT
L1	N 29°27'25" E	1233'	SHL TO LANDMARK	PARCEL CORNER
L2	S 61°05'29" E	1932'	SHL TO LANDMARK	PARCEL CORNER
L3	S 37°17'05" W	20.39'	SHL TO REF. PNT.	CHARLES FRYE OHI 3H WELL HEAD (069-00079)
L4	S 50°46'42" E	27.76'	SHL TO REF. PNT.	CHARLES FRYE OHI 10H WELL HEAD (069-00091)
LINE	BEARING	DISTANCE	CURVE LENGTH	DESCRIPTION
L5	S 08°20'41" W	436.44'		SHL TO LP
L6	S 34°20'48" E	5845.23'		LP TO BHL

Latitude: 40°05'00"

Longitude: 80°32'30"

**NOTES ON SURVEY**

- COORDINATE SYSTEM IS UTM, NAD 83 DATUM, ZONE 17, U.S. FOOT AND WELL COORDINATES ESTABLISHED USING SURVEY GRADE GPS.
- SURFACE AND ROYALTY OWNER INFORMATION AND THEIR BOUNDARIES SHOWN HEREON WERE PLOTTED FROM DEEDS AND/OR TAX PARCEL MAPS PROVIDED BY CLIENT AND/OR FIELD LOCATIONS.
- THIS PLAT DOES NOT REPRESENT A BOUNDARY SURVEY OF THE PARCELS SHOWN HEREON.
- NO OCCUPIED DWELLINGS AND AGRICULTURE BUILDINGS GREATER THAN 2500 SQ FT. WITHIN 625 FEET OF PROPOSED CENTER OF PAD.
- NO WATER WELLS OR DEVELOPED SPRINGS WITHIN 250 FEET OF PROPOSED WELL.
- NO PERENNIAL STREAMS, LAKES, PONDS, OR RESERVOIRS WITHIN 100 FEET OF THE LIMITS OF DISTURBANCE.
- NO NATURALLY PRODUCING TROUT STREAM WITHIN 300 FEET OF LIMITS OF DISTURBANCE.
- NO GROUND INTAKE OR PUBLIC WATER SUPPLY WITHIN 1000 FEET OF WELL PAD, LIMITS OF DISTURBANCE, E & S CONTROLS OR PUBLIC WATER SUPPLY.

TRACT	SURFACE OWNER (S) / ROYALTY OWNER (R)	TAX PARCEL	ACRES
1	CHARLES FRYE & DOROTHY FRYE (S) DOROTHY V FRYE (R)	06-T14-01	105.00
2	ZACHARY ALLAN MEYER (S) ZACHARY MEYER & JENNIFER MEYER (R)	06-T14-02	91.58
3	DONALD MOFFITT JR & L L MOFFITT (S) DONALD L MOFFITT JR & LINDA J MOFFITT (R) DAVID R MOFFITT (R) JUDITH L REBICH (R)	06-T14-03.3	1.649
4	DAVID R MOFFITT & LINDA J MOFFITT (S/R)	06-T14-03	34.231
5	REGINA A CONKLIN & HENRY M CONKLIN (S) REGINA A CONKLIN & HENRY J CONKLIN (R)	06-T14-03.4	1.048
6	DAVID R MOFFITT & L J MOFFITT (S) DAVID R MOFFITT & LINDA J MOFFITT (R)	06-T14-03.2	2.00
7	JUSTUS LUZADER JR, LIFE ESTATE (S) JUSTUS LUZADER JR (R)	06-T14-11	57.513
8	RICHARD J LUZADER (S/R)	06-T14-11.1	14.992
9	JASON GRAY & NICOLE L GRAY (S) RICHARD J LUZADER (R)	06-T14-11.3	5.00
10	KIRK LUZADER & JUDY LUZADER (S) KIRK D LUZADER & JUDY L LUZADER (R)	06-T14-11.2	14.365
11	KIRK D LUZADER & JUDY L LUZADER (S/R)	06-T14-11.4	6.94
12	CHRISTY M BOPP (S/R)	06-T14-10	54.866

**SWN PRODUCTION COMPANY, LLC**  
**"CHARLES FRYE OHI 8H"**  
**SURFACE HOLE**  
**ELEV: 1267.4'**

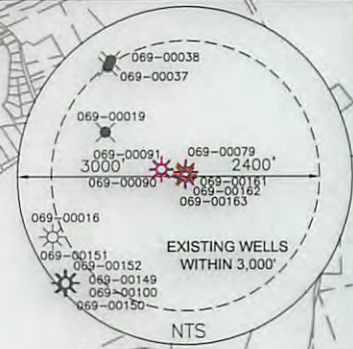
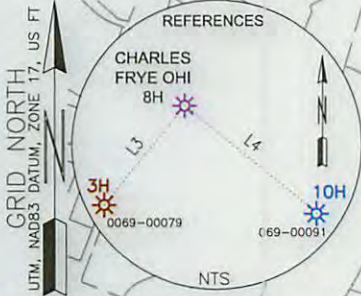

SURFACE HOLE LOCATION (SHL):	
GEOGRAPHIC (NAD83):	LATITUDE: 40.053169° LONGITUDE: -80.577101°
UTM (NAD83, ZONE 17, FEET):	NORTHING: 14,546,375.541 EASTING: 1,758,758.170
UTM (NAD83, ZONE 17, METERS):	NORTHING: 4,433,744.133 EASTING: 536,070.563
LANDING POINT LOCATION (LPL):	
GEOGRAPHIC (NAD83):	LATITUDE: 40.051984° LONGITUDE: -80.577335°
UTM (NAD83, ZONE 17, FEET):	NORTHING: 14,545,943.721 EASTING: 1,758,694.830
UTM (NAD83, ZONE 17, METERS):	NORTHING: 4,433,612.514 EASTING: 536,051.256
BOTTOM HOLE LOCATION (BHL):	
GEOGRAPHIC (NAD83):	LATITUDE: 40.038688° LONGITUDE: -80.565634°
UTM (NAD83, ZONE 17, FEET):	NORTHING: 14,541,117.681 EASTING: 1,761,992.710
UTM (NAD83, ZONE 17, METERS):	NORTHING: 4,432,141.534 EASTING: 537,056.452

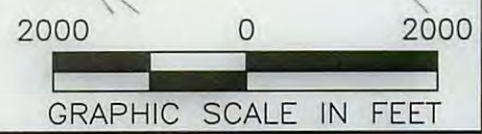
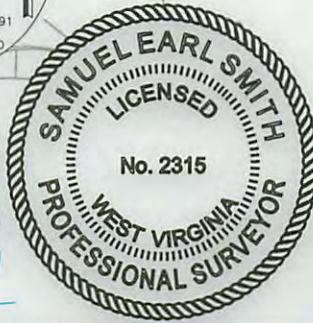
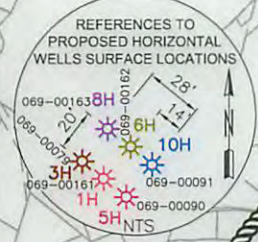

I, THE UNDERSIGNED, HEREBY CERTIFY THAT THIS PLAT IS CORRECT TO THE BEST OF MY KNOWLEDGE AND BELIEF AND SHOWS ALL THE INFORMATION REQUIRED BY LAW AND REGULATIONS ISSUED AND PRESCRIBED BY THE DEPARTMENT OF ENVIRONMENTAL PROTECTION.

P.S. 2315

*Samuel Earl Smith*

COMPANY: **SWN** **SWN** <sup>R-V+</sup><sub>A</sub>  
Production Company, LLC Production Company™

<p>(+) DENOTES LOCATION OF WELL ON UNITED STATES TOPOGRAPHIC MAPS</p> <p>WVDEP OFFICE OF OIL &amp; GAS 601 57TH STREET CHARLESTON, WV 25034</p>	<p>MINIMUM DEGREE OF ACCURACY: 1/200</p> <p>PROVEN SURVEY SOURCE OF GRADE GPS ELEVATION: (NAVD 88, US FT)</p>	<p>CHARLES FRYE OHI</p> <p>OPERATOR'S WELL #: 8H</p> <p>API WELL #: 47 69 00163H6A</p> <p>STATE COUNTY PERMIT</p>
	<p>WELL TYPE: OIL <input type="checkbox"/> WASTE DISPOSAL <input type="checkbox"/> PRODUCTION <input checked="" type="checkbox"/> DEEP <input type="checkbox"/> GAS <input checked="" type="checkbox"/> LIQUID INJECTION <input type="checkbox"/> STORAGE <input type="checkbox"/> SHALLOW <input checked="" type="checkbox"/></p> <p>WATERSHED: MIDDLE WHEELING CREEK</p> <p>DISTRICT: TRIDELPHIA COUNTY: OHIO</p> <p>SURFACE OWNER: CHARLES FRYE &amp; DOROTHY FRYE</p> <p>OIL &amp; GAS ROYALTY OWNER: DOROTHY V FRYE</p>	<p>ELEVATION: 1267.4'</p> <p>QUADRANGLE: VALLEY GROVE</p> <p>ACREAGE: ±105.00</p> <p>ACREAGE: ±105.00</p>

DRILL  DRILL DEEPER  REDRILL  FRACTURE OR STIMULATE  PLUG OFF OLD FORMATION  PERFORATE NEW FORMATION

CONVERT  PLUG & ABANDON  CLEAN OUT & REPLUG  OTHER CHANGE  (SPECIFY) AS-DRILLED

TARGET FORMATION: MARCELLUS ESTIMATED DEPTH: 6,614' TD 12,665' IMD

WELL OPERATOR: SWN PRODUCTION COMPANY, LLC DESIGNATED AGENT: DEE SOUTHALL  
ADDRESS: P.O. BOX 1300 ADDRESS: P.O. BOX 1300  
CITY: JANE LEW STATE: WV ZIP CODE: 26378 CITY: JANE LEW STATE: WV ZIP CODE: 26378

LEGEND:	REVISIONS:	DATE:
<ul style="list-style-type: none"> <li>○ PROPOSED SURFACE HOLE / BOTTOM HOLE</li> <li>⊗ EXISTING / PRODUCING WELL HEAD</li> <li>⊗ ABANDONED WELL</li> <li>⊗ PLUGGED &amp; ABANDONED WELL</li> <li>△ CUT CONDUCTOR</li> </ul>	<ul style="list-style-type: none"> <li>--- LEASE BOUNDARY</li> <li>--- 500' DHP BUFFER</li> <li>- - - MAR 1 - - - MARCELLUS DHP</li> <li>--- ABANDONED PATH</li> </ul>	<p>08-25-2015</p> <p>DRAWN BY: S. HUTSON</p> <p>SCALE: 1" = 2000'</p> <p>DRAWING NO: 59061</p> <p>WELL LOCATION PLAT</p>