

**TOP HOLE (UTM 83)**  
N) 4432660.0  
E) 540013.5

**BOTTOM HOLE (UTM 83)**  
N) 4430881.0  
E) 541370.5

**WELL (SURFACE HOLE) ROY FERRELL OHI 210H**  
WV-N (NAD 83)  
N: 563754.6  
E: 1679868.4  
UTM (NAD 83)  
N: 4432660.0  
E: 540013.5

**WELL (SURFACE HOLE) ROY FERRELL OHI 210H**  
WV-N (NAD 83)  
N: 563753.10  
E: 1679868.29  
UTM (NAD 83)  
N: 4432659.54  
E: 540014.12

**WELL (LANDING POINT) ROY FERRELL OHI 210H**  
WV-N (NAD 83)  
N: 564479.28  
E: 1681644.35  
UTM (NAD 83)  
N: 4432889.83  
E: 540551.50

**WELL (LANDING POINT) ROY FERRELL OHI 210H**  
WV-N (NAD 83)  
N: 563754.6  
E: 1679868.4  
UTM (NAD 83)  
N: 4432660.0  
E: 540013.5

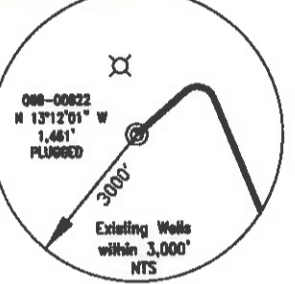

**REFERENCE NOTES**  
Boundaries as shown taken from deeds, tax maps and field locations. A full boundary survey is not expressed nor implied. All bearings are based on true north. Ownership taken from public records Ohio County, West Virginia FEBRUARY 2011 State Plane Coordinates & NAD 83 Lat/Long by differential submeter mapping grade GPS Drafted by: E.A.M.

FILE #: CHE 034  
DRAWING #: 1975  
SCALE: PLAT = (1"=1400')  
TICK MARK = (1"=2000')

MINIMUM DEGREE OF ACCURACY: 1/200

PROVEN SOURCE SUBMETER MAPPING OF ELEVATION: GRADE GPS

I, THE UNDERSIGNED, HEREBY CERTIFY THAT THIS PLAT IS CORRECT TO THE BEST OF MY KNOWLEDGE AND BELIEF AND SHOWS ALL THE INFORMATION REQUIRED BY LAW AND THE REGULATIONS ISSUED AND PRESCRIBED BY THE DEPARTMENT OF ENVIRONMENTAL PROTECTION.

Signed: *[Signature]*

L.L.S. #2124 : Ernest J. Benchek III

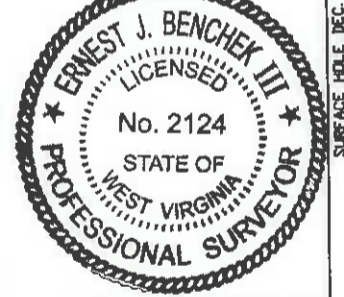

(+) DENOTES LOCATION OF WELL ON UNITED STATES TOPOGRAPHIC MAPS WVDEP

OFFICE OF OIL & GAS  
601 57TH STREET  
CHARLESTON, WV 25304

Well Type:  Oil  Waste Diposal  Production  Deep  Gas  Liquid Injection  Storage  Shallow

WATERSHED: WHEELING CREEK

COUNTY/DISTRICT: OHIO/TRIADELPHIA

SURFACE OWNER: ROY E. FERRELL

OIL & GAS ROYALTY OWNER: ROY E. FERRELL

LEASE NUMBERS: \_\_\_\_\_

DATE: MAY 10, 2016

OPERATOR'S WELL #: ROY FERRELL OHI 210H AS-DRILLED

API WELL #: 47 69 00172  
STATE COUNTY PERMIT

AS-BUILT  
ELEVATION: 1196.0'

QUADRANGLE: VALLEY GROVE WV.

ACREAGE: 202.31 +/-

ACREAGE: 591.30 +/10/28/2016

TARGET FORMATION: MARCELLUS

WELL OPERATOR: CHESAPEAKE APPALACHIA, LLC.

ADDRESS: PO BOX 18496

CITY: OKLAHOMA CITY STATE: OK ZIP CODE: 73154-0496

DRILL  CONVERT  DRILL DEEPER  REDRILL  FRACTURE OR STIMULATE   
PLUG OFF FORMATION  PERFORATE NEW FORMATION  PLUG & ABANDON   
CLEAN OUT & REPLUG  OTHER CHANGE  (SPECIFY): \_\_\_\_\_

AS-DRILLED DEPTH: TVD: 6,766.446' TMD: 14,784'  
DESIGNATED AGENT: JESSICA GREATHOUSE  
ADDRESS: PO Box 6070  
CITY: CHARLESTON STATE: WV ZIP CODE: 25301