

REFERENCE NOTES
Boundaries as shown taken from deeds, tax maps and field locations. A full boundary survey is not expressed nor implied. All bearings are based on true north. Ownership taken from public records Ohio County, West Virginia JUNE 2013
State Plane Coordinates & NAD 83 Lat/Long by differential submeter mapping grade GPS
Drafted by EAK

TOP HOLE (UTM NAD 83)
N) 4438947.6
E) 537467.7

BOTTOM HOLE (UTM NAD 83)
N) 4441754.3
E) 536185.5

NOTE:
NO WATER WELLS WERE FOUND WITHIN 250' OF THE CENTER OF WELL PAD.
NO DWELLINGS WERE FOUND WITHIN 825' OF THE CENTER OF THE WELL PAD.

FILE #: CHE 036

DRAWING #: 1653

SCALE: PLAT: 1" = 1800'
TICK MARK: 1" = 2000'

MINIMUM DEGREE OF ACCURACY: 1/200

PROVEN SOURCE OF ELEVATION: SUBMETER MAPPING GRADE GPS

I, THE UNDERSIGNED, HEREBY CERTIFY THAT THIS PLAT IS CORRECT TO THE BEST OF MY KNOWLEDGE AND BELIEF AND SHOWS ALL THE INFORMATION REQUIRED BY LAW AND THE REGULATIONS ISSUED AND PRESCRIBED BY THE DEPARTMENT OF ENVIRONMENTAL PROTECTION.

Signed: [Signature]

L.L.S. #2124 : Ernest J. Benchek III



(+) DENOTES LOCATION OF WELL ON UNITED STATES TOPOGRAPHIC MAPS WVDEP

OFFICE OF OIL & GAS
601 57TH STREET
CHARLESTON, WV 25304

Well Type: Oil Waste Diposal Production Deep
 Gas Liquid Injection Storage Shallow

WATERSHED: UPPER OHIO SOUTH ELEVATION: 1,198'

COUNTY/DISTRICT: OHIO / LIBERTY QUADRANGLE: VALLEY GROVE, WV

SURFACE OWNER: ALICE MAE EDGE ACREAGE: 103 +/-

OIL & GAS ROYALTY OWNER: SEE ATTACHED ACREAGE: 529.229 +/-

LEASE NUMBERS: _____

DRILL CONVERT DRILL DEEPER REDRILL FRACTURE OR STIMULATE
PLUG OFF FORMATION PERFORATE NEW FORMATION PLUG & ABANDON
CLEAN OUT & REPLUG OTHER CHANGE (SPECIFY): _____

TARGET FORMATION: MARCELLUS ESTIMATED DEPTH: TVD: 6,410' TMD: 16,302'

WELL OPERATOR: CHESAPEAKE APPALACHIA, LLC. DESIGNATED AGENT: ERIC B. GILLESPIE

ADDRESS: PO BOX 18496 ADDRESS: PO BOX 6070

CITY: OKLAHOMA CITY STATE: OK ZIP CODE: 73154-0496 CITY: CHARLESTON STATE: WV ZIP 09/26/2014

DATE: JULY 22, 2014

OPERATOR'S WELL #: ALICE EDGE OHI 3H

API WELL #: 47 69 00180 H&E
STATE COUNTY PERMIT

WELL: ALICE EDGE OHI 3H
QUAD: VALLEY GROVE, WV

47-6900180

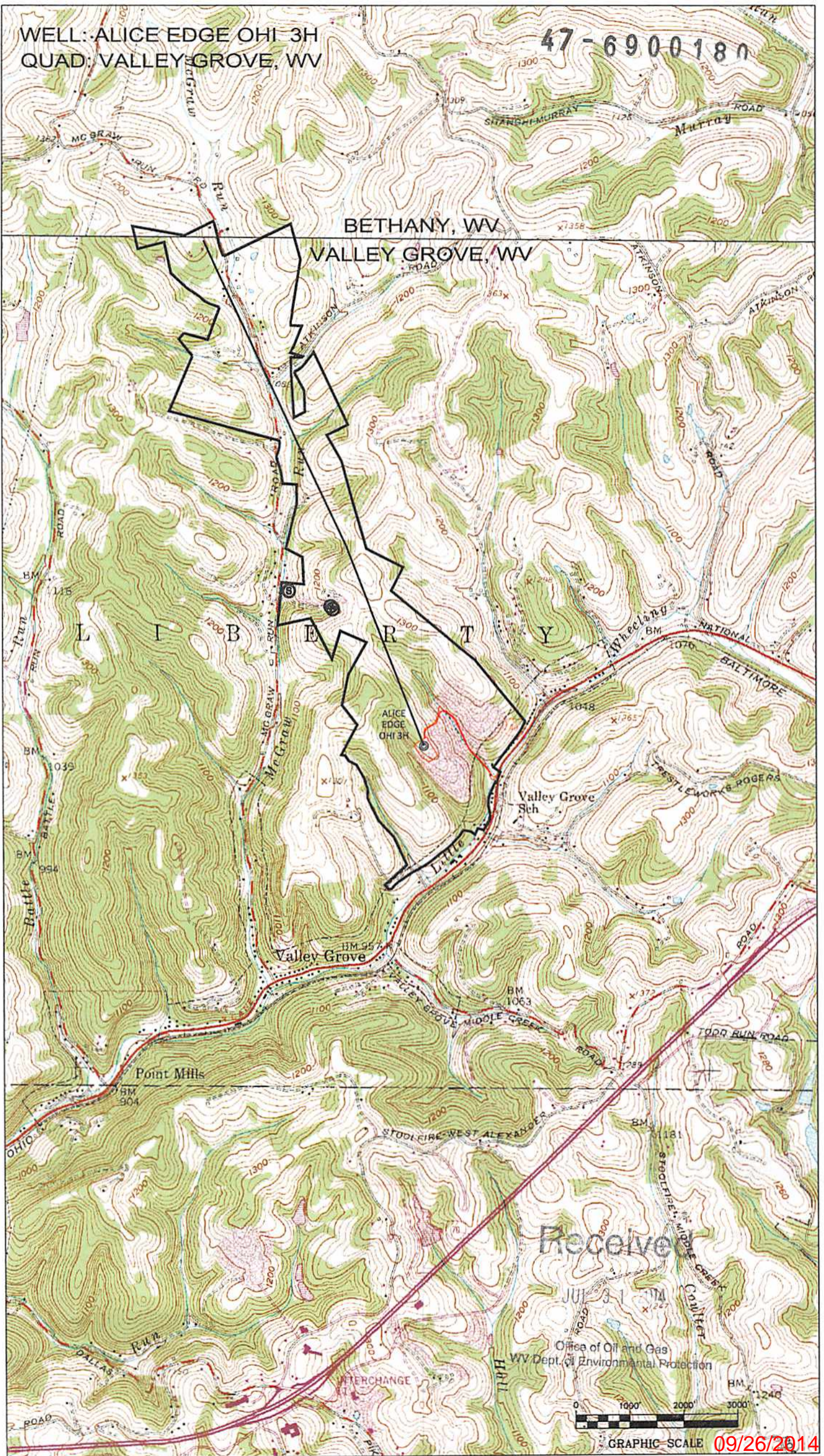

Received

JUL 31 2014

Office of Oil and Gas
WV Dept. of Environmental Protection

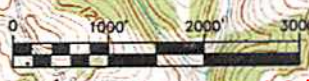

GRAPHIC SCALE 09/26/2014