

Via Federal Express

January 26, 2016

Ms. Laura Cooper
Office of Oil & Gas
601 57th Street
Charleston WV 25304

RE: Form WR-35 and WR-36 Filing Well: Alice Edge OHI 201H
API: 47-069-00181

Dear Ms. Cooper:

Please find enclosed form WR-35 Well Operator's Report of Well Work and WR-36 Well Operator's Report of Initial Gas-Oil Ratio, with supporting documentation for the subject well referenced above.

If you have any questions or require additional information, please contact me via email at liz_gee@swn.com or telephone at (832) 796-7632.

Sincerely,

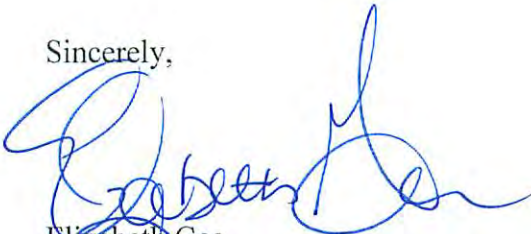

Elizabeth Gee
Sr. Regulatory Analyst
West Virginia Division

/lg
Encl.

RECEIVED
Office of Oil and Gas

JAN 27 2016

WV Department of
Environmental Protection

[Handwritten initials]
2-22-16

$\frac{R^2}{A} \rightarrow V^+$

02/26/2016

State of West Virginia
Department of Environmental Protection - Office of Oil and Gas
Well Operator's Report of Well Work

API 47-069-00181 County OHIO District LIBERTY
Quad VALLEY GROVE Pad Name ALICE EDGE-OHI-PAD1 Field/Pool Name PANHANDLE
Farm name ALICE MAE EDGE Well Number ALICE EDGE OHI 201H
Operator (as registered with the OOG) SWN PRODUCTION COMPANY LLC
Address PO BOX 12359 City SPRING State TX Zip 77397-2359

As Drilled location NAD 83/UTM Attach an as-drilled plat, profile view, and deviation survey
Top hole Northing 4438947.520 Easting 537467.805
Landing Point of Curve Northing 4439089.837 Easting 537403.955
Bottom Hole Northing 4441755.916 Easting 536186.648

Elevation (ft) 1199 GL Type of Well New Existing Type of Report Interim Final
Permit Type Deviated Horizontal Horizontal 6A Vertical Depth Type Deep Shallow
Type of Operation Convert Deepen Drill Plug Back Redrilling Rework Stimulate
Well Type Brine Disposal CBM Gas Oil Secondary Recovery Solution Mining Storage Other _____
Type of Completion Single Multiple Fluids Produced Brine Gas NGL Oil Other _____
Drilled with Cable Rotary

Drilling Media Surface hole Air Mud Fresh Water Intermediate hole Air Mud Fresh Water Brine
Production hole Air Mud Fresh Water Brine
Mud Type(s) and Additive(s) SOBM

RECEIVED
Office of Oil and Gas

JAN 27 2016

Date permit issued 10/08/2014 Date drilling commenced 10/28/2014 WV Department of Environmental Protection 11/13/2014
Date completion activities began 08/31/2015 Date completion activities ceased 10/30/2015
Verbal plugging (Y/N) N Date permission granted N/A Granted by N/A

Please note: Operator is required to submit a plugging application within 5 days of verbal permission to plug

Freshwater depth(s) ft 394' Open mine(s) (Y/N) depths N
Salt water depth(s) ft 731' Void(s) encountered (Y/N) depths N
Coal depth(s) ft 582' Cavern(s) encountered (Y/N) depths N
Is coal being mined in area (Y/N) N

Reviewed by:
6272672016

API 47-069 - 00181 Farm name ALICE MAE EDGE Well number ALICE EDGE OHI 201H

| CASING STRINGS | Hole Size | Casing Size | Depth | New or Used | Grade wt/ft | Basket Depth(s) | Did cement circulate (Y/N) * Provide details below* |
|---------------------------|--------------|-------------|--------|-------------|--------------|-----------------|--|
| Conductor | 28 | 20 | 120' | N | J-55/ 94# | | Y, 13 BBLs TO SURFACE |
| Surface | 17.5 | 13.375 | 630' | N | J-55/ 54.50# | | Y, 32 BBLs TO SURFACE |
| Coal | SEE SURFACE | | | | | | |
| Intermediate 1 | 12.25 | 9.625 | 2106' | N | J-55/ 40# | | Y, 35 BBLs TO SURFACE |
| Intermediate 2 | | | | | | | |
| Intermediate 3 | | | | | | | |
| Production | 8.75 TO 8.50 | 5.5 | 18756' | N | P-110/20# | | Y |
| Tubing | | 2.375 | 7071' | N | L-80/4.70# | | N |
| Packer type and depth set | | N/A | | | | | |

Comment Details _____

| CEMENT DATA | Class/Type of Cement | Number of Sacks | Slurry wt (ppg) | Yield (ft ³ /sks) | Volume (ft ³) | Cement Top (MD) | WOC (hrs) |
|----------------|----------------------|-----------------|-----------------|------------------------------|---------------------------|-----------------|-----------|
| Conductor | A | 200 | 15.6 | 1.20 | 240 | SURFACE | 24 |
| Surface | A | 610 | 15.6 | 1.20 | 732 | SURFACE | 8 |
| Coal | SEE SURFACE | | | | | | |
| Intermediate 1 | A | 805 | 15.7 | 1.19 | 957.95 | SURFACE | 8 |
| Intermediate 2 | | | | | | | |
| Intermediate 3 | | | | | | | |
| Production | A | 1007/2821 | 15.3/15.6 | 1.31/1.19 | 1319/3357 | SURFACE | 24 |
| Tubing | | | | | | | |

Drillers TD (ft) 18756' Loggers TD (ft) 18756'
 Deepest formation penetrated MARCELLUS Plug back to (ft) NA
 Plug back procedure NA

Kick off depth (ft) 6217'

Check all wireline logs run caliper density deviated/directional induction
 neutron resistivity gamma ray temperature sonic

Well cored Yes No Conventional Sidewall Were cuttings collected Yes No

DESCRIBE THE CENTRALIZER PLACEMENT USED FOR EACH CASING STRING _____

ALL CASING STRINGS RAN WITH A CENTRALIZER AT A MINIMUM OF 1 PER EVERY 3RD JOINT OF CASING

RECEIVED
Office of Oil and Gas

JAN 27 2016

WAS WELL COMPLETED AS SHOT HOLE Yes No DETAILS _____

WV Department of
Environmental Protection

WAS WELL COMPLETED OPEN HOLE? Yes No DETAILS _____

WERE TRACERS USED Yes No TYPE OF TRACER(S) USED _____

ALICE EDGE OHI 201H - STIMULATION INFORMATION

| STAGE NUM | Stim Date | Ave Pump Rate (BPM) | Ave Treatment Pressure (PSI) | Max Breakdown Pressure (PSI) | ISIP (PSI) | Amount of Proppant (lbs) | Amount of water bbls | Amount of nitrogen/other |
|--------------|-----------|------------------------------|---------------------------------------|---------------------------------------|------------|--------------------------------|----------------------------|--|
| 1 | 8/31/2015 | 2 | 8,230 | 9,217 | 3,239 | 269,900 | 5,111 | |
| 2 | 8/31/2015 | 2 | 8,098 | 9,209 | 4,403 | 378,040 | 6,374 | |
| 3 | 8/31/2015 | 2 | 7,695 | 9,235 | 4,219 | 305,620 | 6,555 | |
| 4 | 9/1/2015 | 2 | 8,647 | 9,459 | 4,479 | 120,000 | 7,828 | |
| 5 | 9/1/2015 | 2 | 8,426 | 9,002 | 4,685 | 504,620 | 7,923 | |
| 6 | 9/2/2015 | 2 | 8,767 | 9,172 | 4,591 | 493,560 | 7,527 | |
| 7 | 9/2/2015 | 2 | 8,496 | 9,152 | 4,479 | 499,660 | 7,838 | |
| 8 | 9/3/2015 | 2 | 8,608 | 9,062 | 4,701 | 502,820 | 7,382 | |
| 9 | 9/3/2015 | 2 | 8,573 | 9,294 | 4,459 | 504,140 | 7,400 | |
| 10 | 9/3/2015 | 2 | 8,366 | 9,181 | 4,578 | 502,940 | 8,087 | |
| 11 | 9/4/2015 | 2 | 8,395 | 9,222 | 4,497 | 503,900 | 7,312 | |
| 12 | 9/4/2015 | 2 | 8,471 | 9,200 | 4,305 | 503,640 | 7,645 | |
| 13 | 9/4/2015 | 2 | 8,251 | 9,119 | 4,814 | 500,920 | 7,381 | |
| 14 | 9/5/2015 | 2 | 8,285 | 8,982 | 4,445 | 500,160 | 7,495 | |
| 15 | 9/5/2015 | 2 | 8,191 | 8,917 | 4,577 | 503,220 | 7,493 | |
| 16 | 9/5/2015 | 2 | 8,113 | 9,058 | 4,528 | 516,000 | 7,495 | |
| 17 | 9/6/2015 | 2 | 8,190 | 8,840 | 4,499 | 500,120 | 7,407 | |
| 18 | 9/6/2015 | 2 | 8,240 | 8,932 | 4,449 | 501,220 | 7,315 | |
| 19 | 9/6/2015 | 2 | 8,050 | 9,142 | 4,660 | 500,180 | 7,281 | |
| 20 | 9/7/2015 | 2 | 8,303 | 8,761 | 4,319 | 500,540 | 7,341 | |
| 21 | 9/7/2015 | 2 | 8,118 | 9,135 | 4,388 | 487,120 | 7,218 | |
| 22 | 9/7/2015 | 2 | 7,836 | 8,700 | 4,403 | 510,640 | 7,434 | |
| 23 | 9/8/2015 | 2 | 8,139 | 9,181 | 4,533 | 500,400 | 7,197 | |
| 24 | 9/8/2015 | 2 | 8,124 | 8,899 | 4,329 | 503,000 | 7,228 | |
| 25 | 9/9/2015 | 2 | 8,036 | 8,727 | 4,626 | 500,140 | 7,529 | |
| 26 | 9/9/2015 | 2 | 7,846 | 9,114 | 4,442 | 501,240 | 7,155 | |
| 27 | 9/9/2015 | 2 | 7,722 | 9,047 | 4,515 | 500,060 | 7,433 | RECEIVED Office of Oil and Gas |
| 28 | 9/10/2015 | 2 | 7,661 | 8,642 | 5,145 | 500,740 | 7,410 | |
| 29 | 9/10/2015 | 2 | 7,903 | 9,104 | 4,480 | 499,960 | 7,284 | JAN 27 2016 |
| 30 | 9/11/2015 | 2 | 7,545 | 9,162 | 4,685 | 501,720 | 7,442 | |
| 31 | 9/11/2015 | 2 | 7,739 | 9,059 | 4,480 | 500,660 | 7,270 | WV Department of Environmental Protection |
| 32 | 9/11/2015 | 2 | 7,460 | 9,014 | 4,557 | 500,360 | 7,316 | |
| 33 | 9/12/2015 | 2 | 7,723 | 8,971 | 4,667 | 500,690 | 8,238 | |
| 34 | 9/12/2015 | 2 | 7,462 | 8,472 | 4,576 | 500,900 | 7,347 | |
| 35 | 9/13/2015 | 2 | 7,557 | 9,061 | 4,740 | 500,040 | 7,263 | |
| 36 | 9/13/2015 | 2 | 7,399 | 8,501 | 4,819 | 481,800 | 7,133 | |
| 37 | 9/14/2015 | 2 | 7,658 | 8,900 | 5,116 | 505,500 | 7,188 | |
| 38 | 9/14/2015 | 2 | 7,403 | 8,988 | 4,714 | 504,280 | 7,233 | |
| 39 | 9/15/2015 | 2 | 7,400 | 8,735 | 4,777 | 500,000 | 7,179 | |
| 40 | 9/15/2015 | 2 | 7,184 | 9,125 | 4,751 | 500,820 | 7,930 | |
| 41 | 9/16/2015 | 2 | 7,348 | 8,767 | 4,770 | 497,820 | 7,007 | |

ALICE EDGE OHI 201H - STIMULATION INFORMATION

| STAGE NUM | Stim Date | Ave Pump Rate (BPM) | Ave Treatment Pressure (PSI) | Max Breakdown Pressure (PSI) | ISIP (PSI) | Amount of Proppant (lbs) | Amount of water bbls | Amount of nitrogen/other |
|--------------|-----------|------------------------------|---------------------------------------|---------------------------------------|------------|--------------------------------|----------------------------|-----------------------------|
| 42 | 9/16/2015 | 2 | 7,613 | 8,741 | 4,685 | 499,600 | 7,005 | |
| 43 | 9/17/2015 | 2 | 7,379 | 8,689 | 5,116 | 497,880 | 7,023 | |
| 44 | 9/17/2015 | 2 | 7,173 | 8,408 | 4,853 | 500,780 | 6,883 | |
| 45 | 9/17/2015 | 2 | 7,148 | 8,692 | 5,154 | 500,320 | 6,776 | |
| Grand total | | 2 | 7,933 | 9,459 | 4,583 | 21,607,670 | 328,311 | |

RECEIVED
Office of Oil and Gas

JAN 27 2016

WV Department of
Environmental Protection

ALICE EDGE OHI 201H - PERFORATION INFORMATION

| STAGE NUM | Perf Date | Perf Top MD | Perf Bottom MD | # SHOTS PER STG |
|--------------|-----------|-------------|-------------------|--------------------|
| 1 | 8/31/2015 | 18,472 | 18,509 | 33 |
| 2 | 8/31/2015 | 18,276 | 18,409 | 33 |
| 3 | 8/31/2015 | 18,080 | 18,213 | 33 |
| 4 | 9/1/2015 | 17,884 | 18,017 | 33 |
| 5 | 9/1/2015 | 17,622 | 17,820 | 42 |
| 6 | 9/2/2015 | 17,361 | 17,559 | 42 |
| 7 | 9/2/2015 | 17,099 | 17,297 | 42 |
| 8 | 9/3/2015 | 16,838 | 17,036 | 42 |
| 9 | 9/3/2015 | 16,582 | 16,774 | 42 |
| 10 | 9/3/2015 | 16,314 | 16,513 | 42 |
| 11 | 9/4/2015 | 16,053 | 16,251 | 42 |
| 12 | 9/4/2015 | 15,791 | 15,989 | 42 |
| 13 | 9/4/2015 | 15,530 | 15,728 | 42 |
| 14 | 9/5/2015 | 15,268 | 15,466 | 42 |
| 15 | 9/5/2015 | 15,007 | 15,205 | 42 |
| 16 | 9/5/2015 | 14,745 | 14,943 | 42 |
| 17 | 9/6/2015 | 14,484 | 14,682 | 42 |
| 18 | 9/6/2015 | 14,222 | 14,420 | 42 |
| 19 | 9/6/2015 | 13,960 | 14,159 | 42 |
| 20 | 9/7/2015 | 13,699 | 13,897 | 42 |
| 21 | 9/7/2015 | 13,437 | 13,635 | 42 |
| 22 | 9/7/2015 | 13,176 | 13,374 | 42 |
| 23 | 9/8/2015 | 12,914 | 13,112 | 42 |
| 24 | 9/8/2015 | 12,653 | 12,851 | 42 |
| 25 | 9/9/2015 | 12,391 | 12,589 | 42 |
| 26 | 9/9/2015 | 12,130 | 12,328 | 42 |
| 27 | 9/9/2015 | 11,868 | 12,066 | 42 |
| 28 | 9/10/2015 | 11,606 | 11,805 | 42 |
| 29 | 9/10/2015 | 11,345 | 11,543 | 42 |
| 30 | 9/11/2015 | 11,083 | 11,281 | 42 |
| 31 | 9/11/2015 | 10,822 | 11,020 | 42 |
| 32 | 9/11/2015 | 10,560 | 10,758 | 42 |
| 33 | 9/12/2015 | 10,299 | 10,497 | 42 |
| 34 | 9/12/2015 | 10,037 | 10,235 | 42 |
| 35 | 9/13/2015 | 9,776 | 9,974 | 42 |
| 36 | 9/13/2015 | 9,514 | 9,712 | 42 |
| 37 | 9/14/2015 | 9,252 | 9,451 | 42 |
| 38 | 9/14/2015 | 8,991 | 9,189 | 42 |
| 39 | 9/15/2015 | 8,729 | 8,927 | 42 |
| 40 | 9/15/2015 | 8,468 | 8,666 | 42 |
| 41 | 9/16/2015 | 8,206 | 8,404 | 42 |
| 42 | 9/16/2015 | 7,945 | 8,143 | 42 |
| 43 | 9/17/2015 | 7,683 | 7,881 | 42 |
| 44 | 9/17/2015 | 7,422 | 7,620 | 42 |
| 45 | 9/17/2015 | 7,160 | 7,358 | 42 |

RECEIVED
Office of Oil and Gas

JAN 27 2016

WV Department of
Environmental Protection

02/26/2016

Hydraulic Fracturing Fluid Product Component Information Disclosure

| | |
|--------------------------------|---------------------|
| Job Start Date: | 8/31/2015 |
| Job End Date: | 9/17/2015 |
| State: | West Virginia |
| County: | Ohio |
| API Number: | 47-069-00181-00-00 |
| Operator Name: | Southwestern Energy |
| Well Name and Number: | Alice Edge Ohi 201H |
| Longitude: | -80.56037700 |
| Latitude: | 40.09982700 |
| Datum: | NAD27 |
| Federal/Tribal Well: | NO |
| True Vertical Depth: | 6,222 |
| Total Base Water Volume (gal): | 13,443,066 |
| Total Base Non Water Volume: | 0 |



Hydraulic Fracturing Fluid Composition:

| Trade Name | Supplier | Purpose | Ingredients | Chemical Abstract Service Number (CAS #) | Maximum Ingredient Concentration in Additive (% by mass)** | Maximum Ingredient Concentration in HF Fluid (% by mass)** | Comments |
|--|--------------|--|---|--|--|--|----------|
| Ingredients shown above are subject to 29 CFR 1910.1200(i) and appear on Material Safety Data Sheets (MSDS). Ingredients shown below are Non-MSDS. | | | | | | | |
| Proppant Transport | Schlumberger | Corrosion Inhibitor, Acid, Breaker, Gelling Agent, Friction Reducer, Propping Agent, Fluid Loss Additive | | | | | |
| | | | Water (Including Mix Water Supplied by Client)* | NA | | 83.97526 | |
| | | | Quartz, Crystalline silica | 14808-60-7 | 98.62940 | 15.80510 | |
| | | | Hydrochloric acid | 7647-01-0 | 1.34676 | 0.21581 | |
| | | | Ammonium sulfate | 7783-20-2 | 0.29085 | 0.04661 | |
| | | | Urea | 57-13-6 | 0.04847 | 0.00777 | |
| | | | Methanol | 67-56-1 | 0.00402 | 0.00064 | |
| | | | Aliphatic acids | Proprietary | 0.00201 | 0.00032 | |
| | | | Thiourea formaldehyde polymer | Proprietary | 0.00201 | 0.00032 | |
| | | | Propargyl alcohol | 107-19-7 | 0.00067 | 0.00011 | |
| | | | Aliphatic alcohols, ethoxylated #2 | Proprietary | 0.00067 | 0.00011 | |
| | | | Hexadec-1-ene | 629-73-2 | 0.00033 | 0.00005 | |
| | | | Olefin Hydrocarbon | Proprietary | 0.00033 | 0.00005 | |
| | | | Formaldehyde | 50-00-0 | 0.00001 | | |

WV Department of Environmental Protection
 JAN 27 2015
 RECEIVED
 Office of Oil and Gas

* Total Water Volume sources may include fresh water, produced water, and/or recycled water
** Information is based on the maximum potential for concentration and thus the total may be over 100%

Note: For Field Development Products (products that begin with FDP), MSDS level only information has been provided.
Ingredient information for chemicals subject to 29 CFR 1910.1200(i) and Appendix D are obtained from suppliers Material Safety Data Sheets (MSDS)

RECEIVED
Office of Oil and Gas
JAN 27 2016
WV Department of
Environmental Protection

ALICE EDGE OHI 201H

| LITHOLOGY/FORMATION | TOP DEPTH, TVD (FT) | BOTTOM DEPTH, TVD (FT) | TOP DEPTH, MD (FT) | BOTTOM DEPTH, MD (FT) | QUANTITY AND TYPE OF FLUID |
|---------------------|---------------------|------------------------|--------------------|-----------------------|----------------------------|
| Base of Fresh Water | N.A. | 394.00 | N.A. | 394.00 | |
| Top of Salt Water | 731.00 | N.A. | 731.00 | N.A. | |
| Pittsburgh Coal | 581.99 | 587.99 | 582.00 | 588.00 | |
| Big Injun (ss) | 1818.81 | 2273.66 | 1829.00 | 2289.00 | |
| Berea (siltstone) | 2273.66 | 5812.91 | 2289.00 | 6180.00 | |
| Rhinestreet (shale) | 5812.91 | 6042.27 | 6180.00 | 6440.68 | |
| Cashaqua (shale) | 6042.27 | 6116.57 | 6440.68 | 6525.67 | |
| Middlesex (shale) | 6116.57 | 6187.79 | 6525.67 | 6615.71 | |
| Burket (shale) | 6187.79 | 6212.78 | 6615.71 | 6650.30 | |
| Tully (ls) | 6212.78 | 6246.95 | 6650.30 | 6700.30 | |
| Mahantango (shale) | 6246.95 | 6375.05 | 6700.30 | 6965.58 | |
| Marcellus (shale) | 6375.05 | N.A. | 6965.58 | N.A. | |

RECEIVED
 Office of Oil and Gas
JAN 27 2016
 WV Department of
 Environmental Protection

THRASHER AS-DRILLED

THE THRASHER GROUP, INC.
600 WHITE OAKS BLVD.
BRIDGEPORT, WV 26330
PHONE 304-624-4108

| TRACT | SURFACE OWNER (S) / ROYALTY OWNER (R) | TAX PARCEL | ACRES | LEASE NO. |
|-------|---------------------------------------|-------------|--------|----------------|
| 1 | ALICE MAE EDGE | 3-L11-23 | 103.0 | 1-292390-000 |
| 2 | LYNN & YVONNE REUSSER | 3-L11-21 | 70.90 | 47-000579-000 |
| 3 | LYNN & YVONNE REUSSER | 3-L11-20 | 103.80 | 47-000579-000 |
| 4 | MICHAEL & MELISSA J VARGO | 3-L11-10 | 134.94 | 01-324194-000 |
| 5 | MICHAEL & MELISSA J VARGO | 3-L11-10.7 | 1.22 | 01-324194-000 |
| 6 | DAVID J MILLER | 3-L11-8 | 26.89 | 01-265403-000 |
| 7 | ROBERT J & TONYA L LEMASTERS | 3-L11E-24 | 0.321 | 47-001958-000 |
| 8 | ROBERT J & TONYA L LEMASTERS | 3-L11E-24.1 | 0.321 | 47-001958-000 |
| 9 | HOWARD G & DONA E TAYLOR | 3-L11E-21 | 39.15 | 47-000079-000 |
| 10 | FAYE J TAGGART | 3-L11-3 | 66.00 | 47-0000193-000 |
| 11 | TIM R & L L REED | 3-L11-2.6 | 22.423 | 01-325754-000 |
| 12 | JOHN L SMITH II & JOAN MARIE SMITH | 3-LB-41 | 4.486 | 734034-000 |
| 13 | WILLIAM F & NINA JUNE STRAUB | 3-L11-1.3 | 24.50 | 01-383489-000 |
| 14 | STEVE & SHARON K VARGO | 3-LB-29 | 58.50 | 01-384424-000 |
| 15 | JOHN L & JOAN MARIE SMITH | 3-L7-48 | 120.58 | 01-385509-000 |
| 16 | MICHELLE BONHAM | 3-LB-24.1 | 6.00 | 01-313753-000 |
| 17 | MICHELLE BONHAM | 3-LB-24.10 | 4.00 | 01-313741-000 |
| 18 | COREY M SOBOTA | 3-LB-24 | 24.24 | 01-268384-000 |
| 19 | DANIEL MCKEE | 3-LB-24.8 | 9.26 | 01-329244-000 |
| 20 | JOSEPH F BIPPUS SR ETAL | 3-LB-1.3 | 96.046 | 01-385.04-000 |
| 21 | BETTY JANE MEYERS | 3-L7-8.3 | 22.084 | 01-385504-000 |
| 22 | BETTY JANE MEYERS | 3-L7-6.1 | 2.91 | 01-385504-000 |

GRID NORTH
UTM, NAD83 DATUM, ZONE 17, US FT

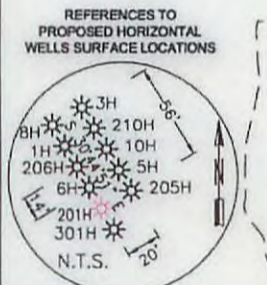
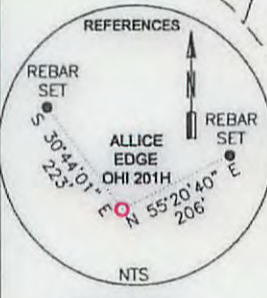

| |
|--|
| AS-DRILLED SURFACE HOLE LOCATION (SHL): |
| UTM (NAD83, ZONE 17, METERS): NORTHING: 4,438,947.520 EASTING: 537,467.805 |
| AS-DRILLED LANDING POINT LOCATION (LPL): |
| UTM (NAD83, ZONE 17, METERS): NORTHING: 4,439,089.837 EASTING: 537,403.955 |
| AS-DRILLED BOTTOM HOLE LOCATION (BHL): |
| UTM (NAD83, ZONE 17, METERS): NORTHING: 4,441,755.916 EASTING: 536,186.648 |

I, THE UNDERSIGNED, HEREBY CERTIFY THAT THIS PLAT IS CORRECT TO THE BEST OF MY KNOWLEDGE AND BELIEF AND SHOWS ALL THE INFORMATION REQUIRED BY LAW AND REGULATIONS ISSUED AND PRESCRIBED BY THE DEPARTMENT OF ENVIRONMENTAL PROTECTION.
P.S. 2270 *[Signature]* 1/26/16

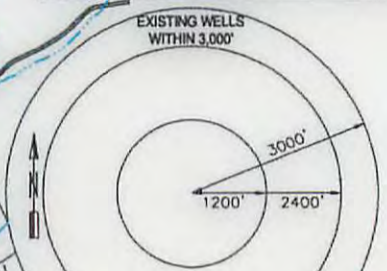
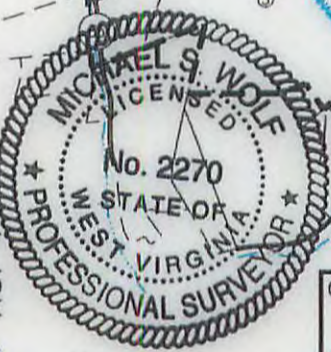

- NOTES ON SURVEY**
- COORDINATES SYSTEM IS UTM, NAD 83 DATUM, ZONE 17, U.S. FOOT AND WELL COORDINATES ESTABLISHED USING SURVEY GRADE GPS.
 - SURFACE AND ROYALTY OWNER INFORMATION AND THEIR BOUNDARIES SHOWN HEREON WERE PLOTTED FROM DEEDS AND/OR TAX PARCEL MAPS PROVIDED BY CLIENT AND FIELD LOCATIONS.
 - THIS PLAT DOES NOT REPRESENT A BOUNDARY SURVEY OF THE PARCELS SHOWN HEREON.
 - NO DWELLINGS AND BUILDINGS WITHIN 625 FEET OF PROPOSED CENTER OF PAD.
 - NO WATER WELLS OR DEVELOPED SPRINGS WITHIN 250 FEET OF PROPOSED WELL.
 - NO PERENNIAL STREAMS, LAKES, PONDS, RESERVOIRS OR WETLANDS WITHIN 100 FEET OF THE LIMITS OF DISTURBANCE.
 - NO NATURALLY PRODUCING TROUT STREAM WITHIN 300 FEET OF LIMITS OF DISTURBANCE.

SWN PRODUCTION COMPANY, LLC
"ALICE EDGE OHI 201H"
SURFACE HOLE
ELEV: 1199.4' (AS-DRILLED)

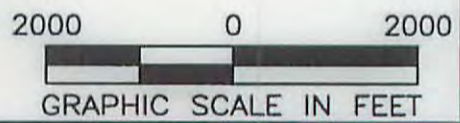

COMPANY: **SWN** Production Company, LLC

(+) DENOTES LOCATION OF WELL ON UNITED STATES TOPOGRAPHIC MAPS
WVDEP
OFFICE OF OIL & GAS
601 57TH STREET
CHARLESTON, WV 25034

MINIMUM DEGREE OF ACCURACY: 1/200
PROVEN SURVEY SOURCE OF GRADE GPS
ELEVATION: (NAVD 88, US FT)

ALICE EDGE
OPERATOR'S WELL #: OHI 201H
API WELL #: 47 STATE 069 COUNTY 00181 PERMIT

WELL TYPE: OIL WASTE DISPOSAL PRODUCTION DEEP GAS LIQUID INJECTION STORAGE SHALLOW

WATERSHED: UPPER OHIO SOUTH ELEVATION: 1199.4
DISTRICT: LIBERTY COUNTY: OHIO QUADRANGLE: VALLEY GROVE
SURFACE OWNER: ALICE MAE EDGE ACREAGE: 103±
OIL & GAS ROYALTY OWNER: ALICE MAE EDGE ACREAGE: 969.538±

DRILL DRILL DEEPER REDRILL FRACTURE OR STIMULATE PLUG OFF OLD FORMATION PERFORATE NEW FORMATION
 CONVERT PLUG & ABANDON CLEAN OUT & REPLUG OTHER CHANGE (SPECIFY)

TARGET FORMATION: MARCELLUS ESTIMATED DEPTH: 6,410 TO 18,275 TD

WELL OPERATOR: SWN PRODUCTION COMPANY, LLC ADDRESS: P.O. BOX 1300
 CITY: JANE LEW STATE: WV ZIP CODE: 26378 DESIGNATED AGENT: DEE SOUTHALL
 CITY: JANE LEW STATE: WV ZIP CODE: 26378

| | | |
|---------------------------------------|--------------------|-----------------------------|
| LEGEND: | REVISIONS: | DATE: 01-26-2016 |
| ○ PROPOSED SURFACE HOLE / BOTTOM HOLE | | |
| ⊗ EXISTING / PRODUCING WELLHEAD | --- LEASE BOUNDARY | |
| ⊗ ABANDONED WELL | --- DESIGN DHP | |
| ⊗ PLUGGED & ABANDONED WELL | --- AS-DRILLED DHP | |
| ⊗ CUT CONDUCTOR | --- ABANDONED DHP | |
| | | DRAWN BY: E.LYLTLE |
| | | SCALE: 1" = 2000' |
| | | DRAWING NO: 030-2725 |
| | | WELL LOCATION PLAT |

THRASHER

THE THRASHER GROUP, INC.
600 WHITE OAKS BLVD.
BRIDGEPORT, WV 26330
PHONE 304-624-4108

AS-DRILLED

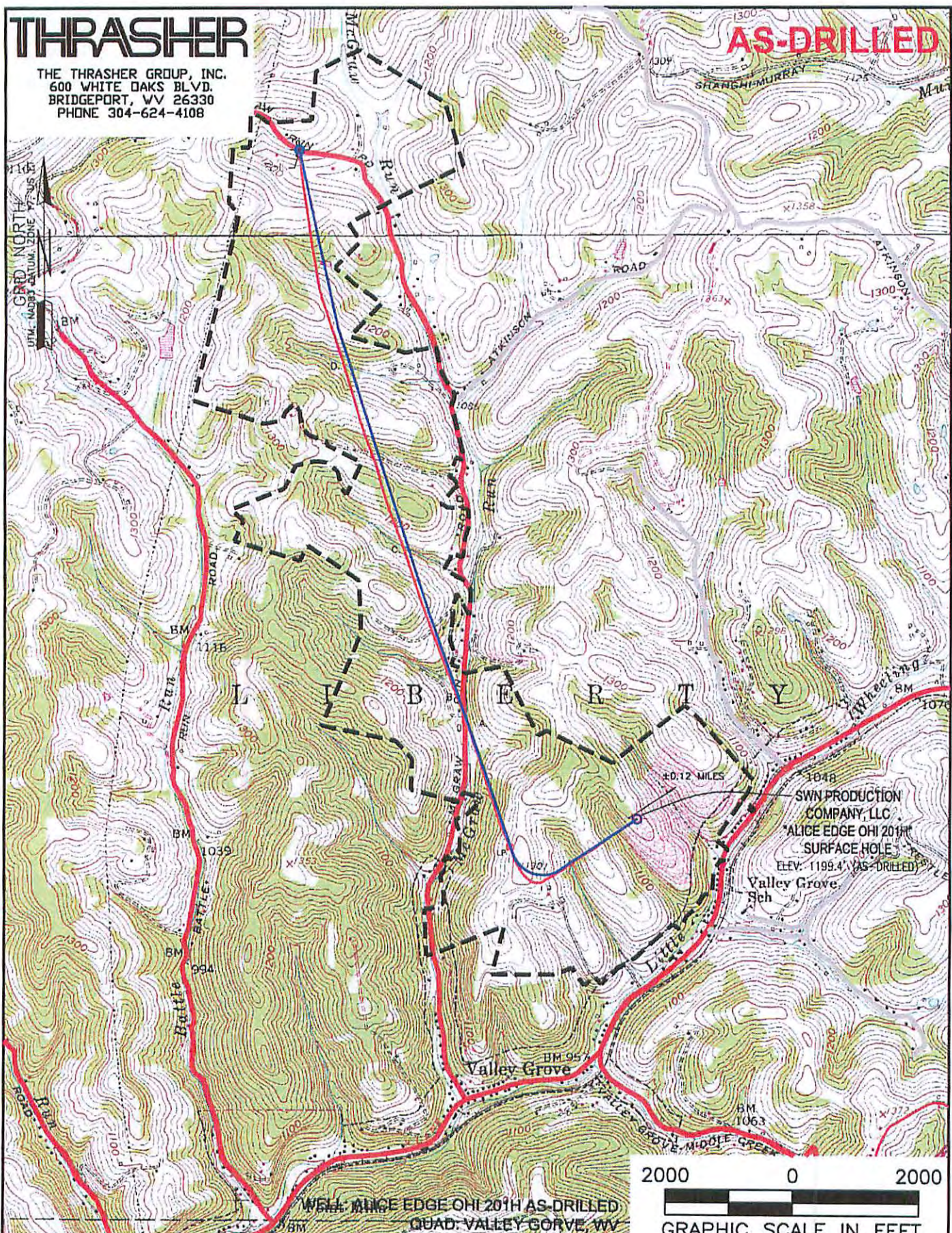

| | | | | | |
|---|--|--|--|--|--|
| NAME AND DISTANCE TO THE NEAREST STREAM: AN UNNAMED TRIBUTARY TO LITTLE WHEELING CREEK IS LOCATED ±0.12 MILES (NE) OF THE CENTER OF THE DRILL PAD. | | STREAM CROSSING COORDINATES (NAD 83): A. LAT: 40.103842' / LONG: -80.569981' B. LAT: 40.105177' / LONG: -80.570621' C. LAT: 40.111572' / LONG: -80.573633' D. LAT: 40.119409' / LONG: -80.576953' | | COMPANY: | |
| WELL RESTRICTIONS: WELL PAD, LOD, & E & S CONTROL FEATURES TO PERENNIAL STREAM, LAKE, POND, RESERVOIR OR WETLAND: >100 FEET WELL PAD, LOD, & E & S CONTROL FEATURES TO NATURALLY PRODUCING TROUT STREAM: >300 FEET WELL PAD, LOD, & E & S CONTROL FEATURES TO GROUNDWATER INTAKE OR PUBLIC WATER SUPPLY: >1000 FEET WELL SHL TO EXISTING WATER WELL OR DEVELOPED SPRING: >250 FEET CENTER OF PAD TO OCCUPIED DWELLING STRUCTURE: >625 FEET CENTER OF PAD TO AGRICULTURAL BUILDINGS LARGER THAN 2500 SQ FT: >625 FEET | | OPERATOR'S ALICE EDGE | | | |
| FEMA FLOOD INFORMATION: NO FLOOD ZONES. | | WELL #: OHI 201H | | LOCATION: LIBERTY DISTRICT, OHIO, WEST VIRGINIA | |
| LEGEND: ○ PROPOSED SURFACE HOLE / BOTTOM HOLE ☼ EXISTING / PRODUCING WELLHEAD ✕ ABANDONED WELL ⊕ PLUGGED & ABANDONED WELL △ CUT CONDUCTOR ○ (S) EXISTING SPRING ○ (W) EXISTING WATER WELL — ACCESS ROAD — ACCESS ROAD TO PREV. SITE — HIGHWAY/INTERSTATE — COUNTY ROAD | | AS-DRILLED SURFACE HOLE LOCATION: GEOGRAPHIC (NAD83): LATITUDE: 40.099987' LONGITUDE: -80.560419' | | 02/26/2016 | |
| | | AS-DRILLED BOTTOM HOLE LOCATION: GEOGRAPHIC (NAD83): LATITUDE: 40.125345' LONGITUDE: -80.575292' | | REVISIONS: | |
| | | DATE: 01-26-2016 | | DRAWN BY: E.LYTLÉ | |
| | | SCALE: 1" = 2000' | | DRAWING NO: 030-2725 | |
| | | TOPOGRAPHIC MAP | | PROPERTY NUMBER 2501161879 | |
| | | | | PAD ID 3001155602 | |