

NOTE:
NO WATER WELLS WERE FOUND WITHIN 250' OF THE CENTER OF WELL PAD.
NO DWELLINGS WERE FOUND WITHIN 825' OF THE CENTER OF THE WELL PAD.

TOP HOLE (UTM NAD 83)
N) 4438926.2
E) 537473.7
BOTTOM HOLE (UTM NAD 83)
N) 4441280.4
E) 535696.1

PARCEL OWNER	PARCEL ID	ACREAGE	LEASE NUMBER
A ASSEMBLY OF GOD TRUSTEES	L11-10.2	0.154 ACRES	LEASE NUMBER
B ASSEMBLY OF GOD TRUSTEES	L11-12	0.099 ACRES	LEASE NUMBER
C ROGER J. & S. RAKON	L11-12.1	0.147 ACRES	LEASE NUMBER
D ROGER J. & S. RAKON	L11-11.1	0.527 ACRES	LEASE NUMBER

1,460' SOUTH OF LATITUDE 40° 07' 30"
11,160' WEST OF LONGITUDE 80° 32' 30"

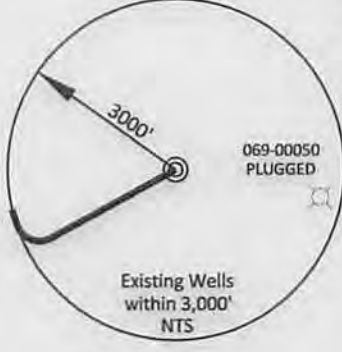
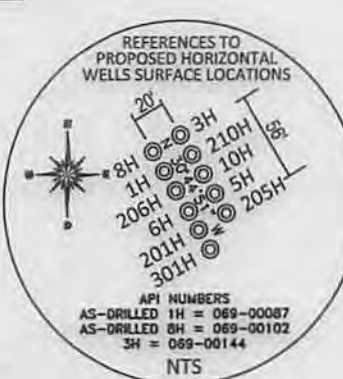

REFERENCE NOTES
Boundaries as shown taken from deeds, tax maps and field locations. A full boundary survey is not expressed nor implied. All bearings are based on true north. Ownership taken from public records Ohio County, West Virginia JUNE 2013 State Plane Coordinates & NAD 83 Lat/Long by differential submeter mapping grade GPS Drafted by EAM.

FILE #: CHE 036
DRAWING #: 2372
SCALE: PLAT: 1" = 1600'
TICK MARK: 1" = 2000'
MINIMUM DEGREE OF ACCURACY: 1/200
PROVEN SOURCE OF ELEVATION: SUBMETER MAPPING GRADE GPS

I, THE UNDERSIGNED, HEREBY CERTIFY THAT THIS PLAT IS CORRECT TO THE BEST OF MY KNOWLEDGE AND BELIEF AND SHOWS ALL THE INFORMATION REQUIRED BY LAW AND THE REGULATIONS ISSUED AND PRESCRIBED BY THE DEPARTMENT OF ENVIRONMENTAL PROTECTION.
Signed: *[Signature]*
L.L.S. #2124 : Ernest J. Benchek III



(+) DENOTES LOCATION OF WELL ON UNITED STATES TOPOGRAPHIC MAPS WVDEP
OFFICE OF OIL & GAS
601 57TH STREET
CHARLESTON, WV 25304
Well Type: Oil Waste Disposal Production Deep
 Gas Liquid Injection Storage Shallow
WATERSHED: UPPER OHIO SOUTH
COUNTY/DISTRICT: OHIO / LIBERTY
SURFACE OWNER: ALICE MAE EDGE
OIL & GAS ROYALTY OWNER: ALICE MAE EDGE
LEASE NUMBERS:

DATE: SEPTEMBER 29, 2014
OPERATOR'S WELL #: ALICE EDGE OHI 301H
API WELL #: 47 69 00183H6A
STATE COUNTY PERMIT
ELEVATION: 1,198'
QUADRANGLE: VALLEY GROVE, WV
ACREAGE: 103 +/-
ACREAGE: 804.197 +/-
TARGET FORMATION: MARCELLUS
ESTIMATED DEPTH: TVD: 6,410' TMD: 17,153'
WELL OPERATOR: CHESAPEAKE APPALACHIA, LLC.
DESIGNATED AGENT: ERIC B. GILLESPIE
ADDRESS: PO BOX 18496
ADDRESS: PO BOX 6070
CITY: OKLAHOMA CITY STATE: OK ZIP CODE: 73154-0496
CITY: CHARLESTON STATE: WV 25362

DRILL CONVERT DRILL DEEPER REDRILL FRACTURE OR STIMULATE
PLUG OFF FORMATION PERFORATE NEW FORMATION PLUG & ABANDON
CLEAN OUT & REPLUG OTHER CHANGE (SPECIFY):

10/10/2014

WELL: ALICE EDGE OHI 301H
QUAD: VALLEY GROVE, WV & BETHANY, WV

4706900183

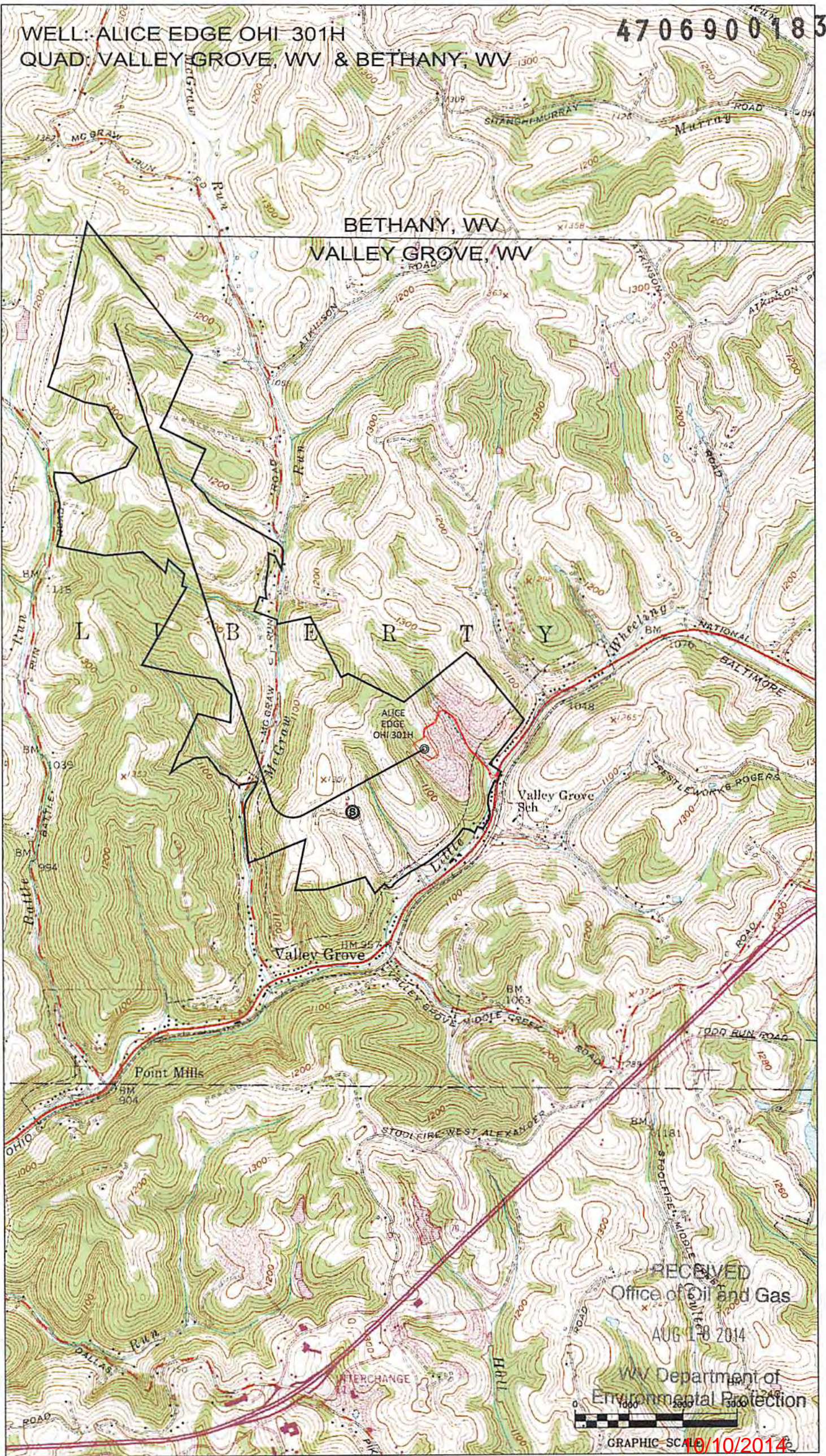

BETHANY, WV
VALLEY GROVE, WV

L I B E R T Y

ALICE
EDGE
OHI 301H

Valley Grove
Sch.

Valley Grove

Point Mills

STODOLICE WEST ALEXANDER

RECEIVED
Office of Oil and Gas

AUG 18 2014

WV Department of
Environmental Protection



GRAPHIC SCALE 10/10/2014